



Chipsmall Limited consists of a professional team with an average of over 10 year of expertise in the distribution of electronic components. Based in Hongkong, we have already established firm and mutual-benefit business relationships with customers from,Europe,America and south Asia,supplying obsolete and hard-to-find components to meet their specific needs.

With the principle of “Quality Parts,Customers Priority,Honest Operation,and Considerate Service”,our business mainly focus on the distribution of electronic components. Line cards we deal with include Microchip,ALPS,ROHM,Xilinx,Pulse,ON,Everlight and Freescale. Main products comprise IC,Modules,Potentiometer,IC Socket,Relay,Connector.Our parts cover such applications as commercial,industrial, and automotives areas.

We are looking forward to setting up business relationship with you and hope to provide you with the best service and solution. Let us make a better world for our industry!



## Contact us

Tel: +86-755-8981 8866 Fax: +86-755-8427 6832

Email & Skype: info@chipsmall.com Web: www.chipsmall.com

Address: A1208, Overseas Decoration Building, #122 Zhenhua RD., Futian, Shenzhen, China



THIS COPY IS PROVIDED ON A RESTRICTED BASIS AND IS NOT TO BE USED IN ANY WAY DETRIMENTAL TO THE INTERESTS OF PANDUIT CORP.

PANDUIT PART #	WIRE RANGE AWG [ mm <sup>2</sup> ]	TAB SIZE INCH [ mm ]	COLOR	MAX. WIRE INSULATION DIAMETER	DIMENSIONS in. [ mm ]		
					L± .03 [ 0,8 ]	W± .01 [ 0,3 ]	H± .01 [ 0,3 ]
EDV10-250	#12-10 [ 4,0-6,0 ]	.250 X .032 [ 6,3 X 0,8 ]	YELLOW	.23 [ 5,8 ]	1.03 [ 26,2 ]	.30 [ 7,6 ]	.13 [ 3,3 ]

NOTES:

- USED FOR:
  - A. STRANDED COPPER WIRE ONLY
  - B. 194°F [90°C] MAX. OPERATING TEMP.
  - C. 600 V. MAX. VOLTAGE RATING
- MATERIAL:
  - A. STAMPING: BRASS, TIN PLATED
  - B. HOUSING: VINYL
  - C. SLEEVE: BRASS, TIN PLATED
- INSTALLATION TOOLS:
  - A. UL LISTED AND CSA CERTIFIED: CT-1550, CT-1551, CT-2500, CT-600A
  - B. PANDUIT APPROVED: CT-100A, CT-160, CT-260, CT-460
- WIRE STRIP LENGTH:  $9/32'' \begin{smallmatrix} +1/32 \\ -0 \end{smallmatrix} [7,1\text{mm} \begin{smallmatrix} +0,8 \\ -0 \end{smallmatrix}]$
- SEE [www.panduit.com](http://www.panduit.com) FOR PACKAGE QUANTITIES INDICATED BY PART NUMBER SUFFIX
- DIMENSIONS IN BRACKETS ARE METRIC EQUIVALENT

MAX. WIRE INSUL. DIA. (SEE CHART)

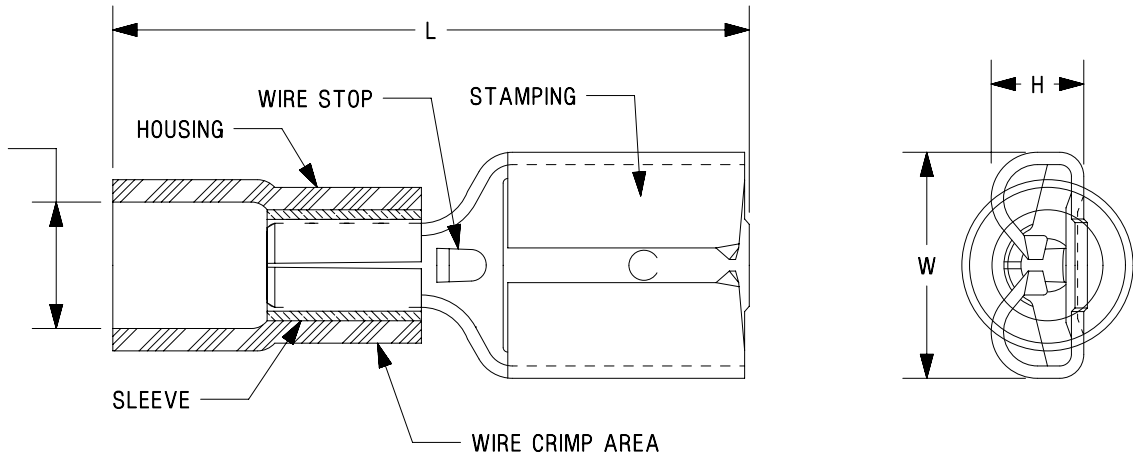

RECOGNIZED E78522 CERTIFIED LR31212

TITLE <b>STRONGHOLD FEMALE DISCONNECTS (250 SERIES)</b> <b>VINYL INSULATED, METAL SLEEVE #12-10 AWG</b> CUSTOMER DRAWING				
ITEM REVISION NAME		00123SHI/00		
DATASET FILE NAME		00123SHI_DC/00		
UNLESS OTHERWISE SPECIFIED, DIMENSIONAL TOLERANCES ARE: IN [ mm ] .x ± .1 [ 2.54 ]      .xxx ± .005 [ .127 ] .xx ± .01 [ .25 ]      ANGLES ± 5 °				MATERIAL:  SEE NOTES
THIRD ANGLE PROJECTION				DRAWING NUMBER: SH41199
DRAWN BY	DATE	CHK	SCALE	SIZE
JHNU	2/18	TMR	N.T.S.	A

REV	DATE	BY	CHK	APR	DESCRIPTION	ECN
00	2/18	JHNU	TMR	RGB	RELEASED	00123SH

D110100DA/12