



Chipsmall Limited consists of a professional team with an average of over 10 year of expertise in the distribution of electronic components. Based in Hongkong, we have already established firm and mutual-benefit business relationships with customers from,Europe,America and south Asia,supplying obsolete and hard-to-find components to meet their specific needs.

With the principle of "Quality Parts,Customers Priority,Honest Operation,and Considerate Service",our business mainly focus on the distribution of electronic components. Line cards we deal with include Microchip,ALPS,ROHM,Xilinx,Pulse,ON,Everlight and Freescale. Main products comprise IC,Modules,Potentiometer,IC Socket,Relay,Connector.Our parts cover such applications as commercial,industrial, and automotives areas.

We are looking forward to setting up business relationship with you and hope to provide you with the best service and solution. Let us make a better world for our industry!



Contact us

Tel: +86-755-8981 8866 Fax: +86-755-8427 6832

Email & Skype: info@chipsmall.com Web: www.chipsmall.com

Address: A1208, Overseas Decoration Building, #122 Zhenhua RD., Futian, Shenzhen, China



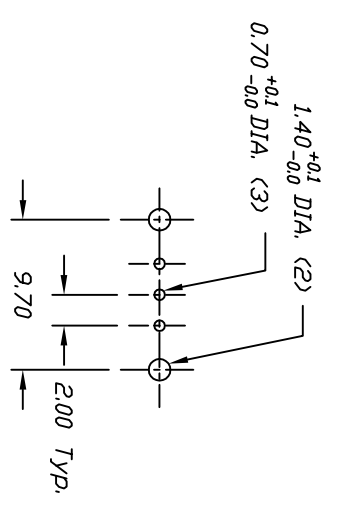
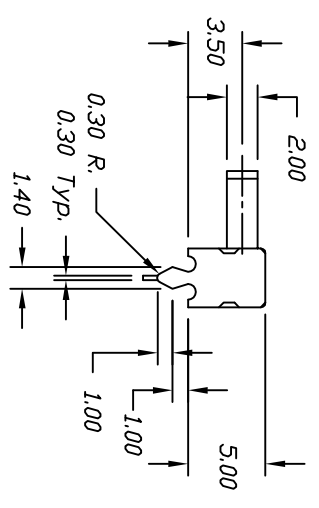
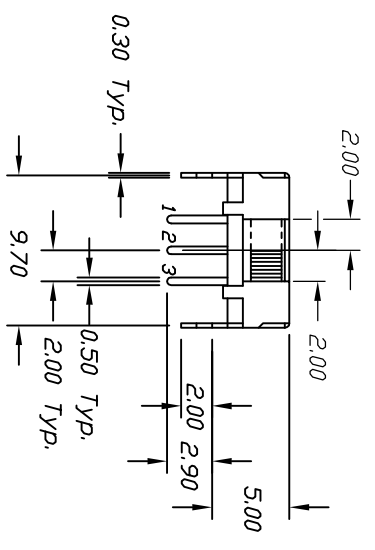
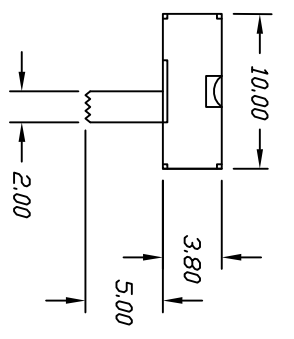

RECOMMEND P.C.B. LAYOUT

NOTES:

1. ALL DIMENSIONS IN MM (IN).
2. GENERAL TOLERANCE: X.X = +/- 0.4 mm
X.XX = +/- 0.25 mm
3. TERM. NDS. FOR REFERENCE ONLY
4. RATING: 0.2A @ 30VDC
5. CONTACT RESISTANCE: 30 MILLI-OHMS MAX. (INITIAL)
6. INSULATION RESISTANCE: 100 MEGA-OHMS MIN. @ 500VDC
7. DIELECTRIC STRENGTH: 500VAC FOR 1 MINUTE
8. OPERATING FORCE: 150-400 GRAMS
9. MATERIALS:
ACTUATOR: NYLON 66 ULHB
HOUSING: COLD ROLLED STEEL, TIN PLATE
TERMINALS: BRASS, SILVER PLATE
BASE: BAKELITE
MOVING CONTACT: PHOSPHORUS BRONZE, SILVER PLATE
10. OPERATING TEMP.: -10° C TO +60° C
11. MECHANICAL LIFE: 10,000 CYCLES
12. SOLDERABILITY: SEE E-SWITCH RECOMMENDED HAND AND WAVE SOLDERING PROFILES

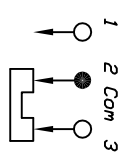

CIRCUIT: SPDT

CONTACT CONFIGURATION

B	18398	ADD MANY SPECIFICATIONS TO NOTES	2/10/09	BLR					
B		REVISED & REDRAWN							
REV.	POR	DESCRIPTION	DATE	CHKD					
THE INFORMATION CONTAINED IN THIS DOCUMENT IS PROPRIETARY TO E-SWITCH AND IS NOT TO BE COPIED OR TRANSFERRED									
TOLERANCES									
0.0					±0.4				
0.00					±0.25				
TITLE					EG 1213 Non-Shorting				
SCALE					2:1				
DATE					2/10/09				
DR					BLR				
DWG					P040030				
REV					C				

