



Chipsmall Limited consists of a professional team with an average of over 10 year of expertise in the distribution of electronic components. Based in Hongkong, we have already established firm and mutual-benefit business relationships with customers from,Europe,America and south Asia,supplying obsolete and hard-to-find components to meet their specific needs.

With the principle of “Quality Parts,Customers Priority,Honest Operation,and Considerate Service”,our business mainly focus on the distribution of electronic components. Line cards we deal with include Microchip,ALPS,ROHM,Xilinx,Pulse,ON,Everlight and Freescale. Main products comprise IC,Modules,Potentiometer,IC Socket,Relay,Connector.Our parts cover such applications as commercial,industrial, and automotives areas.

We are looking forward to setting up business relationship with you and hope to provide you with the best service and solution. Let us make a better world for our industry!



Contact us

Tel: +86-755-8981 8866 Fax: +86-755-8427 6832

Email & Skype: info@chipsmall.com Web: www.chipsmall.com

Address: A1208, Overseas Decoration Building, #122 Zhenhua RD., Futian, Shenzhen, China



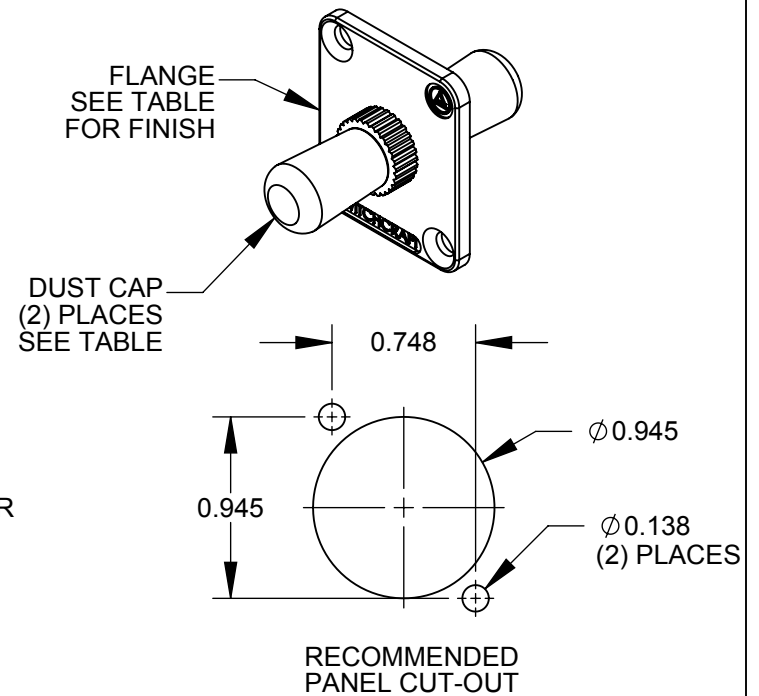
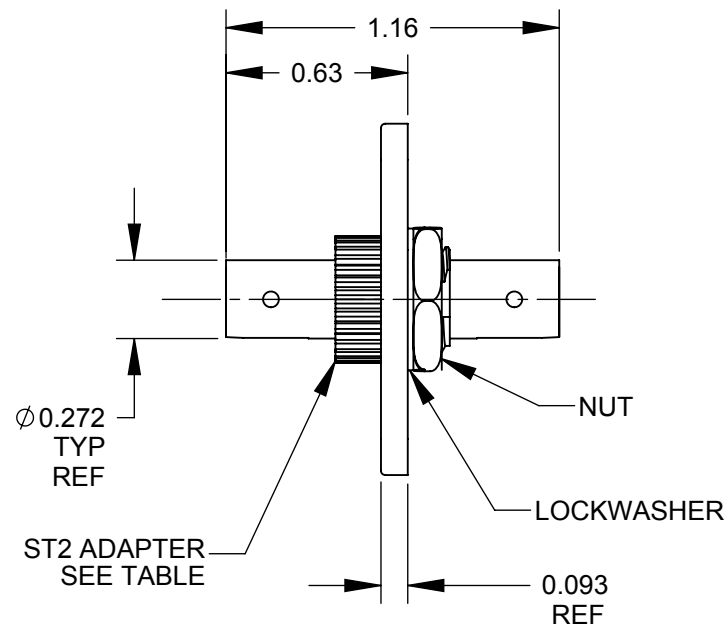
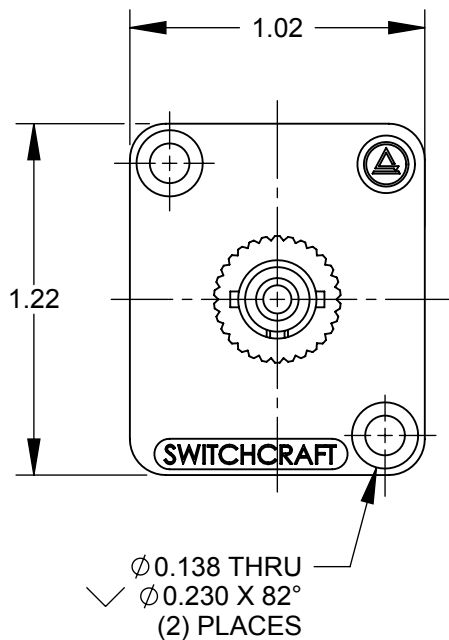

NOTES:

1. INSERTION LOSS: 0.25 dB MAX.
2. OPERATION TEMP: -40°C TO +80°C.
3. MATERIALS:

ST2 ADAPTER:

BODY - ZINC ALLOY
RETENTION WASHER - BRASS, NICKEL PLATED
SLEEVE - CERAMIC, SINGLE-MODE
- BRASS, MULTI-MODE

DUST CAPS - PVC

NUT - STEEL, NICKEL PLATED
LOCKWASHER - STAINLESS STEEL
FLANGE - ZINC ALLOY

4. THIS PRODUCT IS RoHS COMPLIANT.

PART NUMBER	ST2 ADAPTER SEE NOTE 3	DUST CAP COLOR	FLANGE FINISH
EHST2	SINGLE-MODE	RED	NICKEL
EHST2M	DOUBLE-MODE	BLACK	NICKEL
EHST2B	SINGLE-MODE	RED	BLACK CHROME
EHST2MB	DOUBLE MODE	BLACK	BLACK CHROME

CUSTOMER DRAWING

					<div>UNLESS OTHERWISE SPECIFIED</div> <div>1. ALL DIMENSIONS IN INCHES</div> <div>- TWO PLACE DECIMALS ±0.02</div> <div>- THREE PLACE DECIMALS ±0.005</div>	THIS DRAWING DESCRIBES A DESIGN CONSIDERED PROPRIETARY IN NATURE, DEVELOPED AND MANUFACTURED BY SWITCHCRAFT INC. AND IS RELEASED ON A CONFIDENTIAL BASIS FOR IDENTIFICATION PURPOSES ONLY.													
						SIZE	WIDTH		MULT		LBS/M		TEMPER						
						FINISH						MATERIAL							
						SPEC No.						SPEC No.							
						FIRST USED ON				SCALE		<div>Switchcraft®</div>							
								1.5:1											
A	26306	12/1/08	RS	TJK		DATE DRAWN	BY	CHKD		APVD		SHEET 1 OF 1							
					5/12/08	JGK	RS 6/2/09		TJK 7/16/09										
REV	ECO NUMBER	DATE	BY	APVD	NAME						PART No.		REV						
REVISIONS					DO NOT SCALE DRAWING					E SERIES ST2 FIBER OPTIC ADAPTER						EHST2_SERIES		A	

SolidWorks CAD File

