



Chipsmall Limited consists of a professional team with an average of over 10 year of expertise in the distribution of electronic components. Based in Hongkong, we have already established firm and mutual-benefit business relationships with customers from,Europe,America and south Asia,supplying obsolete and hard-to-find components to meet their specific needs.

With the principle of “Quality Parts,Customers Priority,Honest Operation,and Considerate Service”,our business mainly focus on the distribution of electronic components. Line cards we deal with include Microchip,ALPS,ROHM,Xilinx,Pulse,ON,Everlight and Freescale. Main products comprise IC,Modules,Potentiometer,IC Socket,Relay,Connector.Our parts cover such applications as commercial,industrial, and automotives areas.

We are looking forward to setting up business relationship with you and hope to provide you with the best service and solution. Let us make a better world for our industry!



## Contact us

Tel: +86-755-8981 8866 Fax: +86-755-8427 6832

Email & Skype: info@chipsmall.com Web: www.chipsmall.com

Address: A1208, Overseas Decoration Building, #122 Zhenhua RD., Futian, Shenzhen, China





REV	ECN	APP'D
-	4520	IQ 8/21/01
A	4646	IQ 11/7/01
B	4752	IQ 2/12/02
C	5742	PN 12/28/05

## ELFH SERIES PART NUMBERING SCHEME

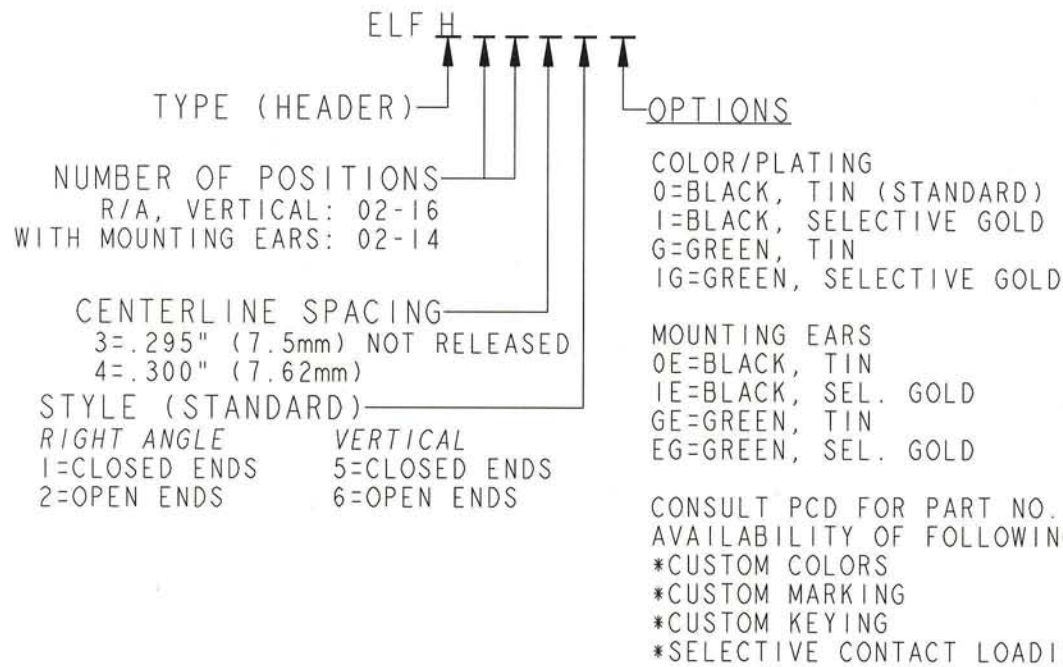

**RU RATINGS**

CURRENT - 15A  
 VOLTAGE - 300V  
 U.L. FILE NO. PENDING

**SA RATINGS**

CURRENT - 15 A  
 VOLTAGE - 450 V  
 CSA FILE NO. PENDING

DIN VDE 0627:1986  
 DIN VDE 0110-1:1989  
 EN 60947-1:1991  
 EN 60947-7-1:1992

CURRENT - 15 A  
 VOLTAGE - 450 V  
 TUV FILE NO. PENDING

**MATERIALS:**  
 HOUSING: PPT, UL 94 V-0  
 CONTACT: BRASS

**MAX OPERATING TEMPERATURE:**  
 105°C

<b>DIMENSIONS</b> ANSI Y14.5M UNITS: INCHES Pro/E FILE	<b>TOLERANCES</b> .XX ±0.01 .XXX ±0.005 ANGLES ±1.0°	<b>PROJECTION</b> 	<h1>Amphenol Pcd</h1>		<b>TITLE</b> <h2>ELFH SERIES          HEADER ASSEMBLY          7.5mm/.300 PITCH</h2>		
			<i>ENGR</i> S.HORNER 01-Aug-01		<b>SIZE</b> <h1>A</h1>	<b>DWG NO.</b> <h1>ELFH02410</h1>	
ORIGINAL STAMPED IN RED	THIS DOCUMENT CONTAINS PROPRIETARY INFORMATION WHICH IS THE CONFIDENTIAL PROPERTY OF AMPHENOL PCD, INC. PEABODY, MA, USA		<i>CHKD</i> I. QUINN 8/21/01		<b>CODE:</b> 58982 <b>SCALE:</b> NONE		<b>SHEET</b> 1 OF 2
			<i>APPD</i> I. QUINN 8/21/01				

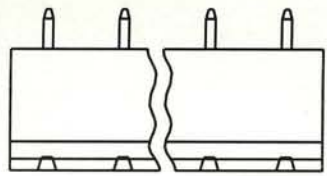

CLOSED ENDS

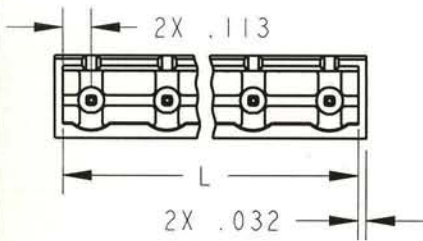

VERTICAL

RIGHT ANGLE

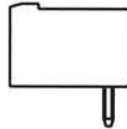

$$L = (\text{NUM OF POS} \times \text{CL}) - .074$$

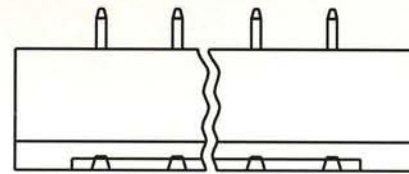

MOUNTING EARS

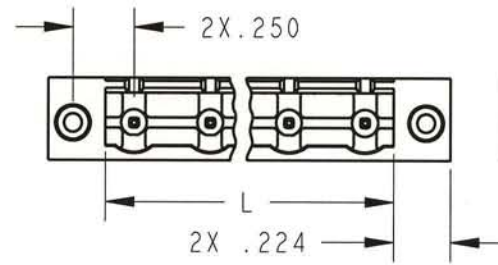

VERTICAL

RIGHT ANGLE

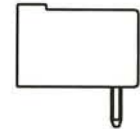

$$L = (\text{NUM OF POS} \times \text{CL}) - .074$$

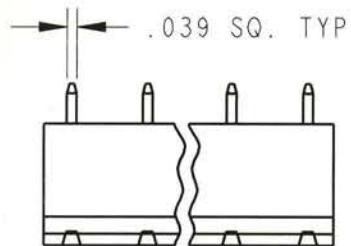

OPEN ENDS

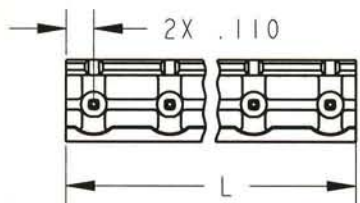

VERTICAL

RIGHT ANGLE

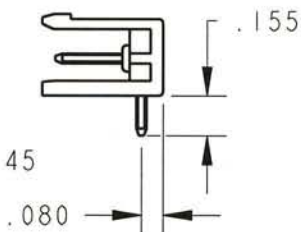
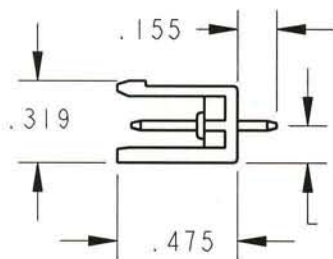

$$L = (\text{NUM OF POS} \times \text{CL}) - .100$$

PRINTED CIRCUIT BOARD CONFIGURATION

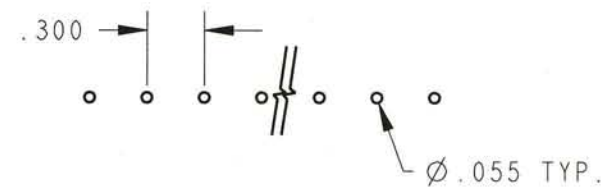

RECOMMENDED PCB THICKNESS: .062 ± .008

SIZE	DWG NO.	REV
A	ELFH02410	C
CODE: 58982	SCALE: NONE	SHEET 2 OF 2