



Chipsmall Limited consists of a professional team with an average of over 10 year of expertise in the distribution of electronic components. Based in Hongkong, we have already established firm and mutual-benefit business relationships with customers from,Europe,America and south Asia,supplying obsolete and hard-to-find components to meet their specific needs.

With the principle of "Quality Parts,Customers Priority,Honest Operation,and Considerate Service",our business mainly focus on the distribution of electronic components. Line cards we deal with include Microchip,ALPS,ROHM,Xilinx,Pulse,ON,Everlight and Freescale. Main products comprise IC,Modules,Potentiometer,IC Socket,Relay,Connector.Our parts cover such applications as commercial,industrial, and automotives areas.

We are looking forward to setting up business relationship with you and hope to provide you with the best service and solution. Let us make a better world for our industry!



## Contact us

Tel: +86-755-8981 8866 Fax: +86-755-8427 6832

Email & Skype: info@chipsmall.com Web: www.chipsmall.com

Address: A1208, Overseas Decoration Building, #122 Zhenhua RD., Futian, Shenzhen, China



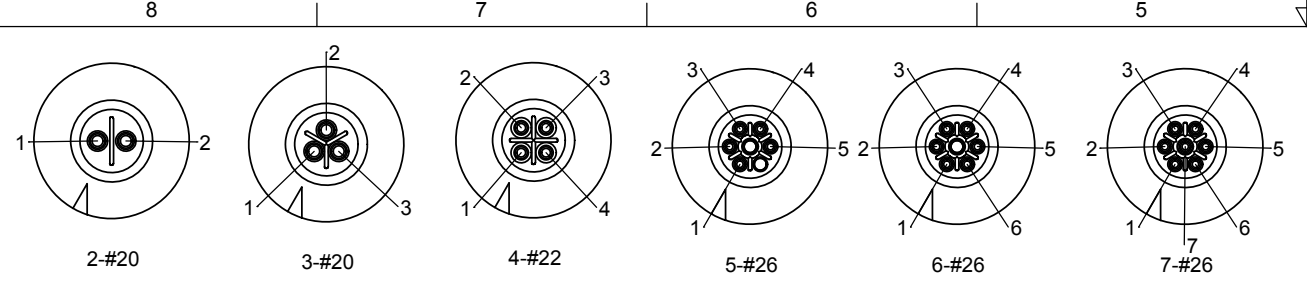

CONTACT ARRANGEMENTS  
PANEL CONNECTOR REAR (WIRING SIDE) VIEW

**EN2 PANEL CONNECTOR FIELD ASSEMBLY INSTRUCTIONS:**

Strip cable end and conductors as shown.

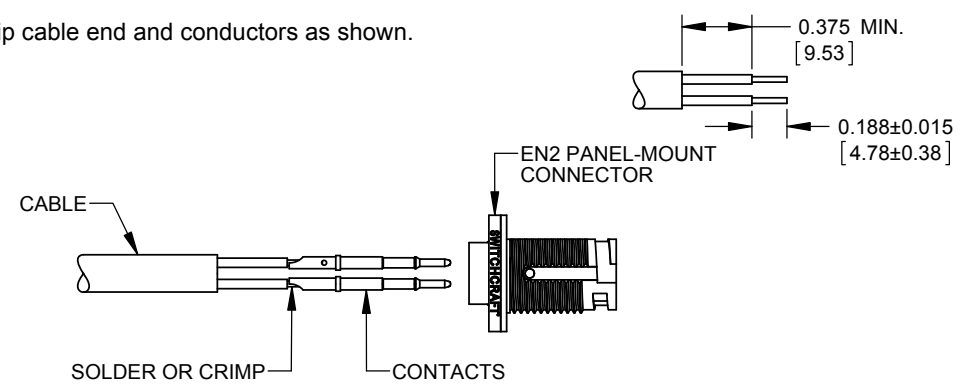

D Soldering or crimping conductors to contacts is recommended before insertion into connector. If crimping, use hand or pneumatic crimp tool with crimp positioner per contact size. If soldering after contacts are inserted in the connector, limit exposure of contacts to soldering iron temperature to 4 sec. maximum. Soldering iron temperature should not exceed 650°F (343°C).

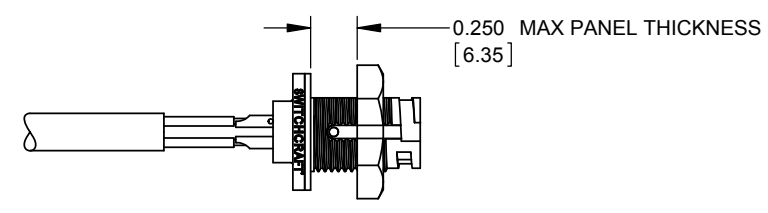

Insert wired contacts into connector housing using an insertion tool and per contacts arrangements. Align and install connector into panel cut-out. Tighten hex nut 5-6 in-lb.

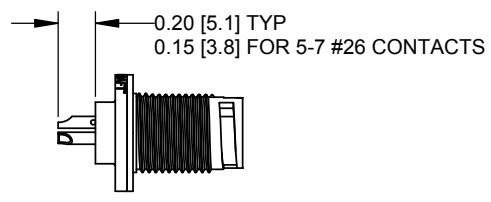

SOLDER OR CRIMP TYPE CONTACTS

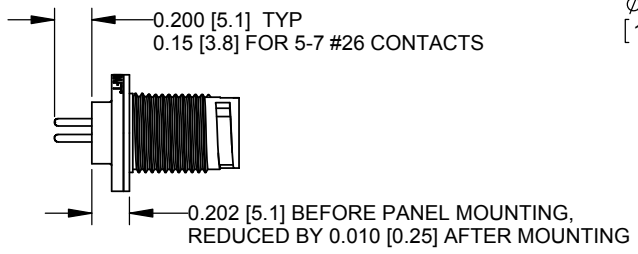

PC TAIL TYPE CONTACTS

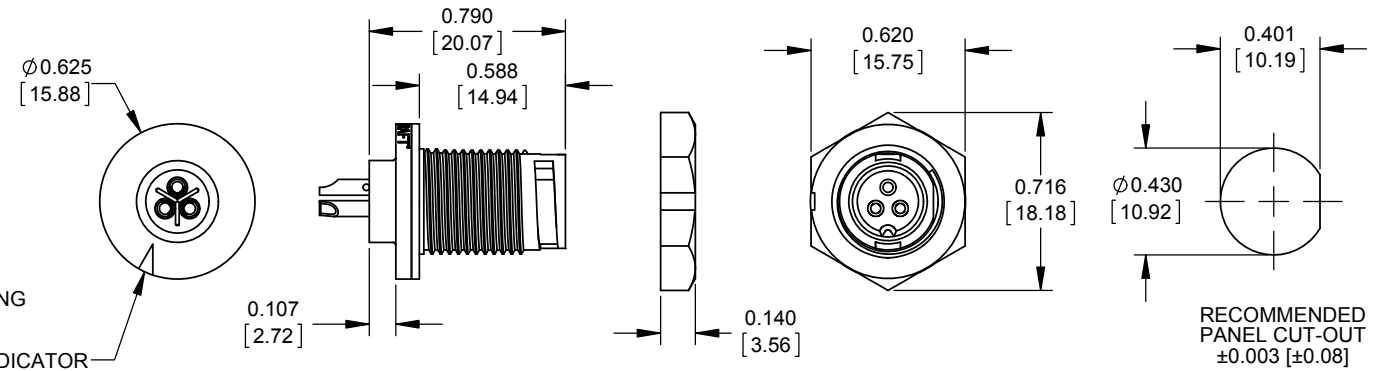

PIN 1 INDICATOR

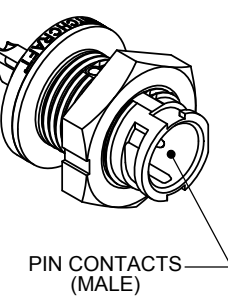

PIN CONTACTS (MALE)

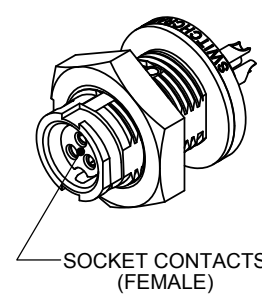

SOCKET CONTACTS (FEMALE)

**PART NUMBER SCHEME:**

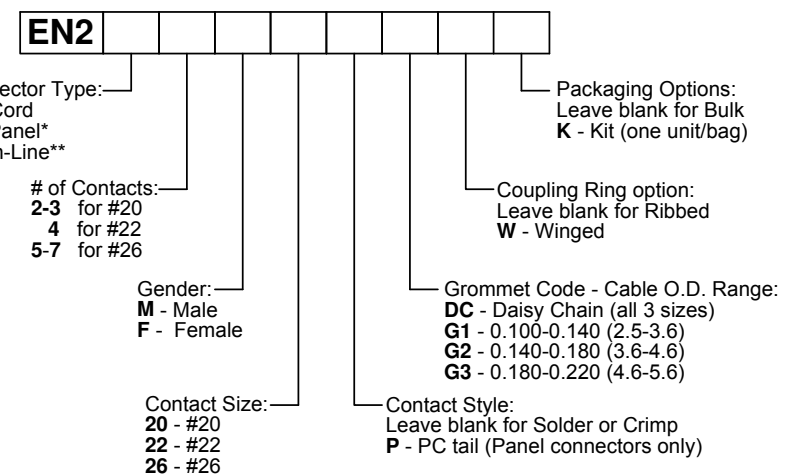

\* for mating Cord connectors refer to EN2C SERIES drawing.  
\*\* Mating In-Line connectors not currently available.

**SPECIFICATIONS:**

**MECHANICAL**  
Life: 600 cycles minimum  
Vibration: Mil-Std 202G Method 201A  
Hex Nut Tongue: 5-6 in-lb

**ELECTRICAL**  
Voltage Rating: 250 V AC/DC for 2 contact arrangement  
125 V AC/DC for 3-7 contact arrangements  
Insulation Resistance: 1000 mΩ minimum  
Contact Resistance: 10 mΩ maximum  
Current Rating: Refer to Current Rating Table

**ENVIRONMENTAL**  
Operating Temperature Limits: -40°C to +85°C (-40°F to +185°F), see Current Rating Table.  
Moisture Resistance: Mil-Std 202G Method 106G  
Insulation Resistance: Mil-Std 202G Method 302  
Thermal Shock: Mil-Std 202G Method 107G  
Salt Atmosphere (Corrosion): Mil-Std 202G Method 101E  
Wear/tight Ratings: IP16, IP18, IP66, IP67, IP68 per IEC60529  
NEMA 250 (6P), CFR 46 Part 110.20

**MATERIAL**  
Connector Housing ----- Thermoplastic, black  
Hex Nut: ----- Thermoplastic, black  
Coupling Ring ----- Thermoplastic, black  
Cable Clamp ----- Thermoplastic, black  
Handle (back-shell) ----- Thermoplastic, black  
Insulator ----- Elastomer, black  
Seal Grommet ----- Elastomer, black  
Contacts ----- Copper Alloy, plated

Contacts	Wire (awg)	Current Rating (A) at Operating Temperature (°C)				
		45°C max.	55°C max.	65°C max.	75°C max.	85°C max.
2 #20	20	7	6	5	4	3.5
	22	5.5	5	4	3	2.5
	24	5.5	5	4	3	2.5
	26	4	3.5	2.5	2	1
3 #20	20	6.5	5.5	4.5	3.5	2
	22	5	4.5	3.5	3	1.5
	24	5	4.5	3.5	3	1.5
	26	3	2.5	2	1.5	0.5
4 #22	20	5	4.5	3.5	3	1.5
	22	4.5	4	3	2	1
	24	4.5	4	3	2	1
	26	3	2.5	2	1.5	0.5
5-7 #26	26	3	2.5	2	1.5	1
	28	2.5	2	1.5	1	0.5
	30	2	1.5	1	0.5	0.5

TOOL	TOOL TYPE	POSITIONER	CONTACT SIZE	WIRE SIZES
EN3CR	HAND CRIMP TOOL	EN2POS20	20 and 22	20 and 22 AWG
		EN3POS26	26	26, 28, and 30 AWG
EN3CRAUTO	PNEUMATIC CRIMP TOOL	EN2POS20	20 and 22	20 and 22 AWG
		EN3POS26	26	26, 28, and 30 AWG
EN2CRL	HAND CRIMP TOOL LARGE FRAME	EN2POS20L	20 and 22	20, 22, 24, and 26 AWG
EN2CRAUTOL	PNEUMATIC CRIMP TOOL LARGE FRAME			
EN3INS20	CONTACT	--	20 and 22	--
EN3INS26	INSERTION/EXTRACTION	--	26	--

ALL DIMENSIONS FOR REFERENCE ONLY

REV	ECO NUMBER	DATE	BY	APVD
0D	SPECS UPDATED	10/03/13	PNK	SRC
0C	SPECS UPDATED	09/20/12	PNK	SRC
0B	TOOLS REVISED	05/14/12	PNK	*
0A	PRELIMINARY	02/09/12	PNK	*
REVISIONS				

UNLESS OTHERWISE SPECIFIED  
1. ALL DIMENSIONS IN INCHES  
- TWO PLACE DECIMALS ±0.02  
- THREE PLACE DECIMALS ±0.005

SIZE	WIDTH	MULT	LBS/M	TEMPER
THIS DRAWING DESCRIBES A DESIGN CONSIDERED PROPRIETARY IN NATURE, DEVELOPED AND MANUFACTURED BY SWITCHCRAFT INC. AND IS RELEASED ON A CONFIDENTIAL BASIS FOR IDENTIFICATION PURPOSES ONLY.				
FINISH SPEC No.		MATERIAL SPEC No.		
FIRST USED ON		SCALE 1.5:1		
DATE DRAWN	BY	CHKD	APVD	Switchcraft®
02/09/12	PNK	PNK	SRC	
NAME				SHEET 1 OF 2
EN2P SERIES CONNECTORS, RoHS				PART No. EN2P SERIES
DO NOT SCALE DRAWING				REV 0D

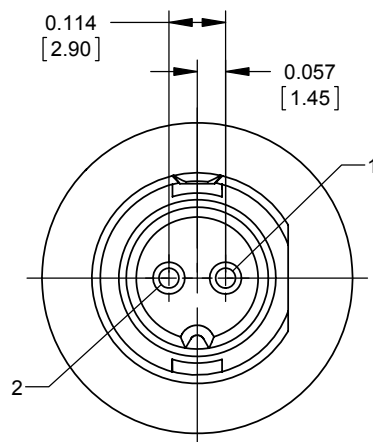

**2-#20**

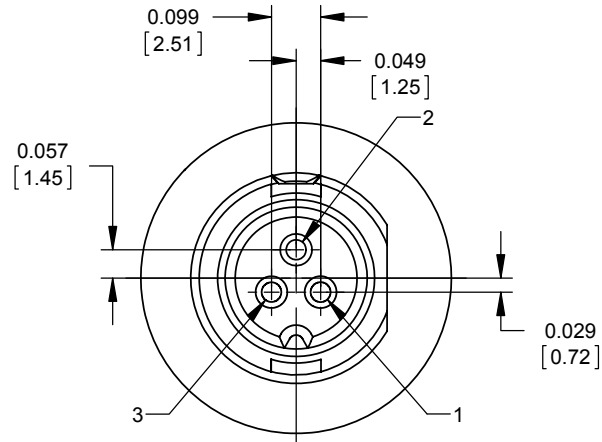

**3-#20**

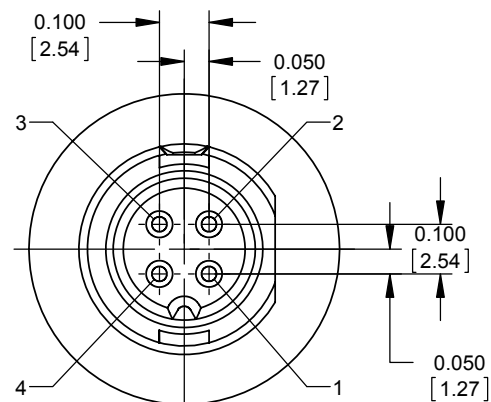

**4-#22**

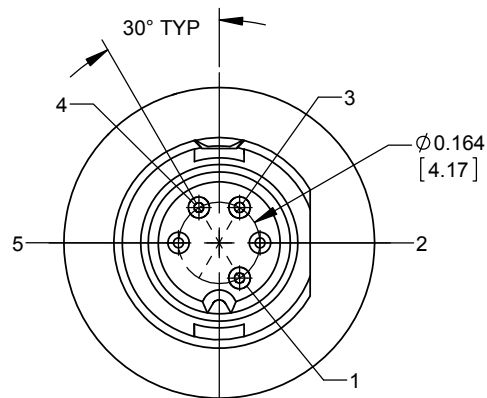

**5-#26**

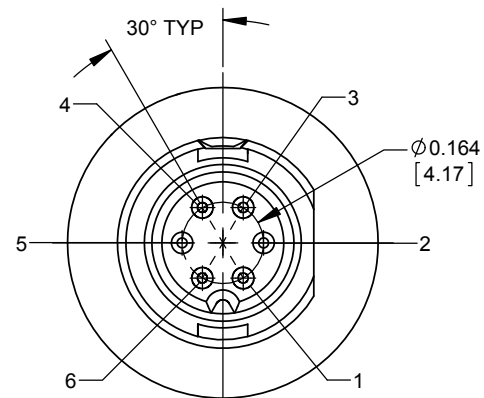

**6-#26**

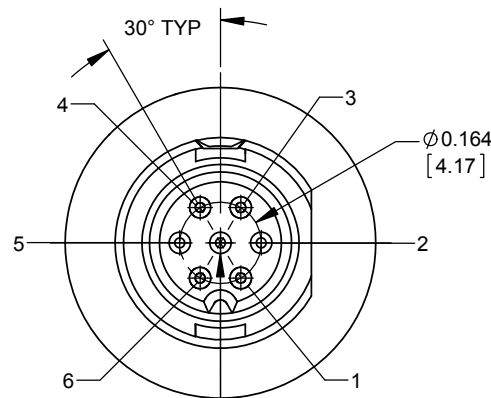

**7-#26**

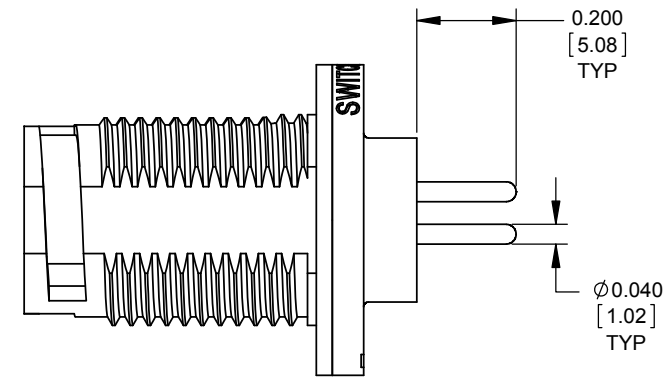

**2 and 3-#20  
PIN ARRANGEMENTS  
(0.046 [1.17] RECOMMENDED PCB HOLE SIZE)**

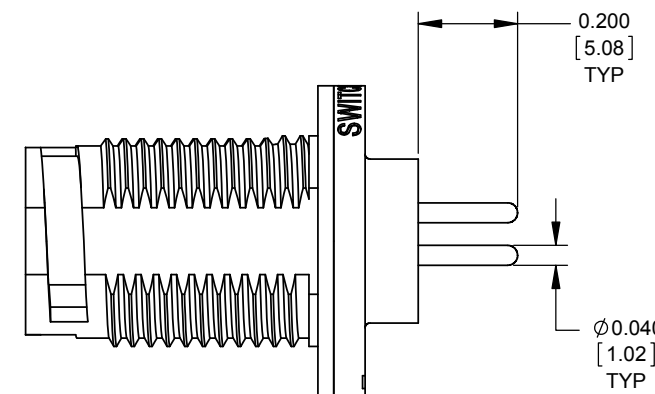

**4-#22  
PIN ARRANGEMENT  
(0.046 [1.17] RECOMMENDED PCB HOLE SIZE)**

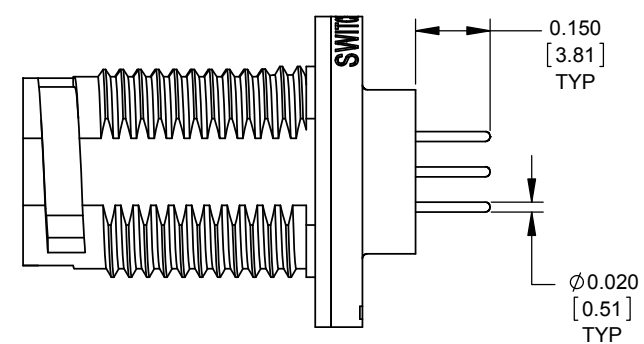

**5, 6, and 7-#26  
PIN ARRANGEMENTS  
(0.026 [0.66] RECOMMENDED PCB HOLE SIZE)**

**CONTACT ARRANGEMENTS  
PANEL CONNECTOR FRONT VIEW (PCB COMPONENT SIDE)  
(RECOMMENDED PCB HOLE LAYOUT WITHIN ±0.001 [0.025])**

CUSTOMER DRAWING

UNLESS OTHERWISE SPECIFIED 1. ALL DIMENSIONS IN INCHES - TWO PLACE DECIMALS ±0.02 - THREE PLACE DECIMALS ±0.005					SIZE	WIDTH	MULT	LBS/M	TEMPER									
					FINISH	MATERIAL			SPEC No.									
<table border="1"> <tr> <td>OD</td> <td>SPECS UPDATED</td> <td>10/03/13</td> <td>PNK</td> <td>SRC</td> </tr> <tr> <td>REV</td> <td>ECO NUMBER</td> <td>DATE</td> <td>BY</td> <td>APVD</td> </tr> </table>					OD	SPECS UPDATED	10/03/13	PNK	SRC	REV	ECO NUMBER	DATE	BY	APVD	FIRST USED ON	SCALE		
					OD	SPECS UPDATED	10/03/13	PNK	SRC									
REV	ECO NUMBER	DATE	BY	APVD														
DATE DRAWN	BY	CHKD	APVD	SRC														
REVISIONS					NAME	PART No.			REV									
					EN2P SERIES CONNECTORS, RoHS			EN2P SERIES		0D								