



Chipsmall Limited consists of a professional team with an average of over 10 year of expertise in the distribution of electronic components. Based in Hongkong, we have already established firm and mutual-benefit business relationships with customers from,Europe,America and south Asia,supplying obsolete and hard-to-find components to meet their specific needs.

With the principle of “Quality Parts,Customers Priority,Honest Operation,and Considerate Service”,our business mainly focus on the distribution of electronic components. Line cards we deal with include Microchip,ALPS,ROHM,Xilinx,Pulse,ON,Everlight and Freescale. Main products comprise IC,Modules,Potentiometer,IC Socket,Relay,Connector.Our parts cover such applications as commercial,industrial, and automotives areas.

We are looking forward to setting up business relationship with you and hope to provide you with the best service and solution. Let us make a better world for our industry!



Contact us

Tel: +86-755-8981 8866 Fax: +86-755-8427 6832

Email & Skype: info@chipsmall.com Web: www.chipsmall.com

Address: A1208, Overseas Decoration Building, #122 Zhenhua RD., Futian, Shenzhen, China



REV	ECN	APPD
-	4800	



RATINGS

CURRENT - 12A
 VOLTAGE - 150V
 U.L. FILE NO.



RATINGS

CURRENT - 12A
 VOLTAGE - 150V
 CSA FILE NO.

DIN VDE 0627:1986
 DIN VDE 0110-1:1989
 EN 60947-1:1991
 EN 60947-7-1:1992

CURRENT - 12A
 VOLTAGE - 130V
 TUV FILE NO.

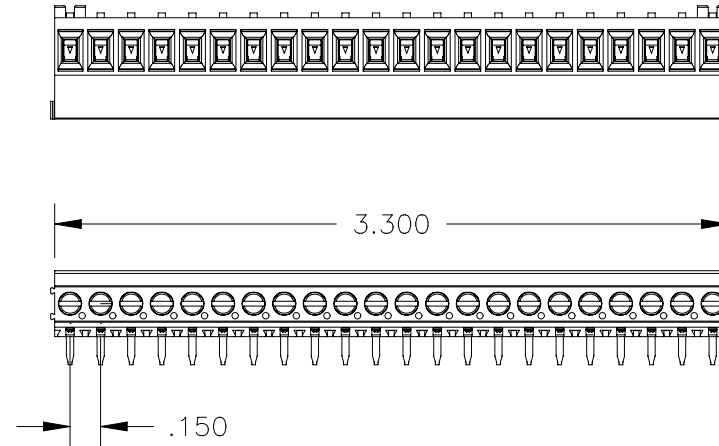
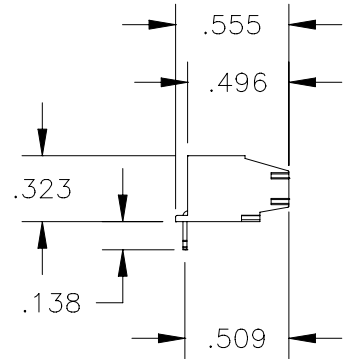

INSTALLATION
 RECOMMENDATIONS

WIRE RANGE: 14-30 AWG
 WIRE STRIP LENGTH: .200-.240
 TIGHTENING TORQUE: 2.2 LB-IN.

MATERIALS

HOUSING: POLYAMIDE 6/6, COLOR: BLACK
 CONTACT: COPPER ALLOY, TIN PLATED
 SCREW / CAGE CLAMP: COPPER ALLOY, NICKEL PLATED

OPERATING TEMPERATURE RANGE: -40°C TO 110°C
 RECOMMENDED PCB THICKNESS: .094 MAX

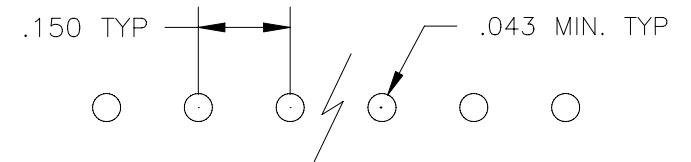

DIMENSIONS

ANSI Y14.5M
 UNITS: INCHES
 ACAD FILE

TOLERANCES

.XX ± .01
 .XXX ± .005
 ANGLES ± 2°

PROJECTION

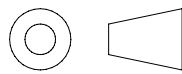

SPECIFICATION
 DRAWING

ENGR
 I. QUINN 3/20/02

CHKD

APPD



TITLE

ESRM TERMINAL BLOCK
 22 POSITION VERTICAL
 .150 [3.81mm] PITCH

SIZE

A

DWG NO.

ESRM22290

REV

-

CODE: 58982

SCALE: NONE

SHEET 1 OF 1

ORIGINAL
 STAMPED
 IN RED

THIS DOCUMENT CONTAINS
 PROPRIETARY INFORMATION WHICH
 IS THE CONFIDENTIAL PROPERTY
 OF PCD, INC. PEABODY, MA, USA