



Chipsmall Limited consists of a professional team with an average of over 10 year of expertise in the distribution of electronic components. Based in Hongkong, we have already established firm and mutual-benefit business relationships with customers from,Europe,America and south Asia,supplying obsolete and hard-to-find components to meet their specific needs.

With the principle of "Quality Parts,Customers Priority,Honest Operation,and Considerate Service",our business mainly focus on the distribution of electronic components. Line cards we deal with include Microchip,ALPS,ROHM,Xilinx,Pulse,ON,Everlight and Freescale. Main products comprise IC,Modules,Potentiometer,IC Socket,Relay,Connector.Our parts cover such applications as commercial,industrial, and automotives areas.

We are looking forward to setting up business relationship with you and hope to provide you with the best service and solution. Let us make a better world for our industry!



Contact us

Tel: +86-755-8981 8866 Fax: +86-755-8427 6832

Email & Skype: info@chipsmall.com Web: www.chipsmall.com

Address: A1208, Overseas Decoration Building, #122 Zhenhua RD., Futian, Shenzhen, China



Circuit diagram

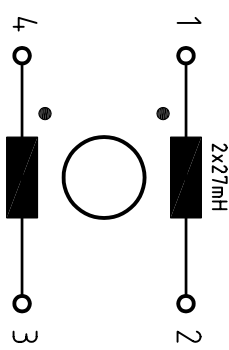

Allgemeine Toleranzen General tolerances Tolerances en général L ± 30% C ± 20% R ± 10%

Daten (single phase) data caractéristiques

Nennstrom bei Umgebungstemp. rated current at an ambient temp. courant nominal à une température ambiante 1,5 A 50 °C

Nennspannung rated voltage tension nominale max. 250 V, 50/60Hz

Betriebsfrequenz operating frequency fréquence de service max. 400 Hz

Ableitstrom im Betrieb Operational leakage current courant de fuite en fonction Tol. Spannung P-E / Frequenz - VAC - Hz

Berechnung mit C-tol. Calculation with C-tol. Calculations avec C-tol. +20 I max. - mA

Maximaler Ableitstrom unterbrochen des Nullleiters with interruption of the neutral conductor avec l'interruption du conducteur neutre Tol. Spannung P-E / Frequenz - VAC - Hz

Berechnung mit C-tol. Calculation with C-tol. Calculations avec C-tol. +20 I max. - mA

DC-Widerstand DC-resistance DC-résistance Tol. @ 25 °C max. 2 x 287 mOhm +15

Prüfspannung 100% Schlusskontroll. Test voltage 100% final test tension d'essais contrôle final 100% P/N->E - kV/- ≥ 2s P->N 2 kV/50Hz ≥ 2s

Wiederholung mit 80% der angegebenen Werte repetition with max. 80% of the specified values répétition avec max. 80% des valeurs spécifiées

Zulässige Betriebstemp. permissible operating temperature gamme de température - 25 °C bis/to/à + 100 °C

Klimatische Prüfklasse climatic test class classe d'essais climatique 25/100/21 IEC/CEI 60068-1

I | III SCHÄFFNER Type EV28-1,5-02-27M-X 2100-088 C

Dimensions (mm)

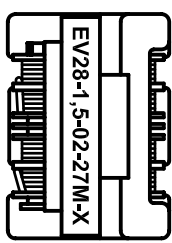
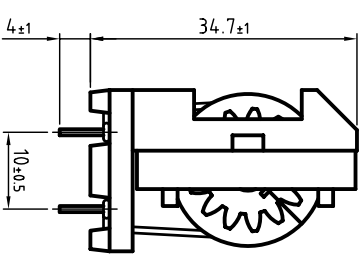
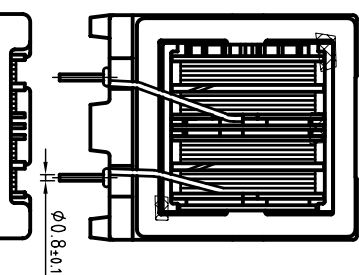
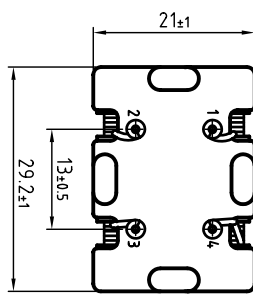

Zusatzangaben additional information informations supplémentaires

Vergussmasse potting compound matière de moulage -- g

Gewicht weight poids 38 g

Prüfzeichen approvals homologations

CSA / C-US UL 1283 CSA C 22.2 No.8 UL UL 1283 SEMKO EN 133200 IEC 60939 VDE

Zusätzliche Angaben: Additional remarks: Remarques additionals:

Für Masse ohne Toleranz for dimensions without tolerance pour mesure sans tolérance ISO2168-m/EN22168-m

Datenblatt (single phase) data sheet fiche technique

Copyright by SCHÄFFNER EMV AG		www.schaffner.com	
C	121074	T	17.02.05
Ind.	revision	date	name
			SAC
		drawn	04.06.2002
		ds proved	27.05.2003
		doc. proved	27.05.2003
		name	STU
		name	SMA
		name	KO

Schaffner EMC **I | III SCHÄFFNER** DB3 2100-088 C

LAMPHUN THAILAND plot date page 1 von 1