



Chipsmall Limited consists of a professional team with an average of over 10 year of expertise in the distribution of electronic components. Based in Hongkong, we have already established firm and mutual-benefit business relationships with customers from,Europe,America and south Asia,supplying obsolete and hard-to-find components to meet their specific needs.

With the principle of “Quality Parts,Customers Priority,Honest Operation,and Considerate Service”,our business mainly focus on the distribution of electronic components. Line cards we deal with include Microchip,ALPS,ROHM,Xilinx,Pulse,ON,Everlight and Freescale. Main products comprise IC,Modules,Potentiometer,IC Socket,Relay,Connector.Our parts cover such applications as commercial,industrial, and automotives areas.

We are looking forward to setting up business relationship with you and hope to provide you with the best service and solution. Let us make a better world for our industry!



## Contact us

Tel: +86-755-8981 8866 Fax: +86-755-8427 6832

Email & Skype: [info@chipsmall.com](mailto:info@chipsmall.com) Web: [www.chipsmall.com](http://www.chipsmall.com)

Address: A1208, Overseas Decoration Building, #122 Zhenhua RD., Futian, Shenzhen, China



### Linear Position Sensors (for reference only)

Japan  
Malaysia

Type: **EVAJ**  
**EVAWA, EVAWM (Slim Type)**  
**EVAW7 (Headlight Sensor)**

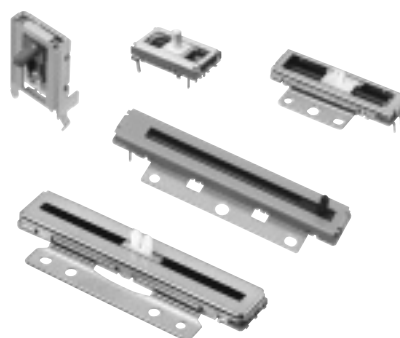

#### ■ Features

- High performance that guarantees a terminal-based linearity within  $\pm 0.5\%$
- A wide variety of operation strokes
- Long life and high resolution

#### ■ Recommended Applications

- Detection of still camera/camcorder lens positions
- Detection of car seat positions
- Steering wheel tilt and telescopic controller
- Car headlight angle detection sensor

#### ■ Explanation Part Numbers

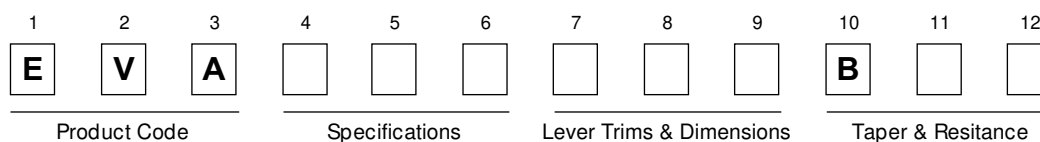

#### ■ Specifications

		EVAJ, EVAWA, EVAWM	EVAW7	
Mechanical	Stroke	13.0 mm $\pm$ 0.5 mm 18.0 mm $\pm$ 0.5 mm 32.0 mm $\pm$ 0.5 mm	9.0 mm $\pm$ 0.5 mm	8.0 mm $\pm$ 0.5 mm
	Operating Force	0.25 N max. (Measurement speed: 5 mm/s to 25 mm/s)	2 N max.	1 N max.
Electrical	Linearity	$\pm 1\%$ ( $\pm 0.5\%$ )	$\pm 2\%$	$\pm 1\%$
	Total Resistance	10 k $\Omega$ $\pm$ 30 %	10 k $\Omega$ $\pm$ 30 %	4.7 k $\Omega$ $\pm$ 30 %
	Voltage Rating	5 Vdc max.	5 Vdc max.	12 Vdc max.
	Taper	B	B	
Endurance	Operating Life	100000 cycles min. (Type capable of 200000 or more operation is also available)	10000 cycles min.	10000 cycles min.
Minimum Quantity/Packing Unit		100 pcs. (Tray Pack)	300 pcs. (Tray Pack)	200 pcs. (Tray Pack)
Quantity/Carton		500 pcs.	3000 pcs.	2000 pcs.

Design and specifications are each subject to change without notice. Ask factory for the current technical specifications before purchase and/or use.  
Should a safety concern arise regarding this product, please be sure to contact us immediately.

### ■ Dimensions in mm (not to scale)

<div> <div>No. 1</div> <div> <div>Japan</div> <div>EVAJ</div> <div>32.0 mm Stroke Type</div> </div> </div> <div> </div> <div> <div>Potentiometer circuit diagram</div> </div>
---

### ■ Dimensions in mm (not to scale)

No. 4

Malaysia

EVAW7

9.0 mm Stroke Type

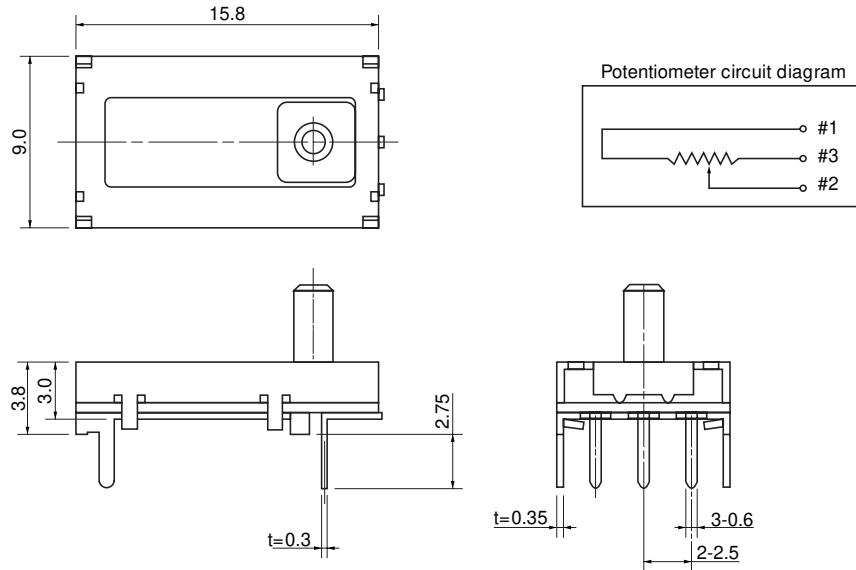

No. 5

Malaysia

EVAW7

8.0 mm Stroke Type

