



Chipsmall Limited consists of a professional team with an average of over 10 year of expertise in the distribution of electronic components. Based in Hongkong, we have already established firm and mutual-benefit business relationships with customers from,Europe,America and south Asia,supplying obsolete and hard-to-find components to meet their specific needs.

With the principle of “Quality Parts,Customers Priority,Honest Operation,and Considerate Service”,our business mainly focus on the distribution of electronic components. Line cards we deal with include Microchip,ALPS,ROHM,Xilinx,Pulse,ON,Everlight and Freescale. Main products comprise IC,Modules,Potentiometer,IC Socket,Relay,Connector.Our parts cover such applications as commercial,industrial, and automotives areas.

We are looking forward to setting up business relationship with you and hope to provide you with the best service and solution. Let us make a better world for our industry!



## Contact us

Tel: +86-755-8981 8866 Fax: +86-755-8427 6832

Email & Skype: info@chipsmall.com Web: www.chipsmall.com

Address: A1208, Overseas Decoration Building, #122 Zhenhua RD., Futian, Shenzhen, China



# MicroSmart FC6A Plus PLC

CPU Modules



## PRODUCT DESCRIPTION

This next-generation IDEC MicroSmart FC6A Plus PLC performs beyond micro PLC limits. With its 2,060 I/O capacity, it can control large machines or entire small-scale manufacturing facilities, providing more capabilities for the most demanding applications.

## KEY FEATURES

- Dual Ethernet ports
- iOS and Android app
- Maximum 2,060 digital I/O
- Maximum 511 analog I/O
- Bluetooth communication

## FC6A PLUS CPU MODULES

High-speed Counter & Pulse Output	Power	Input	Output	Interface	I/O Points	Part No.
<ul style="list-style-type: none"> <li>• High-speed counter Maximum input frequency: 100kHz</li> <li>• Pulse output (*1) Maximum output frequency: 100kHz</li> </ul>	24V DC	24V DC (Sink/Source)	Relay Output 2A (240V AC-2A, 30V DC-2A)	Port 1 (USB) Port 2 (Ethernet) Port 3 (Ethernet)	16 points (8/8)	FC6A-D16R1CEE
			Transistor Source Output 0.5A			FC6A-D16P1CEE
			Transistor Sink Output 0.5A			FC6A-D16K1CEE
			Transistor Source Output 0.1A		32 points (16/16)	FC6A-D32P3CEE
			Transistor Sink Output 0.1A			FC6A-D32K3CEE

## SPECIFICATIONS

General Specifications

Part No.	FC6A-D16R1CEE FC6A-D16P1CEE FC6A-D16K1CEE	FC6A-D32P3CEE FC6A-D32K3CEE
Rated Power Voltage	24V DC	
Allowable Voltage Range	20.4 to 28.8V DC (including ripple)	
Maximum Power Consumption (CPU module)	FC6A-D16R1CEE: 2.88W (24V DC) FC6A-D16P1CEE: 2.88W (24V DC) FC6A-D16K1CEE: 2.88W (24V DC) FC6A-D32P3CEE: 3.36W (24V DC) FC6A-D32K3CEE: 3.36W (24V DC)	
Inrush Current	35A maximum	
Allowable Momentary Power Interruption	10ms (at rated voltage)	
Operating Temperature	-10 to +55°C (no freezing)	
Storage Temperature	-25 to +70°C (no freezing)	
Relative Humidity	Level RH1 (IEC 61131-2) 10 to 95% (no condensation)	
Altitude	Operation: 0 to 2,000m, 795 to 1,013hPa, Transport: 0 to 3,000m, 701 to 1,013hPa	
Pollution Degree	2 (IEC 60664-1)	
Corrosion Immunity	Free from corrosive gases	
Dielectric Strength	Between power and FE terminals: 500V AC, 1 minute Between transistor output and FE terminals: 500V AC, 1 minute Between power and input terminals: 500V AC, 1 minute Between power and relay output terminals: 2,300V AC, 1 minute Between input and relay output terminals: 2,300V AC, 1 minute	Between input and FE terminals: 500V AC, 1 minute Between relay output and FE terminals: 2,300V AC, 1 minute Between power and transistor output terminals: 500V AC, 1 minute Between input and transistor output terminals: 500V AC, 1 minute



Class Div2  
Hazardous  
Location



## GENERAL SPECIFICATIONS (CON'T)

<b>Insulation Resistance</b>	Between power and FE terminals: 100MΩ or higher (500V DC megger)	Between input and FE terminals: 100MΩ or higher (500V DC megger)
	Between transistor output and FE terminals: 100MΩ or higher (500V DC megger)	Between relay output and FE terminals: 100MΩ or higher (500V DC megger)
<b>Noise Resistance</b>	Between power and input terminals: 100MΩ or higher (500V DC megger)	Between power and transistor output terminals: 100 MΩ or higher (500V DC megger)
	Between power and relay output terminals: 100 MΩ or higher (500V DC megger)	Between input and transistor output terminals: 100 MΩ or higher (500V DC megger)
<b>AC/DC power terminals:</b> 1kV, 50ns to 1μs		
<b>I/O terminals (coupling clamp):</b> 1.5kV, 50ns to 1μs coupling adapter		
<b>Vibration Resistance</b>	5 to 8.4Hz amplitude 3.5mm 8.4 to 150Hz acceleration 9.8m/s <sup>2</sup> (1G), 2 hours per axis on each of three mutually perpendicular axes (IEC 61131-2)	
<b>Shock Resistance</b>	147m/s <sup>2</sup> (15G), 11ms duration, 3 shocks per axis on three mutually perpendicular axes	
<b>Degree of Protection</b>	IP20 (IEC 60529)	
<b>Power Supply Wire</b>	UL1007 AWG24-16, UL2464 AWG24-16, UL1015 AWG20-16	
<b>Grounding Wire</b>	UL1007 AWG16	
<b>Ground</b>	D-type ground (Class 3 ground)	
<b>Mounting</b>	DIN rail or panel mounting	
<b>Weight (approx.)</b>	FC6A-D16R1CEE: 290g	FC6A-D32P3CEE: 255g
	FC6A-D16P1CEE: 275g	FC6A-D32K3CEE: 255g
	FC6A-D16K1CEE: 275g	

## FUNCTION SPECIFICATIONS

<b>Part No.</b>	FC6A-D16R1CEE	FC6A-D32P3CEE (*4)
	FC6A-D16P1CEE (*4)	FC6A-D32K3CEE (*4)
	FC6A-D16K1CEE (*4)	
<b>Control System</b>	Stored program system	
<b>Instruction Words</b>	Basic	42
	Advanced	130
<b>Program Capacity (*1)</b>	800KB (100,000 steps)	
<b>User Program Storage</b>	Serial Flash Memory (100,000 times rewritable)	
<b>Processing Time</b>	Basic Instruction	21μs/1,000 steps
	END Processing (*2)	1ms maximum
<b>I/O Points</b>	Input	8 points
	Output	16 points
<b>Expandable Modules</b>	8 points	16 points
<b>Expandable I/O Points with Expansion Modules</b>	7 modules (*3)	16 points
<b>Expandable I/O Points with Expansion Modules</b>	224 points	
<b>Expandable Modules with Unibody Type Expansion Modules</b>	8 modules	
<b>Expandable I/O Points with Unibody Type Expansion Modules</b>	256 points	
<b>Expandable Modules with Separate Type Expansion Modules (*5)</b>	63 modules (separate type master: 1 module maximum, separate type slave: 10 modules maximum)	
<b>Expandable I/O Points with Separate Type Expansion Modules (*5)</b>	2,016 points	
<b>Internal Relay</b>	15,400 points	
<b>Special Internal Relay</b>	1,600 points	
<b>Shift Register</b>	256 points	
<b>Data Register</b>	60,000 points	
<b>Non-Retentive Data Register</b>	200,000 points	
<b>Special Data Register</b>	900 points	
<b>Counter</b>	512 points	
<b>Timer (1ms, 10ms, 100ms, 1s)</b>	2,000 points	
<b>Clock</b>	Clock accuracy: ±30 sec/month (typical) at 25°C	
<b>RAM Backup</b>	Backup Data	Internal relay, shift register, counter, data register, timer, special data register, special internal relay, clock data
	Battery	Lithium primary battery (BR2032)
	Battery Life	Approx. 4 years
	Replaceability	Possible
<b>Self-diagnostic Function</b>	Keep data, user program sum check (serial flash memory), user program sum check (RAM), timer/counter preset value sum check, user program syntax check, user program execution check, WDT check, user program write check, power failure, clock error, data link connection check, I/O bus initialization check	
<b>Input Filter</b>	0 ms (without filter), 3 to 15ms (selectable in increments of 1ms) I14, I15, I16, I17: 3ms	
<b>Catch Input/Interrupt Input</b>	Six inputs I0, I1, I3, I4, I6, I7 (Minimum turn on pulse width: 5μs max./Minimum turn off pulse width: 5μs max.)	

## USB PORT SPECIFICATIONS

<b>USB Type</b>	USB mini-B
<b>USB Standard</b>	USB 2.0
<b>Isolation</b>	Not isolated from the internal circuit
<b>Communication Function</b>	Maintenance communication to PC

## ETHERNET PORT 1 SPECIFICATIONS

<b>Communication Type</b>	IEEE802.3 compliant
<b>Communication Speed</b>	10BASE-T, 100BASE-TX
<b>Connector</b>	RJ45
<b>Cable</b>	CAT.5STP
<b>Maximum Cable Length</b>	100m
<b>Isolation</b>	Pulse trans isolation
<b>Communication Function</b>	Maintenance communication (server), user communication (server/client), user communication UDP, Modbus TCP (server/client), Email, Web Server, PING, SNT, FTP server/client

## ETHERNET PORT 2 SPECIFICATIONS

<b>Communication Type</b>	IEEE802.3 compliant
<b>Communication Speed</b>	10BASE-T, 100BASE-TX
<b>Connector</b>	RJ45
<b>Cable</b>	CAT.5STP
<b>Maximum Cable Length</b>	100m
<b>Isolation</b>	Pulse trans isolation
<b>Communication Function</b>	Maintenance communication (server), user communication (server/client), user communication UDP, Modbus TCP (server/client), PING

## FUNCTION SPECIFICATIONS (CON'T)

High-speed Counter	Maximum Counting Frequency and High-speed Counter Points	Total 6 points Single/two-phase selectable: 100kHz (single-phase: 6 points, two-phase: 3 points)
	Counting Range	0 to 4,294,967,295 (32 bits)
	Operation Mode	Rotary encoder mode, adding counter mode, frequency measurement mode
Analog Potentiometer	Quantity	1 point
	Data Range	0 to 1,000
Analog Voltage Input	Quantity	1 point
	Input Voltage Range	0 to 10V
	Input Impedance	Approx. 100KΩ
	Digital Resolution	Approx. 4,000 steps (12 bits)
Pulse Output (transistor output model only)	Quantity	4 points
	Maximum Output Pulse Frequency	Q0, Q2, Q4, Q6: 100kHz
	Reversible Control	Single-pulse output mode: 4 axis (Q0-Q7), Dual-pulse output mode: 4 axis (Q0-Q7)
	PWM Output	Duty cycle 0.1 to 100.0% (increments of 0.1%), Output pulse frequency 15 to 5,000 Hz (increments of 1 Hz): 4 points (Q0, Q2, Q4, Q6) (Adjust 5μs minimum as ON time and 15μs minimum as OFF time.)
USB Port		USB mini-B (maintenance communication)
Ethernet Port 1		Maintenance communication (server), user communication TCP (server/client), user communication UDP, Modbus TCP (server/client), Email, Web Server, PING, SNMP, FTP server/client
Ethernet Port 2		Maintenance communication (server), user communication TCP (server/client), user communication UDP, Modbus TCP (server/client), PING
Cartridge (option)		Two cartridges can be added (when using FC6A-HPH1)/One cartridge can be added (when using FC6A-PH1)
SD Card Slot		Embedded
HMI Module (option)		Yes

\*1: 1 step equals 8 bytes.

\*2: Not including expansion I/O service time, counter timer processing time, data link processing time, and interrupt processing time.

\*3: A maximum of 5 modules can be connected when using the expansion interface module separate type master.

\*4: Transistor output model

\*5: Communication module cannot be connected.

## INPUT SPECIFICATIONS

Part No.	FC6A-D16R1CEE FC6A-D16P1CEE FC6A-D16K1CEE	FC6A-D32P3CEE FC6A-D32K3CEE
Input Points	8 (8/1 common)	16 (16/1 common)
Rated Input Voltage	24V DC: 24V DC sink/source input signal	
Input Voltage Range	0 to 28.8V DC	
Rated Input Current	High speed input port 5mA/pt, middle/normal speed input port 7mA/pt	
Input Impedance	High speed input port 4.9kΩ, middle/normal speed input port: 3.4kΩ	
Input Delay	Turn ON Time	High speed input port: 5μs + filter value Middle speed input port: 35μs + filter value Normal speed input port: 35μs + filter value
	Turn OFF Time	High speed input port: 5μs + filter value Middle speed input port: 35μs + filter value Normal speed input port: 100μs + filter value
Isolation	Between input terminals: Not isolated Internal circuit: Optocoupler-isolated	
Input Type	Type1 (IEC 61131-2)	
External Load for I/O Interconnection	Not needed	
Signal Determination Method	Static	
Effect of Improper Input Connection	Both sinking and sourcing input signals can be connected, therefore reverse connection does not cause damage. If any input exceeding the rated value is applied, permanent damage may be caused.	
Cable Length	3m in compliance with electromagnetic immunity	
Connector	Insertion Durability	100 times minimum
	Applicable Ferrule	1-wire: AI 0.5-8 WH (Phoenix Contact) 2-wire: AI-TWIN 2x0.5-8 WH (Phoenix Contact)

## RELAY OUTPUT SPECIFICATIONS

Part No.	FC6A-D16R1CEE	
Relay Output Points	8	
Output Points per Common Line	COM1	4
	COM2	4
Output Type	1NO	
Maximum Load Current	Per Point	2A
	Per Common	COM1: 7A COM2: 7A
Minimum Switching Load	1mA/5V DC (reference value)	
Initial Contact Resistance	30mΩ maximum	

## RELAY OUTPUT SPECIFICATIONS (CON'T)

Electrical Life		100,000 operations minimum (rated resistive load 1,800 operations/hour)
Mechanical Life		20,000,000 operations minimum (no load 18,000 operations/hour)
Rated Load		Resistive load: 240V AC 2A, 30V DC 2A Inductive load: 240V AC 2A (cos $\phi = 0.4$ ), 30V DC 2A (L/R = 7 ms)
Connector	Insertion/Removal Durability	100 times minimum
	Applicable Ferrule	1-wire: AI 0.5-8 WH (Phoenix Contact) 2-wire: AI-TWIN 2x0.5-8 WH (Phoenix Contact)

## TRANSISTOR OUTPUT SPECIFICATIONS

Part No.		FC6A-C16P1CEE FC6A-C16K1CEE	FC6A-D32P3CEE FC6A-D32K3CEE
Transistor Output Points		8 (8/1 common)	16 (16/1 common)
Output Type	Transistor Sink	FC6A-D16K1CEE/FC6A-D32K3CEE	
	Transistor Source	FC6A-D16P1CEE/FC6A-D32P3CEE	
Rated Load Voltage		24V DC	
Voltage Tolerance		19.2 to 28.8V DC	
Rated Load Current	Per Point	0.5A	0.1A
	Per Common	4.0A	1.6A
Output Delay	Turn ON Time	High speed input port: 5 $\mu$ s Normal speed input port: 300 $\mu$ s	
	Turn OFF Time	High speed input port: 5 $\mu$ s Normal speed input port: 300 $\mu$ s	
Isolation		Between output terminal and Internal circuit: Optocoupler-isolated Between output terminals: Not isolated	
Voltage Drop (ON Voltage)		1V max (voltage between COM and output terminal when output is on.)	
Inrush Current		1A	0.2A
Leakage Current		0.1mA maximum	
Clamping Voltage		39V $\pm$ 1V	
Maximum Lamp Load		12W	2.4W
Inductive Load		L/R=10ms (28.8V DC, 1Hz)	
Overcurrent Protection		Transistor Sink Output: No Transistor Source Output: Overcurrent is detected by current limit resistance. (*1)	
External Current Draw		100mA maximum, 24V DC (power voltage at the +V terminal, -V terminal at source)	
Connector	Insertion Durability	100 times minimum	
	Applicable Ferrule	1-wire: AI 0.5-8 WH (Phoenix Contact) 2-wire: AI-TWIN 2x0.5-8 WH (Phoenix Contact)	—

\*1: This overcurrent signals consist of one signal per 4 point outputs. When microprocessor gets this overcurrent signal by interrupt input, microprocessor turns off 4pt outputs of this category at fixed time (approx. 1sec).

## DIMENSIONS (mm)

Plus CPU Modules

FC6A-D16R1CEE  
FC6A-D16K1CEE  
FC6A-D16P1CEE

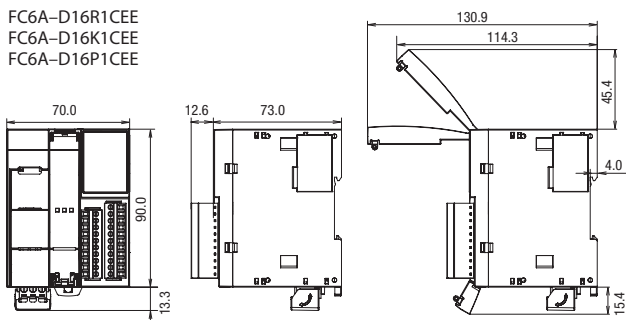

FC6A-D32K3CEE  
FC6A-D32P3CEE

