



Chipsmall Limited consists of a professional team with an average of over 10 year of expertise in the distribution of electronic components. Based in Hongkong, we have already established firm and mutual-benefit business relationships with customers from,Europe,America and south Asia,supplying obsolete and hard-to-find components to meet their specific needs.

With the principle of “Quality Parts,Customers Priority,Honest Operation,and Considerate Service”,our business mainly focus on the distribution of electronic components. Line cards we deal with include Microchip,ALPS,ROHM,Xilinx,Pulse,ON,Everlight and Freescale. Main products comprise IC,Modules,Potentiometer,IC Socket,Relay,Connector.Our parts cover such applications as commercial,industrial, and automotives areas.

We are looking forward to setting up business relationship with you and hope to provide you with the best service and solution. Let us make a better world for our industry!



Contact us

Tel: +86-755-8981 8866 Fax: +86-755-8427 6832

Email & Skype: info@chipsmall.com Web: www.chipsmall.com

Address: A1208, Overseas Decoration Building, #122 Zhenhua RD., Futian, Shenzhen, China



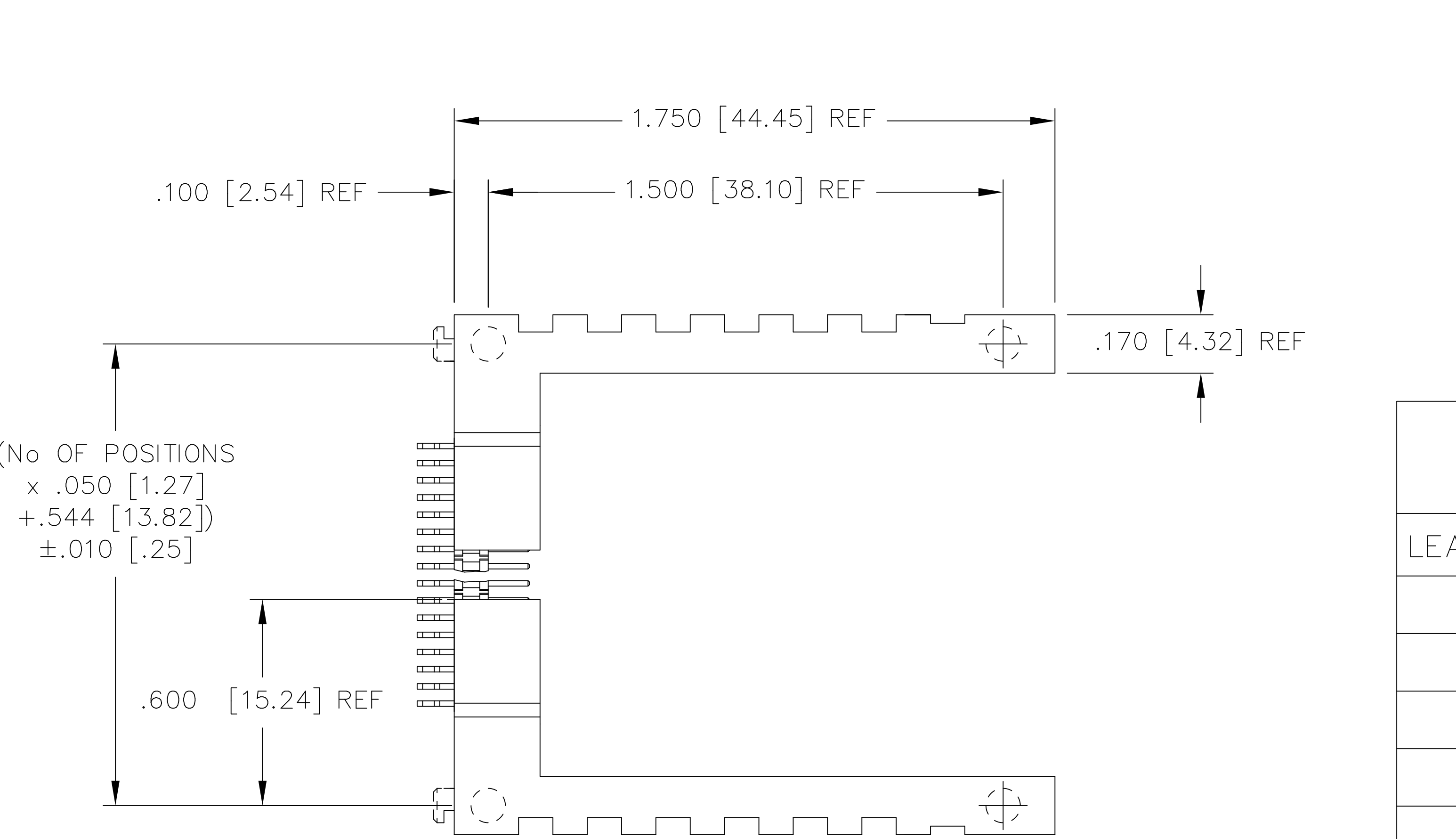
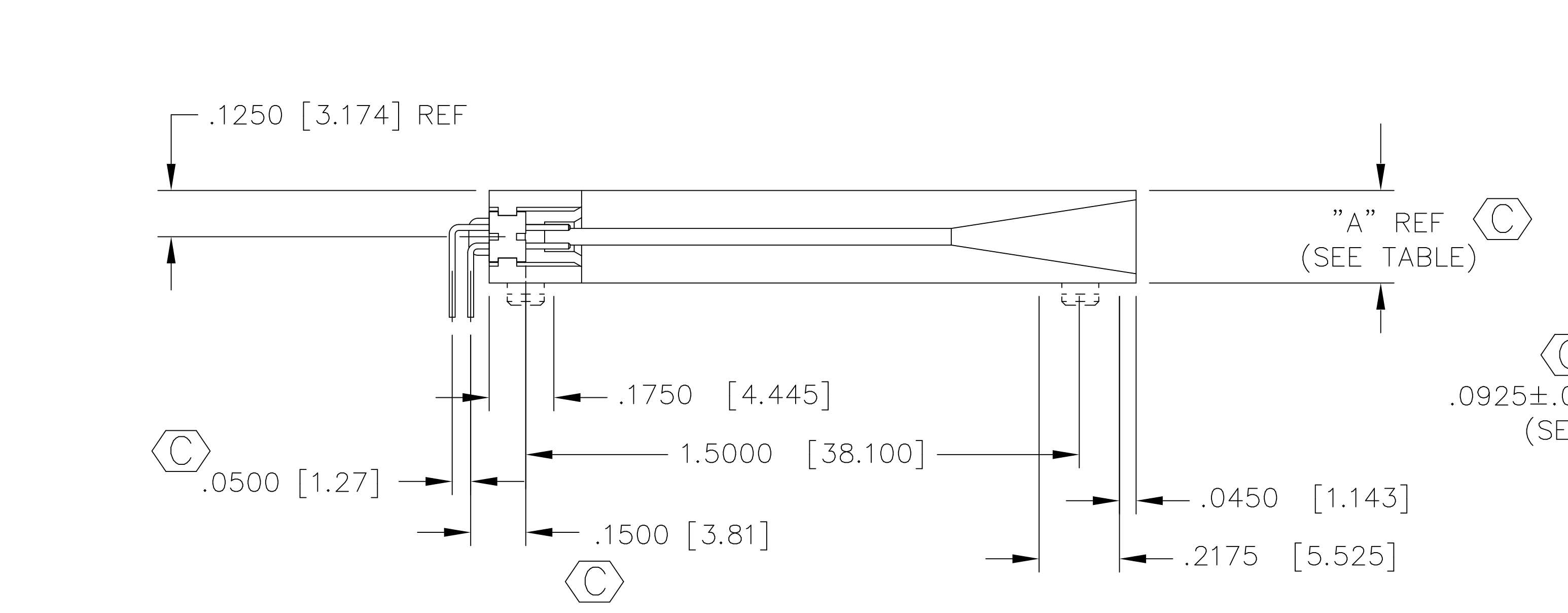
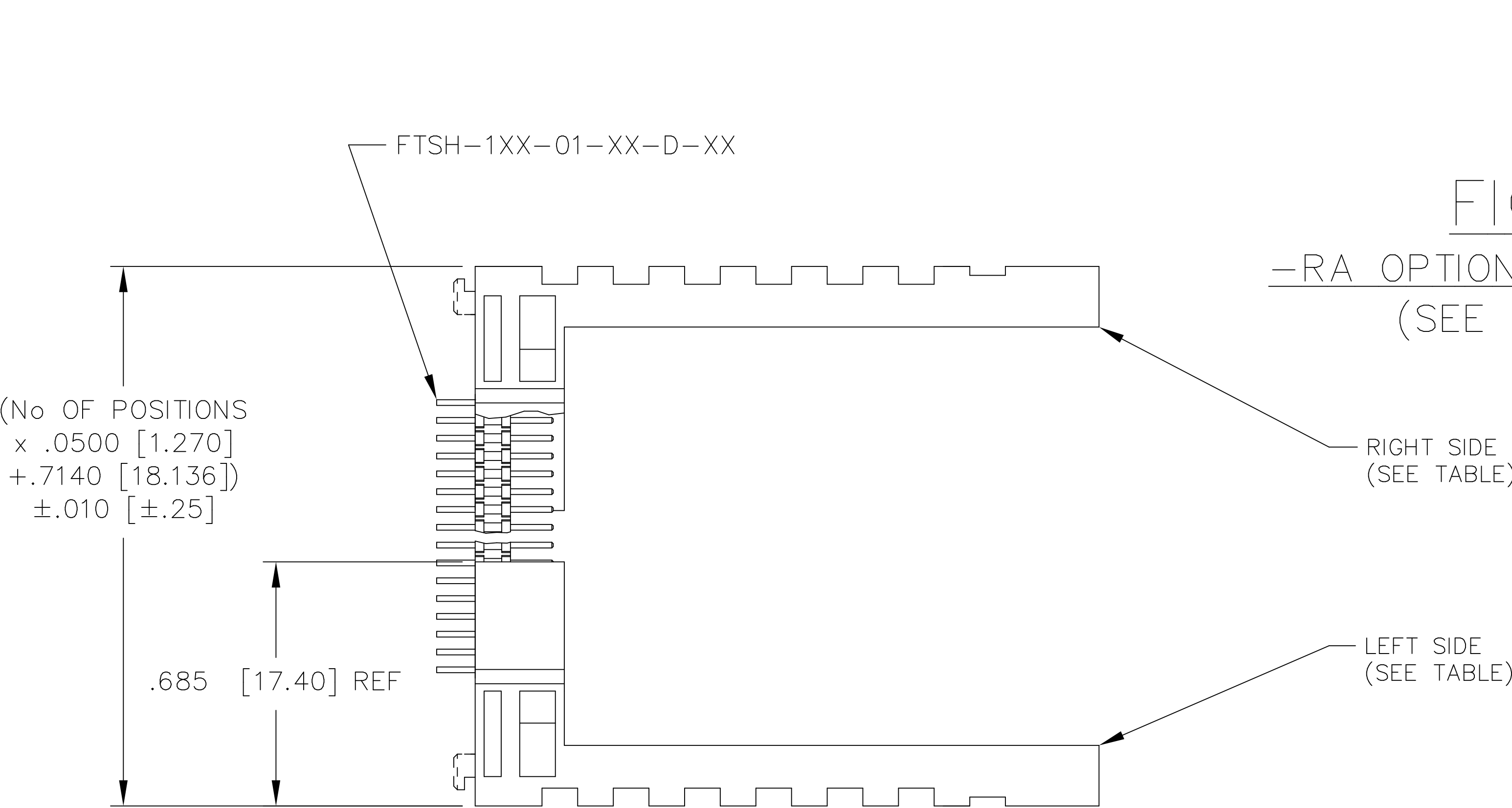
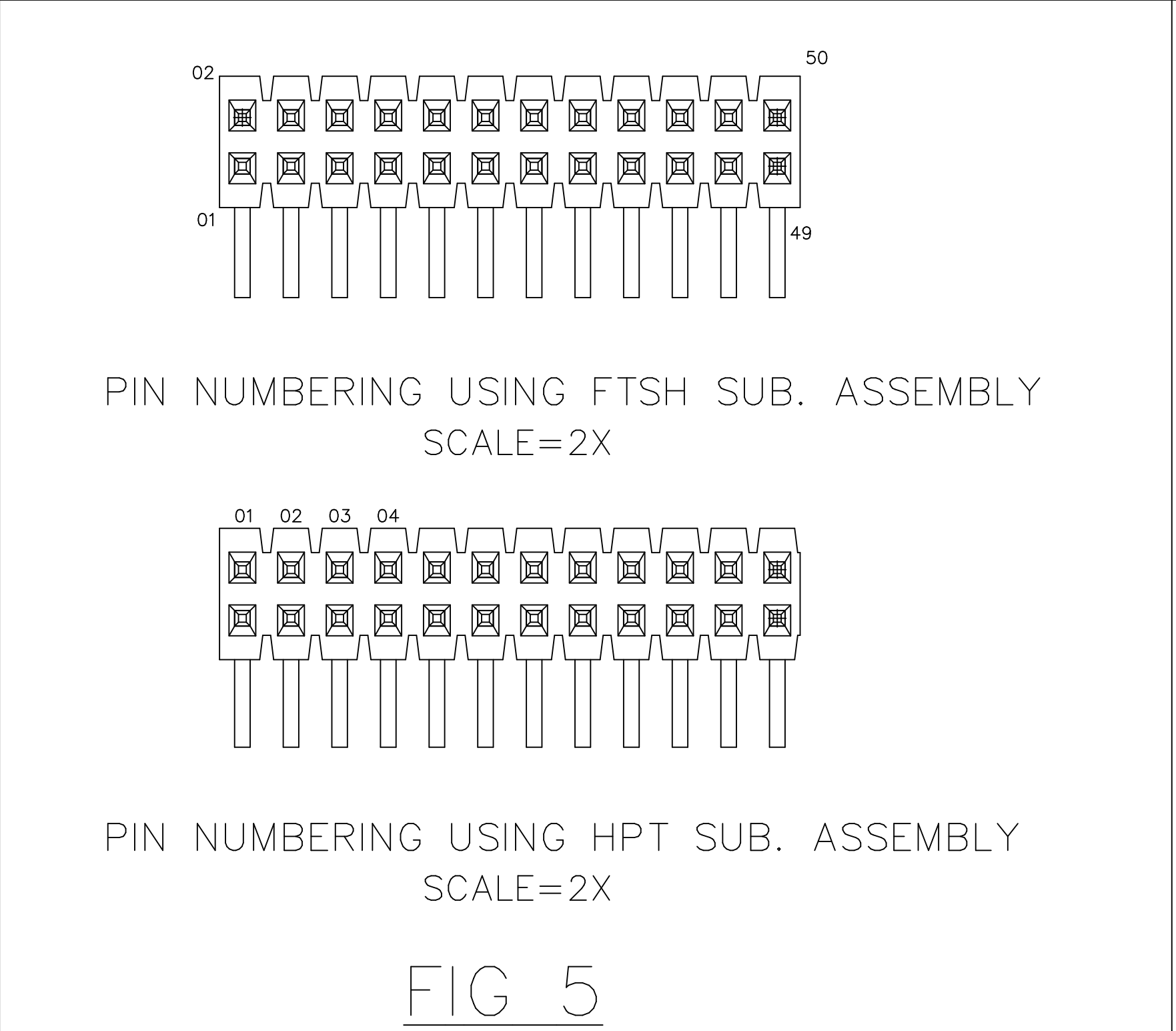
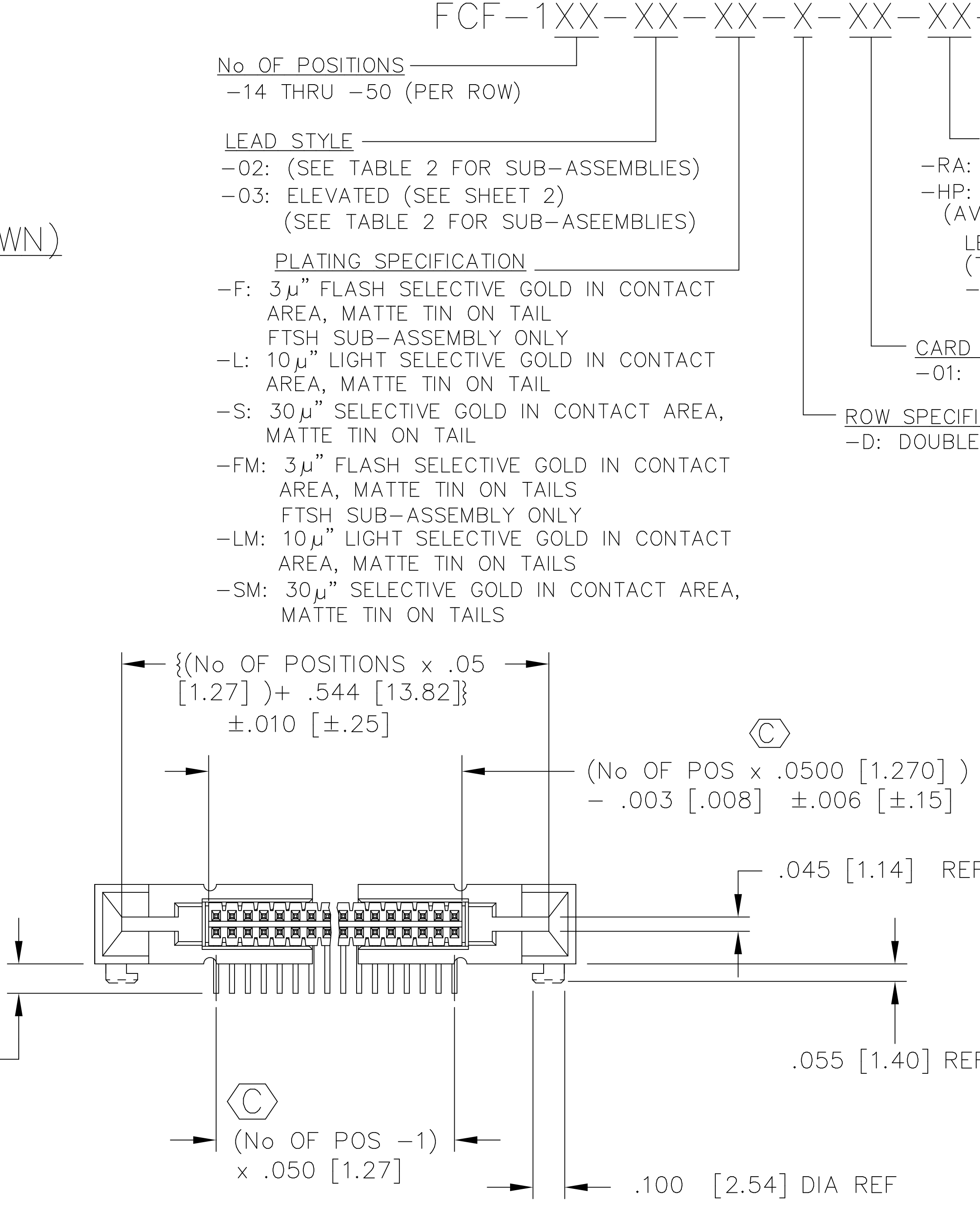
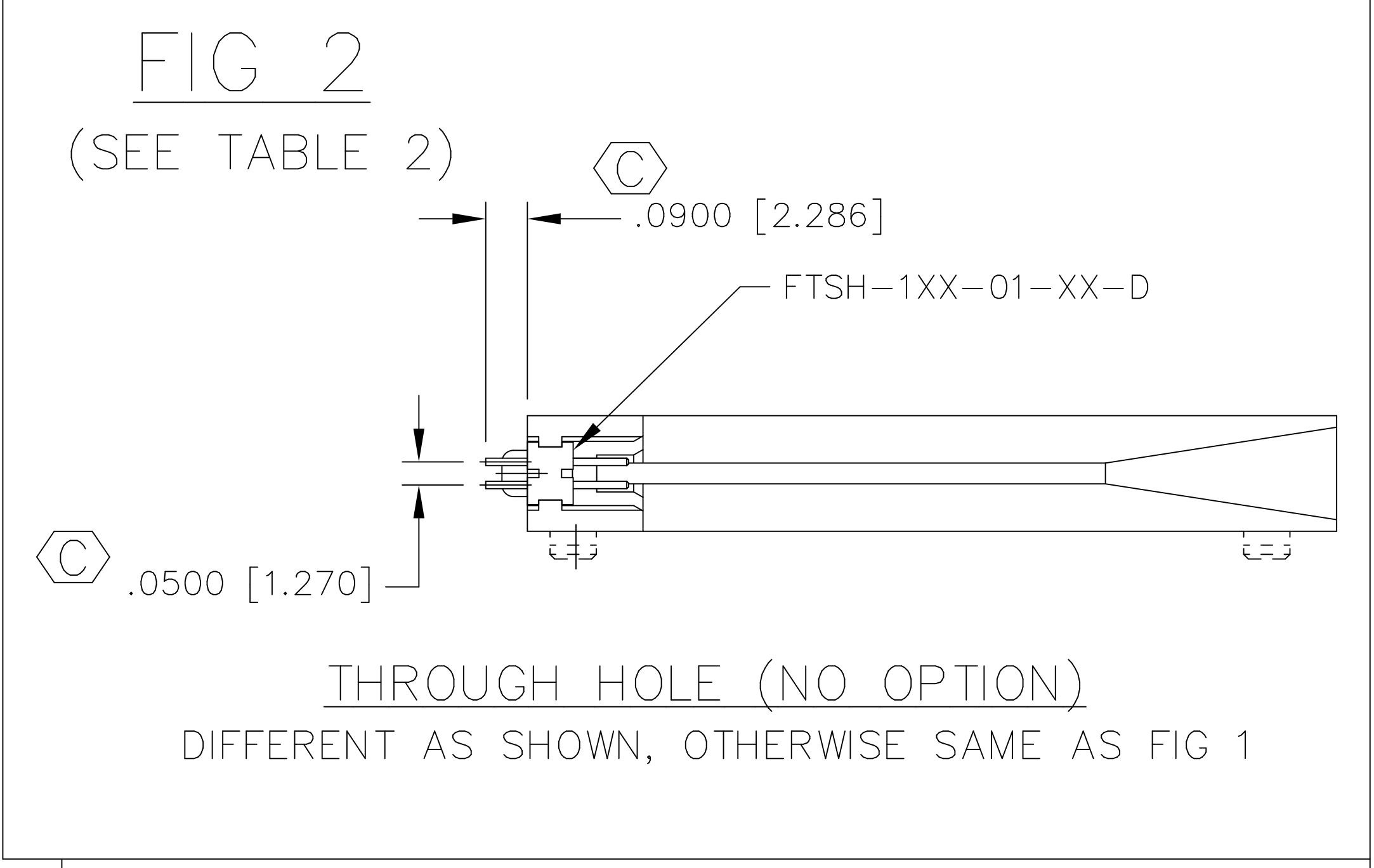

TABLE 2 (SEE NOTE-4 AND -5)		
LEAD STYLE	TAIL OPTION	* SUB-ASSEMBLY
-02	-RA	FTSH-1XX-01-XX-D-FC
-03	-RA	FTSH-1XX-01-XX-D-FE
-02	-HP (25 POS.)	HPT-125-01-XX-D-FC
-03	-HP (25 POS.)	HPT-125-01-XX-D-FE
-02	-HP (34 POS.)	HPT-134-01-XX-D-FC
-03	-HP (34 POS.)	HPT-134-01-XX-D-FE
-02	THROUGH HOLE	FTSH-1XX-01-XX-D



- NOTE:
- ALL PARTS TO BE LAYER PACKAGED WITH THE EXCEPTION OF -RA.
-RA PARTS ARE TO BE PACKAGED IN TRAYS.
 - FOR FINISHED INSPECTION ONLY, MEASURE FROM
BOTTOM OF BODY TO TIP OF PIN.
 - Ⓢ REPRESENTS A CRITICAL DIMENSION.
 - Ⓢ ALL FTSH SUB-ASSEMBLIES MUST HAVE .120 POST.
 - SEE TABLE 2 SHEET 1 OF SUB-ASSEMBLY PRINT FOR
TAIL SHEAR DIMENSION.



PROPRIETARY NOTE
THIS DOCUMENT CONTAINS INFORMATION
CONFIDENTIAL AND PROPRIETARY TO
SAMTEC INC. AND SHALL NOT BE
REPRODUCED OR TRANSFERRED TO
OTHER DOCUMENTS OR DISCLOSED TO
OTHERS OR USED FOR ANY PURPOSE
OTHER THAN THAT FOR WHICH IT WAS
OBTAINED WITHOUT THE EXPRESSED
WRITTEN CONSENT OF SAMTEC INC.

TABLE 1					
LEAD STYLE	"A"	RIGHT (SL OPTION)	RIGHT (NO OPTION)	LEFT (SL OPTION)	LEFT (NO OPTION)
-02	.250	CGD-050-R-02-SL	CGD-050-R-02	CGD-050-L-02-SL	CGD-050-L-02
-03	.375	CGD-050-R-03-SL	CGD-050-R-03	CGD-050-L-03-SL	CGD-050-L-03

EXISPROD\ASSEMBLY\050
FCF-ASM

samtec

520 PARK EAST BLVD. NEW ALBANY,INDIANA 47150
PHONE (812) 944-6733 P.O. BOX 1147
CODE 55322

MADE BY: PURVIS 12-17-96

FCF-1XX-XX-XX-X-XX-XX-X
SHEET 1 OF 3