



Chipsmall Limited consists of a professional team with an average of over 10 year of expertise in the distribution of electronic components. Based in Hongkong, we have already established firm and mutual-benefit business relationships with customers from,Europe,America and south Asia,supplying obsolete and hard-to-find components to meet their specific needs.

With the principle of “Quality Parts,Customers Priority,Honest Operation,and Considerate Service”,our business mainly focus on the distribution of electronic components. Line cards we deal with include Microchip,ALPS,ROHM,Xilinx,Pulse,ON,Everlight and Freescale. Main products comprise IC,Modules,Potentiometer,IC Socket,Relay,Connector.Our parts cover such applications as commercial,industrial, and automotives areas.

We are looking forward to setting up business relationship with you and hope to provide you with the best service and solution. Let us make a better world for our industry!



Contact us

Tel: +86-755-8981 8866 Fax: +86-755-8427 6832

Email & Skype: info@chipsmall.com Web: www.chipsmall.com

Address: A1208, Overseas Decoration Building, #122 Zhenhua RD., Futian, Shenzhen, China



ASSEMBLY INSTRUCTIONS:

- A) Find desired location on door, panel or body to mount shelf.
- B) Open shelf (item 1) to open and locked position (see open steps below) and locate the shelf onto mounting surface. Check to see if shelf is level.
- C) Using the mounting plate as a template mark and CTR punch the hole locations. Drill thru using .281" (7.1mm) dia. drill bit.
- D) Mount shelf using 1/4-20 screw and sealing washer (items 2 & 3) thru holes in mounting surface. Use oversized washer and 1/4-20 KEP nut (items 4 & 5) on inside of mounting plate to secure.
- E) Open and close shelf as shown below

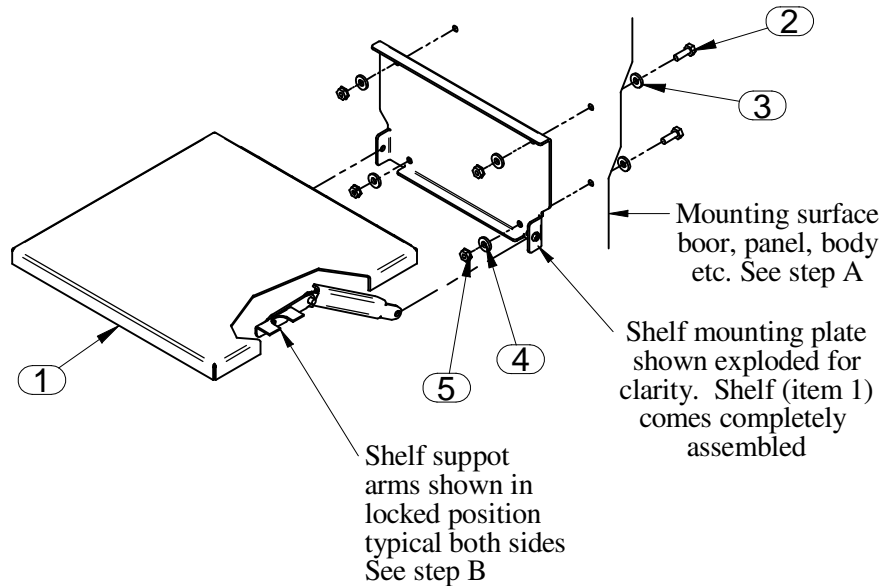

3. Once shelf is in position insure that shelf support is locked before placing objects on it.

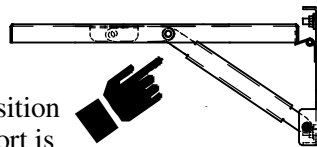

**T
O
O
P
E
N**

2. While lifting shelf into position guide both shelf support arms up and towards rear of shelf

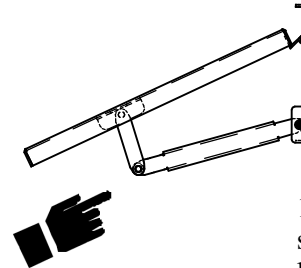

1. To close pull both support arms out of locked position down towards floor

**T
O
C
L
O
S
E**

1. Pull shelf out from closed position

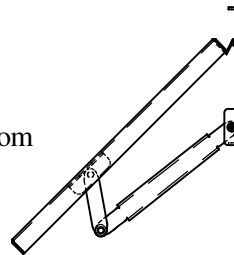

2. Push shelf into closed position

PARTS LIST		
ITEM No.	DESCRIPTION	QTY
1	FLIP UP SHELF	1
2	1/4-20 X 3/4 SCREWS	4
3	1/4 SEALING WASHER	4
4	1/4 OVERSIZED	4
5	1/4-20 KEP NUTS	4

TOOL BOX

