



Chipsmall Limited consists of a professional team with an average of over 10 year of expertise in the distribution of electronic components. Based in Hongkong, we have already established firm and mutual-benefit business relationships with customers from,Europe,America and south Asia,supplying obsolete and hard-to-find components to meet their specific needs.

With the principle of "Quality Parts,Customers Priority,Honest Operation,and Considerate Service",our business mainly focus on the distribution of electronic components. Line cards we deal with include Microchip,ALPS,ROHM,Xilinx,Pulse,ON,Everlight and Freescale. Main products comprise IC,Modules,Potentiometer,IC Socket,Relay,Connector.Our parts cover such applications as commercial,industrial, and automotives areas.

We are looking forward to setting up business relationship with you and hope to provide you with the best service and solution. Let us make a better world for our industry!



Contact us

Tel: +86-755-8981 8866 Fax: +86-755-8427 6832

Email & Skype: info@chipsmall.com Web: www.chipsmall.com

Address: A1208, Overseas Decoration Building, #122 Zhenhua RD., Futian, Shenzhen, China



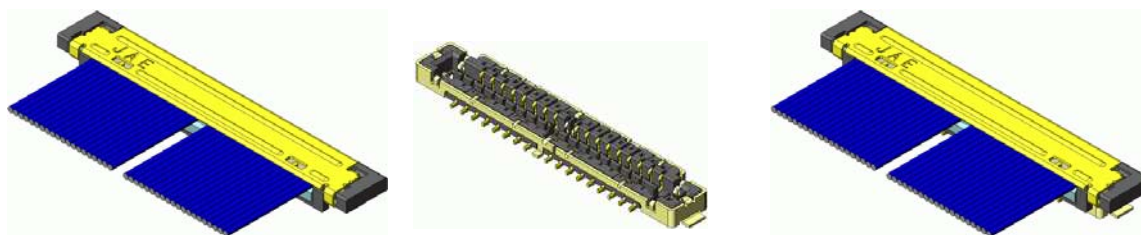

FI-JW Series

RoHS Compliant

The FI-JW Series is a compact, low profile connector with a plug that can pass through a very small diameter hinge after harness assembly.

Features

- Plug side can pass through a 3.7mm dia. hinge after harness assembly (40 pos., 42 AWG)
- Mated dimensions of 3.2mm depth, 17.3mm width (40 pos.), 1.65mm height
- Stable connection by a secure 0.35 mm effective contact length.
- Enhanced connection stability with gold plated ground contact points on plug and receptacle
- Mis-mating prevention structure
- Enhanced noise resistance characteristic with 6 ground contact points between plug and receptacle
- Applicable wire: compatible with 42 and 44 AWG fine-coaxial wire
- Supports automated mounting with embossed tape for receptacle
- Solder migration prevention structure with Ni barrier on receptacle

General Specifications

- | | |
|-----------------------------------------------------|----------------------------------------------------------------|
| ■No. of Contacts: 30, 34, 40, 50 pos. | ■Rated Current: AC, DC each 0.25A per pos. |
| ■Pitch: 0.3mm | ■Rated Voltage: AC, DC each 50V per pos. |
| ■Operating Temperature:
-40 Deg. C to +85 Deg. C | ■Insulation Resistance: 100M ohm min. |
| ■Contact Resistance:
40m ohm max. (initial) | ■Dielectric Withstanding Voltage :
AC 100Vr. m.s per minute |
| ■Durability: 30 mating cycles | ■Applicable Wire: 42 to 44 AWG |

Materials and Finishes

Component	Material / Finish
Receptacle (FI-JW**S-VF16)	
Contact	Copper alloy / Contact area Au plating over Ni, Terminal area Au flash plating over Ni
Shell	Copper alloy / Contact area Au plating over Ni
Insulator	Heat resistant plastic UL94V-0
Adsorption Insulator	Heat resistant plastic UL94V-0
Plug (FI-JW**C)	
Contact	Copper alloy / Contact area Au plating over Ni, Terminal area Au flash plating over Ni
Insulator	Heat resistant plastic UL94V-0
Plug / Base Ground Bar (FI-JW**C-BGB-**)	
Base Ground Bar	Stainless steel / Contact area Au plating over Ni Terminal area Sn plating over Ni
Plug / Cover Ground Bar (FI-JW**C-CGB-**)	
Cover Ground Bar	Copper alloy / Sn plating over Ni
Plug / Cover Shell (FI-JW**C-SH1)	
Cover shell	Stainless steel / Au flash plating over Ni

Ordering Information

Receptacle Side
Individual Product
(30, 34, 50 pos. : SJ106817)

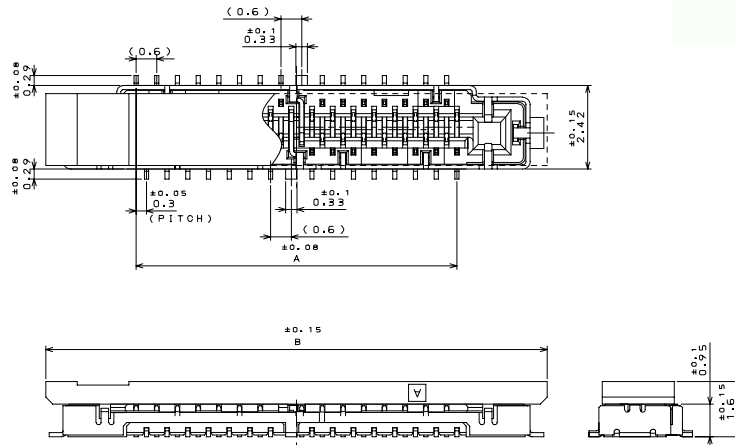
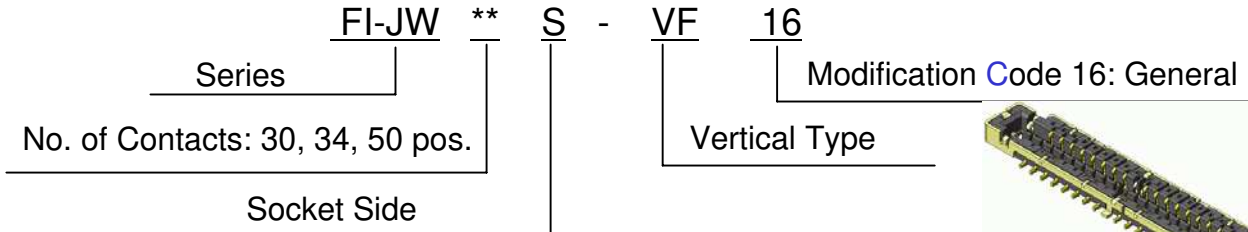

Unit: mm

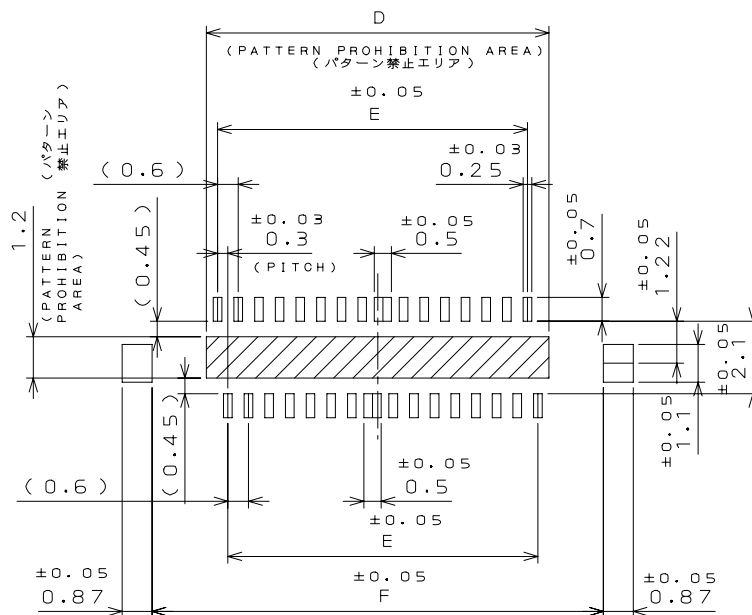

Recommended dimensions of board

Dimensions

DIMENSIONS 寸法 NO. OF CONTACTS 芯数	A	B	C	D	E	F
	30	9.3	14.53	13.54	9.95	9
34	10.5	15.73	14.74	11.15	10.2	14.3
50	15.3	20.53	19.54	15.95	15	19.1

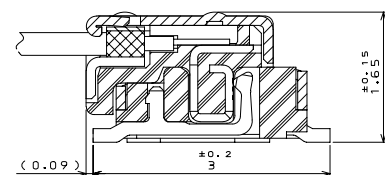

Drawing when mated
(for reference)

Ordering Information

Receptacle Side Individual Product (40 pos. : SJ106319)

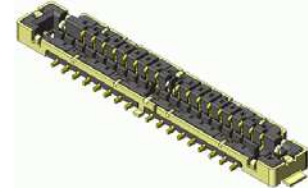
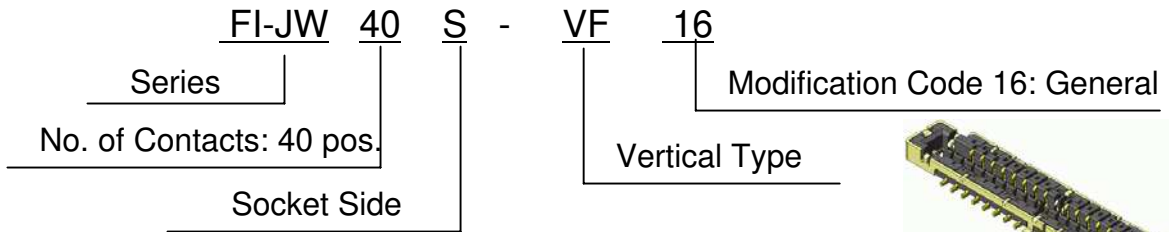

Unit: mm

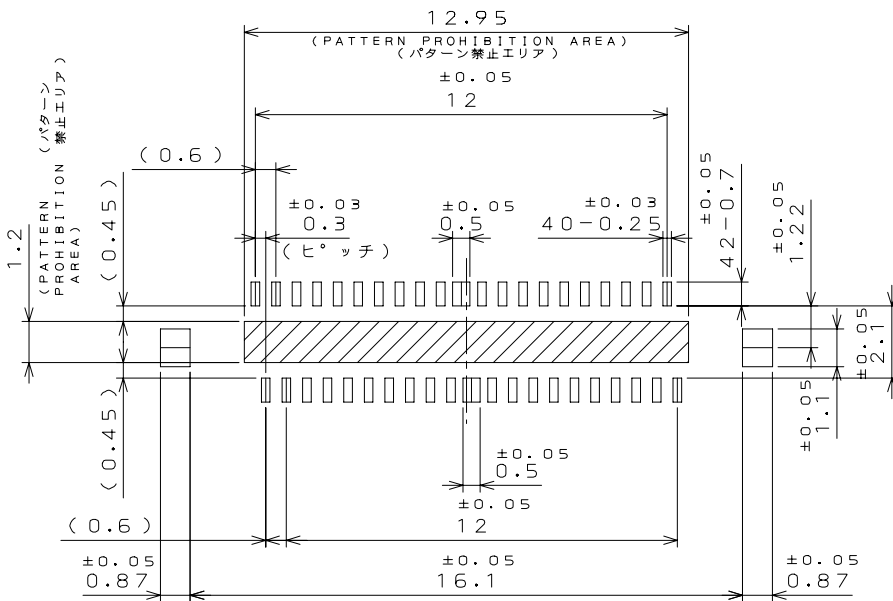
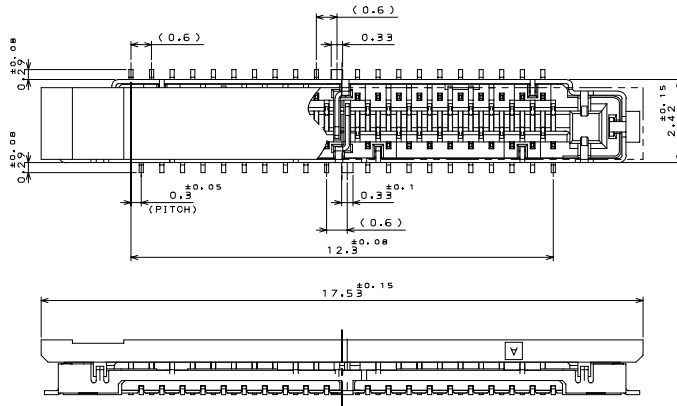

Recommended dimensions of board

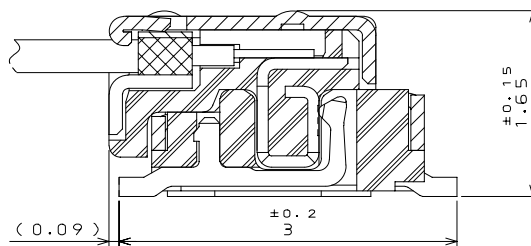

Drawing when mated (for reference)

Ordering Information

Receptacle Side
Emboss Product
(30, 34, 50 pos. : SJ106818)

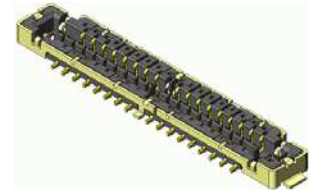
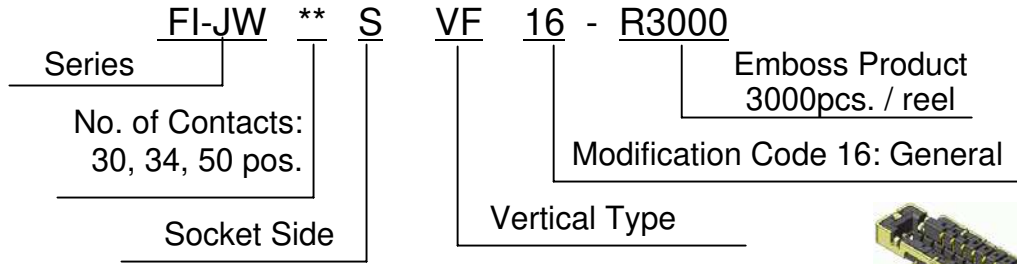

Unit: mm

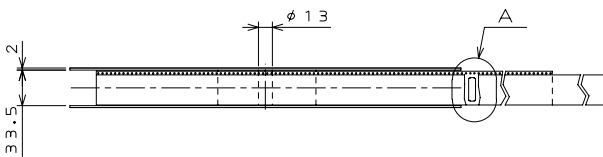

Dimensions

DIMENSIONS 寸法	A	B	C
NO. OF CONTACTS 芯数			
30	11.3	10	15.2
34	12.5	11.2	16.4
50	17.3	16	21.2

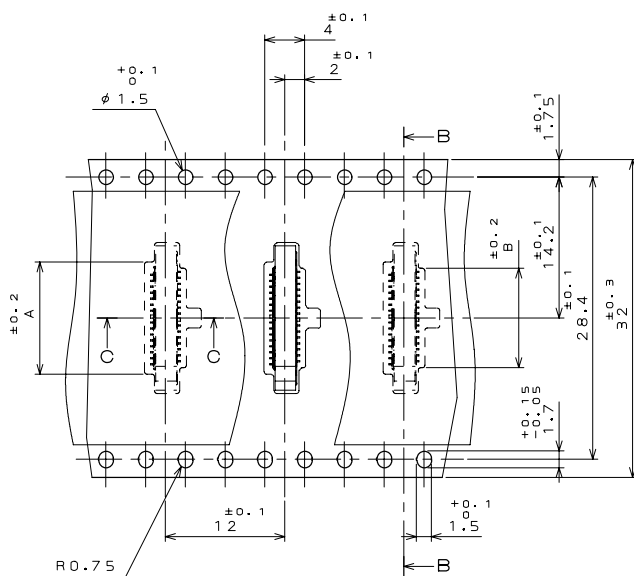
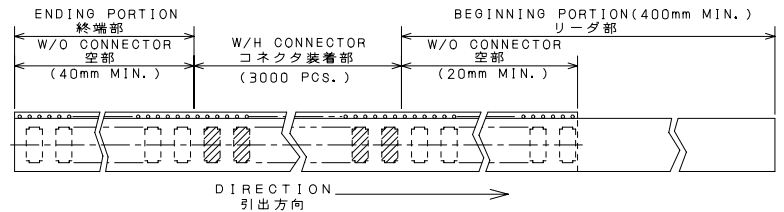
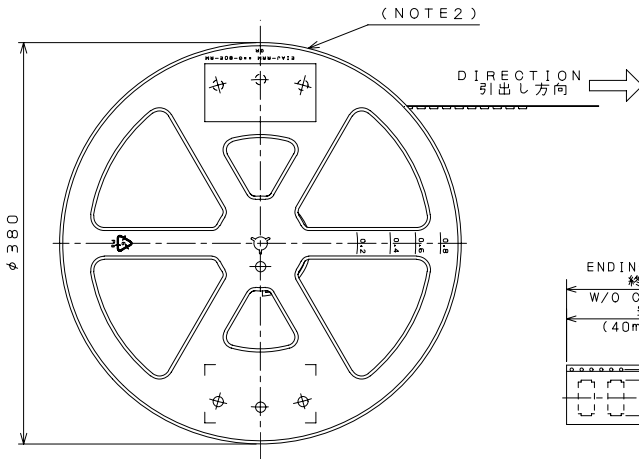

DETAIL A
(SCALE 2:1)

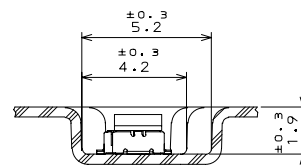

SECT. C-C
(SCALE 5:1)

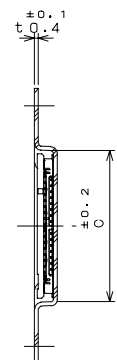

SECT. B-B
(SCALE 2:1)

Ordering Information

Receptacle Side
 Emboss Product
 (40 pos. : SJ106320)

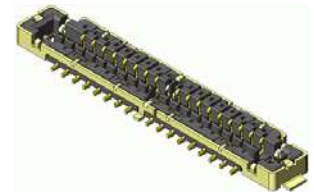
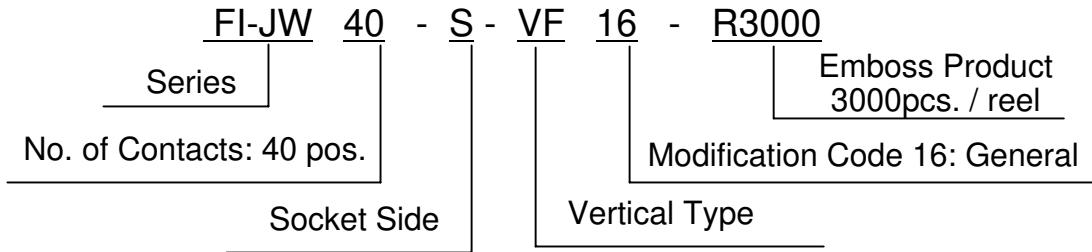

Unit: mm

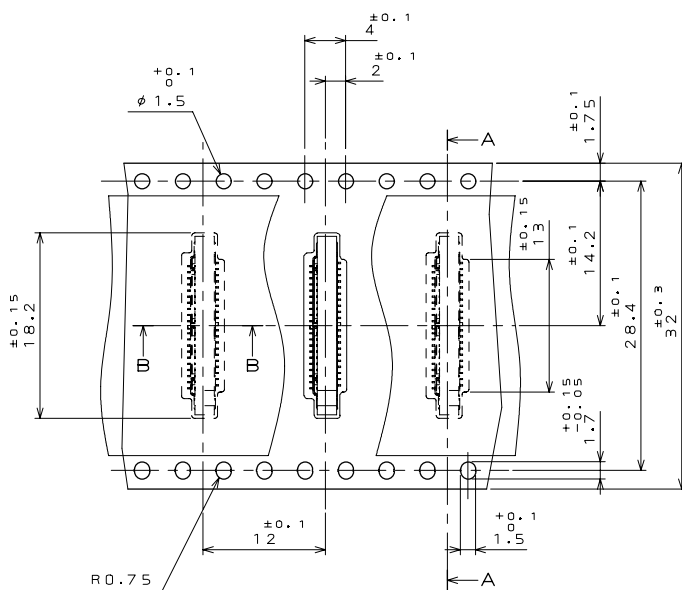
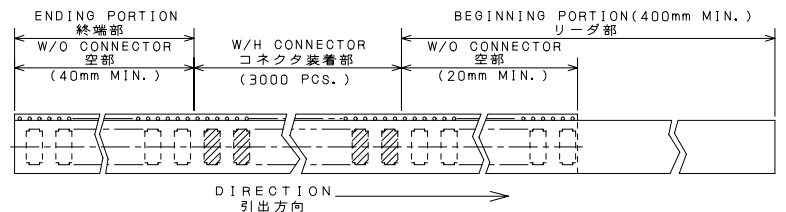
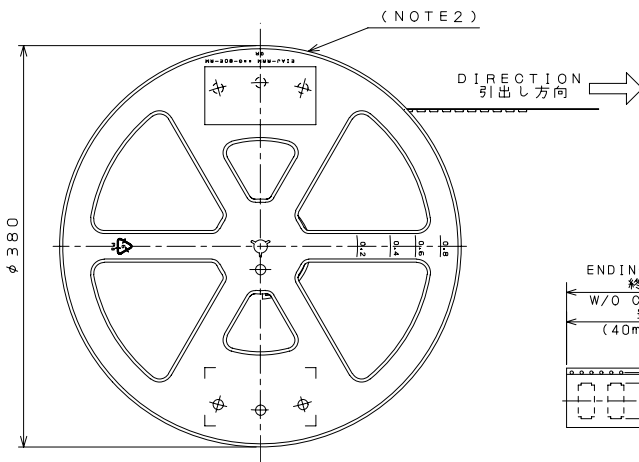
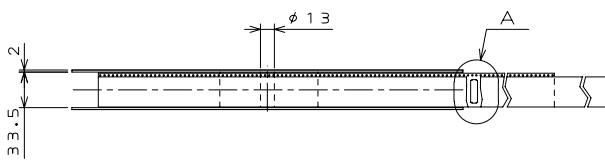

DETAIL A
 (SCALE 2:1)

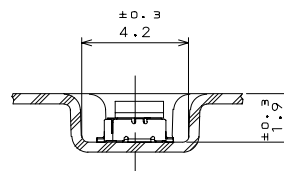

SECT. C-C
 (SCALE 5:1)

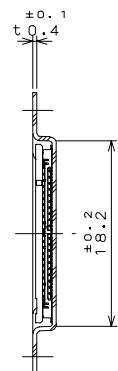

SECT. B-B
 (SCALE 2:1)

Ordering Information

Plug Side, Insulator (SJ106335)

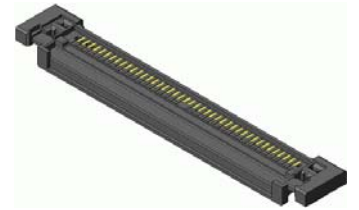
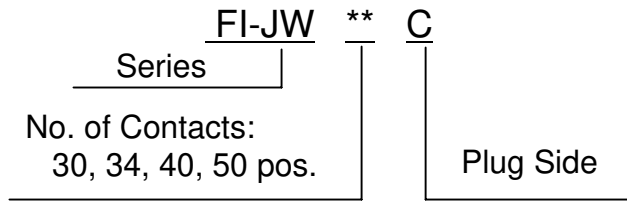

Unit: mm

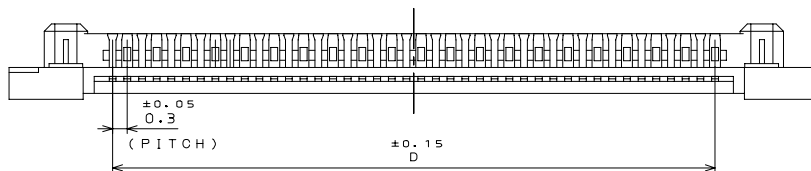
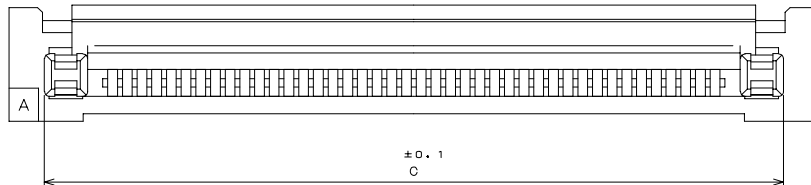
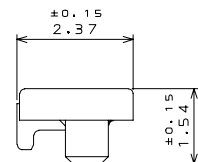
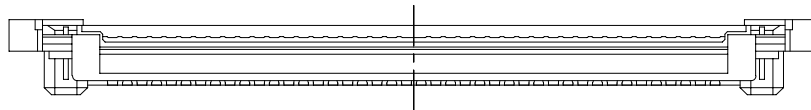
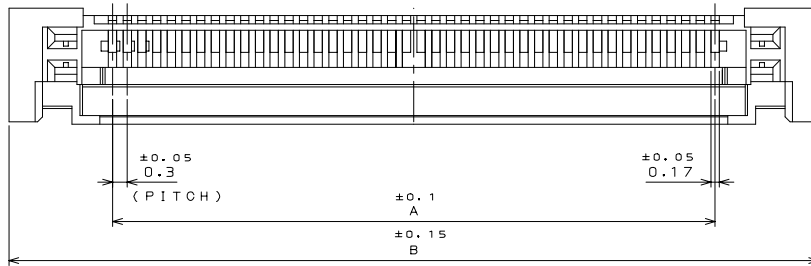

Dimensions

No. OF CONTACTS (N)	30	34	40	50
A	9.3	10.5	12.3	15.3
B	13.53	14.73	16.53	19.53
C	12.09	13.29	15.09	18.09
D	9.3	10.5	12.3	15.3

Ordering Information

Plug Side, Insulator
Emboss Product (SJ10336)

Series **FI-JW** ** C - **R3000**
 No. of Contacts: 30, 34, 40, 50 pos. Emboss Product 3000pcs. / reel
 Plug Side



Unit: mm

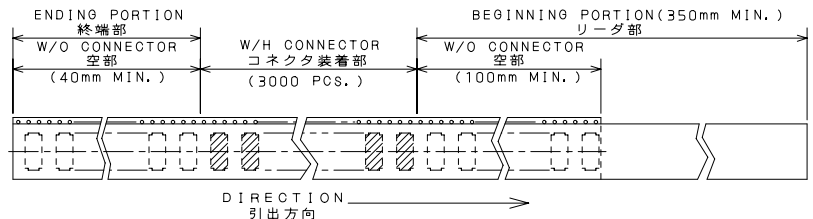
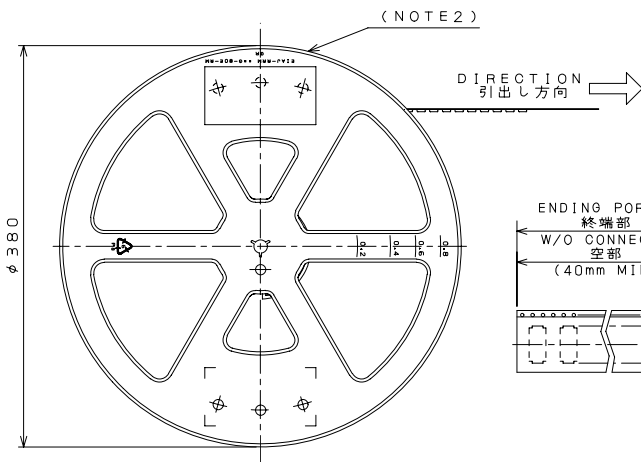
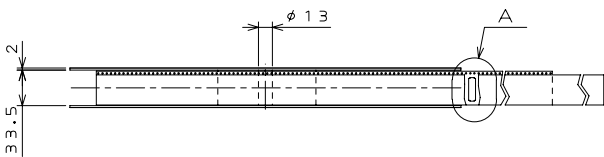

NO. OF CONTACTS 芯数	DIMENSIONS 寸法	A
30		13.9
34		15.1
40		16.9
50		19.9

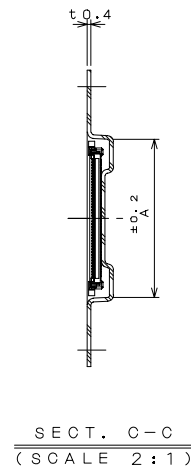
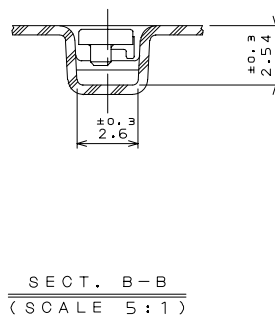
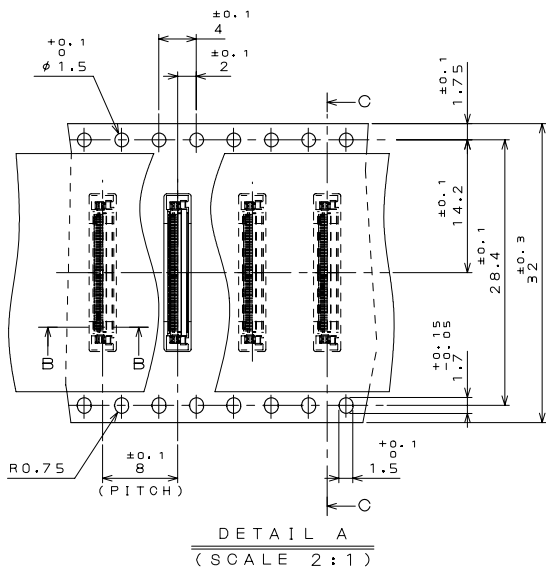

Ordering Information

Plug Side, Shell (SJ106357)

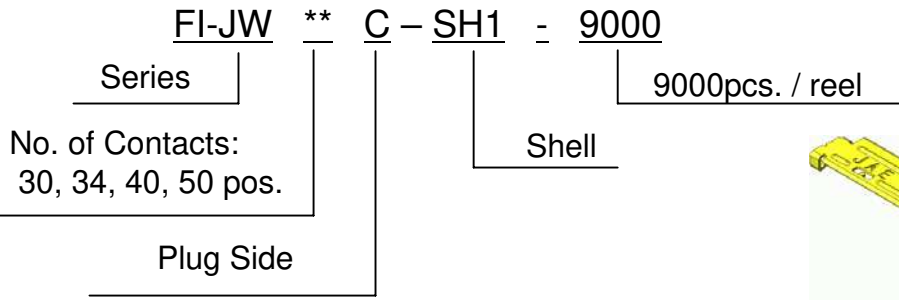

Unit: mm

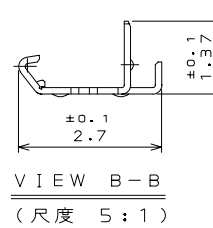
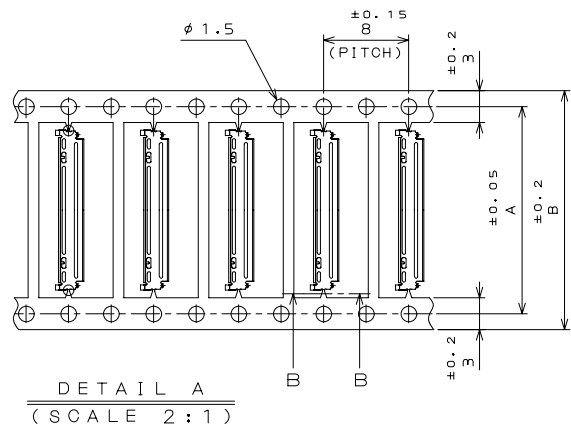
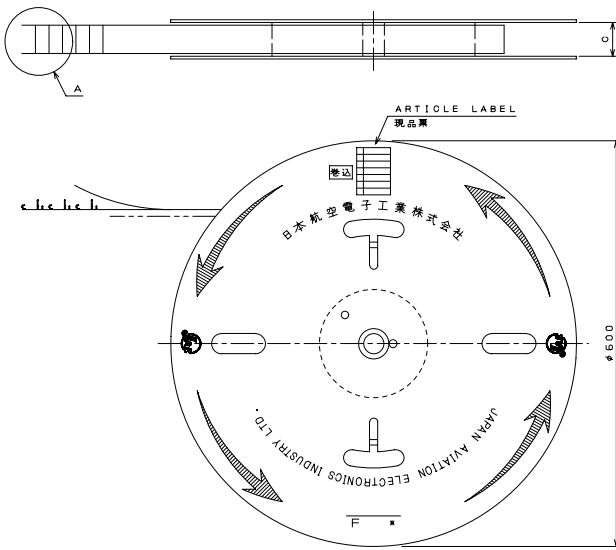

Dimensions

NO. OF CONTACTS 芯数	DIMENSIONS 寸法	DIMENSIONS			TITLE 名称
		A	B	C	
30		16.5	19.5	26	F 1
34		17.7	20.7	26	F 1
40		19.5	22.5	32	F 3
50		22.5	25.5	32	F 3

Ordering Information

Plug Side, Base Ground Bar
(SJ106358)

FI-JW ** C - BGB - S - 6000

Series

6000pcs. / reel

No. of Contacts:
30, 35, 40, 50 pos.

Modification Code S: General

Base Ground Bar

Plug Side

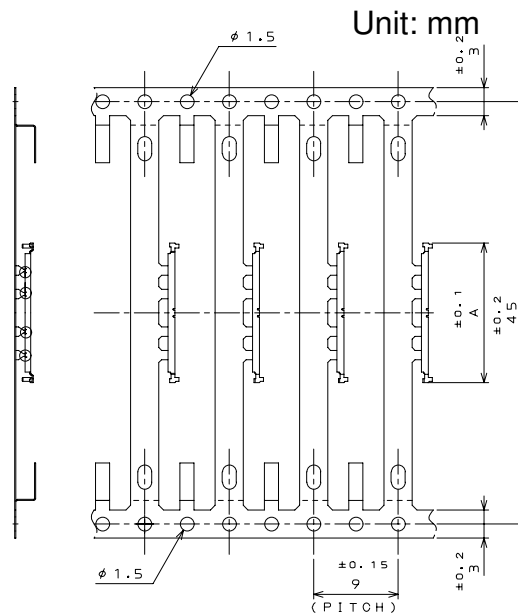
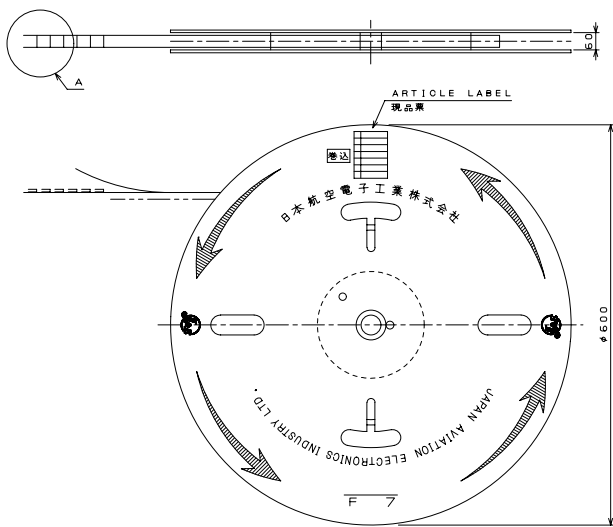
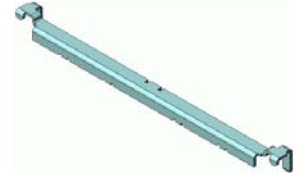

DETAIL A
(SCALE 2:1)

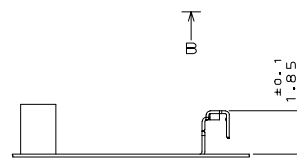

VIEW B
(SCALE 2:1)

Dimensions

NO. OF CONTACTS 芯数	DIMENSIONS 寸法	A
30		11.86
34		13.06
40		14.86
50		17.86

Ordering Information

Plug Side, Cover Ground Bar (SJ106360)

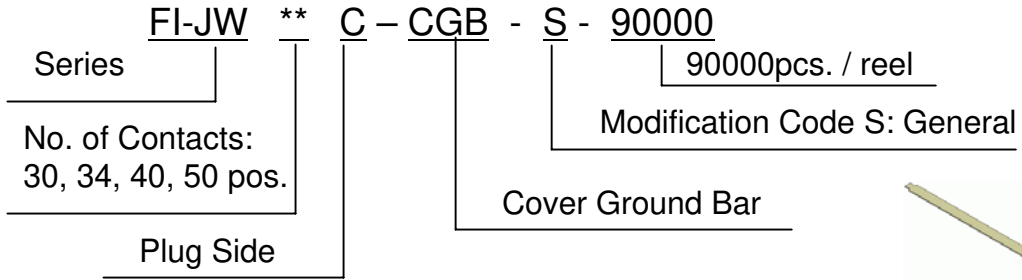

Unit: mm

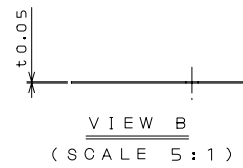
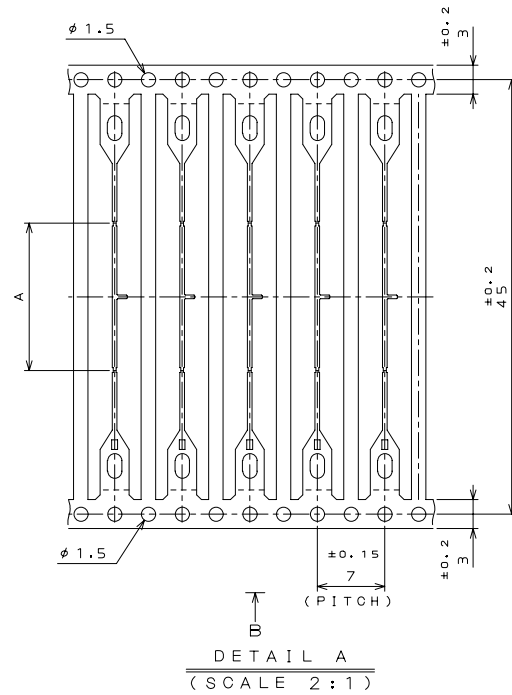
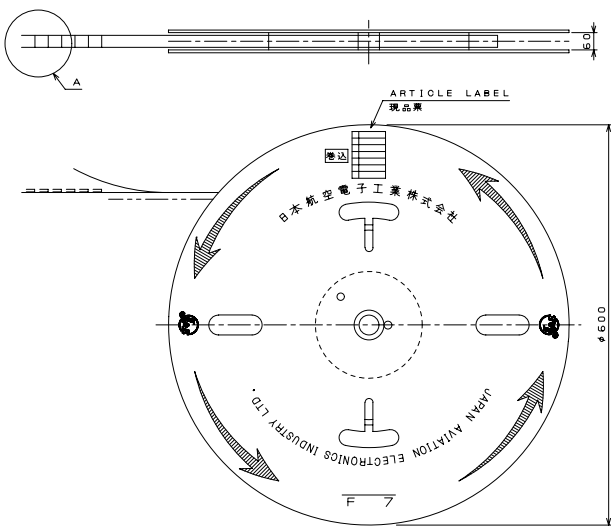

Dimensions

NO. OF CONTACTS 芯数	DIMENSIONS 寸法	A
30		12.26
34		13.46
40		15.26
50		18.26

Related Documents

-Specifications (JACS): JACS- 10345-5

-Harness Assembly Handling Instructions (JAHL): JAHL-10345-1

-Connector Handling Instructions (JAHL): JAHL-10345-10

-Connector Extraction Tool

SJ Drawing: SJ713199-00

P/N: SC-FIJW-2-K

Tool Handling Instruction: T713199



-Plug Shell Press-in Tool

P/N: WT-FIJW-2(B)-**

Tool Handling Instruction T714230

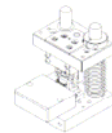

-Plug Shell Clamping Tool

P/N: WT-FIJW-5(B)-**

Tool Handling Instruction: T714233

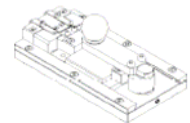

-Plug Ground Bar Cutting Tool

P/N: WT-FIJW-10-**

Tool Handling Instruction: T714261

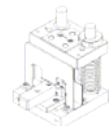

-Plug Ground Bar Press-in Tool

P/N: WT-FIJW-1-**

Tool Handling Instruction: T714299



Japan Aviation Electronics Industry, Limited

Product Marketing Division

Aobadai Building, 3-1-19, Aobadai, Meguro-ku, Tokyo 153-8539

Phone: +81-3-3780-2787 FAX: +81-3-3780-2946

Notice: Products shown in this leaflet are made for the applications listed below. However, if the above-mentioned products are to be used in aerospace devices, marine cable-connection devices, atomic power control systems, medical equipment for life-support systems, or any other specific application requiring extremely high reliability, please contact JAE for further information.

Recommended applications: computers, office machines, measuring devices, telecommunication devices (terminals, mobile devices), AV devices, household applications, FA devices, etc.