



Chipsmall Limited consists of a professional team with an average of over 10 year of expertise in the distribution of electronic components. Based in Hongkong, we have already established firm and mutual-benefit business relationships with customers from,Europe,America and south Asia,supplying obsolete and hard-to-find components to meet their specific needs.

With the principle of “Quality Parts,Customers Priority,Honest Operation,and Considerate Service”,our business mainly focus on the distribution of electronic components. Line cards we deal with include Microchip,ALPS,ROHM,Xilinx,Pulse,ON,Everlight and Freescale. Main products comprise IC,Modules,Potentiometer,IC Socket,Relay,Connector.Our parts cover such applications as commercial,industrial, and automotives areas.

We are looking forward to setting up business relationship with you and hope to provide you with the best service and solution. Let us make a better world for our industry!



## Contact us

Tel: +86-755-8981 8866 Fax: +86-755-8427 6832

Email & Skype: info@chipsmall.com Web: www.chipsmall.com

Address: A1208, Overseas Decoration Building, #122 Zhenhua RD., Futian, Shenzhen, China



# Silicone Case for LattePanda

SKU:FIT0516

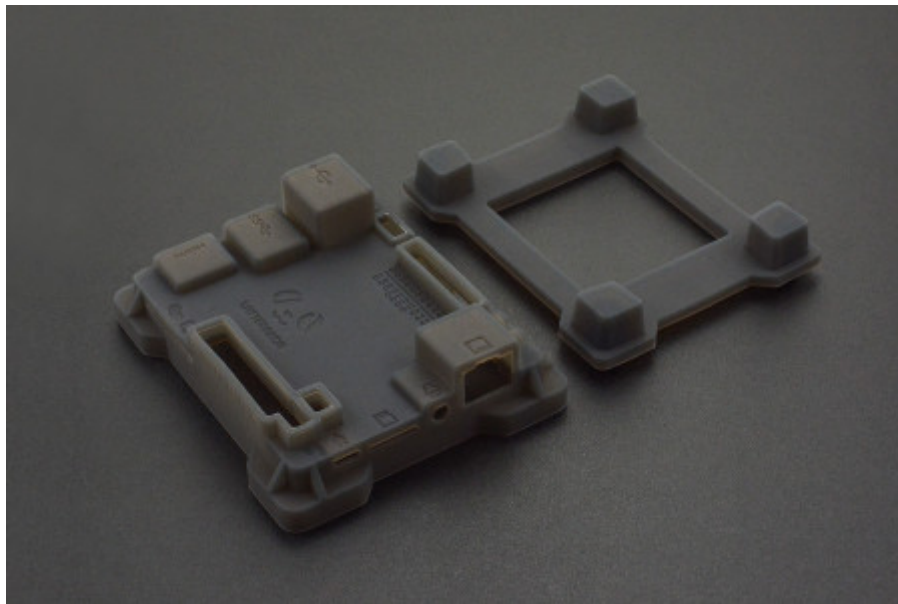

## INTRODUCTION

This silicone case is specifically designed for LattePanda development board. Not only using non-toxic and non-smell silicone material (food grade), but also provide a full range of protection structure to avoid damage caused by accidental drop.

It is worth mentioning that the silicone case has some other functions. All interface for external connection has been reserved, and each interface has a clear mark for the function. The hollow-carved design makes it easy to mount the heatsink cooling fan. In addition, this silicone case has static electricity isolation feature and good cold and heat resistance, it can tolerate -40~250°C working temperature.

Every design details and ingenuity all make it more convenient and durable.

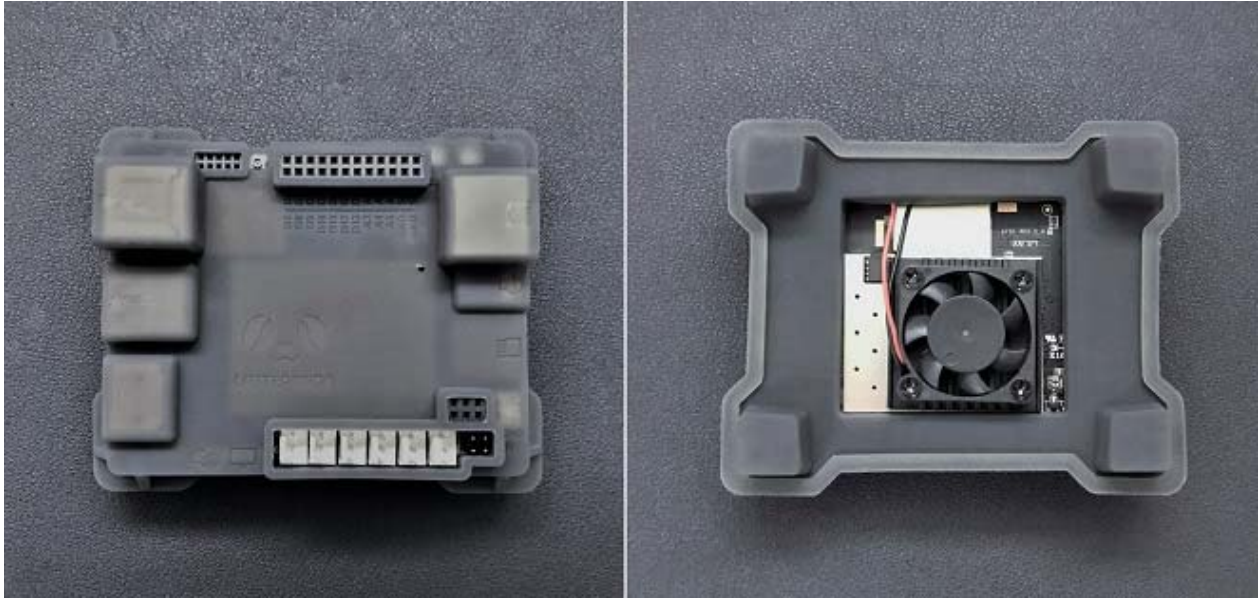

**Note:** The LattePanda development board is not included in the kit.

## FEATURES

- Compatible with LattePanda
- Non-toxic and non-smell silicone material (food grade)
- Cold & heat fatigue resisting
- Static electricity isolation

## SPECIFICATION

- Material: Silicone
- Heat resistance: -40~250°C
- Top enclosure dimensions: 101.2 \* 83.2 \* 28.2 mm/ 3.98 \* 3.28 \* 1.11 inches
- Lower base dimensions: 97 \* 79 \* 17.1 mm/ 3.82 \* 3.11 \* 0.67 inches
- Assembly dimensions: 101.2 \* 83.2 \* 37.0 mm/ 3.98 \* 3.28 \* 1.46 inches
- Net weight (without LattePanda): 60g

## SHIPPING LIST

- Silicone Case (Top enclosure) x1
- Silicone Case (Lower base) x1