



Chipsmall Limited consists of a professional team with an average of over 10 year of expertise in the distribution of electronic components. Based in Hongkong, we have already established firm and mutual-benefit business relationships with customers from,Europe,America and south Asia,supplying obsolete and hard-to-find components to meet their specific needs.

With the principle of “Quality Parts,Customers Priority,Honest Operation,and Considerate Service”,our business mainly focus on the distribution of electronic components. Line cards we deal with include Microchip,ALPS,ROHM,Xilinx,Pulse,ON,Everlight and Freescale. Main products comprise IC,Modules,Potentiometer,IC Socket,Relay,Connector.Our parts cover such applications as commercial,industrial, and automotives areas.

We are looking forward to setting up business relationship with you and hope to provide you with the best service and solution. Let us make a better world for our industry!



Contact us

Tel: +86-755-8981 8866 Fax: +86-755-8427 6832

Email & Skype: info@chipsmall.com Web: www.chipsmall.com

Address: A1208, Overseas Decoration Building, #122 Zhenhua RD., Futian, Shenzhen, China



FL

Washable

FUJISOKU SWITCHES

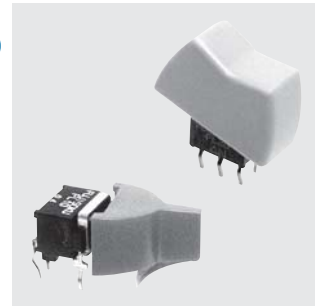

Hyper-miniature Lever & Rocker Switches

RoHS Compliant

Features

1. Hyper-miniature type. The volumetric ratio is half the conventional Series A.
2. Immersion cleaning is possible after soldering.
3. The terminal pitch is of the 0.1-inch size..
4. The independent detent mechanism ensures light operating feeling.
5. For the contact reliability, long-term stability is assured by the clip contacts.
6. Since the contacts are gold-plated, the switches are best suited for use in the dry circuit areas.
7. The full-molded type prevents malfunction caused by static electricity.

Specifications

Rating	Max : 0.4VA (28VDC max.) Min : 1μA 20mVDC
Initial contact resistance	100mΩ max. (1.5mA 200μVAC)
Dielectric strength	250VAC 1 minute
Insulation resistance	500MΩ min. (250VDC)
Electrical life	10,000 cycles at max. rating 50,000 cycles at max. rating (D,E type) 30,000 cycles at max. rating (F,G,H type)
Operating temperature range	-40°C~+85°C
Storage temperature range	-40°C~+85°C

Part Numbering

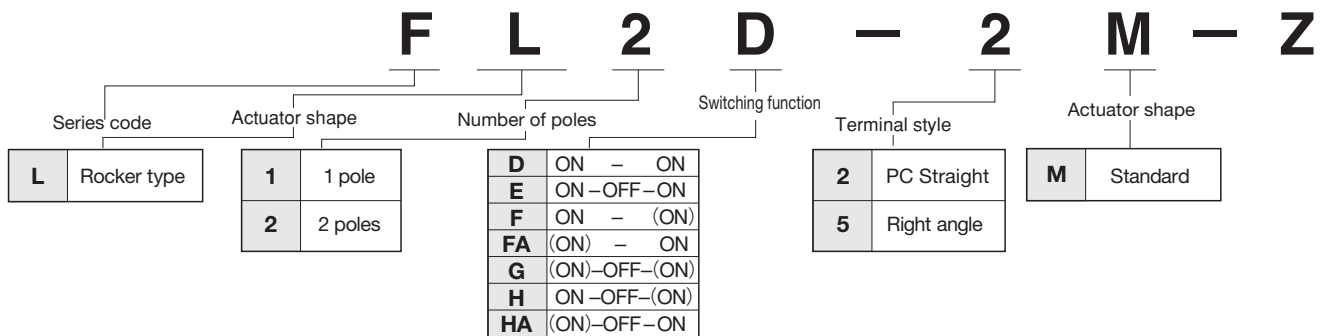

Standard Accessories

《Supplied separately》

Part name	Lever (PC Straight&R/A)	Rocker (PC Straight&R/A)	Rocker (PC Straight)
Dimensions	 Gloss finish ABS resin	 Gloss finish ABS resin	 Gloss finish ABS resin
White	14000050858	140000481410	140000481594
Red	14000050859	140000481411	140000481595
Black	14000050860	140000481412	140000481596
Gray	14000050861	140000481413	140000481597

Lever・Rocker Mounting

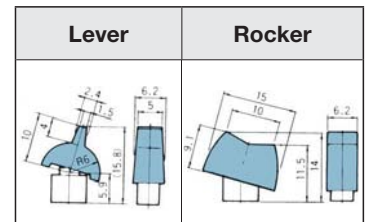

- The lever and the rocker are standard accessories. Specify either of the lever or the rocker by part number.

FL

SPDT

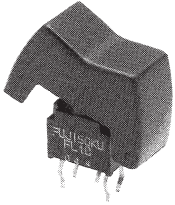

(Mount with Rocker)

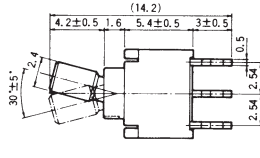
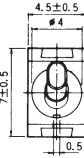

Part number marking side

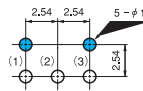
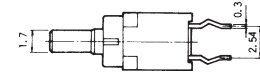
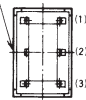

PC Straight

Terminal numbers are not shown on the bottom of the switch.

PC Hole Layouts

Switching function Part No.	Viewed from part No. marking side		
FL1D-2M-Z	ON	—	ON
▲FL1E-2M-Z	ON	OFF	ON
▲FL1F-2M-Z	(ON)	—	ON
★FL1G-2M-Z	(ON)	OFF	(ON)
▲FL1H-2M-Z	(ON)	OFF	ON
Connecting terminals	2-1	—	2-3

DPDT



(Mount with Rocker)

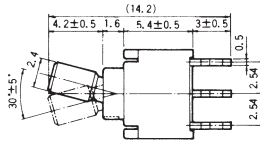
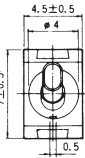

Part number marking side

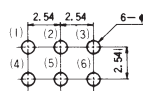
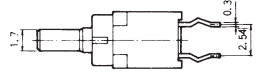
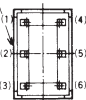

PC Straight

Terminal numbers are not shown on the bottom of the switch.

PC Hole Layouts

Switching function Part No.	Viewed from part No. marking side		
★FL2D-2M-Z	ON	—	ON
▲FL2E-2M-Z	ON	OFF	ON
★FL2F-2M-Z	(ON)	—	ON
★FL2G-2M-Z	(ON)	OFF	(ON)
▲FL2H-2M-Z	(ON)	OFF	ON
Connecting terminals	2-1 5-4	—	2-3 5-6

SPDT



(Mount with Rocker)

R/A

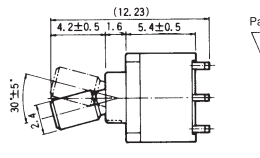
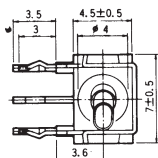

Part number marking side

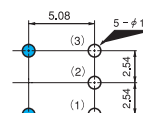
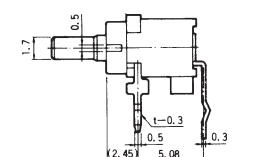
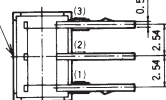

Terminal numbers are not shown on the bottom of the switch.

PC Hole Layouts

Switching function Part No.	Viewed from part No. marking side		
★FL1D-5M-Z	ON	—	ON
▲FL1E-5M-Z	ON	OFF	ON
▲FL1F-5M-Z	ON	—	(ON)
▲FL1FA-5M-Z	(ON)	—	ON
★FL1G-5M-Z	(ON)	OFF	(ON)
▲FL1H-5M-Z	ON	OFF	(ON)
▲FL1HA-5M-Z	(ON)	OFF	ON
Connecting terminals	2-3	—	2-1

DPDT

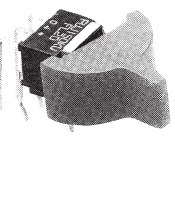

(Mount with Rocker)

R/A

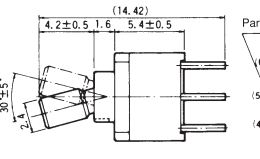
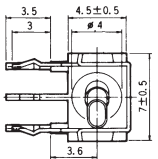

Part number marking side

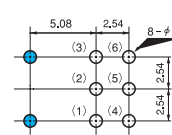
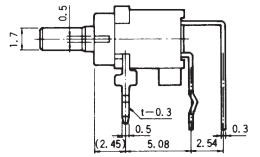
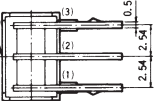

Terminal numbers are not shown on the bottom of the switch.

PC Hole Layouts

Switching function Part No.	Viewed from part No. marking side		
★FL2D-5M-Z	ON	—	ON
▲FL2E-5M-Z	ON	OFF	ON
▲FL2F-5M-Z	ON	—	(ON)
▲FL2FA-5M-Z	(ON)	—	ON
▲FL2G-5M-Z	(ON)	OFF	(ON)
▲FL2H-5M-Z	ON	OFF	(ON)
▲FL2HA-5M-Z	(ON)	OFF	ON
Connecting terminals	2-3 5-6	—	2-1 5-4

■ Packaging Specifications

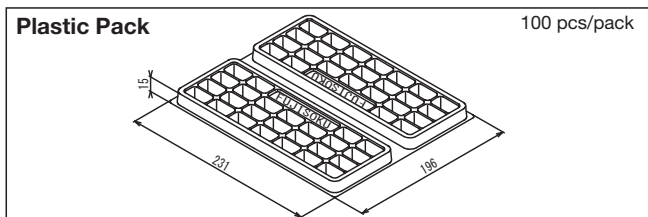

■ Soldering Specifications

- Manual Soldering
Device: Soldering iron
380°C, Max.; 3 seconds, Max.
- Auto Soldering
Device: Jet wave type or dip type
275°C; 6 seconds, Max.

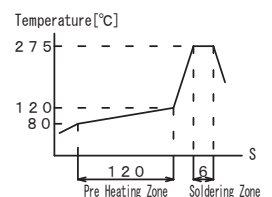

★ : Made to order products.