



Chipsmall Limited consists of a professional team with an average of over 10 year of expertise in the distribution of electronic components. Based in Hongkong, we have already established firm and mutual-benefit business relationships with customers from,Europe,America and south Asia,supplying obsolete and hard-to-find components to meet their specific needs.

With the principle of “Quality Parts,Customers Priority,Honest Operation,and Considerate Service”,our business mainly focus on the distribution of electronic components. Line cards we deal with include Microchip,ALPS,ROHM,Xilinx,Pulse,ON,Everlight and Freescale. Main products comprise IC,Modules,Potentiometer,IC Socket,Relay,Connector.Our parts cover such applications as commercial,industrial, and automotives areas.

We are looking forward to setting up business relationship with you and hope to provide you with the best service and solution. Let us make a better world for our industry!



Contact us

Tel: +86-755-8981 8866 Fax: +86-755-8427 6832

Email & Skype: info@chipsmall.com Web: www.chipsmall.com

Address: A1208, Overseas Decoration Building, #122 Zhenhua RD., Futian, Shenzhen, China



ITEM	Q'TY	PART NUMBER	PART DESCRIPTION
1	1	PML3-1	Flexible Light Pipe Adapter,Bushing
2	1	PML3-2	Flexible Light Pipe Adapter, Body
3	1	3HC-F	T1 (3mm) Flanged LED
4	1	FLP-LC	Lens Cap, Flexible Light Pipe
5	1	FLPS1022-6.380	Optical Fiber, Cut Length in Inches

REV.	DESCRIPTION	DATE	APPROVED
A	Engineering Release	04/05/10	T. Y.
B	Updated Fiber To FLPS In BOM.	11/15/12	T. Y.

NOTE: 1) ITEMS 1, 2, & 3 ASSEMBLED
 2) ITEMS 4 & 5 ASSEMBLED
 3) ASSEMBLED ITEMS SHIPPED SEPARATELY

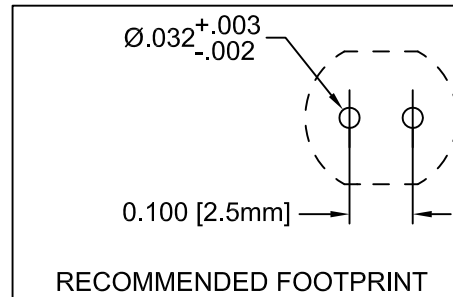
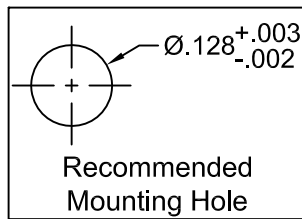
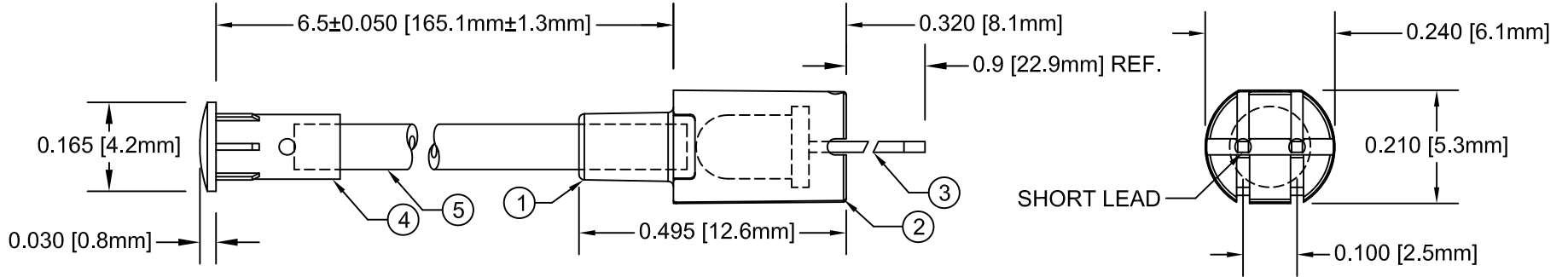
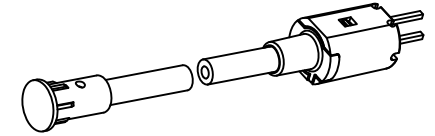

SHORT LEAD CATHODE

Chip			Lens Appearance	Absolute Max. Ratings			Electro-Optical Data @ 20mA			Viewing Angle 2 θ ½ (Deg)
Emitted Color	Peak Wave Length λp(nm)	Material		Pd (mW)	If (mA)	Peak If(mA)	Vf (V)		Iv (mcd)	
							TYP	MAX	TYP	
HE RED	625	GaAsP/GaP	80	30	150	2.0	2.8	50	20	

ABSOLUTE MAXIMUM RATINGS (Ta=25°C)

REVERSE VOLTAGE _____ 5V
 REVERSE CURRENT _____ 100uA
 OPERATING TEMPERATURE RANGE _____ -25° C - 85° C
 STORAGE TEMPERATURE _____ -30° C - 100° C
 LEAD SOLDERING TEMPERATURE(1/16" FROM BODY) _____ 260° C FOR 5 SECONDS

STANDARD TOLERANCE (UNLESS OTHERWISE SPECIFIED)		 4 THOMAS, IRVINE, CA. 92618 TEL: (949) 951-8808 FAX: (949) 951-3974	
DECIMALS	ANGULAR		
.X ±.1	X° ±1°		
.XX ±.02		 TITLE: FLEXIBLE LIGHT-PIPE ASSY VERTICAL, 3mm LENS CAP W/L ED	
.XXX ±.010			
DESIGNED: Raffy Paje	DATE: 04/05/10	PART NO: FLPV6.5-H	REVISION: B
CHECKED: T. Yin	DATE: 04/05/10	CAGE CODE : 32559	SHEET # 1 OF 1
CAD GENERATED DOCUMENT, DO NOT MEASURE DRAWING.			