



Chipsmall Limited consists of a professional team with an average of over 10 year of expertise in the distribution of electronic components. Based in Hongkong, we have already established firm and mutual-benefit business relationships with customers from,Europe,America and south Asia,supplying obsolete and hard-to-find components to meet their specific needs.

With the principle of "Quality Parts,Customers Priority,Honest Operation,and Considerate Service",our business mainly focus on the distribution of electronic components. Line cards we deal with include Microchip,ALPS,ROHM,Xilinx,Pulse,ON,Everlight and Freescale. Main products comprise IC,Modules,Potentiometer,IC Socket,Relay,Connector.Our parts cover such applications as commercial,industrial, and automotives areas.

We are looking forward to setting up business relationship with you and hope to provide you with the best service and solution. Let us make a better world for our industry!



Contact us

Tel: +86-755-8981 8866 Fax: +86-755-8427 6832

Email & Skype: info@chipsmall.com Web: www.chipsmall.com

Address: A1208, Overseas Decoration Building, #122 Zhenhua RD., Futian, Shenzhen, China



Versatile easy-mount filter

FN 420

- 0.6-6.5A current ratings
- Low profile case
- Designed for easy-mounting
- Nennströme von 0,6 bis 6,5A
- Flaches Gehäuse
- Einfache Montage
- Courants de service de 0,6 à 6,5A
- Boîtier à hauteur réduite
- Conçu pour un montage simple



Filter selection table

Choose the family FN xxx with the required current rating and features, and add /?? to determine input/output (line/load) connection style. Example: FN 422-4/13 is a 4A filter with mini fast-on connections.

Approvals



Family	Connections 	Current ratings at 40°C (25°) A	Inductance L mH
FN 42? -0.6 /??	/13	0.6 (0.7)	22.5
FN 42? -1 /??	/13	1 (1.2)	13
FN 42? -2.5 /??	/13	2.5 (3)	3.4
FN 42? -4 /??	/13	4 (4.8)	2
FN 42? -6.5 /??	/13	6.5 (7.3)	0.75

Additional specifications

Filter type	Capacitance		Res. R MΩ	Maximum leakage μA/phase	Maximum operating voltage		Operating frequency Hz	Hipot test voltage		Housing	Weight g
	C _x nF	C _y nF			VAC	Hz		PN→E VAC	P→N VDC		
FN 420 types	150	2.2	1	190	250	50/60	DC to 400	2000	1700	A7B	70
FN 422 types	150	4.7	1	190	250	50/60	DC to 400	2000	1700	A7B	70

MTBF at 40°C, 230V, per Mil-HB-217F: 625,000 hours.

Electrical schematic

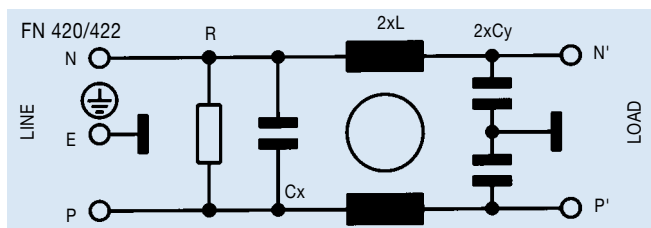

See tables for component values.

FN 420 insertion loss

Per CISPR 17; A = 50Ω/50Ω sym, B = 50Ω/50Ω asym, C = 0.1Ω/100Ω sym, D = 100Ω/0.1Ω sym

FN 420 0.6 amp types

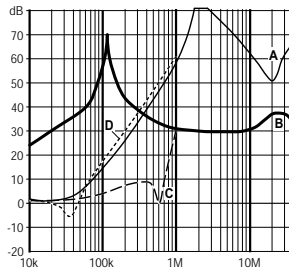

FN 420 1 amp types

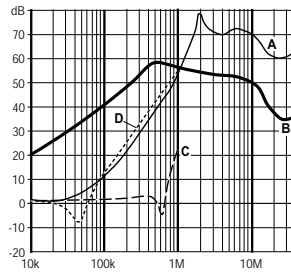

FN 420 2.5 amp types

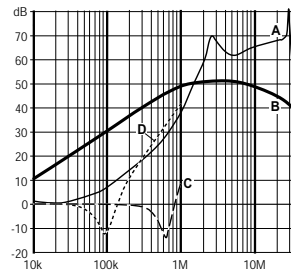

FN 420 4 amp types

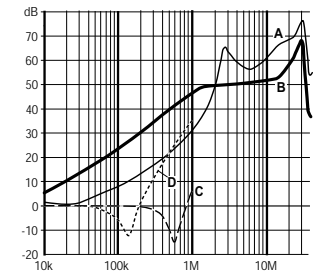

FN 420 6.5 amp types

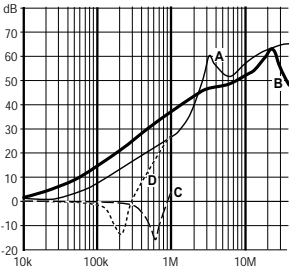

FN 422 0.6 amp types

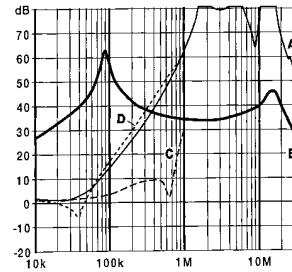

FN 422 1 amp types

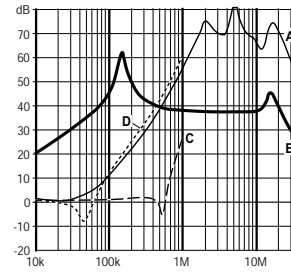

FN 422 2.5 amp types

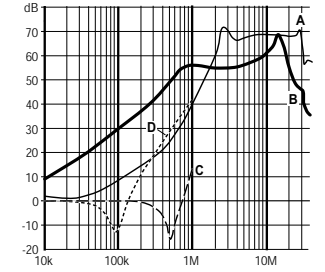

FN 422 4 amp types

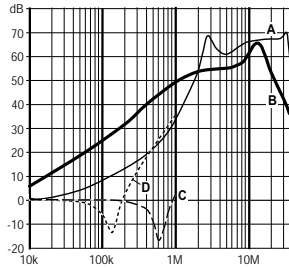

FN 422 6.5 amp types

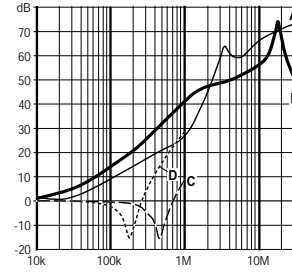

Mechanical data

		Tol. mm
A	83	± 0.5
B	41	± 0.3
C	17	± 0.3
D	65.8	± 0.2
E	31	± 0.5
F	40	± 0.2
G	5.5	± 0.3
J	15.2	± 0.3
K	1	± 0.1
M	Ø5	± 0.1

Front view

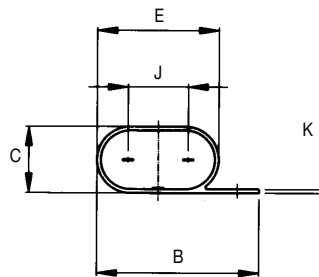

Top view

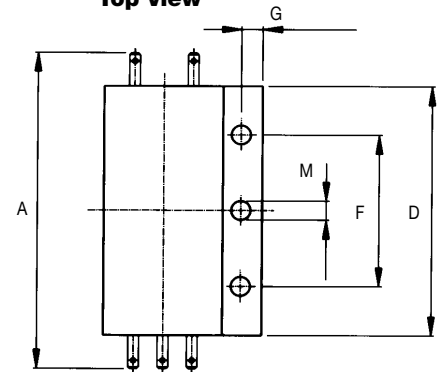

All dimensions in mm; 1 inch = 25.4 mm