



Chipsmall Limited consists of a professional team with an average of over 10 year of expertise in the distribution of electronic components. Based in Hongkong, we have already established firm and mutual-benefit business relationships with customers from,Europe,America and south Asia,supplying obsolete and hard-to-find components to meet their specific needs.

With the principle of “Quality Parts,Customers Priority,Honest Operation,and Considerate Service”,our business mainly focus on the distribution of electronic components. Line cards we deal with include Microchip,ALPS,ROHM,Xilinx,Pulse,ON,Everlight and Freescale. Main products comprise IC,Modules,Potentiometer,IC Socket,Relay,Connector.Our parts cover such applications as commercial,industrial, and automotives areas.

We are looking forward to setting up business relationship with you and hope to provide you with the best service and solution. Let us make a better world for our industry!



Contact us

Tel: +86-755-8981 8866 Fax: +86-755-8427 6832

Email & Skype: info@chipsmall.com Web: www.chipsmall.com

Address: A1208, Overseas Decoration Building, #122 Zhenhua RD., Futian, Shenzhen, China



1-phase filters FN 612

General purpose EMI filter

SCHAFFNER
safety for electronic systems



- Rated currents from 1 to 100A
- Good differential-mode attenuation
- Optional medical versions (B type)

Approvals



Technical specifications

Maximum continuous operating voltage:	250VAC, 50/60Hz
Operating frequency:	dc to 400Hz
Rated currents:	1 to 100A @ 40°C max.
High potential test voltage:	P → E 2000VAC for 2 sec P → E 2500VAC for 2 sec (B types) P → N 760VAC for 2 sec
Temperature range (operation and storage):	-25°C to +100°C (25/100/21)
Flammability corresponding to:	UL 94V-2 or better
Design corresponding to:	UL 1283, CSA 22.2 No. 8 1986, IEC/EN 60939
MTBF @ 40°C/230V (Mil-HB-217F):	800,000 hours

Typical electrical schematic

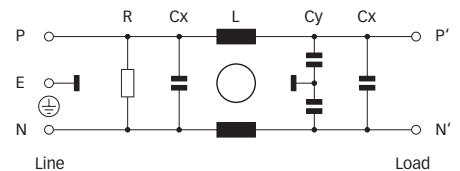

Features and benefits

- FN 612 filters are designed for easy and fast chassis mounting.
- FN 612 offer a perfect combination of performance/size ratio.
- All filters provide a good differential-mode attenuation performance, based on two chokes with high saturation resistance and excellent thermal behavior and additional capacitor on load side.
- General purpose filter attenuation with good differential-mode performance suitable to be used in a broad range of applications.
- Multiple terminal connections like faston with additional spade solder possibility, wire connection and screw connection.
- Optional medical versions (B type) with low leakage current.
- FN 612 filters are also available as two-stage filters (FN 660, FN 670 series).
- Custom-specific versions on request.

Typical applications

- Electrical and electronic equipment
- Consumer goods
- Household equipment
- Industrial equipment
- Medical equipment
- Office automation equipment
- Datacom equipment

Filter selection table

Filter*	Rated current @ 40°C (25°C) [A]	Leakage current** @ 230VAC/50Hz [µA]	Inductance L [mH]	Capacitance		Resistance R [kΩ]	Input/Output connections			Weight									
				Cx [nF]	Cy [nF]		-03	-06	-10	-24	[g]	[g]	[g]	[g]					
FN 612-1-06	1 (1.15)	190	3	100	2.2	1000													
FN 612-3-06	3 (3.4)	190	2	100	2.2	1000													
FN 612-6-06	6 (6.9)	190	0.75	100	2.2	1000													
FN 612-10-06	10 (11.5)	190	0.45	100	2.2	1000													
FN 612-20-..	20 (23)	190	0.48	100	2.2	1000	-03	-06	-10	290	260	290							
FN 612-30-..	30 (34)	190	0.61	100	2.2	1000	-03		-10	630		630							
FN 612-80-24	80 (92)	450	0.2	470	4.7	1000			-24										700
FN 612-100-24	100 (115)	450	0.2	1000	4.7	470			-24										1100
FN 612B-10-06	10 (11.5)	2	0.45	100		1000			-06										115
FN 612B-30-..	30 (34)	2	0.61	100		1000	-03		-10	630		630							
FN 612B-100-24	100 (115)	2	0.2	1000		470			-24										1100

* To compile a complete part number, please replace the .. with the required I/O connection style (e.g. FN 612-20-03, FN 612B-30-10).

** Maximum leakage under normal operating conditions. Note: if the neutral line is interrupted, worst case leakage could reach twice this level.

Typical filter attenuation

Per CISPR 17; A = 50Ω/50Ω sym; B = 50Ω/50Ω asym; C = 0.1Ω/100Ω sym; D = 100Ω/0.1Ω sym

1A types

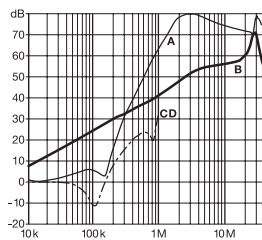

3A types

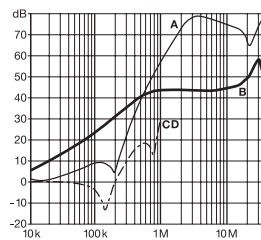

6 and 10A types

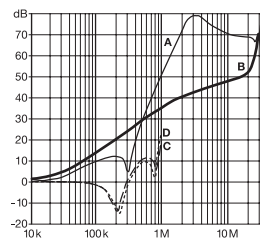

20 and 30A types

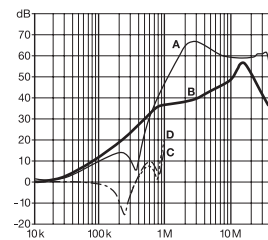

80A types

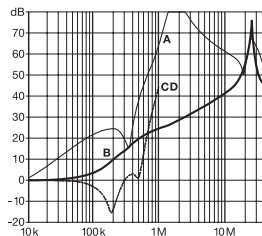

100A types

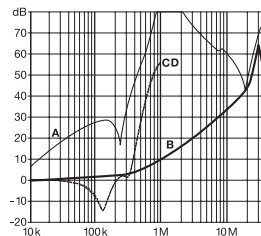

Mechanical data

Connection style -06, 1 to 20A types

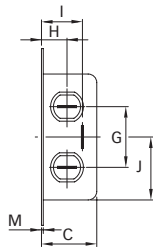
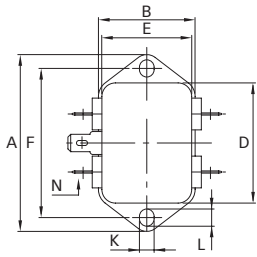

Connection style -03, 20A types

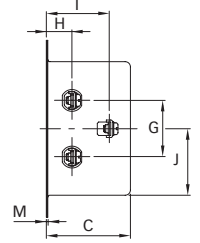
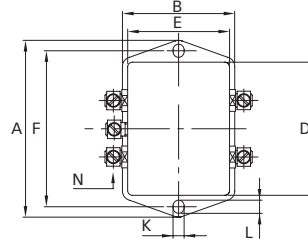

Connection style -10, 20A types

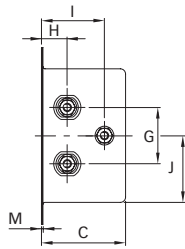
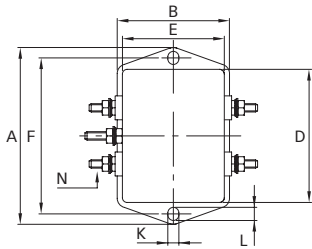

Connection style -03, 30A types

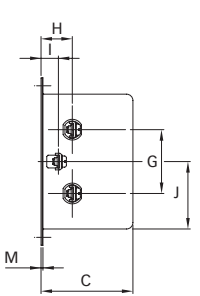
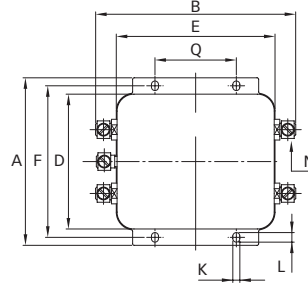

Connection style -10 and -24, 30 to 100A types

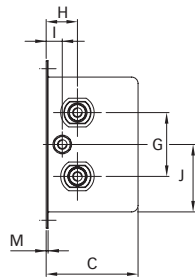
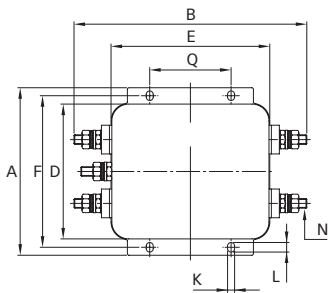

Dimensions

	1A	3A	6A	10A	20A	30A	80A	100A	Tolerances
A	71	71	71	71	85	105	105	105	±0.5
B	46.6	46.6	46.6	46.6	54	126	126	126	±1
C	22.3	29.3	29.3	29.3	40.3	38.6	45	57.6	±1
D	50.5	50.5	50.5	50.5	64.8	84.5	84.5	84.5	±1
E	44.5	44.5	44.5	44.5	49.8	99.5	99.5	99.5	±1
F	61	61	61	61	75	95	95	95	±0.2
G	21	21	21	21	27	40	40	40	±0.5
H	10.8	10.8	10.8	10.8	12	19.3	19.3	19.3	±0.5
I	16.8	24.8	24.8	24.8	29.5	9.8	9.8	9.8	±0.5
J	25.25	25.25	25.25	25.25	32.4	42.25	42.25	42.25	±0.5
K	5.3	5.3	5.3	5.3	5.3	4.4	4.4	4.4	
L	6.3	6.3	6.3	6.3	6.3	6	6	6	
M	0.7	0.7	0.7	0.7	0.7				
N	6.3 x 0.8	6.3 x 0.8	6.3 x 0.8	6.3 x 0.8	6.3 x 0.8				
Connection style -03									
N									
Q						51			±0.1
Connection style -10									
N					UNC 8-32	UNC 8-32			
Q						51			±0.1
Connection style -24									
N							M6	M6	
Q							51	51	±0.1

All dimensions in mm; 1 inch = 25.4mm
Tolerances according: ISO 2768 / EN 22768