



Chipsmall Limited consists of a professional team with an average of over 10 year of expertise in the distribution of electronic components. Based in Hongkong, we have already established firm and mutual-benefit business relationships with customers from,Europe,America and south Asia,supplying obsolete and hard-to-find components to meet their specific needs.

With the principle of “Quality Parts,Customers Priority,Honest Operation,and Considerate Service”,our business mainly focus on the distribution of electronic components. Line cards we deal with include Microchip,ALPS,ROHM,Xilinx,Pulse,ON,Everlight and Freescale. Main products comprise IC,Modules,Potentiometer,IC Socket,Relay,Connector.Our parts cover such applications as commercial,industrial, and automotives areas.

We are looking forward to setting up business relationship with you and hope to provide you with the best service and solution. Let us make a better world for our industry!



Contact us

Tel: +86-755-8981 8866 Fax: +86-755-8427 6832

Email & Skype: info@chipsmall.com Web: www.chipsmall.com

Address: A1208, Overseas Decoration Building, #122 Zhenhua RD., Futian, Shenzhen, China





PANDUIT PART NUMBER	WEIGHT
FRSTRCLIP	0.53 LB/EACH (240g/EACH)

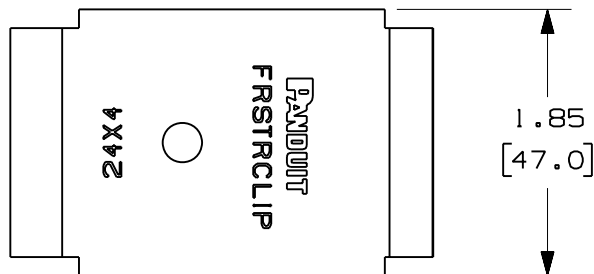

NOTES:

1. SEE CURRENT CATALOG FOR ADDITIONAL PART SUFFIXES TO INDICATE PACKAGE QUANTITY.
2. THE FIBERRUNNER STRUT CLIP KIT ALLOWS FOR THE FIBERRUNNER 4x4, 6x4, 12x4 AND 24x4 CABLE ROUTING SYSTEMS TO BE INSTALLED DIRECTLY TO 15/8" WIDE STRUT METAL FRAMING CHANNEL.
3. THE FIBERRUNNER STRUT CLIP KIT INCLUDES:
TWO (2) CLIPS,
TWO (2) 1/4-20 CHANNEL NUTS WITHOUT SPRINGS,
TWO (2) 1/4-20x7/8 HEX HEAD CAP SCREWS,
TWO (2) 1/4 HELICAL SPRING LOCKWASHERS.
4. FINISH COLOR: BLACK (EXCEPT HARDWARE)
5. DIMENSIONS IN PARENTHESES ARE IN METRIC.

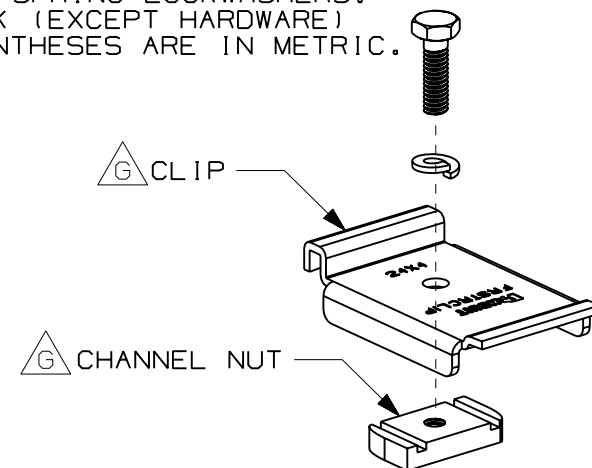
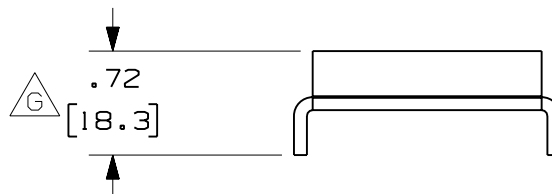
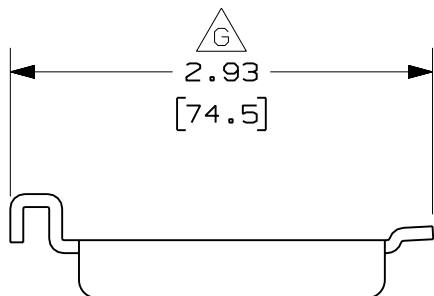

ENG. REF.: D38241BI_DC/02 FRSTRCLIP

CAD FILENAME/LAYERS **FRSTRCLIP.pdf**

PANDUIT CORP TINLEY PARK, ILLINOIS
FIBERRUNNER STRUT CLIP KIT
 (FRSTRCLIP)
 CUSTOMER DRAWING

REV	DATE	BY	CHK	DESCRIPTION	ECN	R	CUST	SUP	GMBH
-	-----	---	--	H. REVISED PART WEIGHT.	-----	--	--		
2	11-3-08	MSO	SL	G. REVISED PART GEOMETRY. F. REVISED DRAWING TITLE.	38241-08	RN	RN		
-	-----	---	--	E. REVISED GENERAL NOTES.	-----	--	--		
-	-----	---	--	D. REVISED PART WEIGHT. C. REVISED DRAWING TITLE.	-----	--	--		
1	12-29-06	MSO	RN	B. REVISED CAD FILENAME. A. REVISED AND REDRAWN.	38241-08	RN	RN		

UNLESS OTHERWISE SPECIFIED, DIMENSIONAL TOLERANCES ARE: (.X) ± (.XXX) ± (.XX) ± .03 (.8) ANGLES ±		UNLESS OTHERWISE SPECIFIED, ALL DIMENSIONS ARE GIVEN IN INCHES, THIRD ANGLE PROJECTION.	
DRAWN BY JHNU	MAT'L: STEEL	SCALE NONE	
DATE 11-12-01		DRAWING NO. 38241-08	DWG A SIZE
CHK'D HIW			