



Chipsmall Limited consists of a professional team with an average of over 10 year of expertise in the distribution of electronic components. Based in Hongkong, we have already established firm and mutual-benefit business relationships with customers from,Europe,America and south Asia,supplying obsolete and hard-to-find components to meet their specific needs.

With the principle of “Quality Parts,Customers Priority,Honest Operation,and Considerate Service”,our business mainly focus on the distribution of electronic components. Line cards we deal with include Microchip,ALPS,ROHM,Xilinx,Pulse,ON,Everlight and Freescale. Main products comprise IC,Modules,Potentiometer,IC Socket,Relay,Connector.Our parts cover such applications as commercial,industrial, and automotives areas.

We are looking forward to setting up business relationship with you and hope to provide you with the best service and solution. Let us make a better world for our industry!



## Contact us

Tel: +86-755-8981 8866 Fax: +86-755-8427 6832

Email & Skype: info@chipsmall.com Web: www.chipsmall.com

Address: A1208, Overseas Decoration Building, #122 Zhenhua RD., Futian, Shenzhen, China



THIS COPY IS PROVIDED ON A RESTRICTED BASIS AND IS NOT TO BE USED IN ANY WAY DETRIMENTAL TO THE INTERESTS OF PANDUIT CORP.

PANDUIT PART NUMBER	WEIGHT
FSCRBLD	.003 LB./EACH [ 1.3 GRAMS/EACH ]

NOTES:

1. SEE CURRENT CATALOG FOR ADDITIONAL PART NUMBER SUFFIXES TO INDICATE PACKAGE QUANTITIES.
2. EACH PACKAGE CONTAINS (1) CARBIDE REPLACEMENT BLADE FOR PANDUIT SCRIBE #FSCRIBL.
3. ALL DIMENSIONS IN BRACKETS ARE METRIC [ mm ].

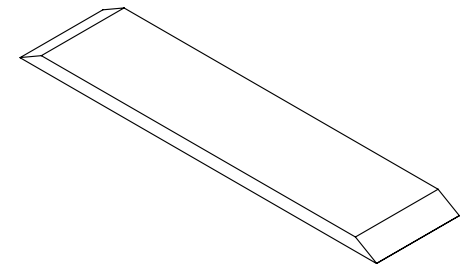
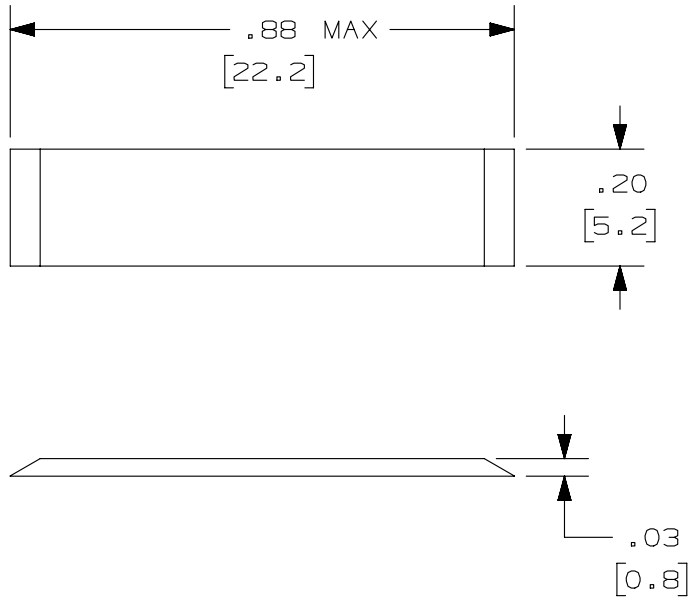

PART NUMBER		FSCRBLD	
TITLE			
REPLACEMENT BLADE FOR FSCRIBE			
CUSTOMER DRAWING			
ITEM REVISION NAME		M01190CF/00	
DATASET FILE NAME		M01190CF_DC/00B	
UNLESS OTHERWISE SPECIFIED, DIMENSIONAL TOLERANCES ARE: IN [ mm ]		MATERIAL:	
.x ± .xxx ± .010 [ .3 ]		SEE NOTES	
.xx ± .03 [ .8 ]		DRAWING NUMBER:	
ANGLES ±		01190-30	
THIRD ANGLE PROJECTION		SHT 1 OF 1	
DRAWN BY	DATE	CHK	SCALE
EFK	07-24-03	RTFI	NONE
REV	DATE	BY	CHK
1	2/13/15	JSP	WJM
APR	DESCRIPTION		ECN
	A. UPDATED DRAWING TITLE BLOCK.		01190-30

D10100DA/14

2

1

2

1