



Chipsmall Limited consists of a professional team with an average of over 10 year of expertise in the distribution of electronic components. Based in Hongkong, we have already established firm and mutual-benefit business relationships with customers from,Europe,America and south Asia,supplying obsolete and hard-to-find components to meet their specific needs.

With the principle of "Quality Parts,Customers Priority,Honest Operation,and Considerate Service",our business mainly focus on the distribution of electronic components. Line cards we deal with include Microchip,ALPS,ROHM,Xilinx,Pulse,ON,Everlight and Freescale. Main products comprise IC,Modules,Potentiometer,IC Socket,Relay,Connector.Our parts cover such applications as commercial,industrial, and automotives areas.

We are looking forward to setting up business relationship with you and hope to provide you with the best service and solution. Let us make a better world for our industry!



Contact us

Tel: +86-755-8981 8866 Fax: +86-755-8427 6832

Email & Skype: info@chipsmall.com Web: www.chipsmall.com

Address: A1208, Overseas Decoration Building, #122 Zhenhua RD., Futian, Shenzhen, China



CA38-30775-000
SHT 1.1

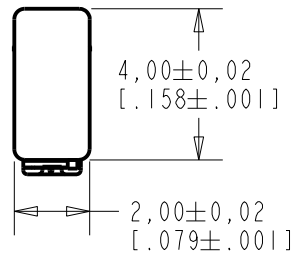

NOTES:

1. INCREASED PRESSURE AT SOUND INLET CAUSES A POSITIVE GOING VOLTAGE TO APPEAR AT THE OUTPUT TERMINAL, RELATIVE TO THE NEGATIVE TERMINAL.

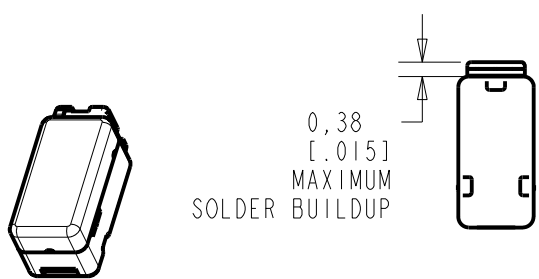
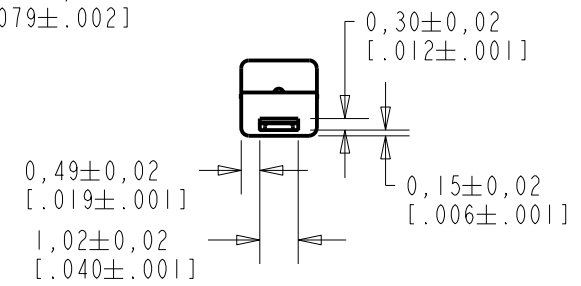
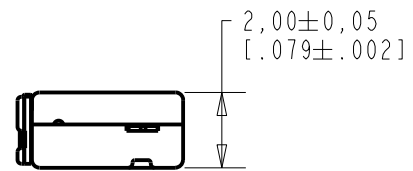
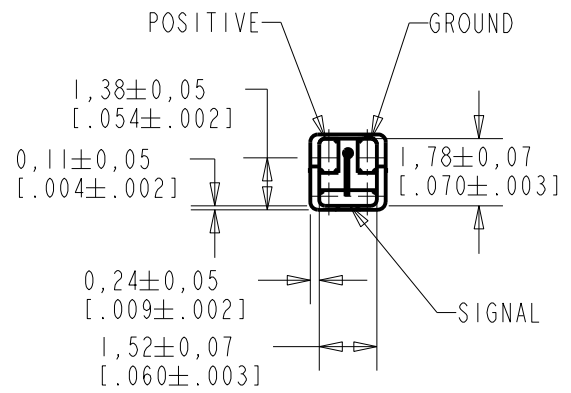

NOMINAL WEIGHT
.052 GRAMS

DIMENSIONS IN MILLIMETERS [INCHES]

Revision	C.O. #	Implementation Date	RELEASE LEVEL	REVISION
			Active	D
D	MI0104290	8-10-11		

KNOWLES ELECTRONICS
ITASCA, ILLINOIS U.S.A.

SCALE:	5:1	DR. BY	DATE
DO NOT SCALE DRAWING		LSY	7-27-10
TITLE:	MICROPHONE	CK. BY	DATE
	CA38-30775-000	GJP	7-28-10
	OUTLINE DRAWING	APP. BY	DATE
	SHT 1.1	GJP	7-28-10

TYPICAL SENSITIVITY

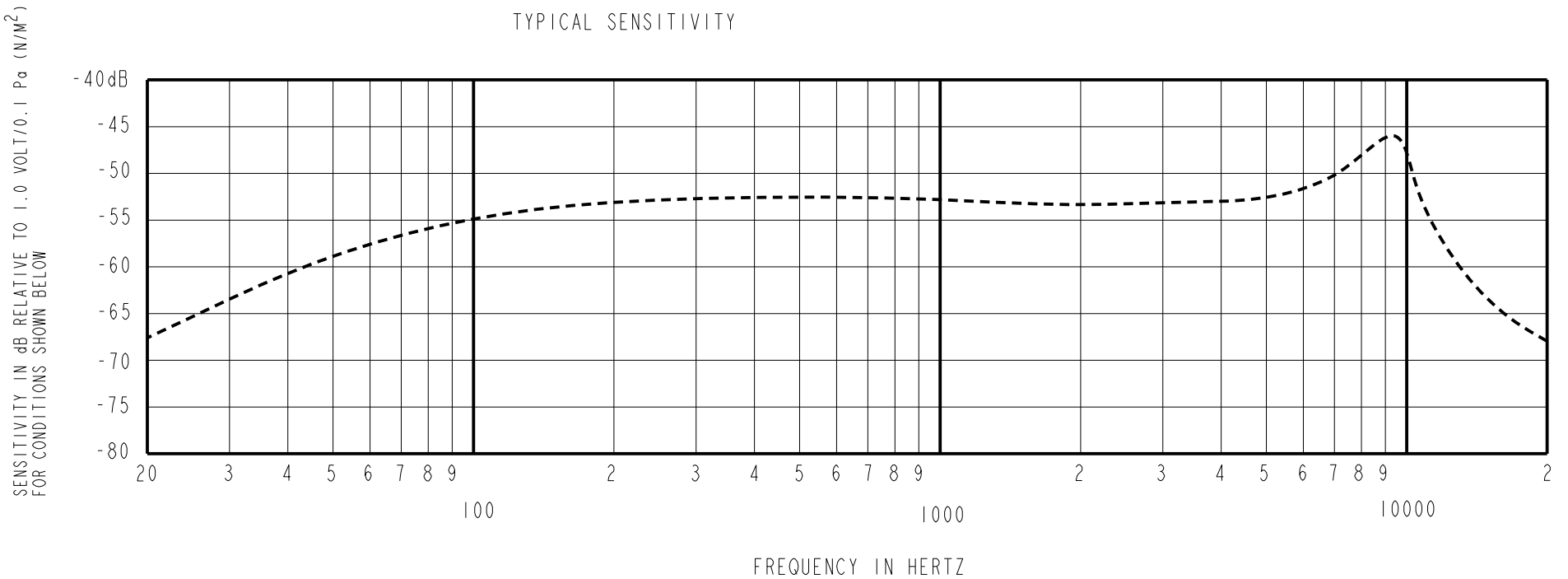

SENSITIVITY MEASURED IN A PRESSURE CAVITY UNDER THE NOMINAL CONDITIONS SHOWN BELOW

POWER REQUIREMENT					
PARAMETER	UNIT	MINIMUM	NOMINAL	MAXIMUM	REMARKS
SUPPLY VOLTAGE RANGE	VDC	0.9	0.9	1.6	-

PERFORMANCE					
PARAMETERS	UNIT	MINIMUM	NOMINAL	MAXIMUM	REMARKS
SENSITIVITY	80 Hz	-5.0	-3.0	-1.0	re SENSITIVITY AT 1 kHz
	1000 Hz	-56.0	-53.0	-50.0	dB re 1V/0.1Pa
	8000-11000 Hz	+3.0	+6.0	+9.0	re SENSITIVITY AT 1 kHz
CURRENT DRAIN	µA	-	22.0	29.0	-
OUTPUT LOAD VOLTAGE	V _L	0.28	0.43	0.58	OPEN LOAD
A-WEIGHTED NOISE	dB SPL	-	25.0	27.0	INPUT REFERRED NOISE re SENSITIVITY AT 1kHz
OUTPUT IMPEDANCE	Ohms	2800	4400	6800	

NOTES: 1. CASE CONNECTED TO NEGATIVE TERMINAL.

2. SENSITIVITY AND NOISE VALUES INDICATED ON THIS SPECIFICATION ARE VALID WHEN TESTED AT 909 KOhm//<1500pF LOAD IMPEDANCE. TYPICAL TEST ENVIRONMENT: 50% RH, 21°C (70°F)

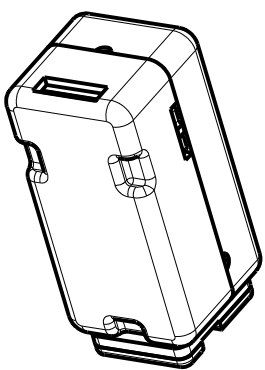

PORT LOCATION: 12N

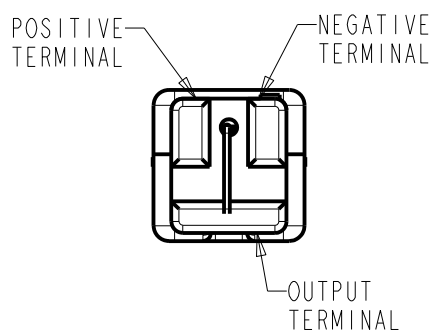

TERMINAL DEFINITION

CENTER LASER MARKING

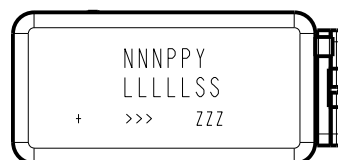

NNN IS THE MODEL NUMBER CODE
PP IS THE PRODUCTION WEEK (01-52)
Y IS THE PRODUCTION YEAR (0-9)
LLLLL IS THE LOT NUMBER
SS IS THE SUB-LOT NUMBER (01-99)
+ IS THE POSITIVE TERMINAL FOR PAIRS
>>> IS THE LEADING/LAGGING INDICATOR FOR PAIRS
ZZZ IS A SERIAL NUMBER FOR ENGINEERING SAMPLES

KNOWLES RESERVES THE RIGHT TO MAKE CHANGES TO IMPROVE RELIABILITY AND PERFORMANCE OF THE PRODUCT.

Revision	C.O. #	Implementation Date	RELEASE LEVEL	REVISION
D	MI0104290	8-10-11	Active	D

WHEN TEST LIMITS ARE USED TO ESTABLISH INCOMING INSPECTION ACCEPTANCE/REJECTION CRITERIA, CORRELATION OF TEST EQUIPMENT WITH KNOWLES IS ALSO REQUIRED FOR ELIMINATION OF EQUIPMENT AND TEST METHOD VARIATION	DR. BY LSY	DATE 7-27-10
TITLE: MICROPHONE PERFORMANCE SPECIFICATION	CA38-30775-000 SHT 2.1	CK. BY GJP
		DATE 7-28-10
		DATE 7-28-10

KNOWLES ELECTRONICS
ITASCA, ILLINOIS U.S.A.

A) 1/3 OCTAVE INPUT REFERRED NOISE

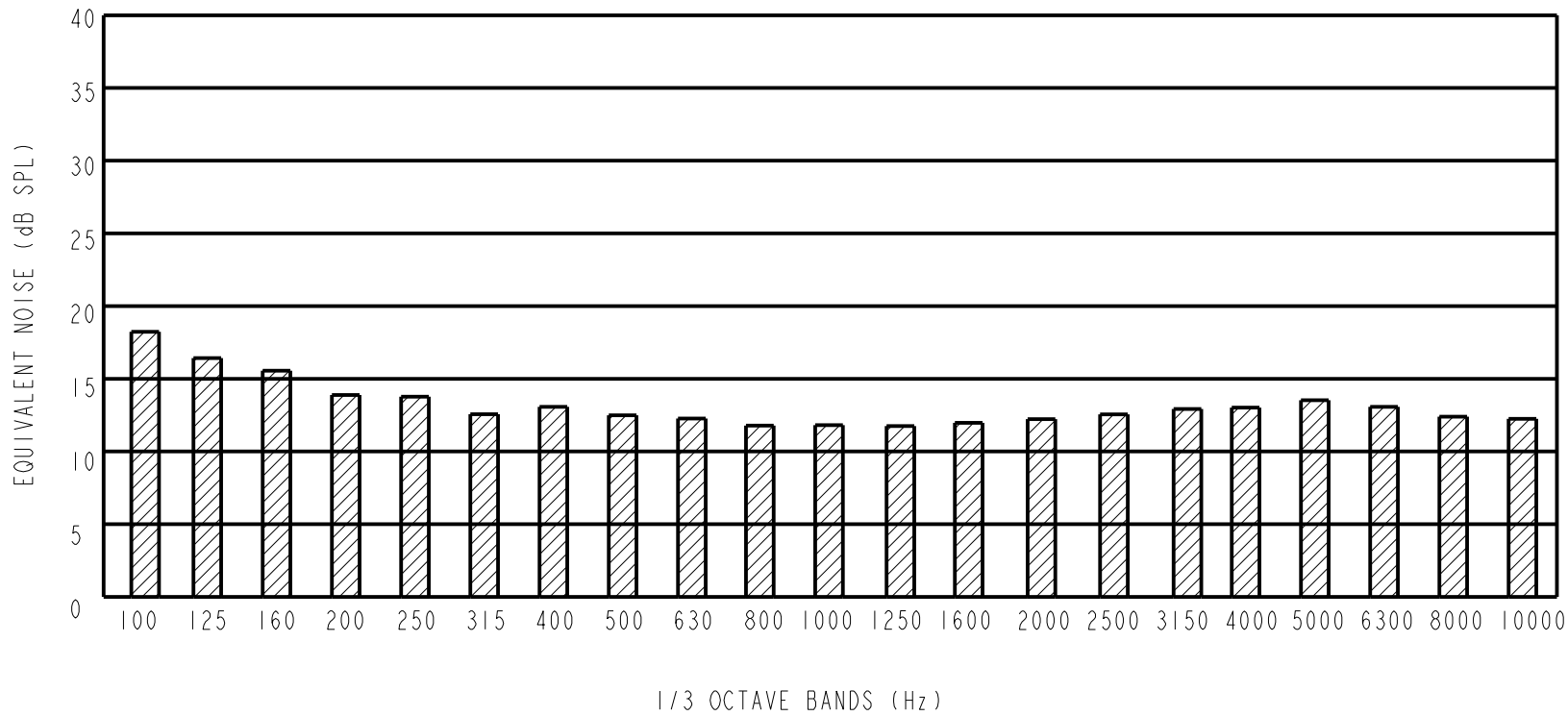

B) PERFORMANCE

PERFORMANCE						
PARAMETERS		UNIT	MINIMUM	TYPICAL	MAXIMUM	REMARKS
POWER SUPPLY REJECTION RATIO (PSRR)	1000 Hz	dB	-	-36	-18	SUPPLY VOLTAGE @ 0.9 VDC
INPUT REFERRED VIBRATION SENSITIVITY	1000 Hz	dB SPL	-	-	60	BLOCKED PORT; 1g ACCELERATION
HUMIDITY COEFFICIENT	1000 Hz	dB		0.03		PER %RH
TEMPERATURE RANGE	OPERATION	°C (°F)	-17 (1.4)	-	63 (145.4)	CELSIUS (FAHRENHEIT)
	STORAGE	°C (°F)	-40 (-40)	-	63 (145.4)	CELSIUS (FAHRENHEIT)
ESD TOLERANCE	MIL-STD-750 CLASS 2 RATING EOS/ESD-S5.1-1993 CLASS 2 RATING					

KNOWLES RESERVES THE RIGHT TO MAKE CHANGES TO IMPROVE RELIABILITY AND PERFORMANCE OF THE PRODUCT.

Revision	C.O. #	Implementation Date	RELEASE LEVEL	REVISION
D	MI0104290	8-10-11	Active	D

WHEN TEST LIMITS ARE USED TO ESTABLISH INCOMING INSPECTION ACCEPTANCE/REJECTION CRITERIA, CORRELATION OF TEST EQUIPMENT WITH KNOWLES IS ALSO REQUIRED FOR ELIMINATION OF EQUIPMENT AND TEST METHOD VARIATION		DR. BY	DATE
TITLE: MICROPHONE PERFORMANCE SPECIFICATION		LSY	7-27-10
		GJP	7-28-10
CA38-30775-000 SHT 2.2		APP. BY	DATE
		GJP	7-28-10

KNOWLES ELECTRONICS
ITASCA, ILLINOIS U.S.A.