



Chipsmall Limited consists of a professional team with an average of over 10 year of expertise in the distribution of electronic components. Based in Hongkong, we have already established firm and mutual-benefit business relationships with customers from,Europe,America and south Asia,supplying obsolete and hard-to-find components to meet their specific needs.

With the principle of "Quality Parts,Customers Priority,Honest Operation,and Considerate Service",our business mainly focus on the distribution of electronic components. Line cards we deal with include Microchip,ALPS,ROHM,Xilinx,Pulse,ON,Everlight and Freescale. Main products comprise IC,Modules,Potentiometer,IC Socket,Relay,Connector.Our parts cover such applications as commercial,industrial, and automotives areas.

We are looking forward to setting up business relationship with you and hope to provide you with the best service and solution. Let us make a better world for our industry!



Contact us

Tel: +86-755-8981 8866 Fax: +86-755-8427 6832

Email & Skype: info@chipsmall.com Web: www.chipsmall.com

Address: A1208, Overseas Decoration Building, #122 Zhenhua RD., Futian, Shenzhen, China



THIS COPY IS PROVIDED ON A RESTRICTED BASIS AND IS NOT TO BE USED IN ANY WAY DETRIMENTAL TO THE INTERESTS OF PANDUIT CORP.

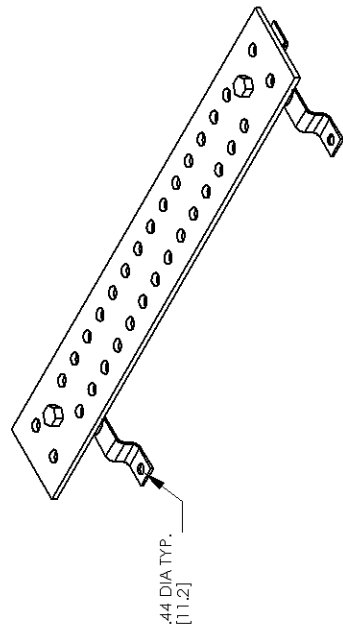
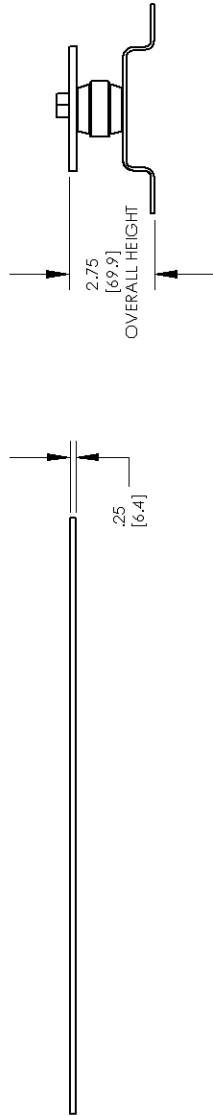
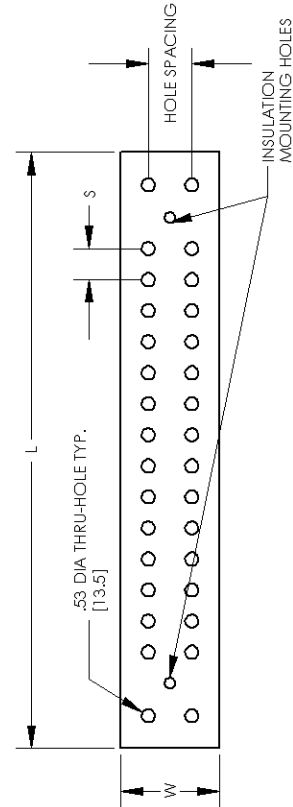

ASSEMBLED AS SHOWN

NOTES:

1. KIT COMES FULLY ASSEMBLED
2. KIT INCLUDES BUSBAR, MOUNTING BRACKETS, INSULATORS, AND MOUNTING HARDWARE.
3. DIMENSIONS IN PARENTHESIS ARE MILLIMETERS.



LISTED
GROUNDING AND BONDING EQUIPMENT

| PANDUIT PART NUMBER | DIMENSIONS - IN [mm] | | | HOLE PATTERN INFORMATION | | MOUNTING BRACKET HARDWARE | MOUNTING KIT QUANTITY |
|---------------------|----------------------|--------------|-----------|--------------------------|-----------------------------|---------------------------|-----------------------|
| | L | W | S | HOLE SIZE | HOLE SPACING # OF HOLE SETS | | |
| GB4N007TPI-1 | 12.00 [304.8] | 4.00 [101.6] | 1.25 | 1/2" | 1.75 7 SETS | BUTTON HEAD SCREW | 2 |
| GB4N016TPI-1 | 24.00 [609.6] | 4.00 [101.6] | 1.25 | 1/2" | 1.75 16 SETS | BUTTON HEAD SCREW | 2 |
| GB4N024TPI-1 | 36.00 [914.4] | 4.00 [101.6] | 1.25/1.38 | 1/2" | 1.75 14 SETS 10 SETS | BUTTON HEAD SCREW | 2 |
| GB4N026TPI-1 | 48.00 [1219.2] | 4.00 [101.6] | 1.56 | 1/2" | 1.75 26 SETS | HEX BOLT | 3 |
| GB4N034TPI-1 | 60.00 [1524.0] | 4.00 [101.6] | 1.56 | 1/2" | 1.75 34 SETS | HEX BOLT | 3 |

| | | | |
|--|-----------|--|---|
| PANDUIT CORP. TINLEY PARK, ILLINOIS | | NEMA SPACING GROUNDING BUSBARS CUSTOMER DRAWING | |
| UNLESS OTHERWISE SPECIFIED, DIMENSIONAL TOLERANCES ARE: (X) ± ANGLES ± (XX) ± (XXX) ± | | UNLESS OTHERWISE SPECIFIED, ALL DIMENSIONS ARE GIVEN IN INCHES, THIRD ANGLE PROJECTION | |
| SCALE | NONE | DRAWN BY | JHNU |
| DRAWING NO / CAD FILE | C41740_03 | DATE | 1/08 |
| DWG | B | CUST/CHK'D | |
| SIZE | | PM | |
| ECN | | DESCRIPTION | |
| 03 | 11/08 | JHNU/JHNU | REVISED DRAWING LAYOUT, REMOVED BRACKET VIEWS |
| 02 | 11/08 | JHNU/DWDA | ADDED MOUNTING HARDWARE COLUMN TO TABLE |
| 01 | 7/08 | JHNU/DWDA | ADDED HOLE PATTERN COLUMN TO TABLE |
| 00 | 5/08 | JHNU/DWDA | DRAWING RELEASED |