



Chipsmall Limited consists of a professional team with an average of over 10 year of expertise in the distribution of electronic components. Based in Hongkong, we have already established firm and mutual-benefit business relationships with customers from,Europe,America and south Asia,supplying obsolete and hard-to-find components to meet their specific needs.

With the principle of “Quality Parts,Customers Priority,Honest Operation,and Considerate Service”,our business mainly focus on the distribution of electronic components. Line cards we deal with include Microchip,ALPS,ROHM,Xilinx,Pulse,ON,Everlight and Freescale. Main products comprise IC,Modules,Potentiometer,IC Socket,Relay,Connector.Our parts cover such applications as commercial,industrial, and automotives areas.

We are looking forward to setting up business relationship with you and hope to provide you with the best service and solution. Let us make a better world for our industry!



Contact us

Tel: +86-755-8981 8866 Fax: +86-755-8427 6832

Email & Skype: info@chipsmall.com Web: www.chipsmall.com

Address: A1208, Overseas Decoration Building, #122 Zhenhua RD., Futian, Shenzhen, China



CABLE GLANDS

Versatile Enclosure and Panel Accessories

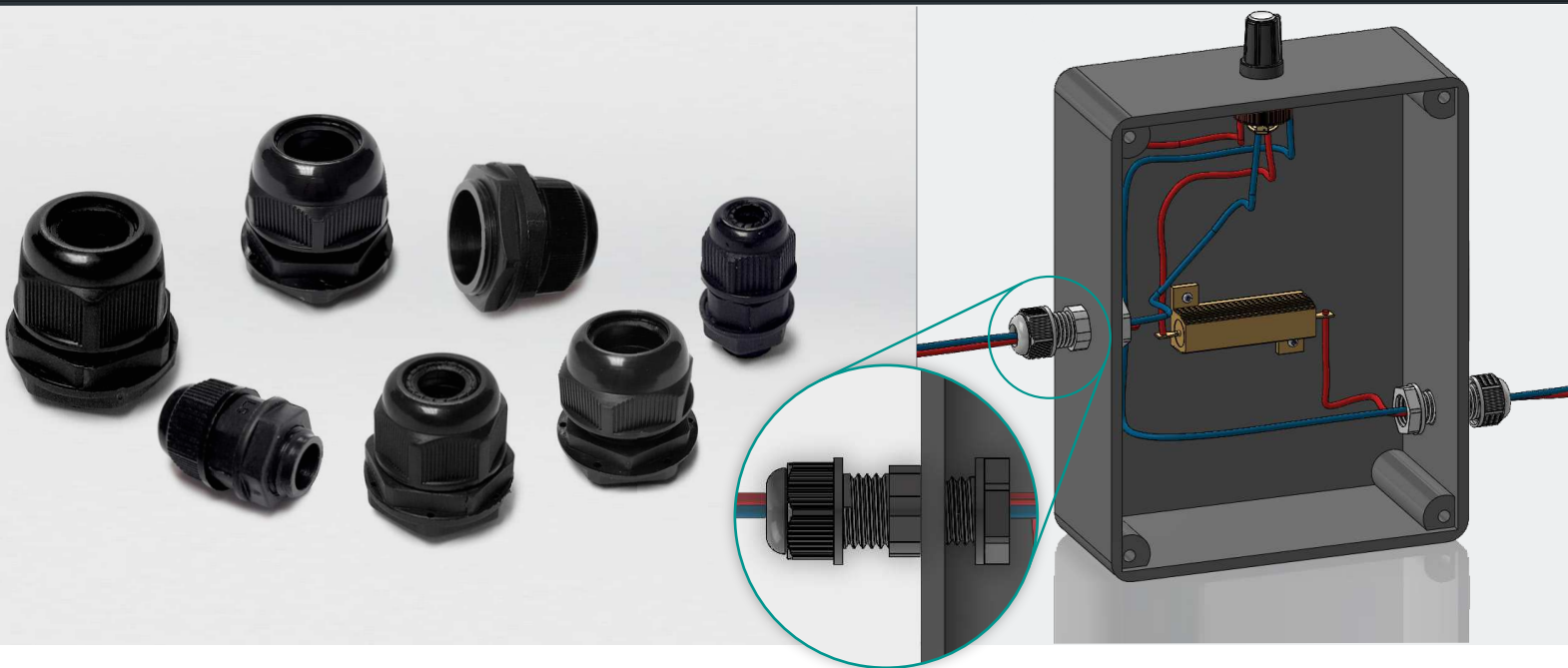

FEATURES

- ▶ Nylon body provides excellent impact resistance and durability in harsh conditions
- ▶ Prevents cabling, wiring or tubing from abrasion
- ▶ Protects enclosures against elements like water, dust and debris
- ▶ Supplied preassembled with locking nut, O-ring, body, seal and sealing nut
- ▶ Cable Gland Material: Nylon UL94 V-2
- ▶ Sealing Elements Material: TPE Rubber
- ▶ Seal Rating: IP67
- ▶ Operating temperature: -30 C to 120 C Dynamic
- ▶ RoHS and REACH compliant
- ▶ Multiple sizes available with metric threads
- ▶ Overview video available: [Click here](#)
- ▶ View full product offerings at www.daviesmolding.com

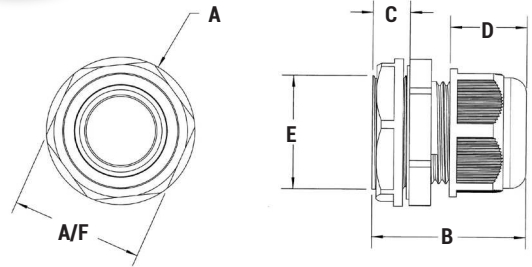

Part No	Thread Type	Cable Range	A/F	Dia. A	Min B	Max B	C	D	Dia. E	Panel Thickness	Panel Hole Dia.
GC1000-A	M12X1.5	2.5-6.5	15	16	27.5	30.5	8.5	12.5	12	.56-1.99	12.5
GC1000-B	M16X1.5	3.5-8.0	18	20	31	35.5	8.5	16.5	16	.56-1.99	16.5
GC1000-C	M20X1.5	7.0-12.0	24	26	27.5	32.5	9	17.5	20	.56-1.99	20.5
GC1000-D	M25X1.5	9.0-14.0	27	31	35	40	10	19	25	.56-1.99	25.5
GC1000-E	M32X1.5	13.0-18.0	37	40.5	38	44	10	21.5	32	.56-1.99	33
GC1000-F	M40X1.5	14.0-25.0	45	50	47.5	53.5	10	26.5	40	.56-1.99	41
GC1000-G	M50X1.5	22.0-32.0	54	60.5	55.5	64	12.5	30.5	50	.56-3.18	51
GCL1000-H	M20X1.5	7.0-12.0	24	26	36.5	41.5	13	17.5	20	.56-3.18	20.5
GCL1000-J	M25X1.5	9.0-14.0	27	31	40	44.5	15	19	25	.56-3.18	25.5

*All measurements are in mm