



Chipsmall Limited consists of a professional team with an average of over 10 year of expertise in the distribution of electronic components. Based in Hongkong, we have already established firm and mutual-benefit business relationships with customers from,Europe,America and south Asia,supplying obsolete and hard-to-find components to meet their specific needs.

With the principle of "Quality Parts,Customers Priority,Honest Operation,and Considerate Service",our business mainly focus on the distribution of electronic components. Line cards we deal with include Microchip,ALPS,ROHM,Xilinx,Pulse,ON,Everlight and Freescale. Main products comprise IC,Modules,Potentiometer,IC Socket,Relay,Connector.Our parts cover such applications as commercial,industrial, and automotives areas.

We are looking forward to setting up business relationship with you and hope to provide you with the best service and solution. Let us make a better world for our industry!



## Contact us

Tel: +86-755-8981 8866 Fax: +86-755-8427 6832

Email & Skype: info@chipsmall.com Web: www.chipsmall.com

Address: A1208, Overseas Decoration Building, #122 Zhenhua RD., Futian, Shenzhen, China



## SPECIFICATION

- Part No. : **GP.1575.25.4.A.02**
- Product Name : 4mm thick GPS/GALILEO Patch Antenna
- Features : 25mm\*25mm\*4mm  
Halogen Free  
RoHS Compliant

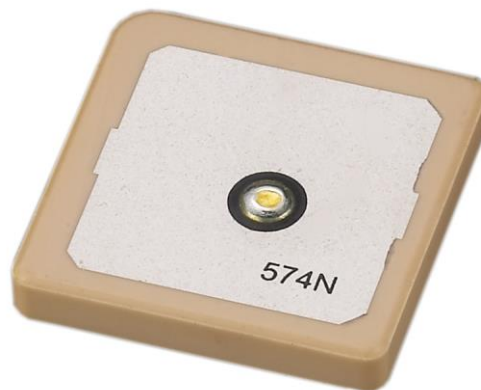

# 1. Introduction

This miniaturized ceramic GPS/GALILEO patch antenna is based on smart **XtremeGain™** technology. It is mounted via pin and double-sided adhesive and has been tuned as optimal solution for the customer device environment.

# 2. Specification Table

Original Patch Specification tested on 50\*50mm ground plane

No	Parameter	Specification
1	Range of Receiving Frequency	1575.42MHz +/- 1.023MHz
	Center Frequency	1575MHz +/- 3MHz
2	Impedance	50Ω
3	Bandwidth	10 MHz min Return Loss <-10dB
4	VSWR	1.2:1
5	Gain toward Zenith	1.55 dBic typ.
6	Gain at 10°Elevation	-2.5 dBic typ.
7	Axial Ratio	3dB Max.
8	Polarization	Right Hand Circular Polarization
9	Frequency Temperature Coefficient ( Tf )	0 ± 20ppm/°C
	Operating Temperature	
10	Operating Temperature	-40°C to +85°C

### 3. Electrical Specification

#### 3.1 Return Loss

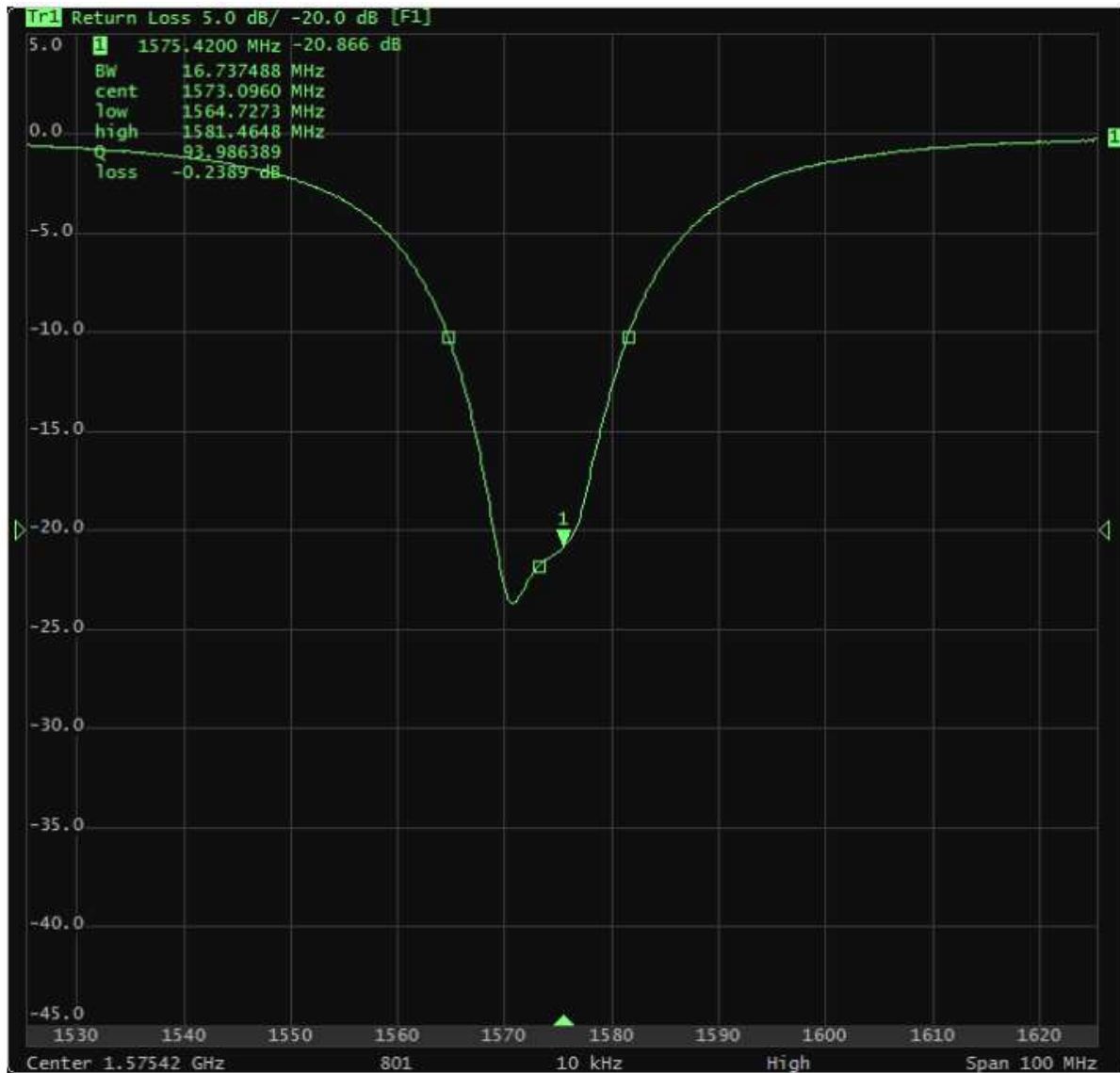

### 3.2 Smith Chart

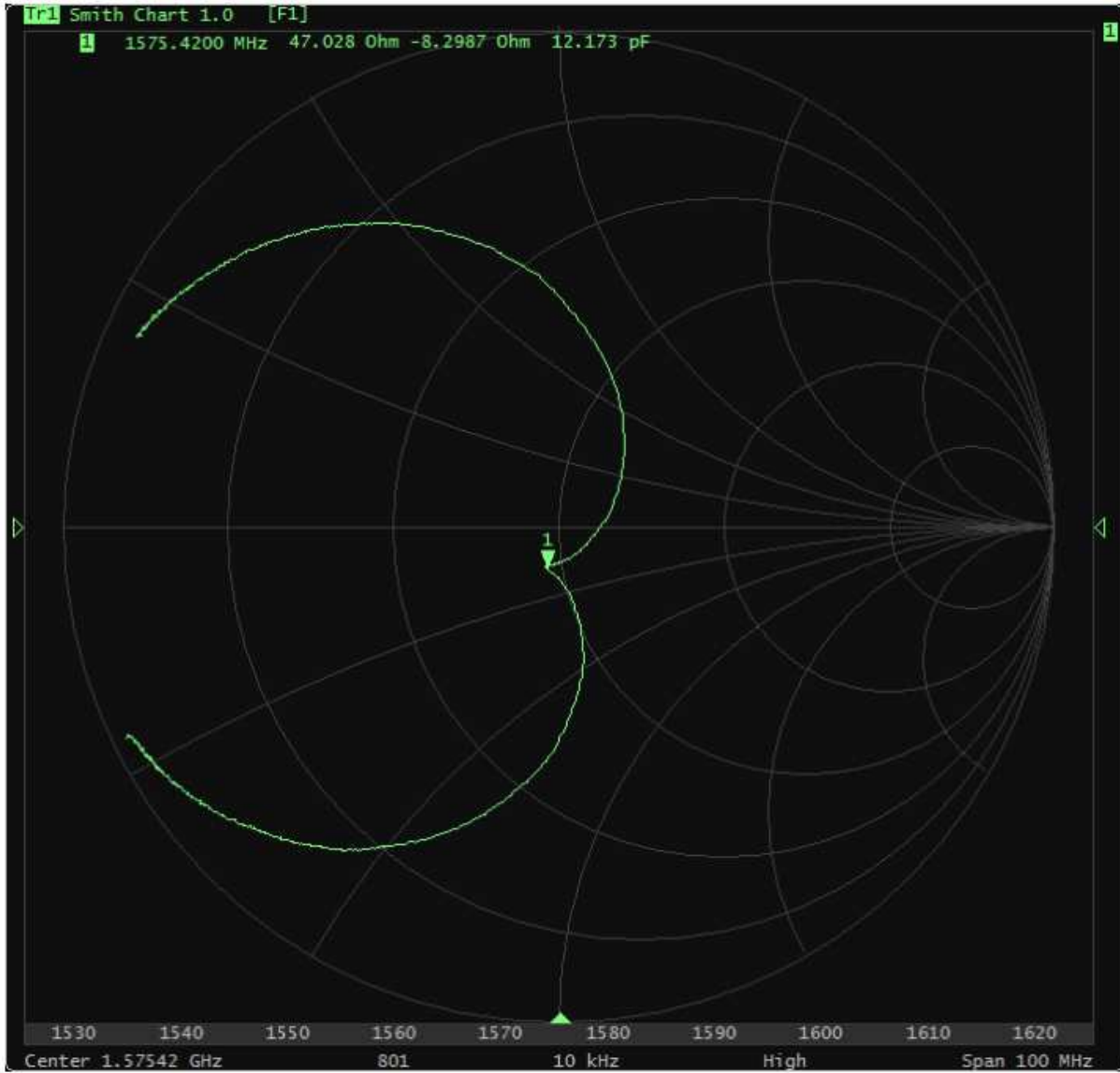

### 3.3. VSWR

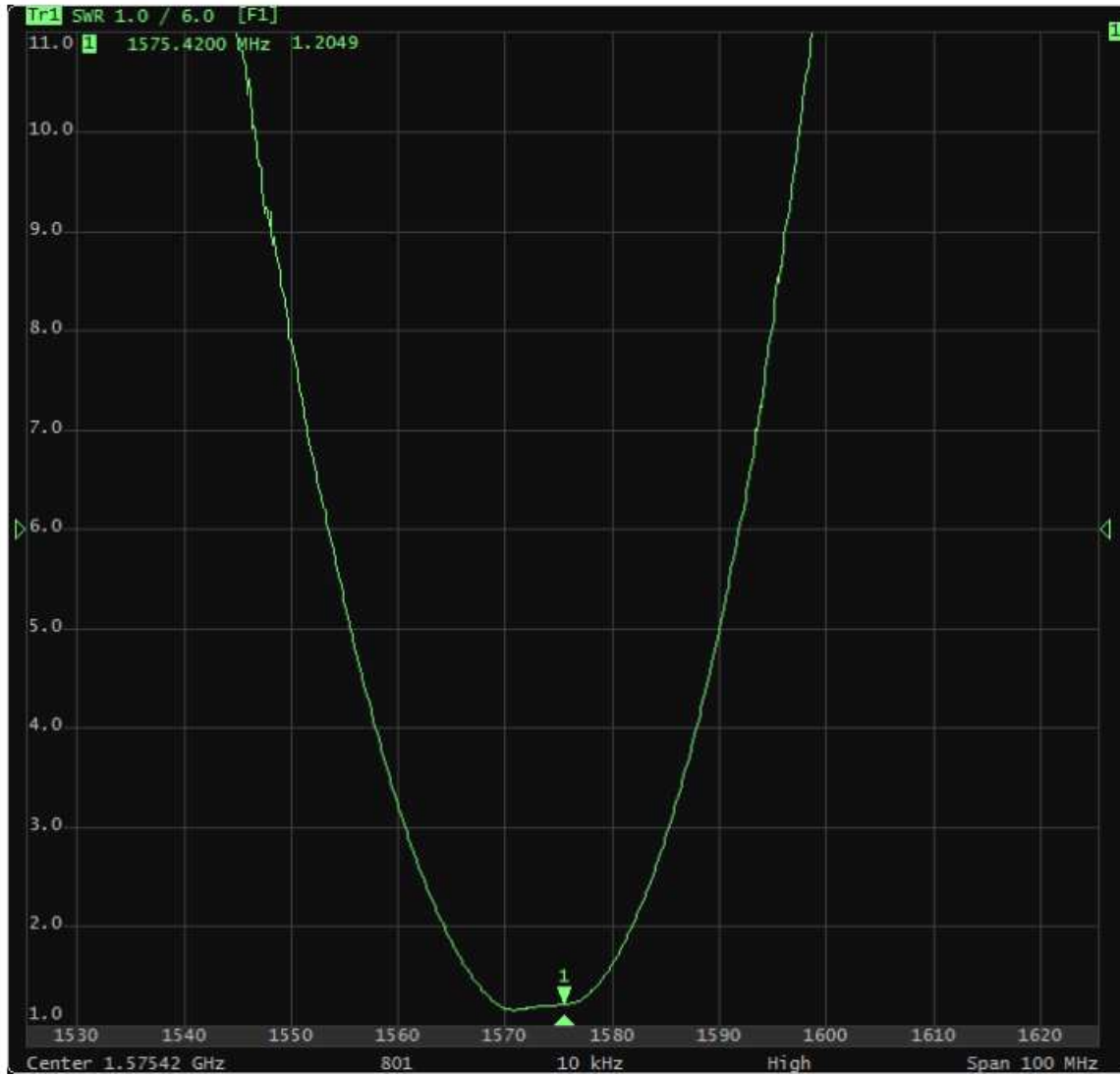

### 4. 2D Radiation Patterns

XZ-Plane

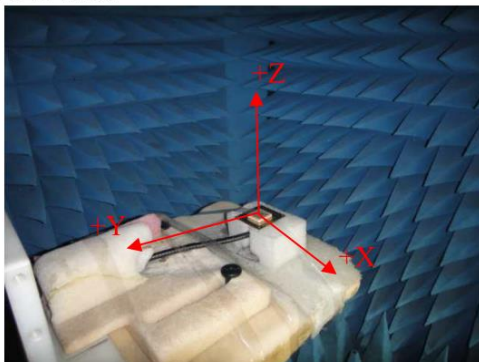

YZ-Plane

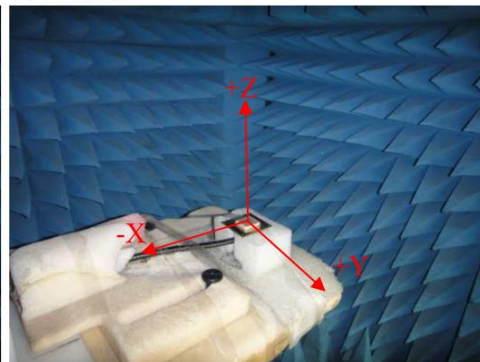

### 4.1 XZ Patterns

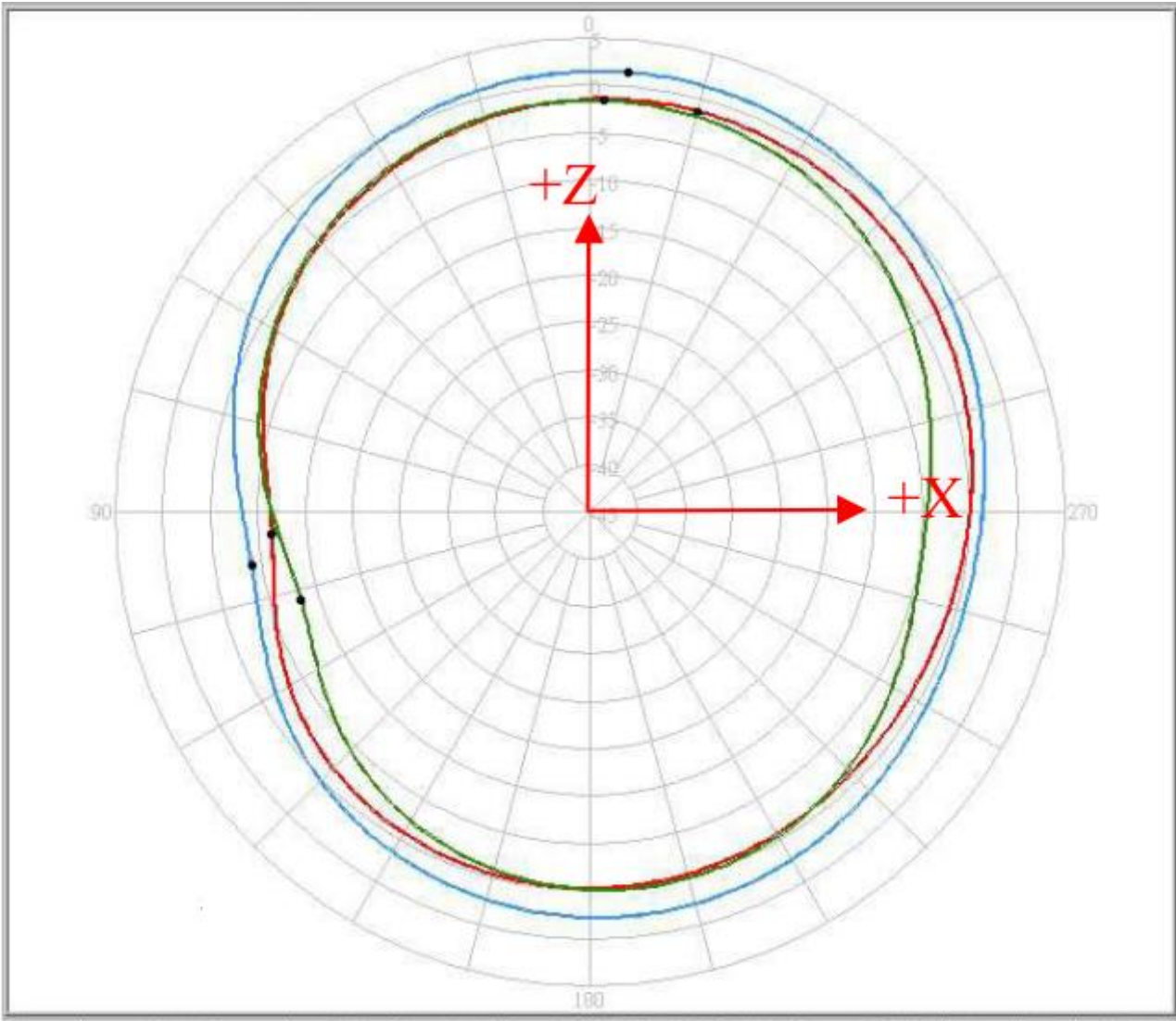

Pattern	Model No.	Test Mode	Freq(MHz)	Max Gain(dBi)	Min Gain(dBi)	Avg. Gain(dBi)	Source Polar.	Date
1	GP.1575.25.4.A.02	XZ	1575.00	-1.28 / 345.00	-11.43 / 94.00	-4.54	Hor.	2013/7/26
2	GP.1575.25.4.A.02	XZ	1575.00	-1.60 / 358.00	-13.17 / 107.00	-5.50	Ver.	2013/7/26
3	GP.1575.25.4.A.02	XZ	1575.00	1.53 / 355.00	-8.89 / 99.00	-1.98	V+H	2013/7/26

## 4.2 YZ Patterns

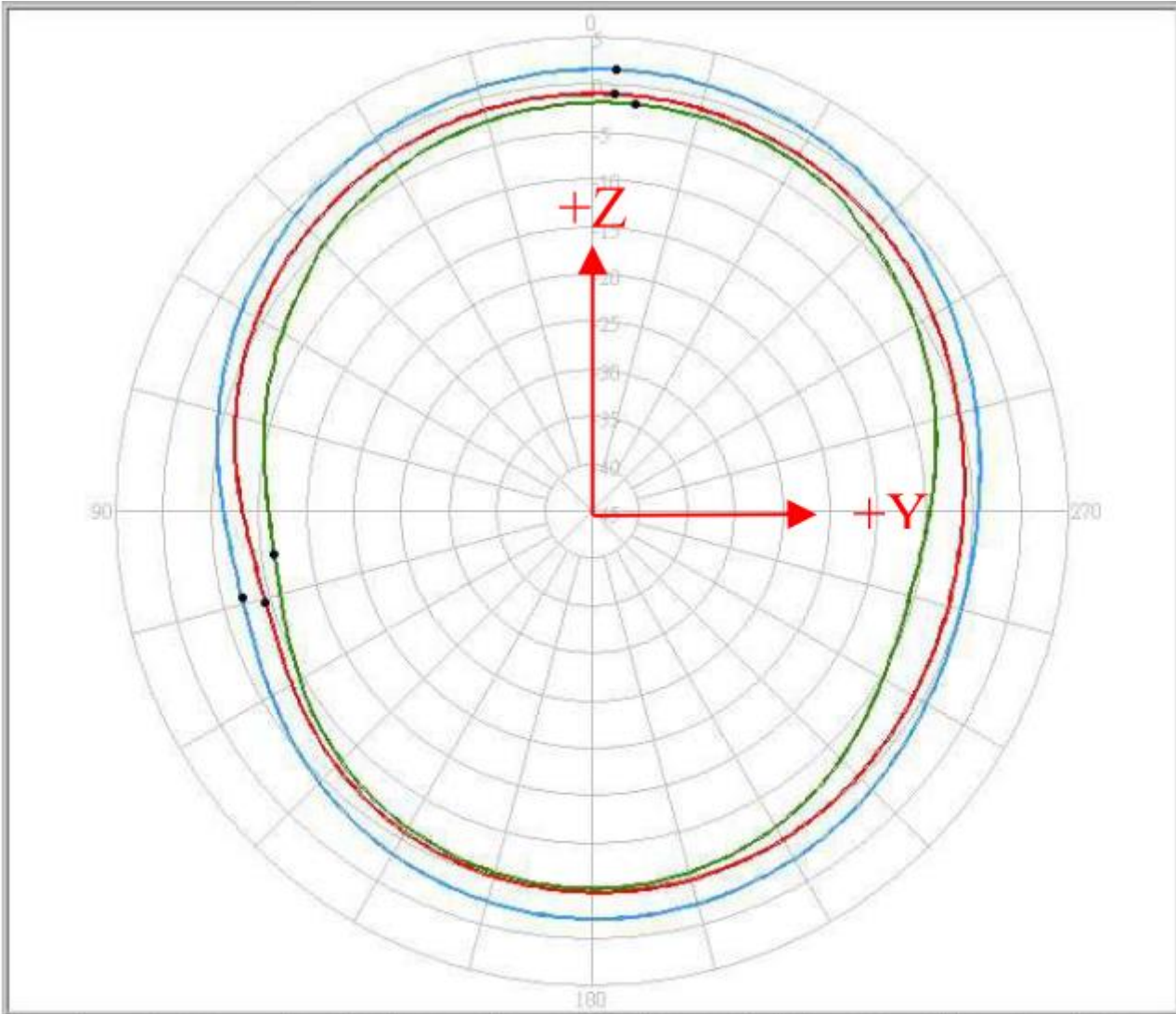

Pattern	Model No.	Test Mode	Freq(MHz)	Max Gain(dBi)	Min Gain(dBi)	Avg. Gain(dBi)	Source Polar.	Date
1	GP.1575.25.4.A.02	YZ	1575.00	-1.00 / 356.97	-9.42 / 105.88	-4.18	Hor.	2013/7/26
2	GP.1575.25.4.A.02	YZ	1575.00	-1.88 / 353.83	-11.35 / 97.71	-5.68	Ver.	2013/7/26
3	GP.1575.25.4.A.02	YZ	1575.00	1.59 / 356.91	-7.16 / 103.89	-1.87	V+H	2013/7/26



## 5. Gain Pattern Value

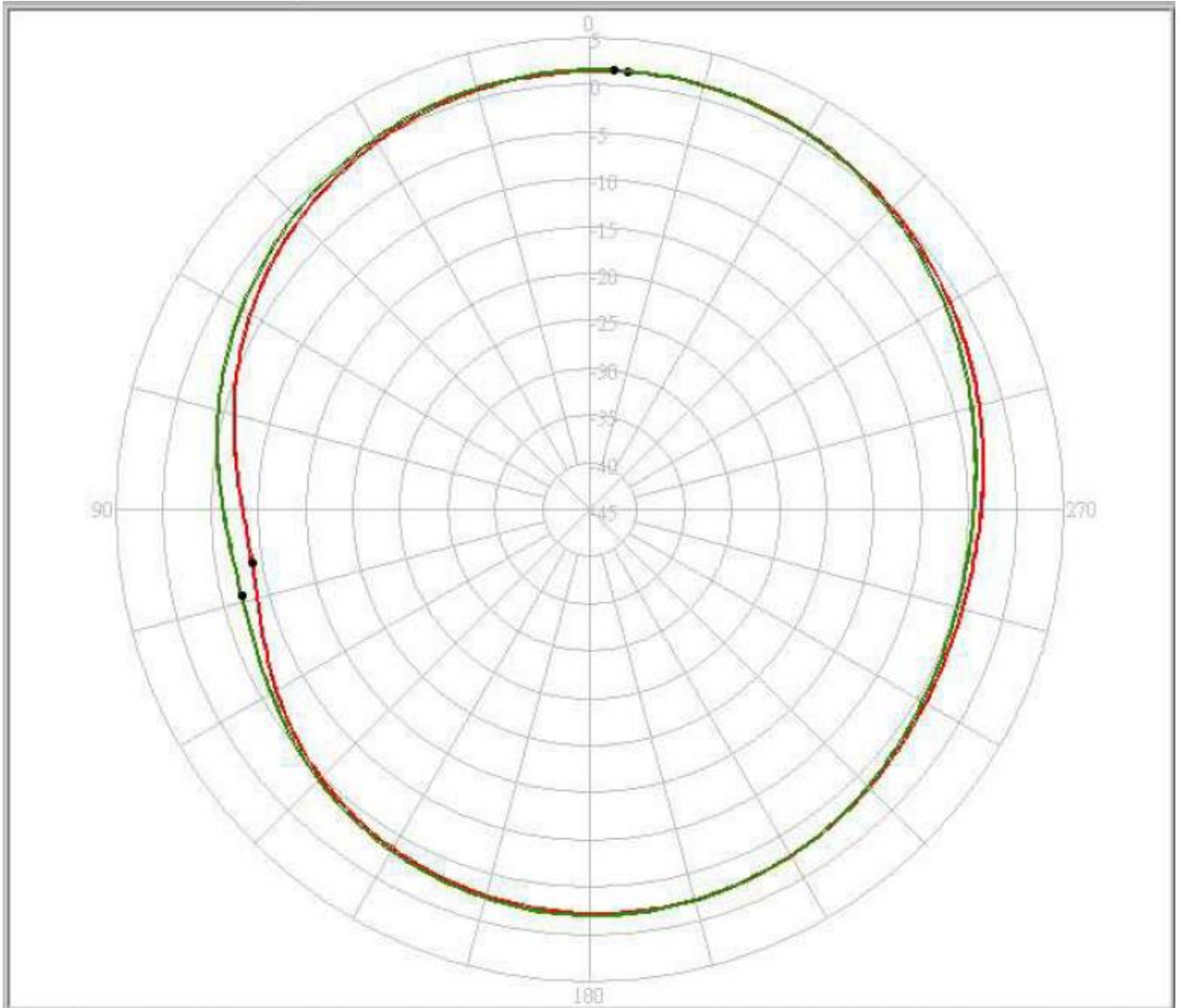

Pattern	Model No.	Test Mode	Freq(MHz)	Max Gain(dBi)	Min Gain(dBi)	Avg. Gain(dBi)	Source Polar.	Date
1	GP.1575.25.4.A.02	XZ	1575.00	1.53 / 355.00	-8.89 / 99.00	-1.98	V+H	2013/7/26
2	GP.1575.25.4.A.02	YZ	1575.00	1.59 / 356.91	-7.16 / 103.89	-1.87	V+H	2013/7/26

Angle	XZ-Plane	YZ-Plane
90°	-8.37	-6.59
75°	-6.12	-4.70
60°	-3.66	-2.80
45°	-1.65	-1.05
30°	-0.11	0.26
15°	0.94	1.14
0°	1.45	1.55
345°	1.46	0.00
330°	0.99	0.00
315°	0.11	0.57
300°	-1.10	-0.82
285°	-2.45	-2.45
270°	-3.69	-3.94

(Unit : dBi)

## 6. Axial Ratio Pattern

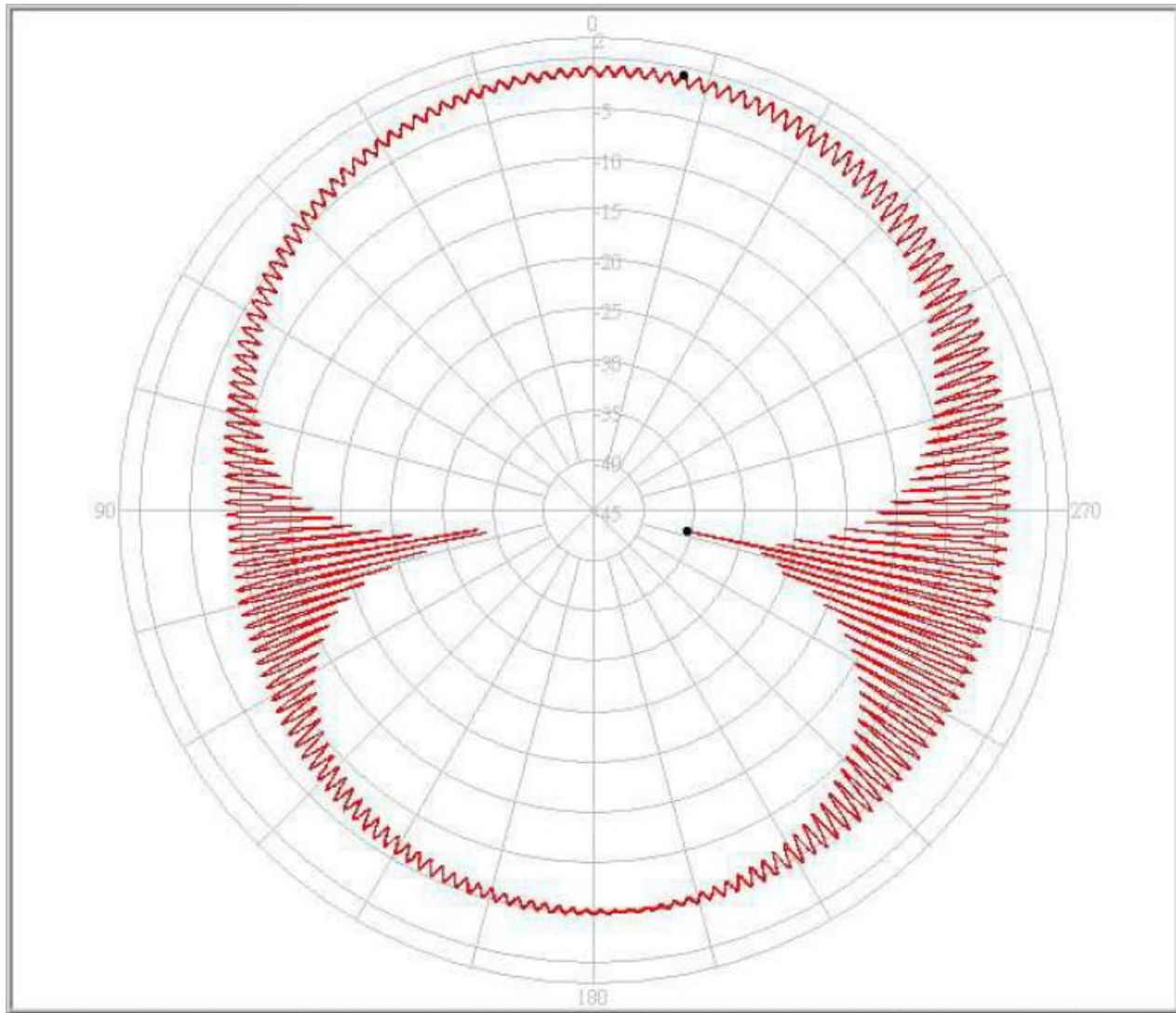

Pattern	Model No.	Test Mode	Freq(MHz)	Max Gain(dBi)	Min Gain(dBi)	Avg. Gain(dBi)	Source Polar.	Date
1	GP.1575.25.4.A.02	Axial Ratio	1575.42	-0.84 / 348.27	-35.58 / 257.52	-4.86	CP	2013/7/26

Angle	Axial Ratio
90°	10.17
75°	3.27
60°	2.03
45°	1.51
30°	1.14
15°	0.87
0°	0.83
345°	1.14
330°	1.88
315°	2.94
300°	4.58
285°	6.86
270°	12.88

( At 1575.42MHz )

## 7. 2D Mechanical Drawing

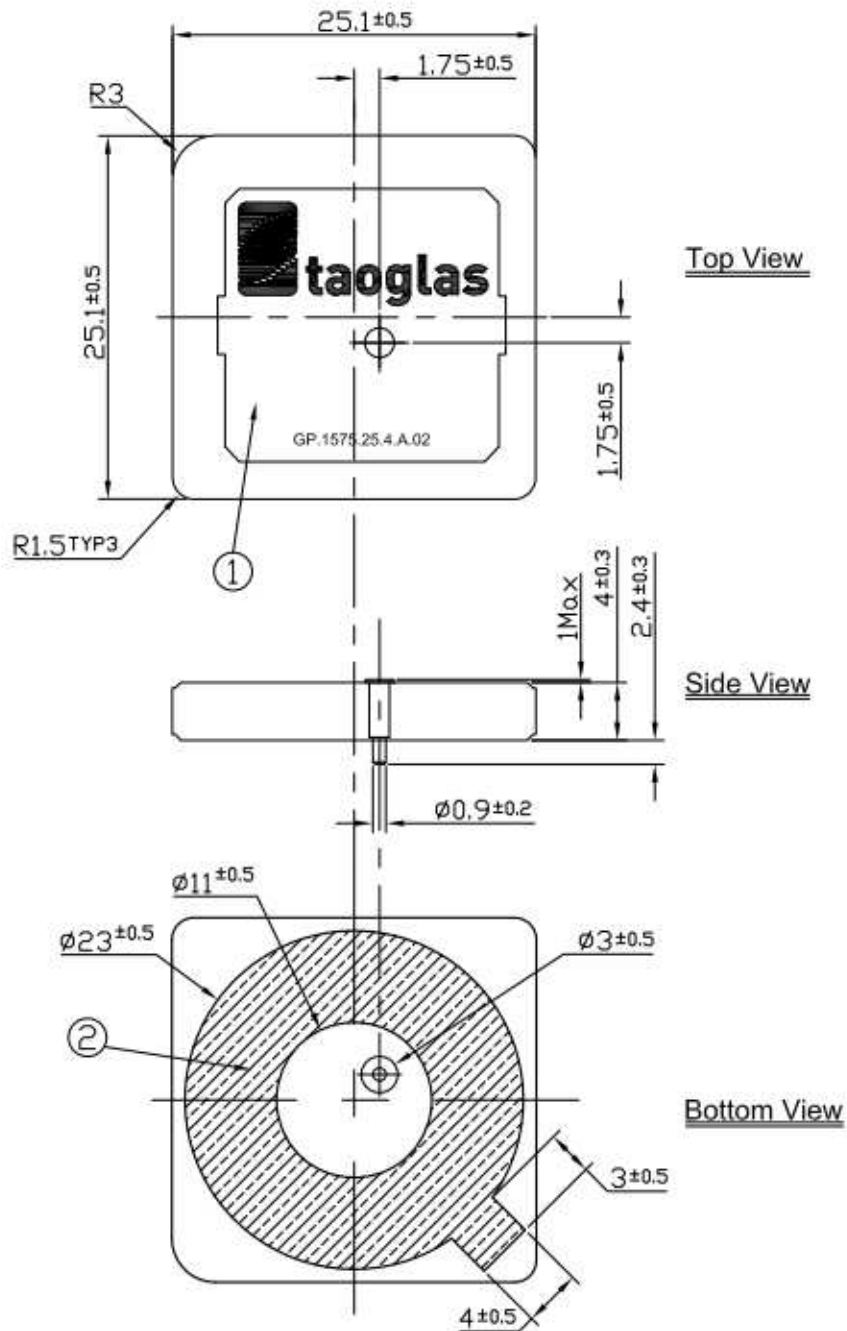

**NOTES:**

1. Double sided adhesive area 

	Name	Material	Finish	QTY
1	GP.1575 Patch 25x25x4	Ceramic	Clear	1
2	Double sided Adhesive	NITTO 5015	White Liner	1

### 5.1 Layout Dimension

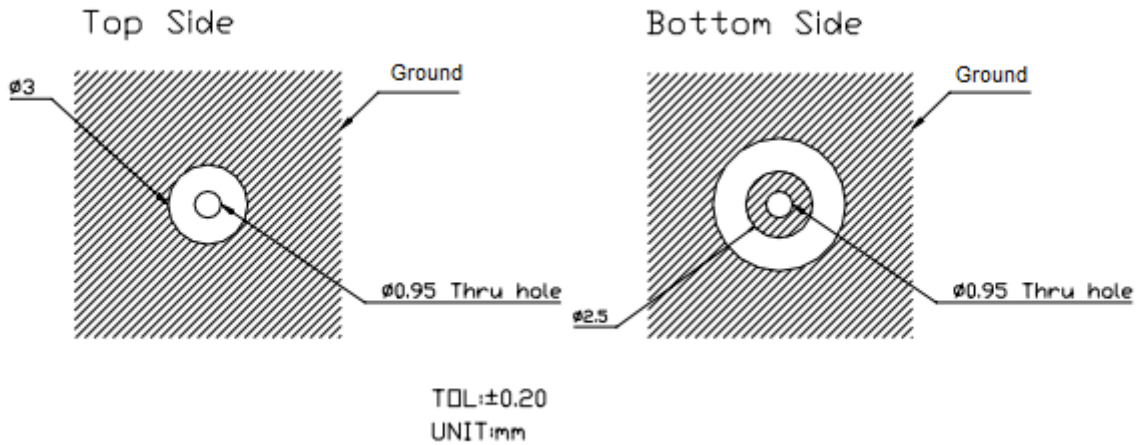

\*Note Layout Dimensions may be affected by the thickness of the PCB

### 8. Test Jig and Dimension

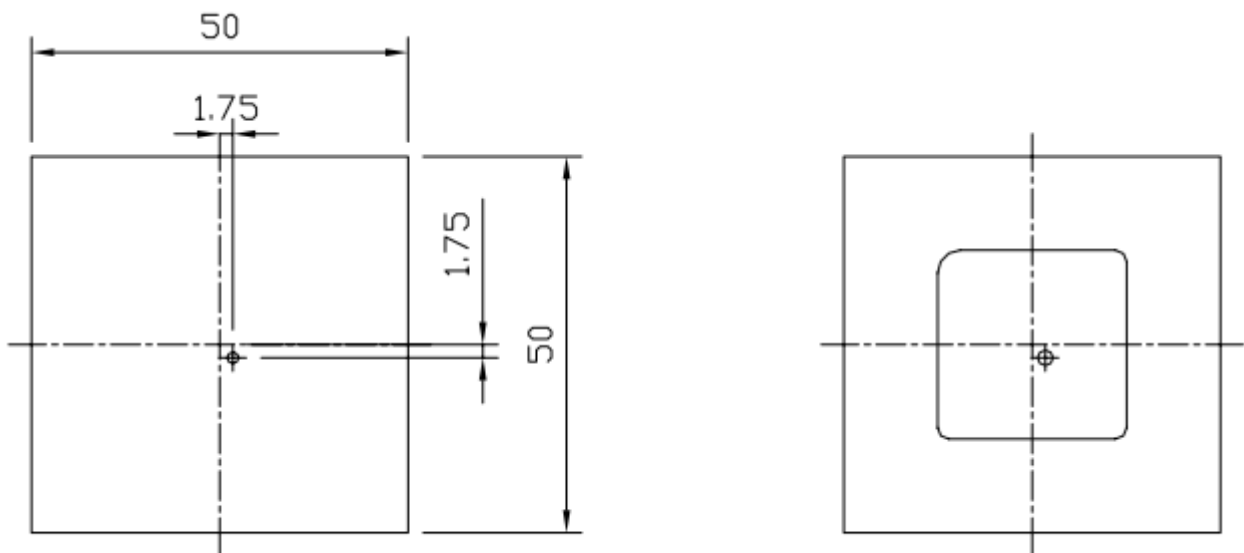

## 8.1 Test Fixture Antenna Setup and Measurements

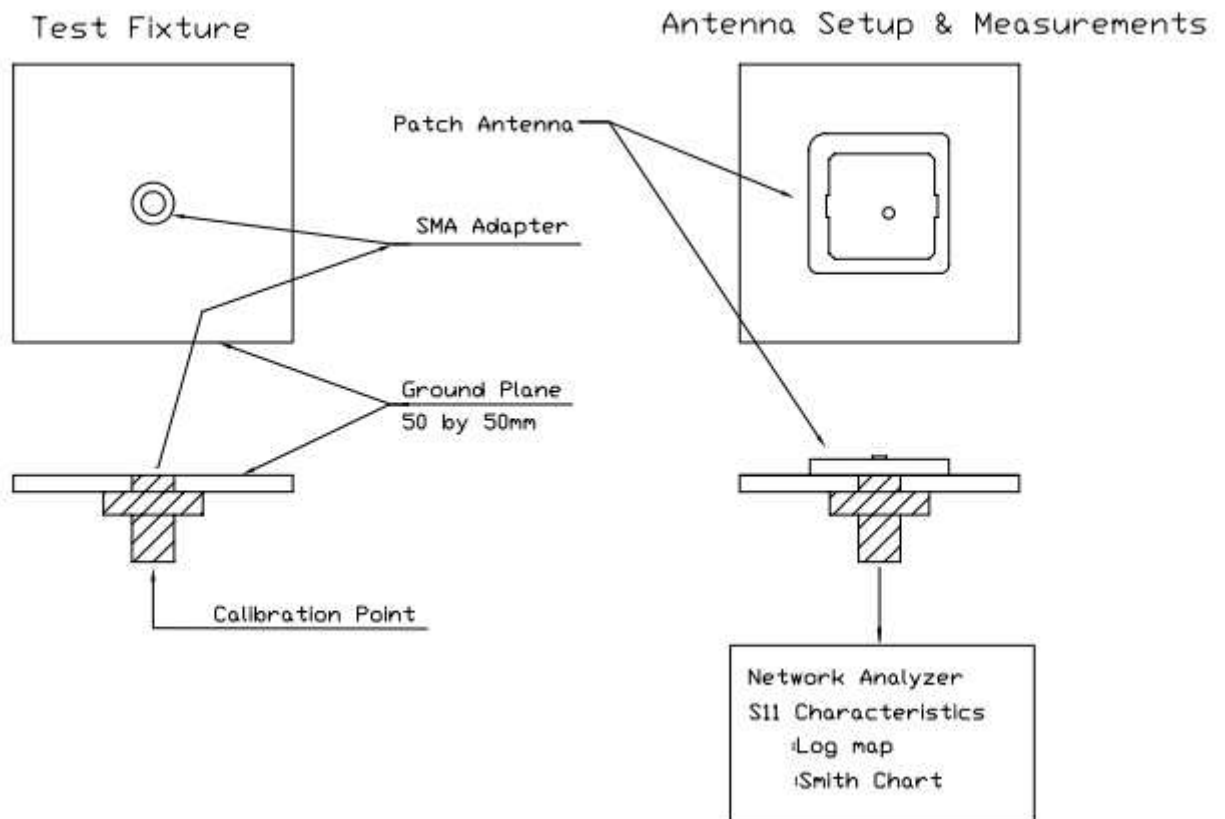

## 9. Packaging

50 pieces per Tray

200 per Inner Carton

4 x 200 – 800 pieces per Outer Carton

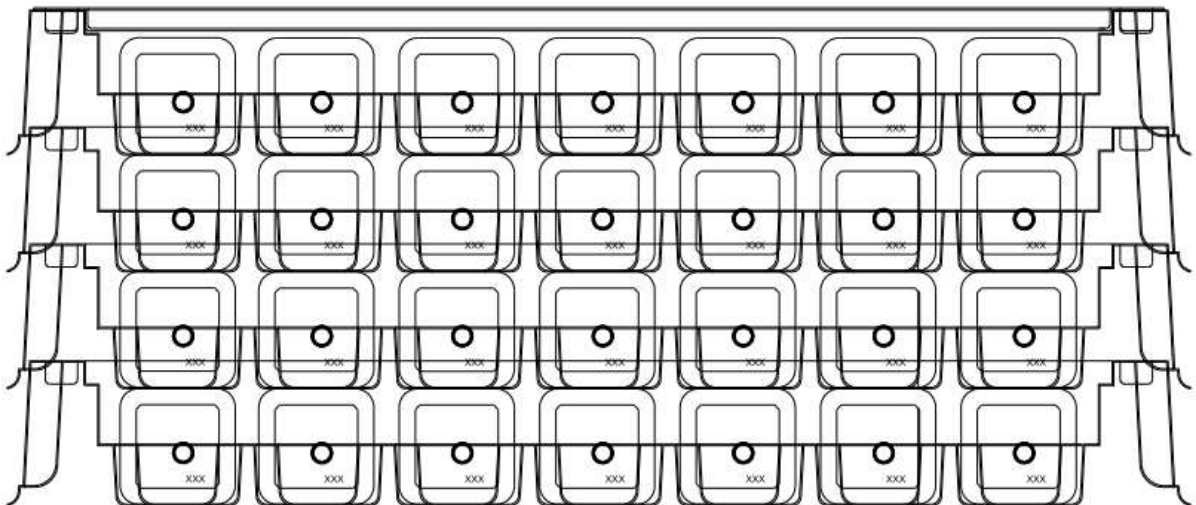
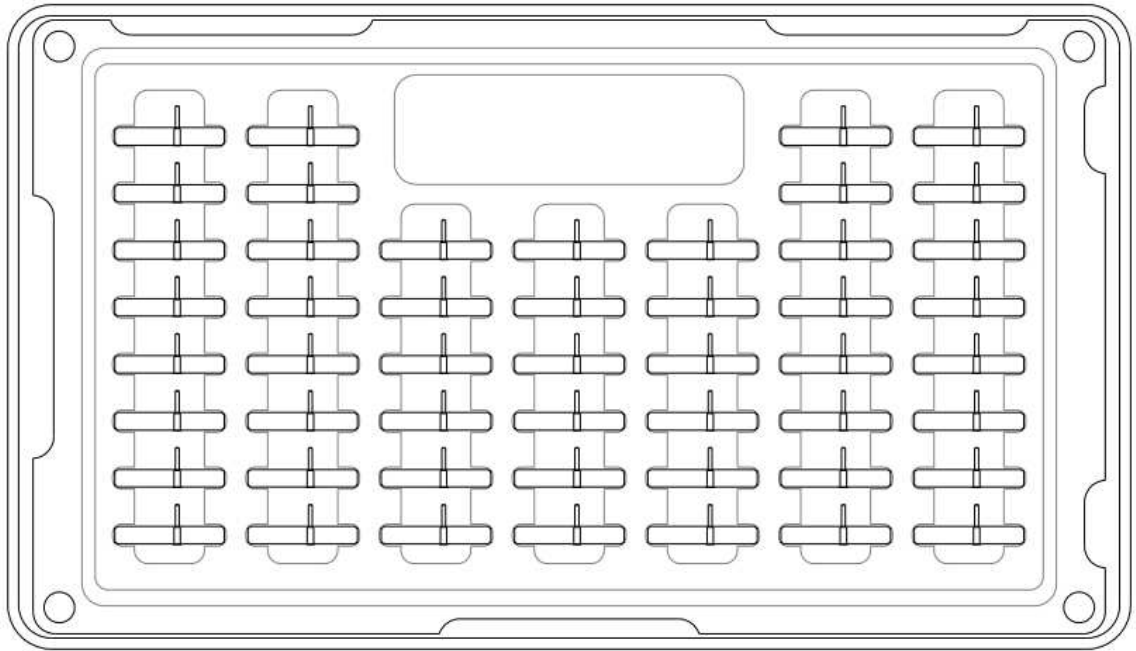



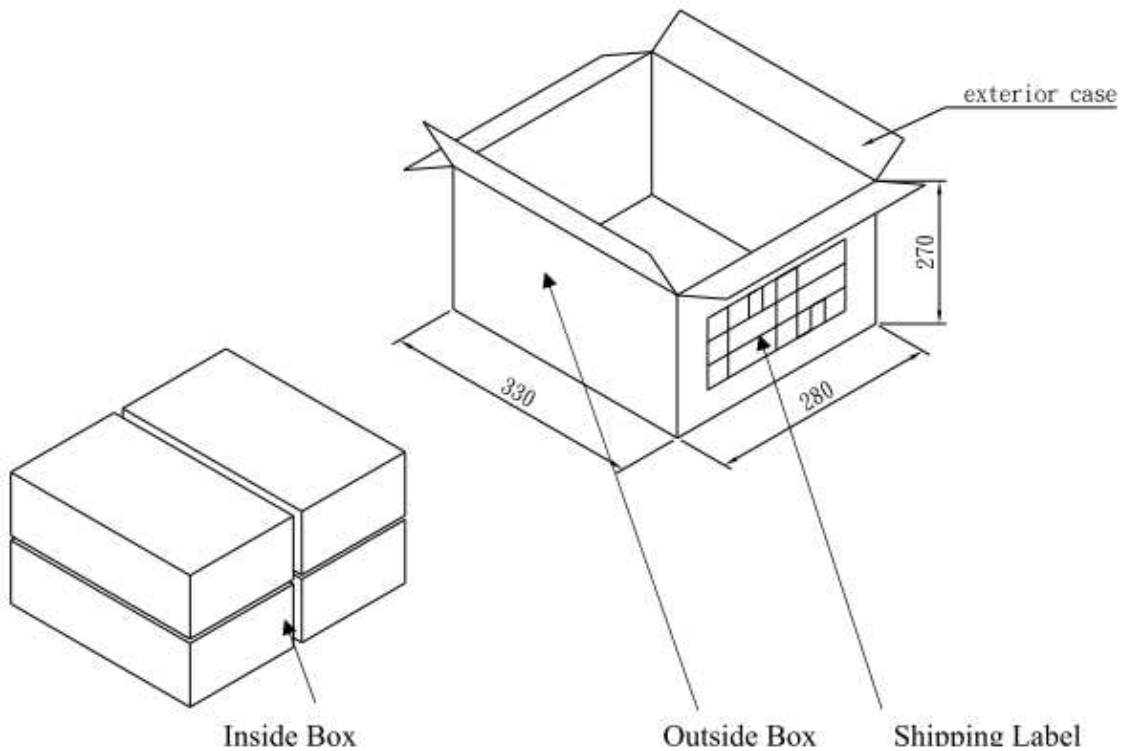
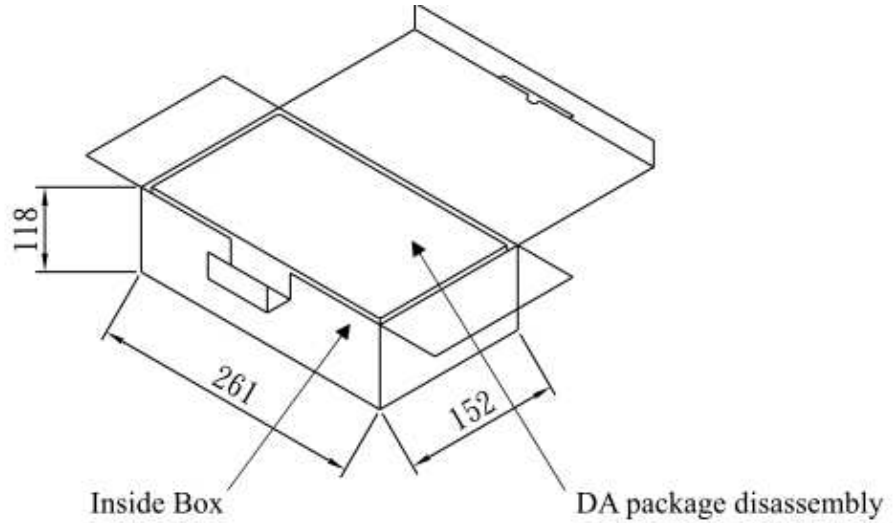

Taoglas makes no warranties based on the accuracy or completeness of the contents of this document and reserves the right to make changes to specifications and product descriptions at any time without notice. Taoglas reserves all rights to this document and the information contained herein.

Reproduction, use or disclosure to third parties without express permission is strictly prohibited.

Copyright © Taoglas Ltd.