



Chipsmall Limited consists of a professional team with an average of over 10 year of expertise in the distribution of electronic components. Based in Hongkong, we have already established firm and mutual-benefit business relationships with customers from,Europe,America and south Asia,supplying obsolete and hard-to-find components to meet their specific needs.

With the principle of “Quality Parts,Customers Priority,Honest Operation,and Considerate Service”,our business mainly focus on the distribution of electronic components. Line cards we deal with include Microchip,ALPS,ROHM,Xilinx,Pulse,ON,Everlight and Freescale. Main products comprise IC,Modules,Potentiometer,IC Socket,Relay,Connector.Our parts cover such applications as commercial,industrial, and automotives areas.

We are looking forward to setting up business relationship with you and hope to provide you with the best service and solution. Let us make a better world for our industry!



## Contact us

Tel: +86-755-8981 8866 Fax: +86-755-8427 6832

Email & Skype: info@chipsmall.com Web: www.chipsmall.com

Address: A1208, Overseas Decoration Building, #122 Zhenhua RD., Futian, Shenzhen, China



## SPECIFICATION

Part No. : **GP.1575.35.3.A.02**

Specification No : **GP.35A**

Product Name : **3.5mm thick GPS Patch Antenna, 1575MHz**

Features : 35mm\*35mm\*3.5mm  
ROHS Compliant

:



## 1. Introduction

This 35\*35mm ceramic GPS patch antenna is based on smart *XtremeGain*<sup>™</sup> technology. It is mounted via pin and double-sided adhesive and has been tuned as the optimal solution for the customer device environment.

## 2. Key Antenna Performance Indicators

Original Patch Specification tested on 50\*50mm ground plane

No	Parameter	Specification
1	Center Frequency	1575MHz ± 6MHz
2	Bandwidth	22MHz min
3	VSWR	1.5 max
4	Gain at Zenith	2.0 dBic typ.
5	Gain at 10°elevation	1.5dBic typ.
6	Axial Ratio	3 dB max
7	Polarization	RHCP
8	Impedance	50 Ohms
9	Frequency Temperature Coefficient ( $\tau_f$ )	0 ± 20ppm / °C
10	Operating Temperature	-40°C to +85°C



### 3. TEST SET UP

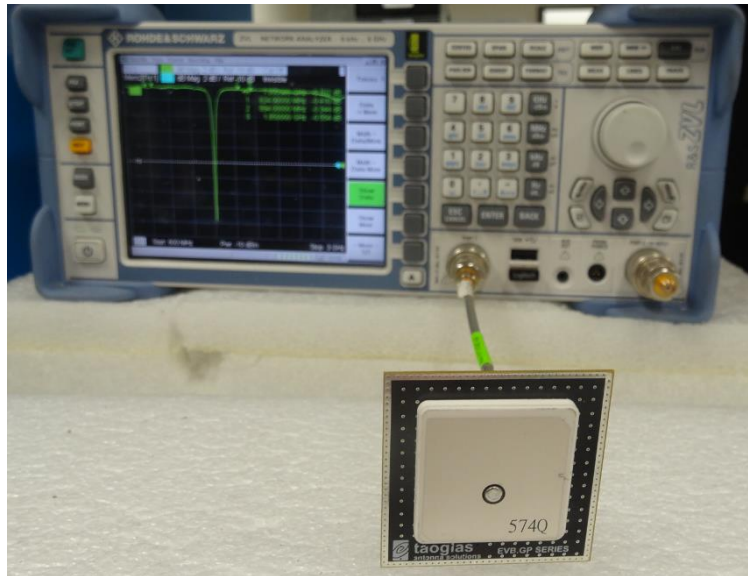

**Figure 1.** Return Loss measurement.

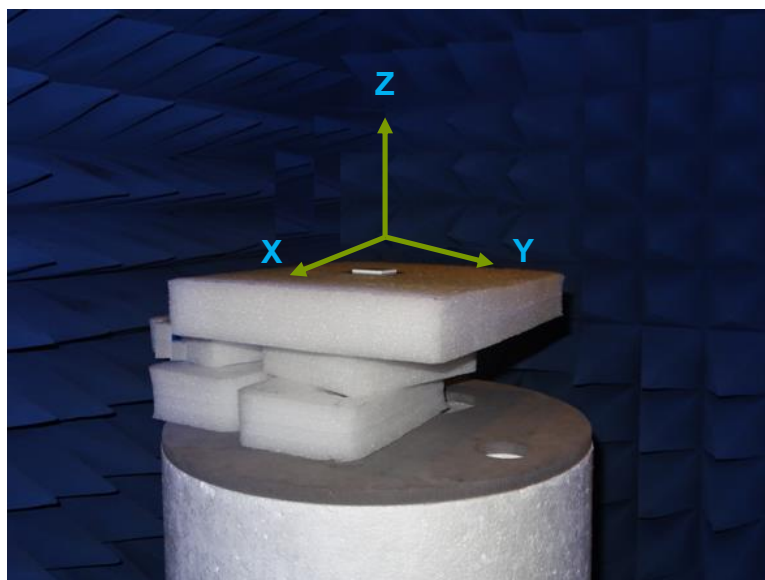

**Figure 2.** Peak gain, average gain, efficiency and radiation pattern measurements.

## 4. ANTENNA PARAMETERS

### 4.1. Return Loss

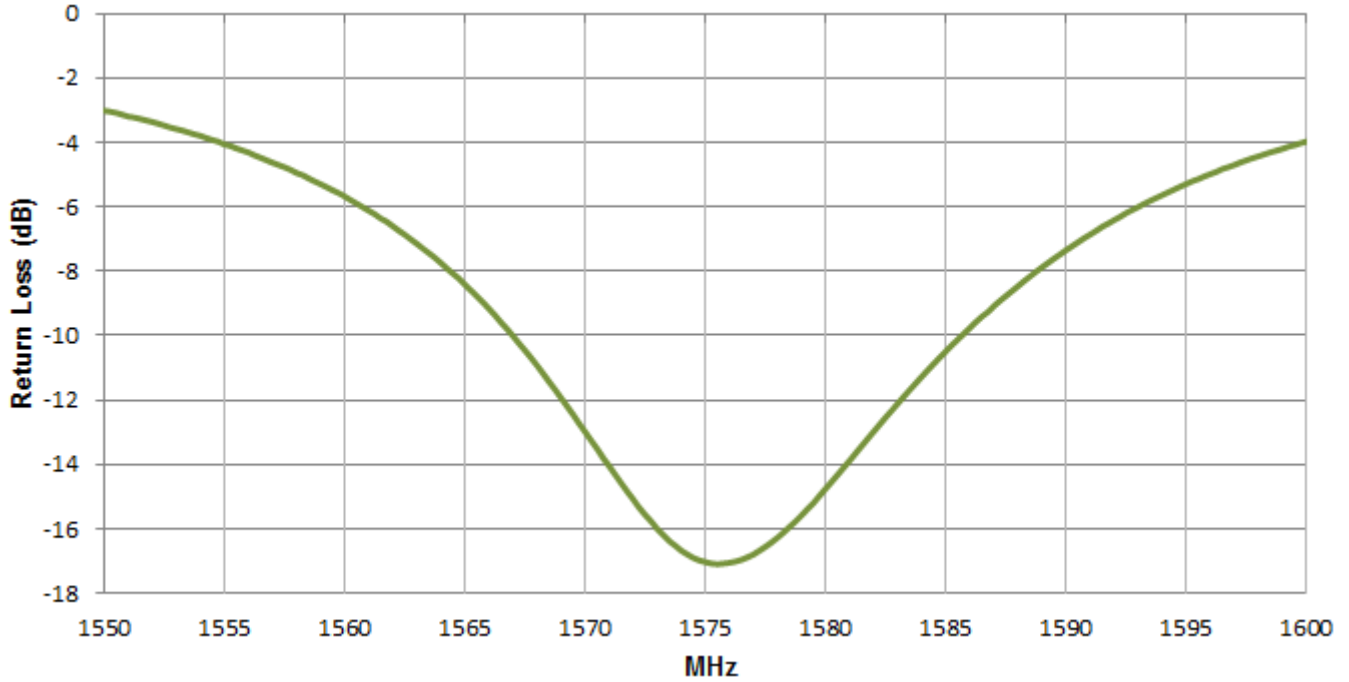

Figure 3. Return Loss of the GP.1575.35.A.02

### 4.2. VSWR

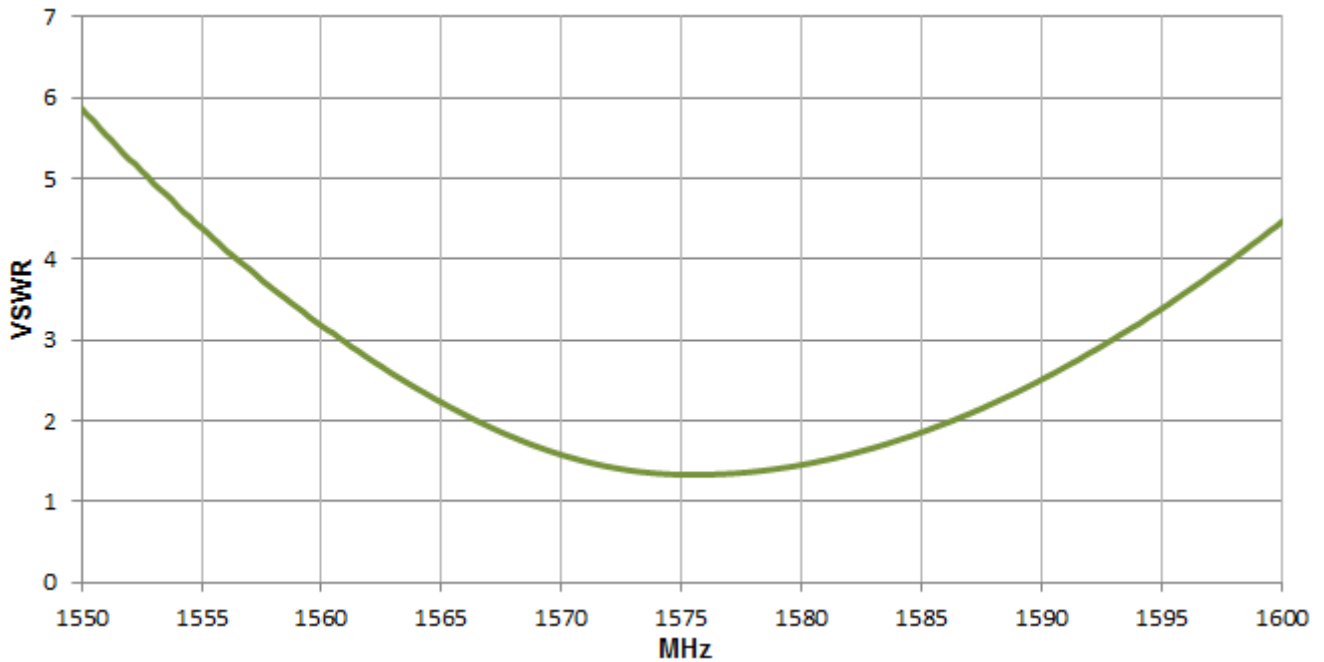
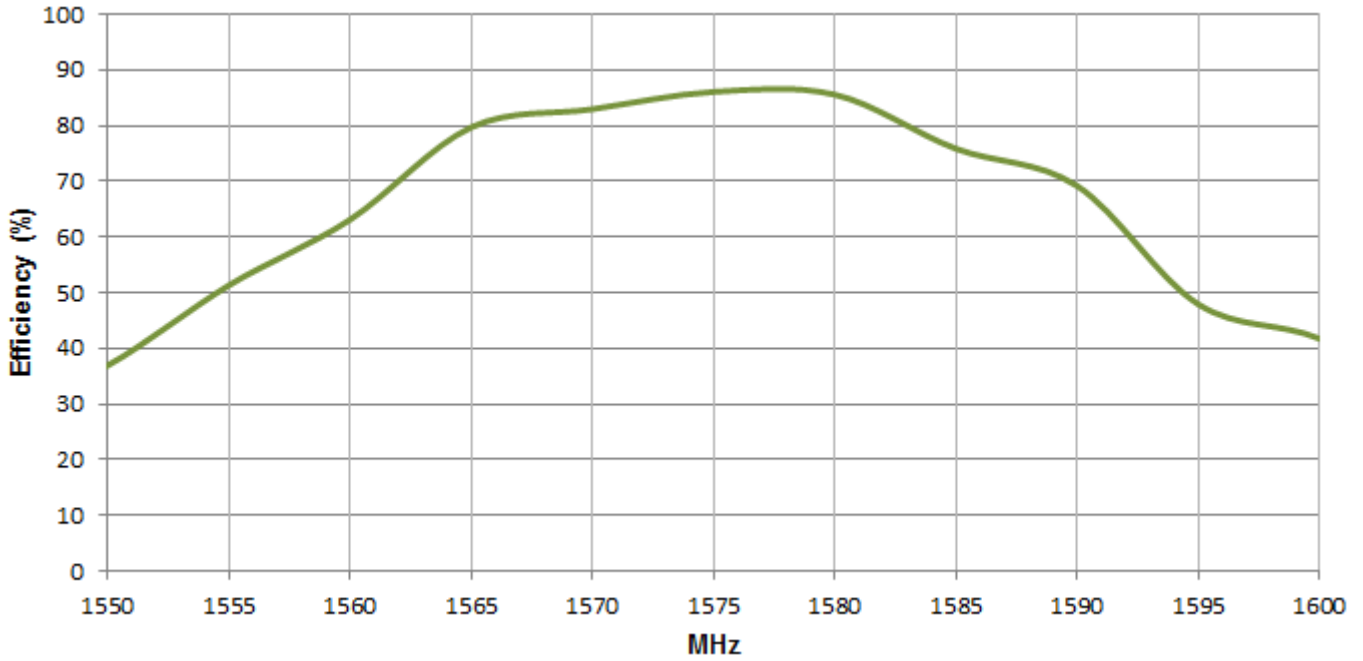

Figure 4. VSWR of the GP.1575.35.A.02

### 4.3. Efficiency



**Figure 5.** Efficiency of the GP.1575.35.A.02

### 4.4. Peak Gain

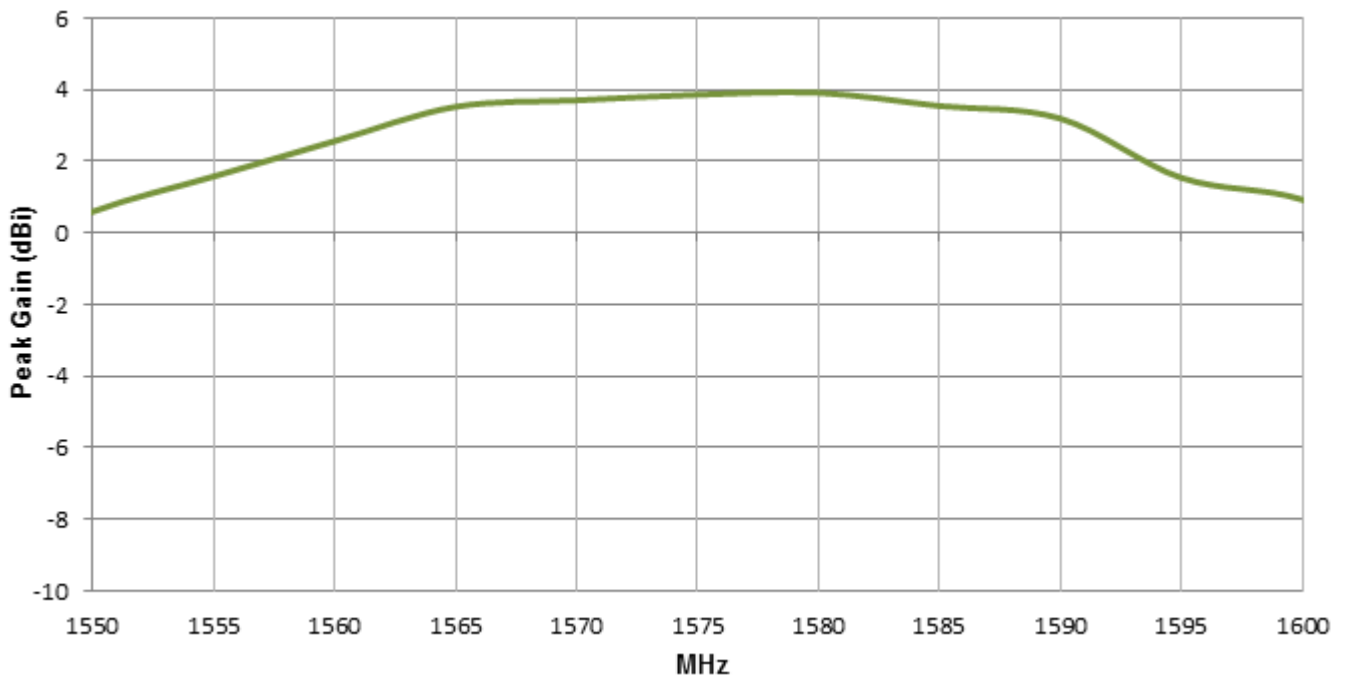

**Figure 6.** Peak Gain of the GP.1575.35.A.02.

## 5. 2D Radiation

### 5.1 XZ Plane Radiation

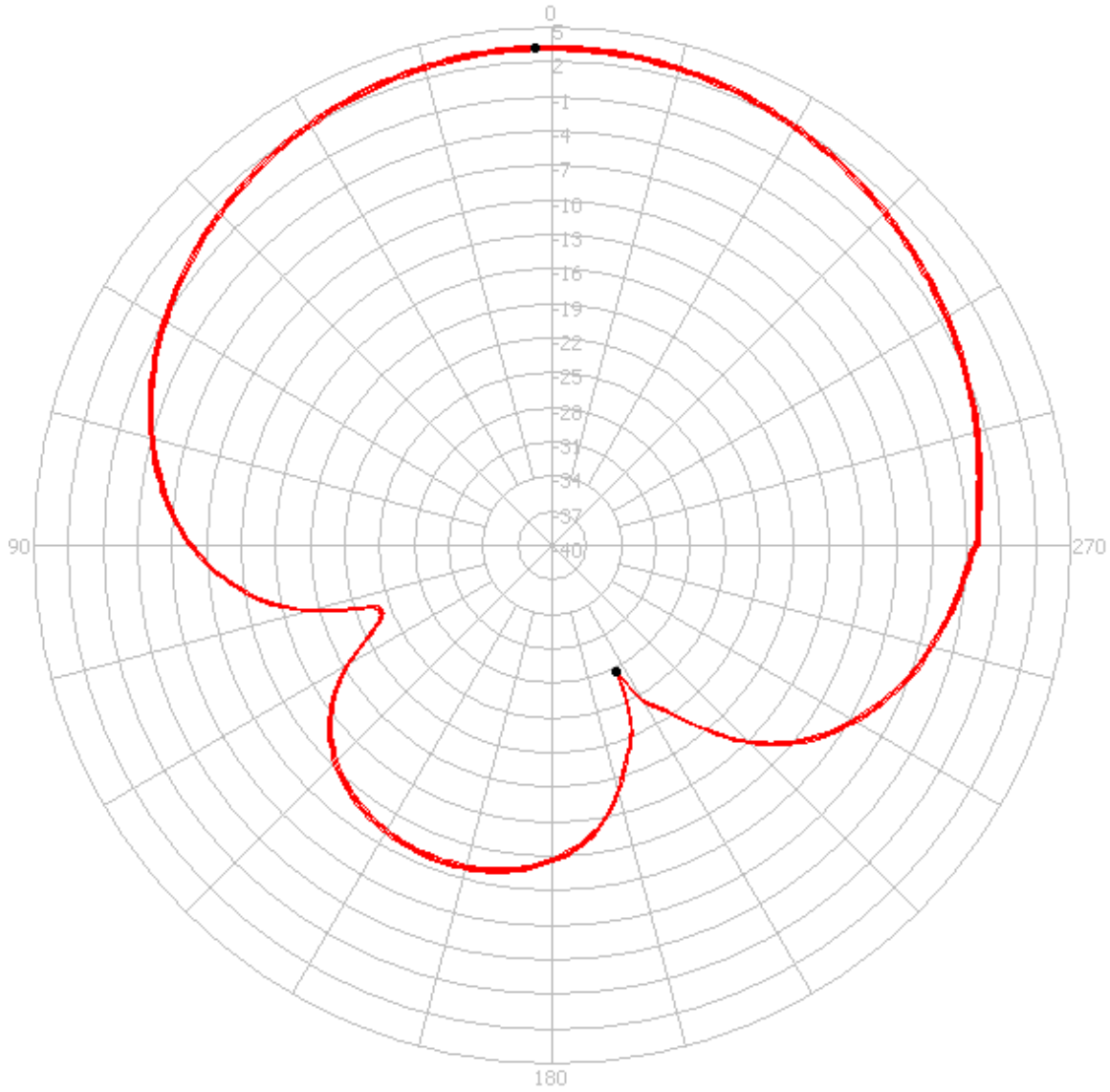

## 5.2 YZ Plane Radiation

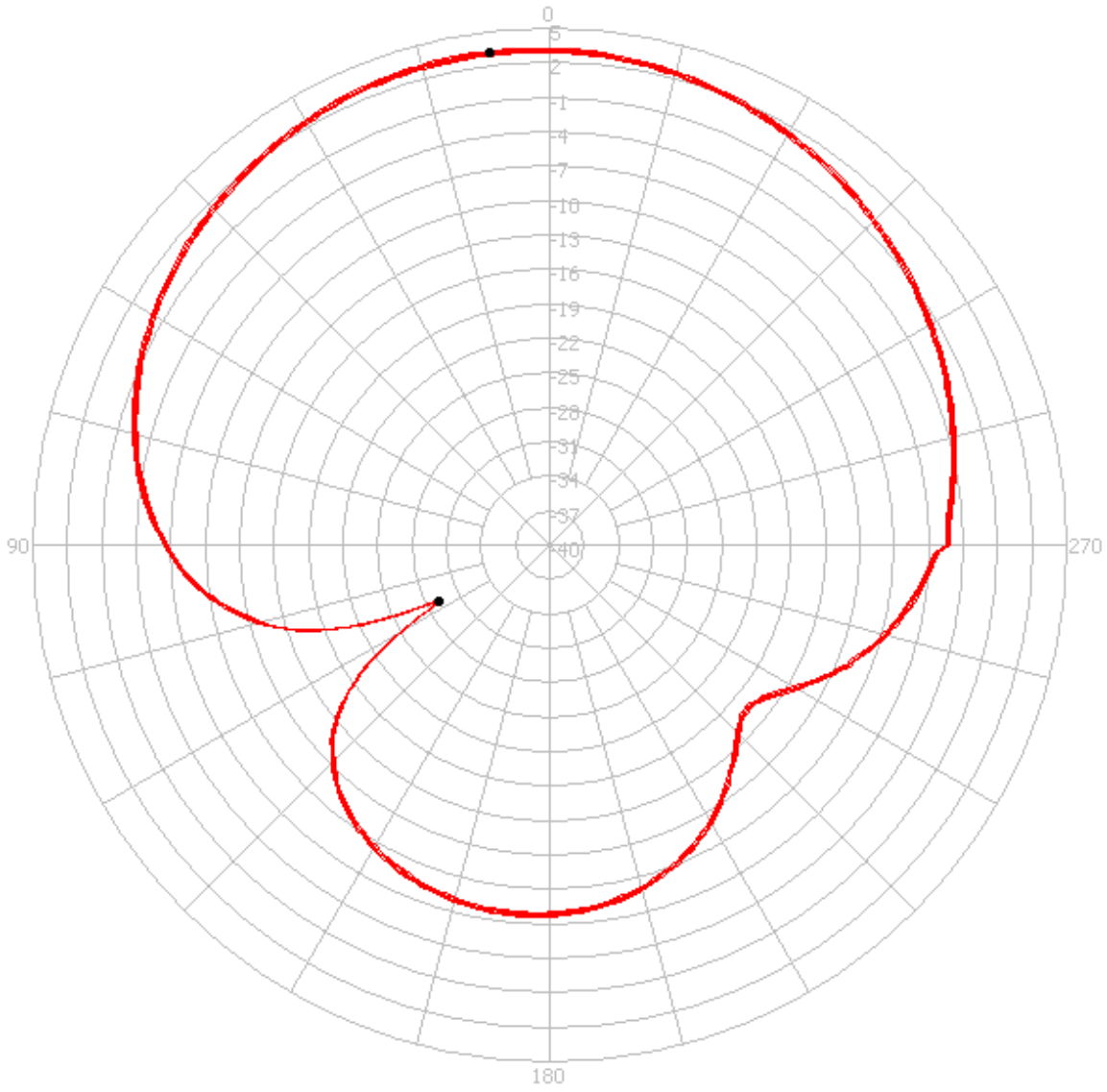



### 5.3 Axial Ratio

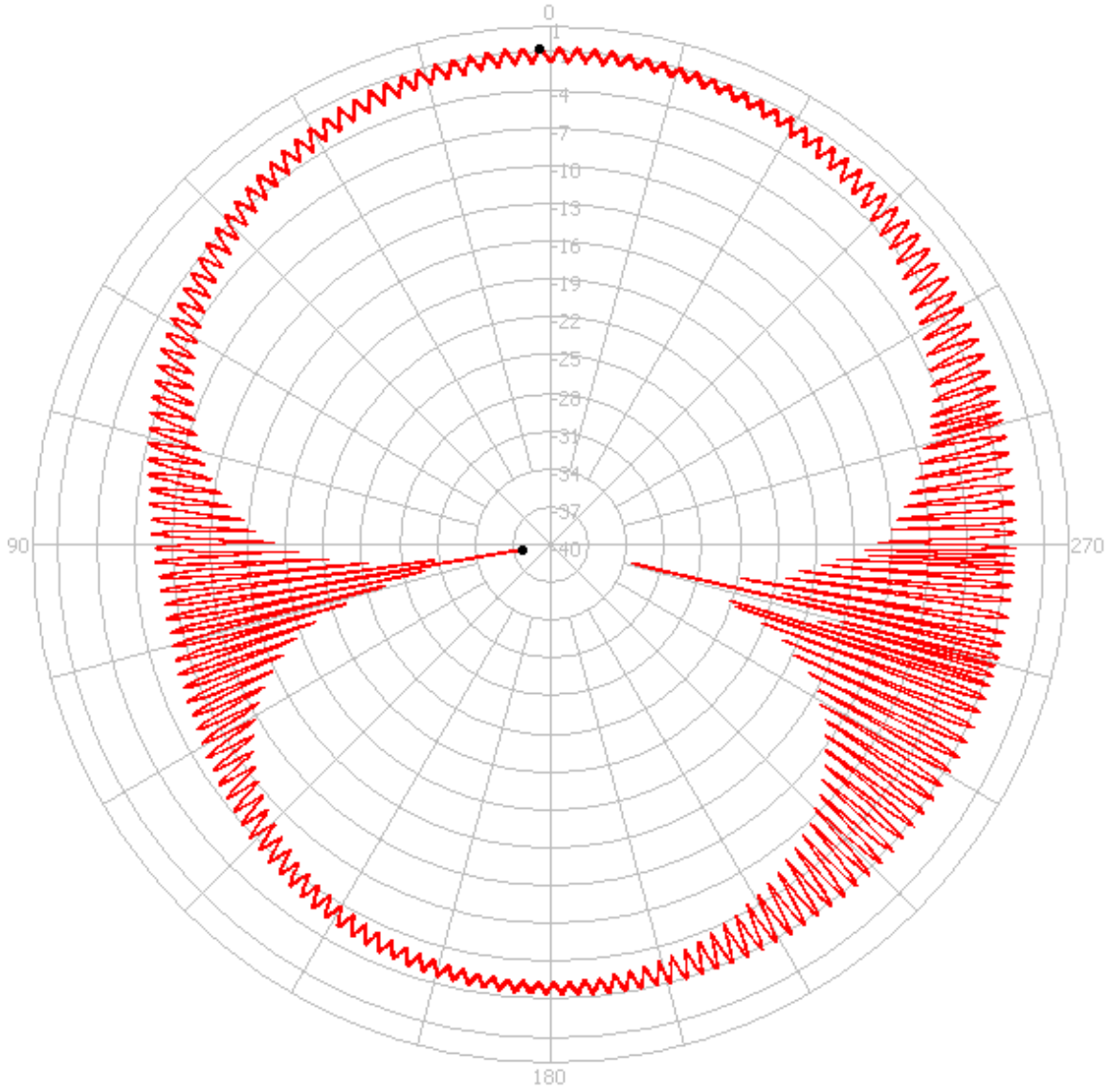

## 5.4 3D Radiation

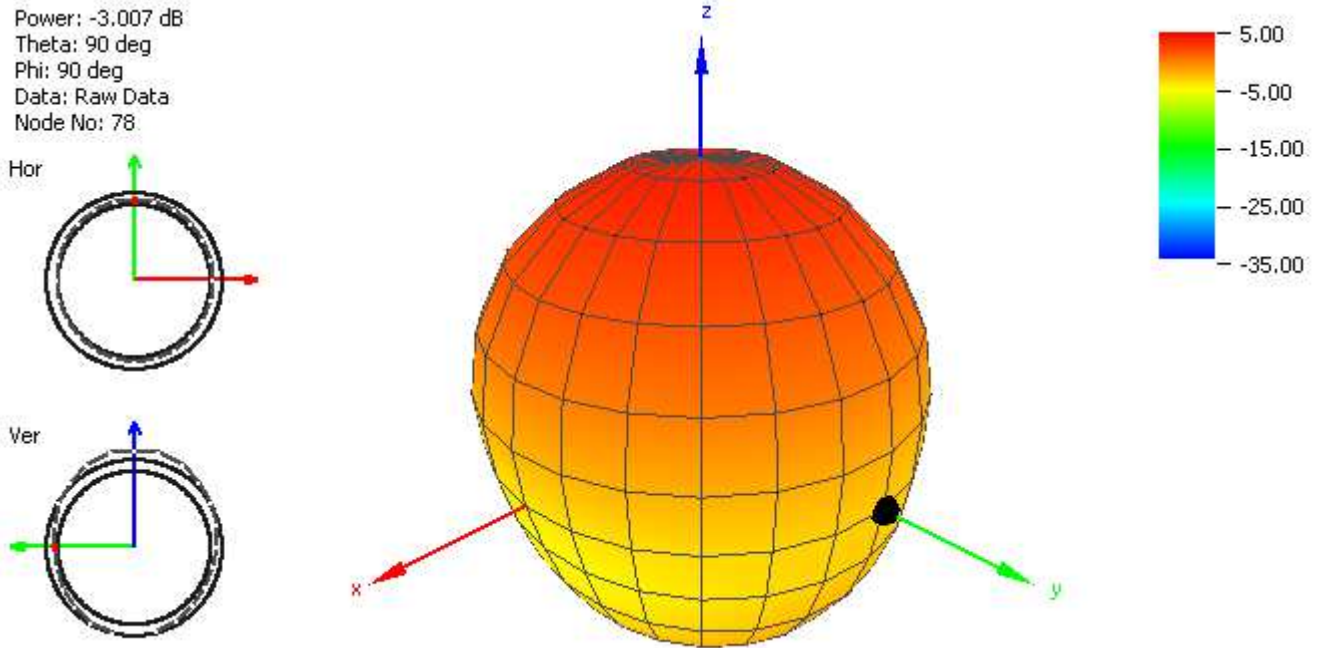

**Figure 7.** Radiation Pattern of the GP.1575.35.A.02 at 1575Mhz.

## 6 . Mechanical Drawing

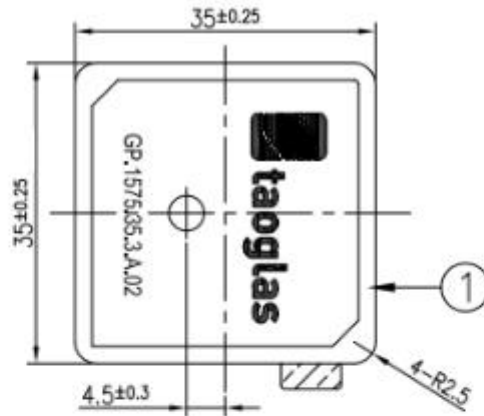

Top View



Side View

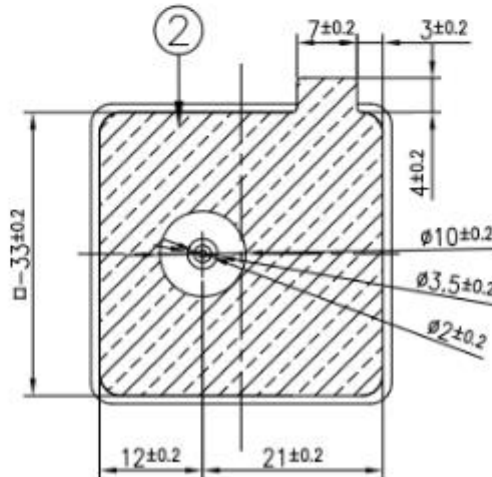

Bottom View

	Name	Material	Finish	QTY	NOTES:
1	GP.35 Patch 35x35x3.5	Ceramic	Clear	1	1.Double sided adhesive area. 
2	Double sided Adhesive	NITTO 5015	White Liner	1	

## 6.1 Adhesive Thickness

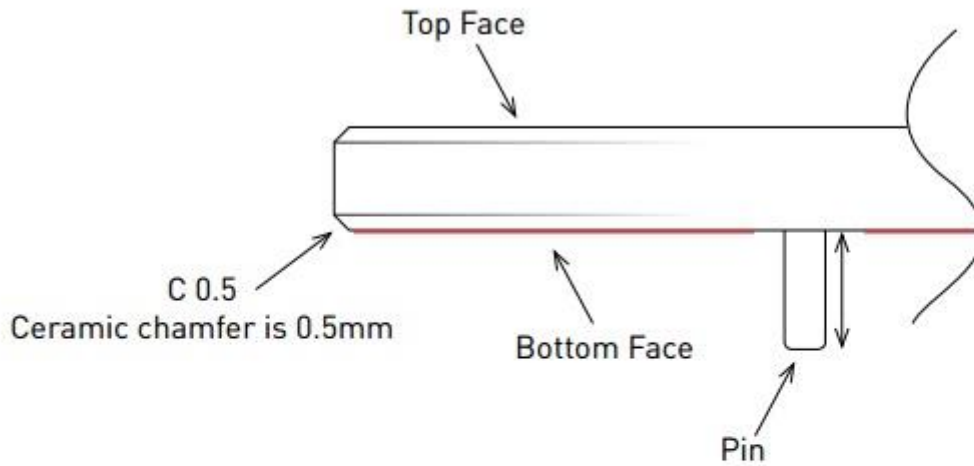

**Red Line** shows the adhesive without Liner – thickness 0.08–0.1mm

## 6.2 Layout Dimensions

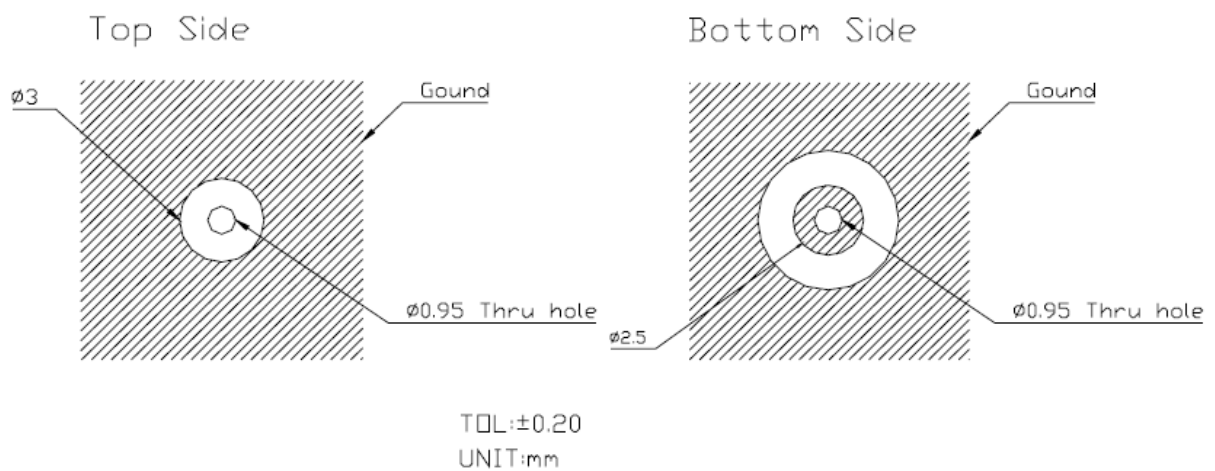

### 6.3 Test Fixture Antenna Setup and Measurements

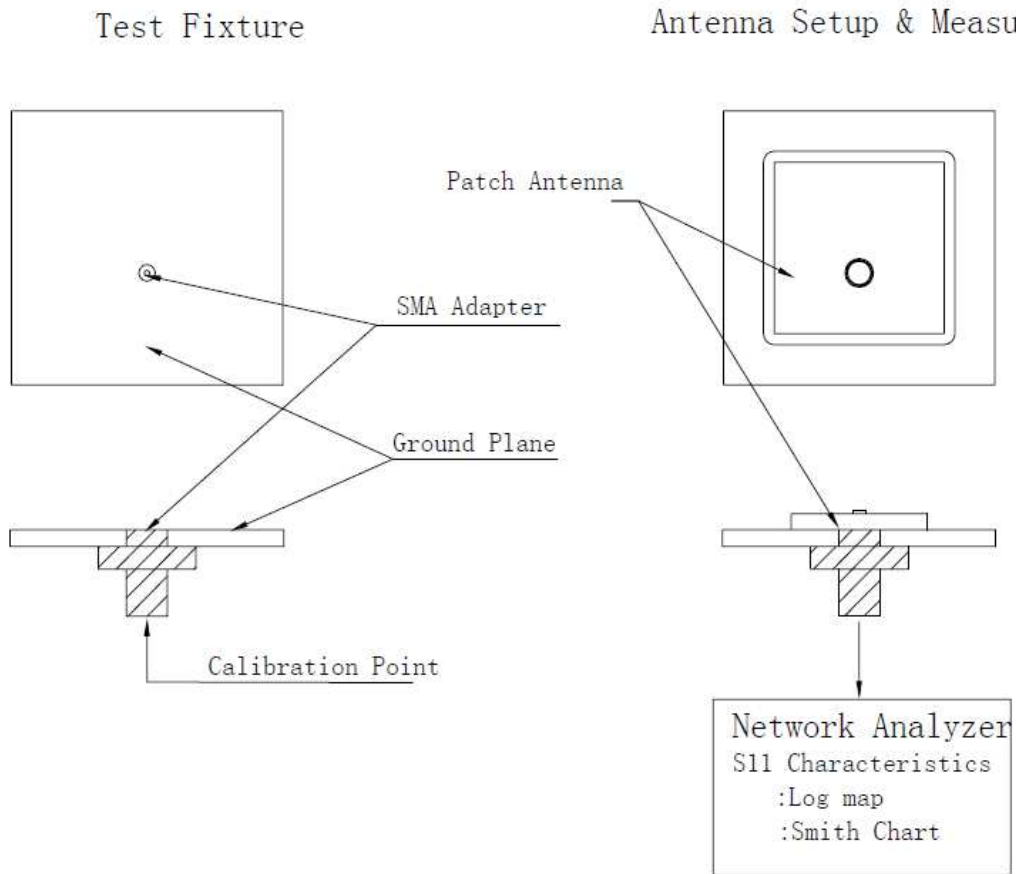

# 7. Packaging

**GP.1575.35.3.A.02**

## Packaging Specifications

12 pcs GP.1575.35.3.A.02 per tray  
 Tray Dimensions - 261\*152mm  
 Total Weight - 270g

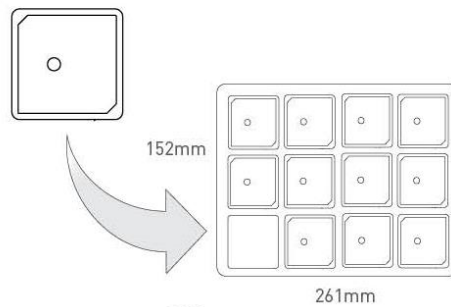

6 trays / 72 pcs per small box  
 Box Dimensions - 261\*152\*118  
 Weight - 1.6Kg

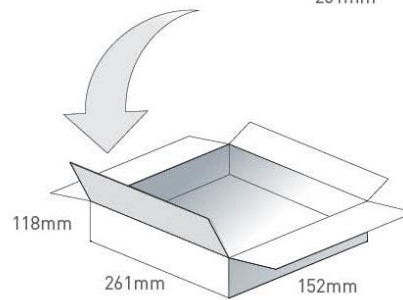

4 boxes / 288 pcs per carton  
 Carton Dimensions - 330\*280\*270mm  
 Weight - 6.6Kg

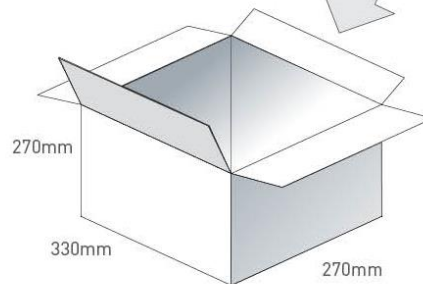

Pallet Dimensions 1100mm\*1120mm\*1500mm  
 60 Cartons per pallet  
 12 Cartons per layer  
 5 Layers

