



Chipsmall Limited consists of a professional team with an average of over 10 year of expertise in the distribution of electronic components. Based in Hongkong, we have already established firm and mutual-benefit business relationships with customers from,Europe,America and south Asia,supplying obsolete and hard-to-find components to meet their specific needs.

With the principle of "Quality Parts,Customers Priority,Honest Operation,and Considerate Service",our business mainly focus on the distribution of electronic components. Line cards we deal with include Microchip,ALPS,ROHM,Xilinx,Pulse,ON,Everlight and Freescale. Main products comprise IC,Modules,Potentiometer,IC Socket,Relay,Connector.Our parts cover such applications as commercial,industrial, and automotives areas.

We are looking forward to setting up business relationship with you and hope to provide you with the best service and solution. Let us make a better world for our industry!



## Contact us

Tel: +86-755-8981 8866 Fax: +86-755-8427 6832

Email & Skype: info@chipsmall.com Web: www.chipsmall.com

Address: A1208, Overseas Decoration Building, #122 Zhenhua RD., Futian, Shenzhen, China



This document is the property of Amphenol Corporation and is delivered on the express condition that it is not to be disclosed, reproduced or used, in whole or in part, for manufacture or sale by anyone other than Amphenol Corporation without its prior consent, and that no right is granted to disclose or to use any information in this document.

The marking on this product doesn't contain environmental hazardous materials per Material Specification SS-00259 for Sony GP compliant or per directive 2011/65/EU for RoHS compliant.



ORIGINAL



REVISIONS				
SYM	ECN No.	DESCRIPTION	DATE	APPROVED
A	NE-14132	NON-RELEASE TO PRODUCTION	07/08/2014	Arron Lin

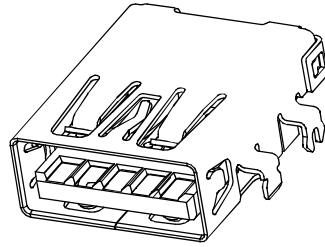
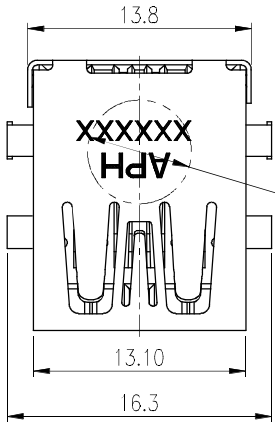

Pin Number	Signal Name
1	VBUS
2	D-
3	D+
4	GND
5	SSRX-
6	SSRX+
7	GND_DRAIN
8	SSTX-
9	SSTX+
Shell	Shield

NOTES:

- MATERIAL:  
HOUSING: THERMOPLASTIC, OPTIONS (HALOGEN FREE), UL94V HB COLOR: OPTIONS.  
USB2.0 TERMINAL (1~4POS.) : PHOSPHOR BRONZE.  
USB3.0 TERMINAL (5~9POS) : BRASS.  
SHELL: SUS.
- FINISH:  
TERMINAL 2.0 & 3.0 :  
CONTACT AREA: SELECTIVE GOLD PLATING.;  
SOLDERING AREA: TIN PLATING 100 μ" THICKNESS MIN.;  
UNDER PLATING: NICKEL PLATING 50 μ" THICKNESS MIN. OVERALL  
SHELL:  
NICKEL PLATING 30 μ" THICKNESS MIN. OVERALL.
- PACKING IS PER AMTA PACKING SPECIFICATION PKS-0001.
- THIS PRODUCT DOESN'T CONTAIN ENVIRONMENTAL HAZARDOUS PER DIRECTIVE 2011/65/EU FOR RoHS COMPLIANT.
- PRODUCT SPECIFICATION REFER TO : PS-7530.

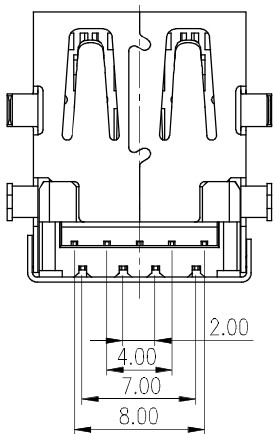
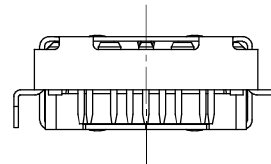
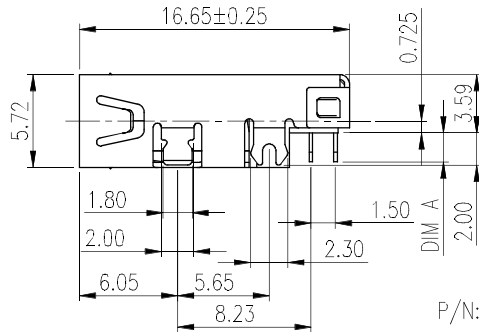
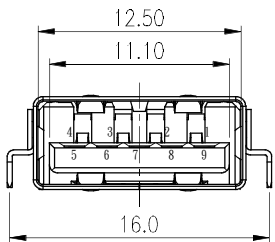

P/N: GSB411B X X X HR  
CONTACT FINISH DIM A  
1: FLASH GOLD 1: 1.80mm  
3: 30u" GOLD 1: 3.00mm  
HOUSING /COLOR  
3: LCP (BLACK)  
4: PA9T (BLUE 300C)

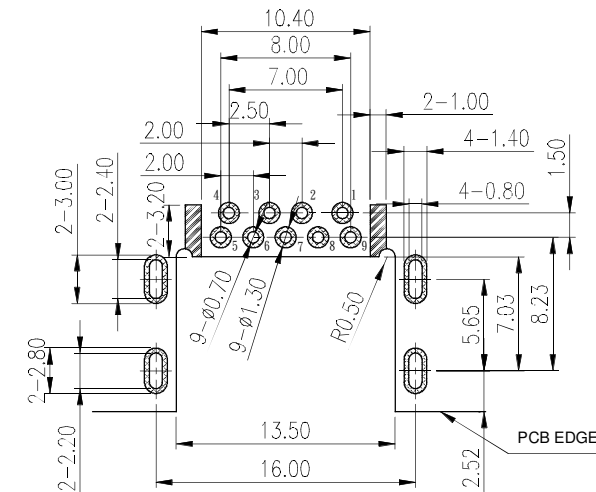

RECOMMENDED PCB LAYOUT  
TOP VIEW  
TOLERANCE: ±0.05mm  
PCB THICKNESS: 1.20±0.05mm  
KEEP OUT AREA  
RECOMMENDED SOLDER PAD AREA

TOLERANCE	APPROVALS	DATE	TITLE		UNIT		SIZE	PART No.	
X. X.X X.XX ±0.30 X.XXX ±0.20 X.XXX ±0.10	DRAWN Debby Hung	07/08/2014	USB 3.1 TYPE A R/A REVERSE CH=0.725mm SINK DIP TYPE		mm		A3	GSB411BXXXHR	
ANGULAR ±1°	CHECKED Roger Tsai	07/08/2014			SCALE		SHEET	DVG No.	
UNLESS OTHERWISE SPECIFIED	APPROVED Arron Lin	07/08/2014			NA		1 OF 2	GSB411BXXXHR	
	DWG TYPE CUST DWG	PROJECT CODE OTHER						REV. A	

This document is the property of Amphenol Corporation and is delivered on the express condition that it not be disclosed, reproduced or used, in whole or in part, for manufacture or sale by anyone other than Amphenol Corporation without its prior consent, and that no right is granted to disclose or to use any information in this document.

The marking on this product doesn't contain environmental hazardous materials per Material Specification SS-00259 for Sony GP compliant or per directive 2011/65/EU for RoHS compliant.



ORIGINAL



REVISIONS				
SYM	ECN No.	DESCRIPTION	DATE	APPROVED
A	NE-14132	NON-RELEASE TO PRODUCTION	07/08/2014	Arron Lin

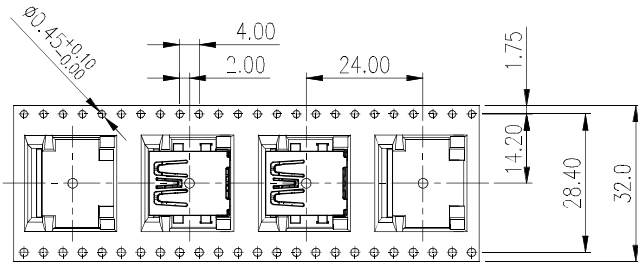

REEL SIZE	PARTS PER CARTON<S.P.Q>	PARTS PER REEL	TOTEL REEL PER CARTON
Ø330	7200	450	16

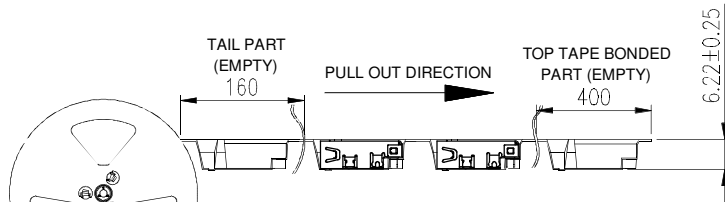

NOTES:

1. STAPLES SHOULD ONLY BE USED TO SET UP CARTON. ALL CARTON CLOSURES MUST BE DONE WITH TAPE.
2. FILL PACKAGING TRAYS WITH THE QUANTITIES AS INDICATED IN THE CHART.
3. SHIPPING CARTON DIMENSION: 690 X 360 X 325mm.
4. NET WEIGHT: 13.7 KG.  
GROSS WEIGHT: 24.2 KG.

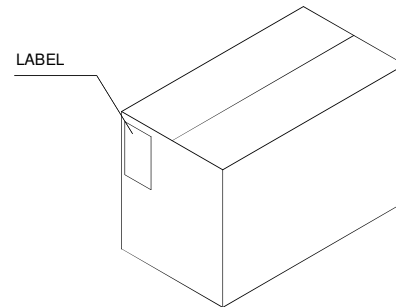
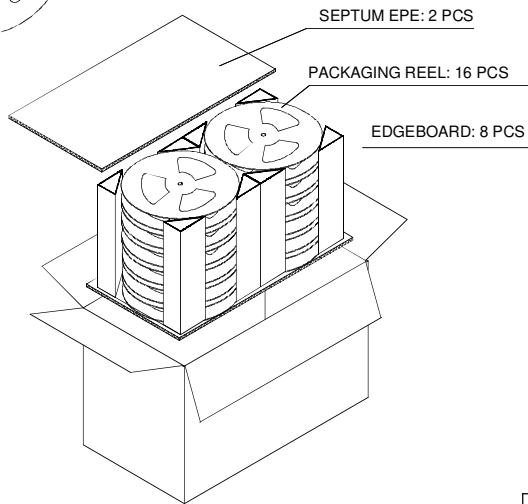

TOLERANCE	APPROVALS	DATE	TITLE		Amphenol® Amphenol Corporation Amphenol Taiwan Corporation			
X. X.X ±0.30 X.XX ±0.20 X.XXX ±0.10	DRAWN Debby Hung	07/08/2014	USB 3.1 TYPE A R/A REVERSE CH=0.725mm SINK DIP TYPE		PART No. GSB411BXXXHR		REV. A	
ANGULAR ±1°	CHECKED Roger Tsai	07/08/2014	UNIT mm SIZE A3		SHEET 2 OF 2		DVG No. GSB411BXXXHR	
UNLESS OTHERWISE SPECIFIED	APPROVED Arron Lin	07/08/2014	SCALE NA		PROJECT CODE OTHER		DVG No. GSB411BXXXHR	
	DWG TYPE CUST DWG							

