



Chipsmall Limited consists of a professional team with an average of over 10 year of expertise in the distribution of electronic components. Based in Hongkong, we have already established firm and mutual-benefit business relationships with customers from,Europe,America and south Asia,supplying obsolete and hard-to-find components to meet their specific needs.

With the principle of "Quality Parts,Customers Priority,Honest Operation,and Considerate Service",our business mainly focus on the distribution of electronic components. Line cards we deal with include Microchip,ALPS,ROHM,Xilinx,Pulse,ON,Everlight and Freescale. Main products comprise IC,Modules,Potentiometer,IC Socket,Relay,Connector.Our parts cover such applications as commercial,industrial, and automotives areas.

We are looking forward to setting up business relationship with you and hope to provide you with the best service and solution. Let us make a better world for our industry!



## Contact us

Tel: +86-755-8981 8866 Fax: +86-755-8427 6832

Email & Skype: info@chipsmall.com Web: www.chipsmall.com

Address: A1208, Overseas Decoration Building, #122 Zhenhua RD., Futian, Shenzhen, China



IEC Appliance Inlet C14 with Fuseholder 1- or 2-pole



Screw-on mounting



Snap-in version



Pick & Place Version



See below:  
[Approvals and Compliances](#)

**Description**

- Panel mount :  
Sandwich/rear-side
- 2 Functions :  
Appliance Inlet Protection class I , with or without Fuseholder for fuse-links 5 x 20 mm on the rear-side 1- or 2-pole
- Meets the requirements of IEC 60335-1 for appliances in unattended use. This includes the enhanced requirements of glow wire tests acc. to IEC 60695-2-12 and -13.
- For PCB mounting
- Pick and place version

**Characteristics**

- PCB mount with snap-in or screw-on feet  
Suitable for automatic PCB assembling
- All single elements are already wired
- Fuseholder on the inside of the equipment prevents accidental use of incorrect fuse-links by the user
- With or without rear-side insulation cover
- Blister tray as optional packaging variant
- Suitable for use in equipment according to IEC/UL 60950

**Other versions on request**

- Ground terminal with quick-connect terminal 6,3 x 0,8 mm
- Ground terminal with solder terminal
- For protection class II

**Weblinks**

[pdf datasheet](#), [html-datasheet](#), [General Product Information](#), [Distributor-Stock-Check](#), [Accessories](#), [Detailed request for product](#), [Microsite](#)

Newly available variants corresponding to V-Lock mating cordset. The connector is equipped with a notch intended for use with the latching cordset. The cord latching system prevents against accidental removal of the cordset.

**Technical Data**





|                                 |   |                                   |  |
|---------------------------------|---|-----------------------------------|--|
| Ratings IEC                     | 10A / 250VAC; 50Hz  | appliance inlet/-outlet           | C14 acc. to IEC 60320-1, UL 498, CSA C22.2 no. 42 (for cold conditions) pin-temperature 70 °C, 10A, Protection Class I |
| Ratings UL/CSA                  | 10A / 250VAC; 60Hz<br>without fuseholder 16A (UL)                 | Fuseholder                        | optional, 1 or 2 pole, Shocksafe category PC2 acc. to IEC 60127-6, for fuse-links 5 x 20mm                             |
| Dielectric Strength             | > 3kVAC between L-N<br>> 4kVAC between L/N-PE<br>(1 min/50Hz)     | Rated Power Acceptance @ Ta 23 °C | 5 x 20: 3.15W (1 pole)/ 2.5W (2-pole) per pole   |
| Allowable Operation Temperature | -25 °C to 70 °C   | Power Acceptance @ Ta > 23°C      | Admissible power acceptance at higher ambient temperature see derating curves  |
| IP-Protection                   | from front side IP 40 acc. to IEC 60529                           |                                   |  |
| Insulation cover                | Suitable for appliances with protection class I acc. to IEC 61140 |                                   |  |
| Terminal                        | For PCB mounting  |                                   |  |
| Panel Thickness S               | Snap-in: 1.5/2/2.5/3 mm   |                                   |  |
| Material: Housing               | Thermoplastic, black, UL 94V-0                                    |                                   |  |

**Approvals and Compliances**

Detailed information on product approvals, code requirements, usage instructions and detailed test conditions can be looked up in [Details about Approvals](#)





**Approvals**

The approval mark is used by the testing authorities to certify compliance with the safety requirements placed on electronic products.  
 Approval Reference Type: GSF1

| Approval Logo  | Certificates  | Certification Body | Description                              |
|--|---------------|--------------------|--|
|  | VDE Approvals | VDE                | Certificate Number: 40024857             |
|  | UL Approvals  | UL                 | UL File Number: E93617, E96454           |
|  | CSA Approvals | CSA                | CSA Certification Record: 38456          |
|  | CQC Approvals | CQC                | CCC Certificate Number: 2006010204183182 |



## Product standards

Product standards that are referenced

| Organization   | Design                | Standard         | Description   |
|--|-----------------------|------------------|---|
|  | Designed according to | IEC 60320-1      | Appliance couplers for household and similar general purposes         |
|  | Designed according to | IEC 60127-6      | Miniature fuses. Part 6. Fuse-holders for miniature fuse-links        |
|  | Designed according to | IEC 61058-1      | Switches for appliances. Part 1. General requirements                 |
|  | Designed according to | UL 498           | Standard for Attachment Plugs and Receptacles                         |
|  | Designed according to | CSA C22.2 no. 42 | General Use Receptacles, Attachment Plugs, and Similar Wiring Devices |







## Application standards

Application standards where the product can be used

| Organization   | Design                         | Standard     | Description   |
|--|--------------------------------|--------------|---|
|   | Designed for applications acc. | IEC/UL 60950 | IEC 60950-1 includes the basic requirements for the safety of information technology equipment.   |
|  | Designed for applications acc. | IEC 60335-1  | Safety of electrical appliances for household and similar purposes. Meets the requirements for appliances in unattended use. This includes the enhanced requirements of glow wire tests acc. to IEC 60695-2-12 and -13. |

## Compliances

The product complies with following Guide Lines

| Identification   | Details                      | Initiator   | Description  |
|--|------------------------------|-------------|--|
|  | CE declaration of conformity | SCHURTER AG | The CE marking declares that the product complies with the applicable requirements laid down in the harmonisation of Community legislation on its affixing in accordance with EU Regulation 765/2008.                        |
|  | RoHS                         | SCHURTER AG | EU Directive RoHS 2011/65/EU   |
|  | China RoHS                   | SCHURTER AG | The law SJ / T 11363-2006 (China RoHS) has been in force since 1 March 2007. It is similar to the EU directive RoHS.   |
|  | REACH                        | SCHURTER AG | On 1 June 2007, Regulation (EC) No 1907/2006 on the Registration, Evaluation, Authorization and Restriction of Chemicals 1 (abbreviated as "REACH") entered into force.  |
|  | MicrositeV-Lock              | SCHURTER AG | V-Lock system are based on a matching plug-dose combination. The connector is equipped with a notch intended for use with the latching cordset. The cord latching system prevents against accidental removal of the cordset. |
|  | White paperGlow wire test    | SCHURTER AG | Meets the requirements of IEC 60335-1 for appliances in unattended use. This includes the enhanced requirements of glow wire tests acc. to IEC 60695-2-12 and -13.   |

Dimensions [mm]

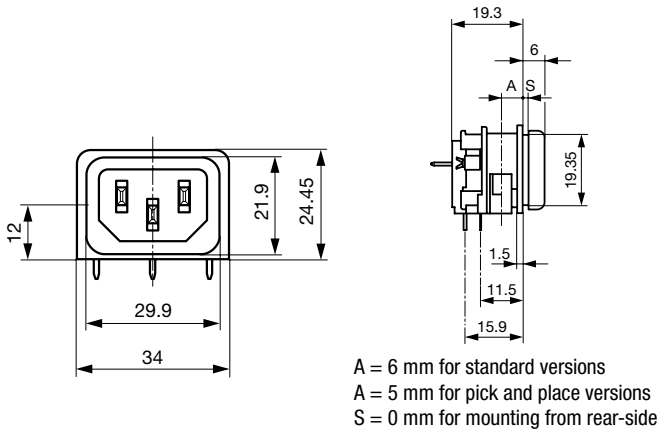

with insulation cover

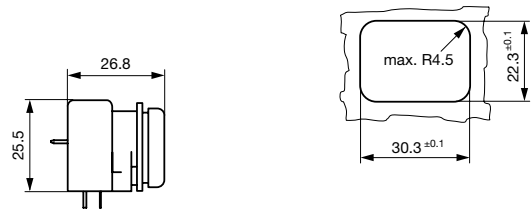

for mounting from rear-side

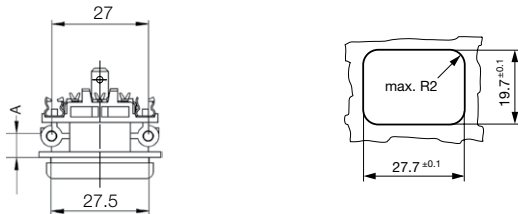

A = 6 mm for standard versions  
 A = 5 mm for pick and place versions

for sandwich mounting

Drilling diagrams

without fuseholder

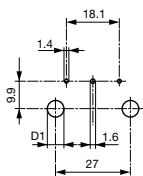

D1 for snap-in mounting =  $6 \pm 0.05$   
 D1 for self-tapping screw =  $3.6 \pm 0.1$

with 1-pole fuseholder

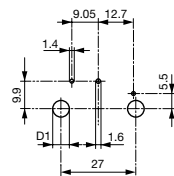

D1 for snap-in mounting =  $6 \pm 0.05$   
 D1 for self-tapping screw =  $3.6 \pm 0.1$

with 2-pole fuseholder

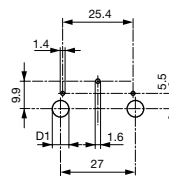

D1 for snap-in mounting =  $6 \pm 0.05$   
 D1 for self-tapping screw =  $3.6 \pm 0.1$

Pick and Place versions  
 without / with 1-pole or  
 2-pole fuseholder

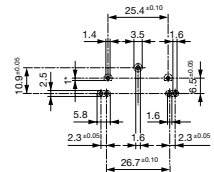

1\* only for protection class II

Derating Curves

1-pole

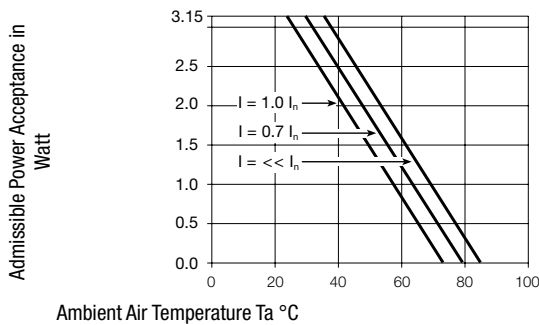

2-pole

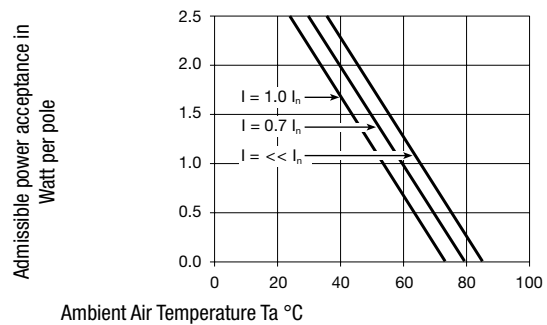

All Variants

| Mounting side | Panel mounting | Panel Thickness<br>s [mm] | Fuseholder | Ground terminal 4.8<br>x 0.8 mm | Ground terminal direction | Packaging | V-Lock | Order Number |
|---------------|----------------|---------------------------|------------|---------------------------------|---------------------------|-----------|--------|--------------|
| Sandwich      | Snap-in        | 1.5                       | -          | ●                               | angled to pin axis        | -         |        | GSF1.0202.31 |
| Sandwich      | Snap-in        | 1.5                       | -          | ●                               | straight                  | -         |        | GSF1.0201.31 |
| Sandwich      | Snap-in        | 2                         | -          | ●                               | angled to pin axis        | -         |        | GSF1.0202.41 |
| Sandwich      | Snap-in        | 2                         | -          | ●                               | straight                  | -         |        | GSF1.0201.41 |
| Sandwich      | Snap-in        | 2.5                       | -          | ●                               | angled to pin axis        | -         |        | GSF1.0202.51 |
| Sandwich      | Snap-in        | 2.5                       | -          | ●                               | straight                  | -         |        | GSF1.0201.51 |
| Sandwich      | Snap-in        | 3                         | -          | ●                               | angled to pin axis        | -         |        | GSF1.0202.61 |
| Sandwich      | Snap-in        | 3                         | -          | ●                               | straight                  | -         |        | GSF1.0201.61 |
| Sandwich      | Snap-in        | 1.5                       | 1-pole     | ●                               | angled to pin axis        | -         |        | GSF1.1202.31 |
| Sandwich      | Snap-in        | 1.5                       | 1-pole     | ●                               | straight                  | -         |        | GSF1.1201.31 |
| Sandwich      | Snap-in        | 2                         | 1-pole     | ●                               | angled to pin axis        | -         |        | GSF1.1202.41 |
| Sandwich      | Snap-in        | 2                         | 1-pole     | ●                               | straight                  | -         |        | GSF1.1201.41 |
| Sandwich      | Snap-in        | 2.5                       | 1-pole     | ●                               | angled to pin axis        | -         |        | GSF1.1202.51 |
| Sandwich      | Snap-in        | 2.5                       | 1-pole     | ●                               | straight                  | -         |        | GSF1.1201.51 |
| Sandwich      | Snap-in        | 3                         | 1-pole     | ●                               | angled to pin axis        | -         |        | GSF1.1202.61 |
| Sandwich      | Snap-in        | 3                         | 1-pole     | ●                               | straight                  | -         |        | GSF1.1201.61 |
| Sandwich      | Snap-in        | 1.5                       | 2-pole     | ●                               | angled to pin axis        | -         |        | GSF1.2202.31 |
| Sandwich      | Snap-in        | 1.5                       | 2-pole     | ●                               | straight                  | -         |        | GSF1.2201.31 |
| Sandwich      | Snap-in        | 2                         | 2-pole     | ●                               | angled to pin axis        | -         |        | GSF1.2202.41 |
| Sandwich      | Snap-in        | 2                         | 2-pole     | ●                               | straight                  | -         |        | GSF1.2201.41 |
| Sandwich      | Snap-in        | 2.5                       | 2-pole     | ●                               | angled to pin axis        | -         |        | GSF1.2202.51 |
| Sandwich      | Snap-in        | 2.5                       | 2-pole     | ●                               | straight                  | -         |        | GSF1.2201.51 |
| Sandwich      | Snap-in        | 3                         | 2-pole     | ●                               | straight                  | -         |        | GSF1.2201.61 |
| Sandwich      | Screw          | 1.5                       | -          | ●                               | angled to pin axis        | -         |        | GSF1.0002.31 |
| Sandwich      | Screw          | 1.5                       | -          | ●                               | straight                  | -         |        | GSF1.0001.31 |
| Sandwich      | Screw          | 2                         | -          | ●                               | angled to pin axis        | -         |        | GSF1.0002.41 |
| Sandwich      | Screw          | 2                         | -          | ●                               | straight                  | -         |        | GSF1.0001.41 |
| Sandwich      | Screw          | 2.5                       | -          | ●                               | angled to pin axis        | -         |        | GSF1.0002.51 |
| Sandwich      | Screw          | 2.5                       | -          | ●                               | straight                  | -         |        | GSF1.0001.51 |
| Sandwich      | Screw          | 3                         | -          | ●                               | angled to pin axis        | -         |        | GSF1.0002.61 |
| Sandwich      | Screw          | 3                         | -          | ●                               | straight                  | -         |        | GSF1.0001.61 |
| Sandwich      | Screw          | 1.5                       | 1-pole     | ●                               | angled to pin axis        | -         |        | GSF1.1002.31 |
| Sandwich      | Screw          | 1.5                       | 1-pole     | ●                               | straight                  | -         |        | GSF1.1001.31 |
| Sandwich      | Screw          | 2                         | 1-pole     | ●                               | angled to pin axis        | -         |        | GSF1.1002.41 |
| Sandwich      | Screw          | 2                         | 1-pole     | ●                               | straight                  | -         |        | GSF1.1001.41 |
| Sandwich      | Screw          | 2.5                       | 1-pole     | ●                               | angled to pin axis        | -         |        | GSF1.1002.51 |
| Sandwich      | Screw          | 2.5                       | 1-pole     | ●                               | straight                  | -         |        | 3-104-974    |
| Sandwich      | Screw          | 2.5                       | 1-pole     | ●                               | straight                  | -         |        | GSF1.1001.51 |
| Sandwich      | Screw          | 2.5                       | 1-pole     | ●                               | straight                  | -         |        | GSF1.1006.51 |
| Sandwich      | Screw          | 3                         | 1-pole     | ●                               | angled to pin axis        | -         |        | GSF1.1002.61 |
| Sandwich      | Screw          | 3                         | 1-pole     | ●                               | straight                  | -         |        | GSF1.1001.61 |
| Sandwich      | Screw          | 1.5                       | 2-pole     | ●                               | angled to pin axis        | -         |        | GSF1.2002.31 |
| Sandwich      | Screw          | 1.5                       | 2-pole     | ●                               | straight                  | -         |        | GSF1.2001.31 |
| Sandwich      | Screw          | 2                         | 2-pole     | ●                               | angled to pin axis        | -         |        | GSF1.2002.41 |
| Sandwich      | Screw          | 2                         | 2-pole     | ●                               | straight                  | -         |        | GSF1.2001.41 |
| Sandwich      | Screw          | 2.5                       | 2-pole     | ●                               | angled to pin axis        | -         |        | GSF1.2002.51 |

| Mounting side | Panel mounting | Panel Thickness s [mm] | Fuseholder | Ground terminal 4.8 x 0.8 mm | Ground terminal direction | Packaging    | V-Lock | Order Number |
|---------------|----------------|------------------------|------------|------------------------------|---------------------------|--------------|--------|--------------|
| Sandwich      | Screw          | 2.5                    | 2-pole     | ●                            | straight                  | -            |        | GSF1.2001.51 |
| Sandwich      | Screw          | 3                      | 2-pole     | ●                            | angled to pin axis        | -            |        | GSF1.2002.61 |
| Sandwich      | Screw          | 3                      | 2-pole     | ●                            | straight                  | -            |        | GSF1.2001.61 |
| Rear Side     | Snap-in        | 6                      | -          | ●                            | angled to pin axis        | -            |        | GSF1.0202.01 |
| Rear Side     | Snap-in        | 6                      | -          | ●                            | straight                  | -            |        | GSF1.0201.01 |
| Rear Side     | Snap-in        | 6                      | 1-pole     | ●                            | angled to pin axis        | -            |        | GSF1.1202.01 |
| Rear Side     | Snap-in        | 6                      | 1-pole     | ●                            | straight                  | -            |        | GSF1.1201.01 |
| Rear Side     | Snap-in        | 6                      | 2-pole     | ●                            | angled to pin axis        | -            |        | GSF1.2202.01 |
| Rear Side     | Snap-in        | 6                      | 2-pole     | ●                            | straight                  | -            |        | GSF1.2201.01 |
| Rear Side     | Screw          | 6                      | -          | ●                            | angled to pin axis        | -            |        | GSF1.0002.01 |
| Rear Side     | Screw          | 6                      | -          | ●                            | straight                  | -            |        | GSF1.0001.01 |
| Rear Side     | Screw          | 6                      | 1-pole     | ●                            | angled to pin axis        | -            |        | GSF1.1002.01 |
| Rear Side     | Screw          | 6                      | 1-pole     | ●                            | straight                  | -            |        | GSF1.1001.01 |
| Rear Side     | Screw          | 6                      | 2-pole     | ●                            | angled to pin axis        | -            |        | GSF1.2002.01 |
| Rear Side     | Screw          | 6                      | 2-pole     | ●                            | straight                  | -            |        | GSF1.2001.01 |
| Rear Side     | Metal snaps    | 6                      | -          | ●                            | angled to pin axis        | Blister tray |        | GSF1.3402.01 |
| Rear Side     | Metal snaps    | 6                      | 1-pole     | ●                            | angled to pin axis        | Blister tray |        | GSF1.4402.01 |
| Rear Side     | Metal snaps    | 6                      | 2-pole     | ●                            | angled to pin axis        | Blister tray |        | GSF1.5402.01 |

Most Popular.

Availability for all products can be searched real-time: <https://www.schurter.com/en/Stock-Check/Stock-Check-SCHURTER>

Insulation cover must be ordered separately. Order No. 0098.0078

Optional blister tray packaging 250 Pcs

**Packaging unit** 50 Pcs

### Accessories

#### Description



Assorted Covers  
Rear Cover

0098.0078

### Mating Outlets/Connectors

#### Category / Description



Appliance Outlet Overview complete

|   |      |
|---|------|
| IEC Appliance Outlet F, Screw-on Mounting, Front Side, Solder Terminal                            | 4787 |
| IEC Appliance Outlet F, Snap-in Mounting, Front Side, Solder or Quick-connect Terminal            | 4788 |
| IEC Appliance Outlet F or H, Screw-on Mounting, Front Side, Solder, PCB or Quick-connect Terminal | 5091 |

Appliance Outlet further types to GSF1



[Connector Overview complete](#)

|   |                         |
|---|-------------------------|
| 4782 Mounting: Power Cord, 3 x 1 mm <sup>2</sup> / 3 x 18 AWG, Cable, Connector: IEC C13    | <a href="#">4782</a>    |
| 4785 Mounting: Power Cord, 3 x 1 mm <sup>2</sup> / 3 x 18 AWG, Cable, Connector: IEC C13    | <a href="#">4785</a>    |
| 4300-06 Mounting: Power Cord, 3 x 1 mm <sup>2</sup> / 3 x 18 AWG, Cable, Connector: IEC C13 | <a href="#">4300-06</a> |
| IEC Connector C15 for hot conditions 120°C, Rewireable, Straight                            | <a href="#">4781</a>    |
| IEC Connector C15 for hot conditions 120°C, Rewireable, Angled                              | <a href="#">4784</a>    |
| <a href="#">Connector further types to GSF1</a>   | ...                     |

**Mating Outlets/Connectors shuttered**



[Power Cord Overview complete](#)

|   |                         |
|---|-------------------------|
| VAC13KS, Overview, diverse Connector IEC C13, cord end: | <a href="#">VAC13KS</a> |
| Power cord with IEC connector C17, V-Lock, straight     | <a href="#">VAC17KS</a> |
| <a href="#">Power Cord further types to GSF1</a>        |                         |