



Chipsmall Limited consists of a professional team with an average of over 10 year of expertise in the distribution of electronic components. Based in Hongkong, we have already established firm and mutual-benefit business relationships with customers from,Europe,America and south Asia,supplying obsolete and hard-to-find components to meet their specific needs.

With the principle of “Quality Parts,Customers Priority,Honest Operation,and Considerate Service”,our business mainly focus on the distribution of electronic components. Line cards we deal with include Microchip,ALPS,ROHM,Xilinx,Pulse,ON,Everlight and Freescale. Main products comprise IC,Modules,Potentiometer,IC Socket,Relay,Connector.Our parts cover such applications as commercial,industrial, and automotives areas.

We are looking forward to setting up business relationship with you and hope to provide you with the best service and solution. Let us make a better world for our industry!



Contact us

Tel: +86-755-8981 8866 Fax: +86-755-8427 6832

Email & Skype: info@chipsmall.com Web: www.chipsmall.com

Address: A1208, Overseas Decoration Building, #122 Zhenhua RD., Futian, Shenzhen, China



1. GSPW1651N□ SE-□ □ -TR (1W LED)

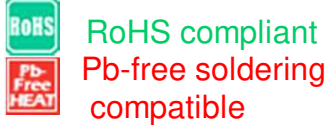

- Special color LED in which object is shown to more attractive.
- Special spectral characteristic matched to object.
- Various phosphors are originally combined.
- High Reliability Life time 40,000hrs

Package Dimensions

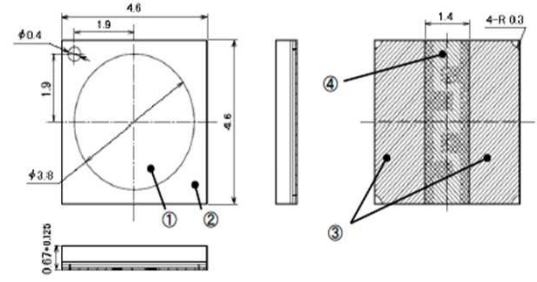

L4.6 x W4.6 x H0.67 mm

Electro-Optical Characteristics (Ta=25°C)

Part Name	Color	VF	Luminous Flux		VF	Forward Current Max
				IF		
GSPW1651NPSE- 11- TR	Purplish Pink	3.0V	85	350mA	600mA	Fresh Meat
GSPW1651NPSE- 12- TR	Yellowish Pink		80			
GSPW1651NCSE- 14- TR	Ice Blue		107			Crystal Glass
GSPW1651NSE- 20Y- TR	Gold(2000K)		85			

2. GTEW1151ASE-16-TR (0.5W LED)

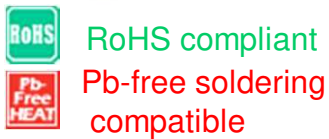

- Special spectral characteristic which is enhanced freshness of objects.
- Decrease a yellow color element and increase a red color element.

Package Dimensions

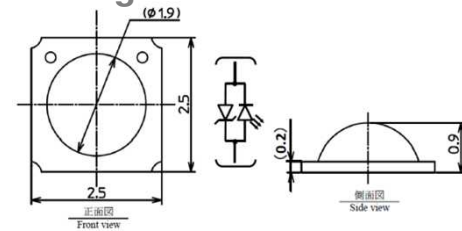

L2.5 x W2.5 x H0.9mm

Electro-Optical Characteristics (Ta=25°C)

Part Name	Color	VF	Luminous Flux		Forward Current Max	Usage
				IF		
GTEW1151ASE- 16- TR	Special color(White)	3.1V	85	80mA	170mA	Fresh Meat

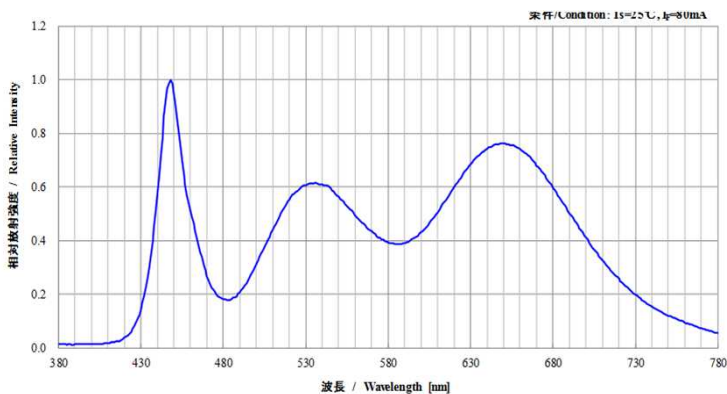

*Performance and specification may revised without prior notice, in accordance to meet the engineering development. It is recommended to confirm the most updated specification before designing.

Updated Sept 2014

1.GSPW 1651N □ SE-□ □ -TR(1W LED)

Light effect



Purplish
Pink



Purplish
Pink



Gold
(2000k)

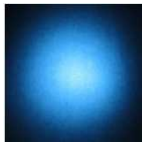

Ice Blue



2.GTEW1151ASE-16-TR (0.5W LED)

■ Application

- Lighting for Fresh meat and Fresh fish (Frozen refrigeration showcase)
- Lighting for 'Sushi neta case'. (Material case)



EW



SUSHI Shop
Meguro Tokyo Japan



IMAGE

*Performance and specification may revised without prior notice, in accordance to meet the engineering development. It is recommended to confirm the most updated specification before designing.

Updated Sept 2014