



Chipsmall Limited consists of a professional team with an average of over 10 year of expertise in the distribution of electronic components. Based in Hongkong, we have already established firm and mutual-benefit business relationships with customers from,Europe,America and south Asia,supplying obsolete and hard-to-find components to meet their specific needs.

With the principle of “Quality Parts,Customers Priority,Honest Operation,and Considerate Service”,our business mainly focus on the distribution of electronic components. Line cards we deal with include Microchip,ALPS,ROHM,Xilinx,Pulse,ON,Everlight and Freescale. Main products comprise IC,Modules,Potentiometer,IC Socket,Relay,Connector.Our parts cover such applications as commercial,industrial, and automotives areas.

We are looking forward to setting up business relationship with you and hope to provide you with the best service and solution. Let us make a better world for our industry!



## Contact us

Tel: +86-755-8981 8866 Fax: +86-755-8427 6832

Email & Skype: info@chipsmall.com Web: www.chipsmall.com

Address: A1208, Overseas Decoration Building, #122 Zhenhua RD., Futian, Shenzhen, China



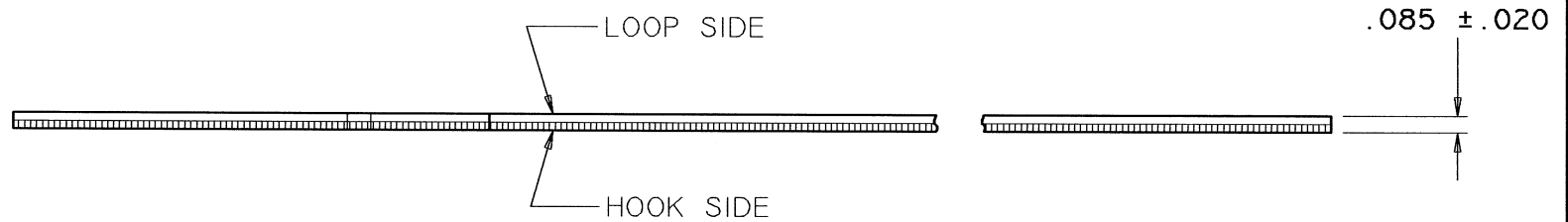
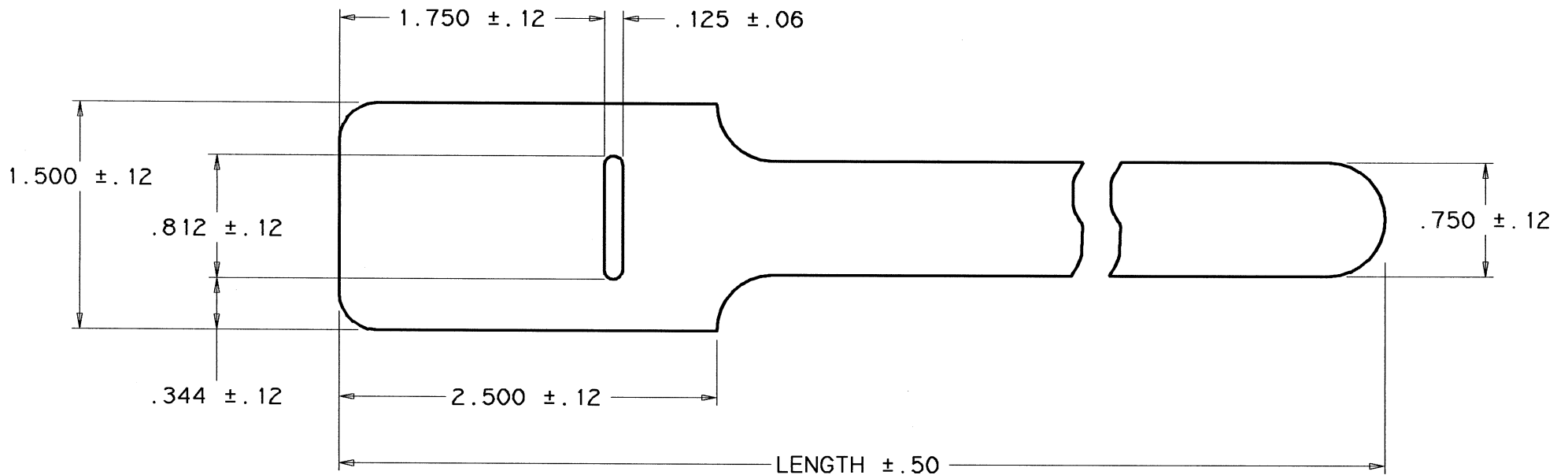

MIN LOOP TENSILE (LBS)	MAX BUNDLE DIA	LENGTH	CATALOG NUMBER
TBD	3.88	15.00	GT .75X15

DESIGN TEAM		INVENTOR(S) / DATE	
<b>HellermannTyton</b>			
ALL PROPRIETARY RIGHTS IN THIS SUBJECT MATTER SHOWN ON THIS DRAWING ARE EXCLUSIVE PROPERTY OF HELLERMANNTYTON			
B			
DWG REV	DASH - REV	CHANGED	RELEASED
	PART NO.	DATE	BY

- NOTES:
- AVG SHEAR STRENGTH = 23 PSI
  - AVG PEEL STRENGTH = .5 LBS/IN WIDTH
  - TENSILE LOOP & MAX BUNDLE DIA ARE BASED ON 2" MIN HOOK & LOOP ENGAGEMENT

DIMENSIONS	VERIFIED	UNITS	TOLERANCES	
			unless otherwise specified	
name	<input checked="" type="checkbox"/>	in	.XXX= NOTED	.X=
date	<input type="checkbox"/>	mm	.XX=	<=
	<input type="checkbox"/>	mm		
		in		

<b>MATERIAL</b>	HOOK & LOOP
	AVAILABLE COLORS: BLUE, ORANGE, YELLOW, RED, GREEN, BLACK
	or engineering approved equivalent

<b>NAME</b>	
<b>DATE</b>	
drawn	K. A. C.
	5/22/96
checked	<i>Km.C.</i>
	6/7/96
approved	

<b>PART NAME</b>	GT .75X15 GRIP TIE	
plot date	6/7/96	scale FULL
drive S	sheet 1 of 1	
FORMAT AH	VERSION E	CUSTOMER DRAWING NUMBER
DRAWING NO. WAS		CT\CST\2007075B