



Chipsmall Limited consists of a professional team with an average of over 10 year of expertise in the distribution of electronic components. Based in Hongkong, we have already established firm and mutual-benefit business relationships with customers from,Europe,America and south Asia,supplying obsolete and hard-to-find components to meet their specific needs.

With the principle of “Quality Parts,Customers Priority,Honest Operation,and Considerate Service”,our business mainly focus on the distribution of electronic components. Line cards we deal with include Microchip,ALPS,ROHM,Xilinx,Pulse,ON,Everlight and Freescale. Main products comprise IC,Modules,Potentiometer,IC Socket,Relay,Connector.Our parts cover such applications as commercial,industrial, and automotives areas.

We are looking forward to setting up business relationship with you and hope to provide you with the best service and solution. Let us make a better world for our industry!



## Contact us

Tel: +86-755-8981 8866 Fax: +86-755-8427 6832

Email & Skype: info@chipsmall.com Web: www.chipsmall.com

Address: A1208, Overseas Decoration Building, #122 Zhenhua RD., Futian, Shenzhen, China



PLATING SPECIFICATIONS		
	CONTACT	TERMINAL
A	.000015" GOLD	.0001" TIN/LEAD
D	.00003" GOLD	.00003" GOLD OVERALL
G	.00001" GOLD	.000005" GOLD
M	.00003" GOLD	.00001" GOLD OVERALL
N	.00005" GOLD	.0001" TIN/LEAD
O	.00003" GOLD	.0001" TIN/LEAD
P	GOLD FLASH	GOLD FLASH
R	.00002" GOLD	.0001" TIN/LEAD
S	.00001" GOLD	.00001" GOLD OVERALL
T	.0001" TIN/LEAD	.0001" TIN/LEAD OVERALL
V	.00003" GOLD	.000005" GOLD
W	GOLD FLASH	.0001" TIN/LEAD
X	.00003" GOLD	.0001" TIN/LEAD
Y	.00003" GOLD	.000005" GOLD
Z	.00001" GOLD	.0001" TIN/LEAD

PART NUMBER	CONTACT PIN	HEAD LENGTH	TAIL LENGTH
GTC_SABN-M30	ETC-SAB	0.230 [5.84]	0.320 [8.13]
GZC_SABN-M30	EZC-SAB	0.230 [5.84]	0.320 [8.13]
GTC_SFBN-M30	ETC-SFB	0.318 [8.08]	0.300 [7.62]
GZC_SFBN-M30	EZC-SFB	0.318 [8.08]	0.300 [7.62]

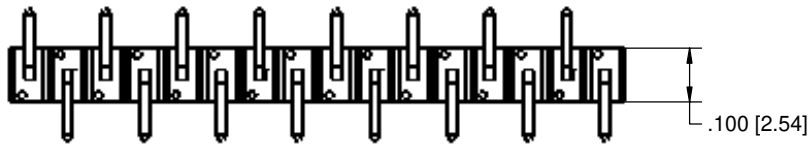
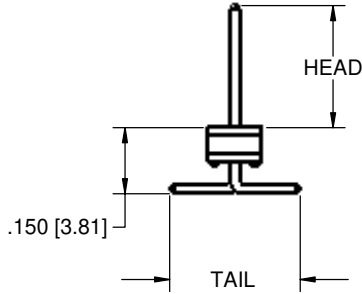
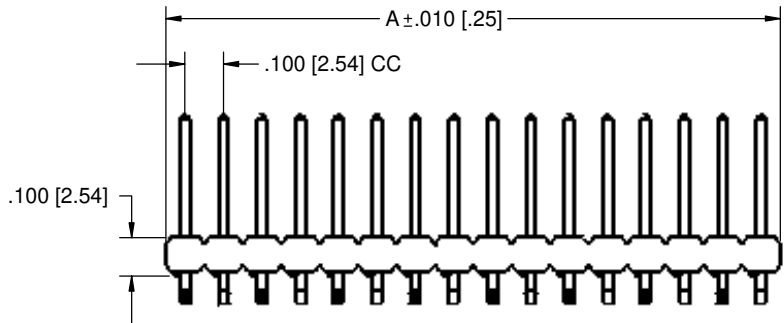

PART NUMBER	BODY NUMBER	A
G_C01S_N-M30	H01S-A360	0.100 [2.54]
G_C02S_N-M30	H02S-A360	0.200 [5.08]
G_C03S_N-M30	H03S-A360	0.300 [7.62]
G_C04S_N-M30	H04S-A360	0.400 [10.16]
G_C05S_N-M30	H05S-A360	0.500 [12.70]
G_C06S_N-M30	H06S-A360	0.600 [15.24]
G_C07S_N-M30	H07S-A360	0.700 [17.78]
G_C08S_N-M30	H08S-A360	0.800 [20.32]
G_C09S_N-M30	H09S-A360	0.900 [22.86]
G_C10S_N-M30	H10S-A360	1.000 [25.40]
G_C11S_N-M30	H11S-A360	1.100 [27.94]
G_C12S_N-M30	H12S-A360	1.200 [30.48]
G_C13S_N-M30	H13S-A360	1.300 [33.02]
G_C14S_N-M30	H14S-A360	1.400 [35.56]
G_C15S_N-M30	H15S-A360	1.500 [38.10]
G_C16S_N-M30	H16S-A360	1.600 [40.64]
G_C17S_N-M30	H17S-A360	1.700 [43.18]
G_C18S_N-M30	H18S-A360	1.800 [45.72]
G_C19S_N-M30	H19S-A360	1.900 [48.26]
G_C20S_N-M30	H20S-A360	2.000 [50.80]
G_C21S_N-M30	H21S-A360	2.100 [53.34]
G_C22S_N-M30	H22S-A360	2.200 [55.88]
G_C23S_N-M30	H23S-A360	2.300 [58.42]
G_C24S_N-M30	H24S-A360	2.400 [60.96]
G_C25S_N-M30	H25S-A360	2.500 [63.50]
G_C26S_N-M30	H26S-A360	2.600 [66.04]
G_C27S_N-M30	H27S-A360	2.700 [68.58]
G_C28S_N-M30	H28S-A360	2.800 [71.12]
G_C29S_N-M30	H29S-A360	2.900 [73.66]
G_C30S_N-M30	H30S-A360	3.000 [76.20]
G_C31S_N-M30	H31S-A360	3.100 [78.74]
G_C32S_N-M30	H32S-A360	3.200 [81.28]
G_C33S_N-M30	H33S-A360	3.300 [83.82]
G_C34S_N-M30	H34S-A360	3.400 [86.36]
G_C35S_N-M30	H35S-A360	3.500 [88.90]
G_C36S_N-M30	H36S-A360	3.600 [91.44]

COMPUTER  
GENERATED  
DOCUMENT DO  
NOT CHANGE  
MANUALLY

**PROPRIETARY AND CONFIDENTIAL**  
THIS DRAWING AND DESIGN IS THE  
PROPERTY OF SULLINS ELECTRONICS.  
IT MAY NOT BE USED FOR ANY  
PURPOSE OTHER THAN BY THE OWNER.  
SULLINS ELECTRONICS DOES NOT  
AUTHORIZE THE REPRODUCTION OR  
CONVEYANCE OF ANY INFORMATION  
CONTAINED HEREIN.

A	62	ORIGINAL RELEASE	9/19/03	JFW	AJT
REV.	ECO NO.	DESCRIPTION	DATE	BY	APP'VD
		UNLESS OTHERWISE SPECIFIED	DATE	NAME	
		DIMENSIONS ARE IN INCHES	9/19/03	JWHITE	
		TOLERANCES			
		FRACTIONAL ± 1/32			
		ANGULAR ± 1°			
		TWO PLACE DECIMAL ± .02			
		THREE PLACE DECIMAL ± .005			
		FOUR PLACE DECIMAL ± .0005			
		INTERFERE TO MATE*			
		TOLERANCING PER:			
		MATERIAL	NOTED		
		FINISH	N/A		
	NEXT ASSY	USED ON			
		APPURTENANCE	DO NOT SCALE DRAWING		

**SULLINS ELECTRONICS**

PART NO. / DESCR. / REVISION: HEADERS G\_C\_S\_N-M30

SIZE DWG. NO. REV: C 10058 A

SCALE 1:1 SHEET 1 OF 1