



Chipsmall Limited consists of a professional team with an average of over 10 year of expertise in the distribution of electronic components. Based in Hongkong, we have already established firm and mutual-benefit business relationships with customers from,Europe,America and south Asia,supplying obsolete and hard-to-find components to meet their specific needs.

With the principle of “Quality Parts,Customers Priority,Honest Operation,and Considerate Service”,our business mainly focus on the distribution of electronic components. Line cards we deal with include Microchip,ALPS,ROHM,Xilinx,Pulse,ON,Everlight and Freescale. Main products comprise IC,Modules,Potentiometer,IC Socket,Relay,Connector.Our parts cover such applications as commercial,industrial, and automotives areas.

We are looking forward to setting up business relationship with you and hope to provide you with the best service and solution. Let us make a better world for our industry!



Contact us

Tel: +86-755-8981 8866 Fax: +86-755-8427 6832

Email & Skype: info@chipsmall.com Web: www.chipsmall.com

Address: A1208, Overseas Decoration Building, #122 Zhenhua RD., Futian, Shenzhen, China



THIS DOCUMENT CONTAINS PROPRIETARY INFORMATION AND SUCH INFORMATION MAY NOT BE DISCLOSED TO OTHERS FOR ANY PURPOSE OR USED FOR MANUFACTURING PURPOSES WITHOUT PERMISSION FROM AMPHENOL CANADA CORP.

REVISIONS				
REV.	EDN	DESCRIPTION	DATE	APPROVED
A		PROPOSAL	AUG. 15/02	K.B.
C		PER ECN E0401B	MAY 28.04	K.L.
D		PROPOSAL	JAN 14.09	A.G.

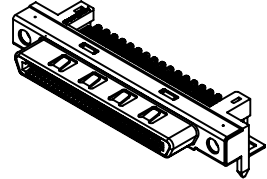

H11-RAA-100 SHOWN
(WITHOUT SCREW-LOCKS)

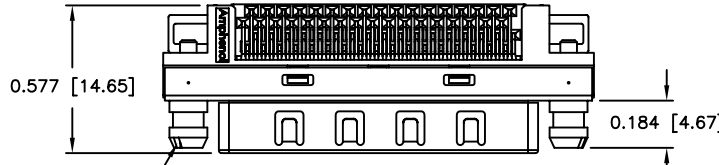

FEMALE SCREWLOCK
M2 X 0.4 - 6H THREAD
TYP. 2 PLS.

TOP VIEW

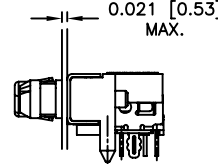

RECOMMENDED PANEL THICKNESS

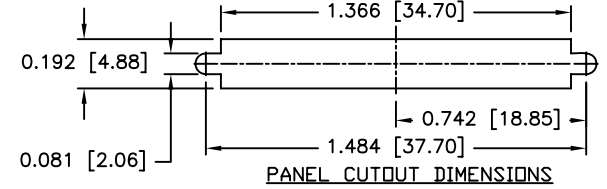

PANEL CUTOUT DIMENSIONS

NOTES: (FOR REFERENCE)

- MATERIAL -
CONTACTS: PHOSPHOR BRONZE
30 microinches GOLD OVER 50 microinches NICKEL IN MATING AREA.
150 - 300 microinches TIN LEAD OVER NICKEL UNDERPLATE IN TERMINATION AREA.
INSULATION MATERIAL: GLASS FILLED THERMOPLASTIC UL 94V-0.
SHELL: STEEL, NICKEL OR BRIGHT TIN PLATE OVER COPPER UNDERPLATE.
GROUNDING CLIP: STEEL, TIN PLATE OVER NICKEL UNDERPLATE.
CENTER SHIELD: BRASS, NICKEL PLATE OVER COPPER UNDER PLATE.
- RATINGS AND CHARACTERISTICS -
RATED VOLTAGE: 30 V rms.
CURRENT RATING AT 55°C (131°F)
1.5 A SINGLE CONTACT
0.5 A 50% ENERGIZED
0.3 A 100% ENERGIZED
INSULATION RESISTANCE: 500 m ohms min.
CONTACT RESISTANCE: 60 m ohms maximum
DURABILITY CYCLING: 2000 min.
CLIMATIC TEMPERATURE RANGE: -55°C (-67°F) TO +85°C (185°F)

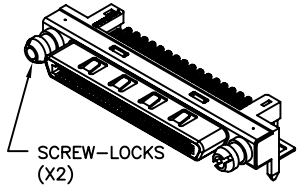

SCREW-LOCKS
(X2)
H11-RAA-101 SHOWN
(WITH SCREW-LOCKS)

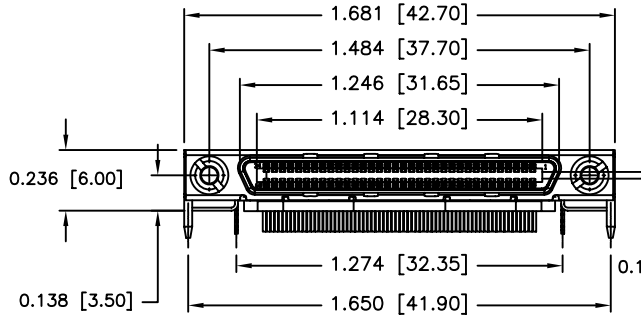

FRONT VIEW
(H11-RAA-X01 SHOWN)

0.032±0.005
[0.81±0.13]
BETWEEN CONTACT
MATING SURFACES

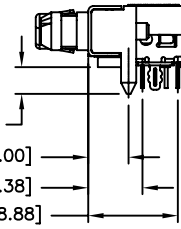

SIDE VIEW

DIM "T"
TAIL LENGTH
(SEE P/N
CONFIGURATION
FOR OPTIONS)

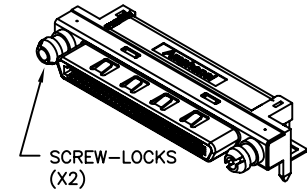

SCREW-LOCKS
(X2)
H11-RAA-111 SHOWN
(WITH SCREW-LOCKS,
BACK COVER)

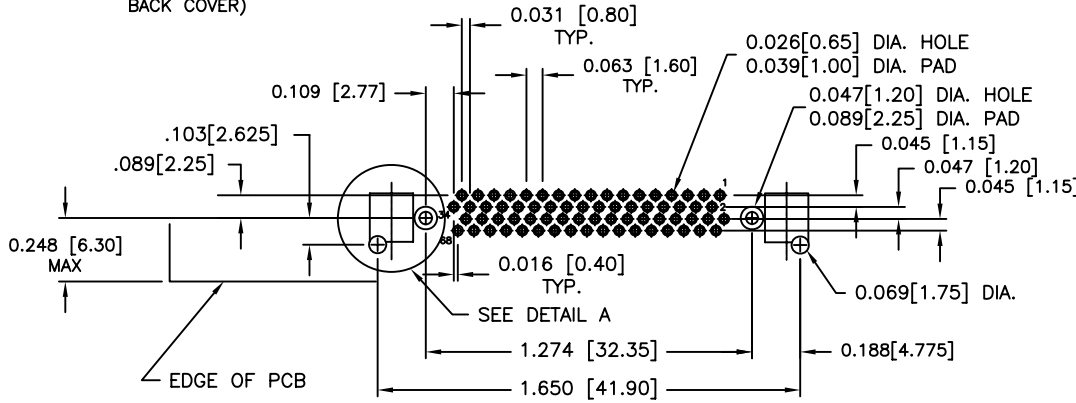

RECOMMENDED PCB LAYOUT

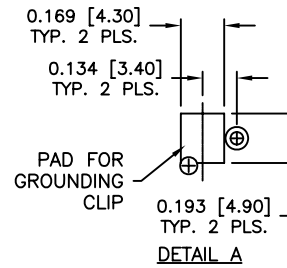

DETAIL A

AMPHENOL PART NUMBER CONFIGURATION

H11-RAA-1 X X - X

CONTACT PLATING OPTIONS
1: 30µ" GOLD OVER 50µ" NICKEL.

SPECIALLY MODIFIER
NONE: STANDARD, DIM T=.082
1: DIM T=.125
N: DIM T=.082
WITH NON-MAGNETIC SHELL AND SCREW

FEATURE OPTIONS
00: WITHOUT SCREW-LOCKS
01: WITH SCREW-LOCKS
11: WITH SCREW-LOCKS, BACK COVER.
(BACK COVER IS CURRENTLY NOT TOOLED YET)

UNLESS OTHERWISE SPECIFIED DIMENSIONS ARE IN INCHES	APPROVALS	DATE	Amphenol Canada Corp.	
	DESIGNED S.C.	AUG 15, 02	TITLE	
	CHECKED L K	JUNE 9, 98	VHDCI FIXED BOARD RIGHT ANGLE SINGLE VERSION	
	MATERIAL AND FINISH	BY APPD		
REF.	E APPD	SIZE B	DWG. NO. P-H11-RAA-1XX-X	REV. D
CORE IDENT. NO. 03554	DWG APPD	SCALE 2 = 1	PROJECT	SHEET 1 OF 1