



Chipsmall Limited consists of a professional team with an average of over 10 year of expertise in the distribution of electronic components. Based in Hongkong, we have already established firm and mutual-benefit business relationships with customers from,Europe,America and south Asia,supplying obsolete and hard-to-find components to meet their specific needs.

With the principle of “Quality Parts,Customers Priority,Honest Operation,and Considerate Service”,our business mainly focus on the distribution of electronic components. Line cards we deal with include Microchip,ALPS,ROHM,Xilinx,Pulse,ON,Everlight and Freescale. Main products comprise IC,Modules,Potentiometer,IC Socket,Relay,Connector.Our parts cover such applications as commercial,industrial, and automotives areas.

We are looking forward to setting up business relationship with you and hope to provide you with the best service and solution. Let us make a better world for our industry!



Contact us

Tel: +86-755-8981 8866 Fax: +86-755-8427 6832

Email & Skype: info@chipsmall.com Web: www.chipsmall.com

Address: A1208, Overseas Decoration Building, #122 Zhenhua RD., Futian, Shenzhen, China



1

2

3

4

5

6

7

Male

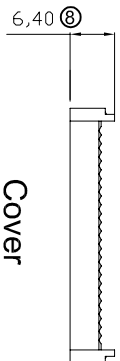
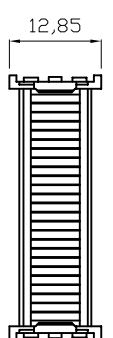
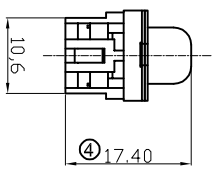
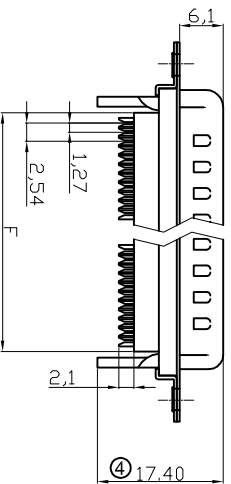
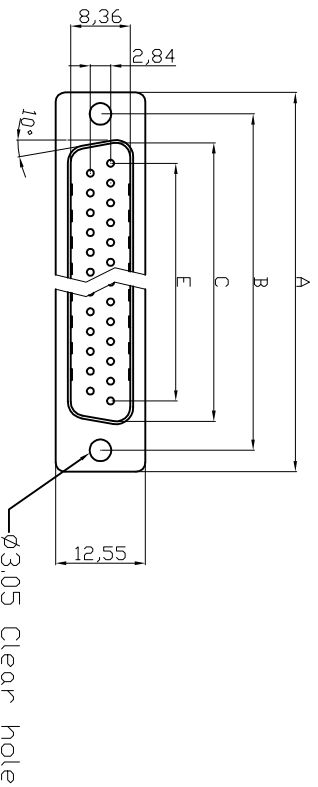

Cover

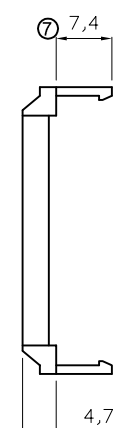

Strain Relief

Without Insulator Support

Dimensions					
Positions	A	B	C	E	F
9	30.81	24.99	16.92	11.08	13.10
15	39.20	33.30	25.25	19.39	20.70
25	53.04	47.04	38.96	33.24	33.68
37	69.40	63.50	55.42	49.86	50.30

RoHS compliant
Unit:mm

1

2

3

4

5

6

7

Scale	Free	⑧	Update the dimension	27.02.2015	Winnle	Date	Name
TOLERANCE		⑦	Update the dimension & shape of cover	09.07.2014	Winnle	Drawn	Lucas
X.	±0.38	⑥	Update the operating temperature	05.06.2014	Winnle	Approved	27.02.2015
X.X	±0.25	⑤	Correct the UL-File number	03.04.2014	Winnle		
X.XX	±0.13	④	Update 17.58& 17.28 into 17.40& 17.10mm	07.03.2014	Winnle		
DIM	TOL	③	Update the wire specification	28.06.2013	Winnle		
X.°	±3°						
X.X°	±1.0°						
Angle	TOL		Modification				



Customer-No. _____
 ASSMANN WSW-No. _____
A-DXF xx LP11/2
 Drawing-No. _____
ASS 4891 CO
 Replace _____
 Sheet 1/2

Product Specification

Material

Insulator : Glass-filled Thermoplastic PBT, UL94V-0,Black
 Contact : Copper alloy, plating gold flash selective gold
 Shell : Steel, 1000" Tin Over 500" min Copper

Electrical

Contact Resistance : 20 milliohms Max at 1 AMP DC.
 Insulation Resistance : 1000 megohms at 500 VDC.
 Dielectric Withstanding Voltage : 1000 VAC/rms 60Hz for 1 minute
 Current Rating : 3 AMP
 Voltage Rating : 250 VAC/rms 60Hz
 Wire Spec : 26 AWG-28 AWG
 Operating Temperature: -55°C--+105°C

Order Code: A-DXF xx LP11/2

Contact style: F - Female S - Male
 No. of Contacts 09 / 15 / 25 / 37
 Standard: Quality class III

A

B

C

D

E

F

G

H

1

2

3

4

5

6

7

Female

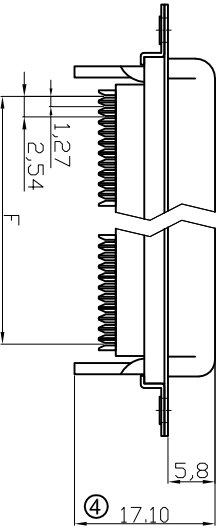
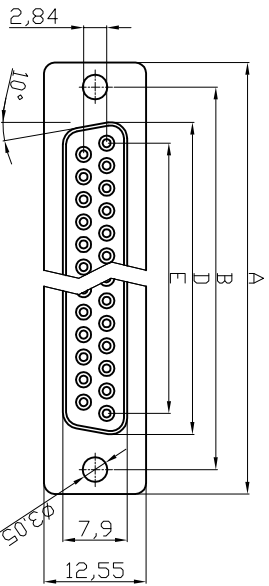

Without Insulator Support

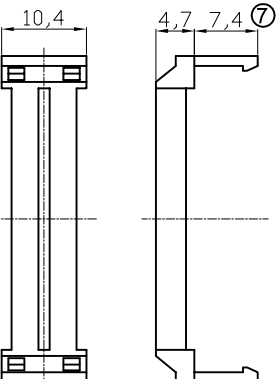
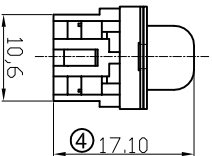

Strain Relief

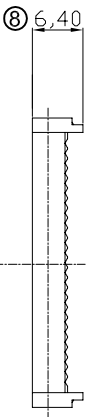

Cover

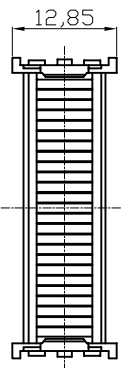

- NOTES:**
- MATERIAL**
1. Insulator Material: Glass-Filled Thermoplastic: PBT, UL 94V-0
 2. Contact Material: Copper alloy
 3. Shell :S'P'OC
 4. Plating :selective Gold Flash
- ELECTRICAL**
1. Current Rating : 3 AMP
 2. Voltage Rating : 250 V AC/rms 60 Hz
 3. Contact Resistance: 20mΩ max at 1 AMP DC
 4. Insulation Resistance: 1000MΩ at 500 VDC
 5. Withstand Voltage : 1000V AC/rms 60Hz for 1 minute
 6. Wire Spec: 26 AWG-28 AWG
 7. Operating temperature: -55 °C+105 °C
- UL E No #E198287

Dimensions Positions	A	B	D	E	F
9	30.51	24.99	16.33	11.08	10.16
15	39.20	33.30	24.70	19.39	17.78
25	53.05	47.04	38.40	33.24	30.48
37	69.40	63.50	54.80	49.86	45.72

RoHS compliant

Unit: mm

Scale	Free TOLERANCE	⑧ Update the dimension	27.02.2015	Winnie	Date	Name
X.	±0.38	⑦ Update the dimension & shape of cover	09.07.2014	Winnie	15.08.2012	Lucas
X.X	±0.25	⑥ Update the operating temperature	05.06.2014	Winnie	27.02.2015	Winnie
X.XX	±0.13	⑤ Correct the UL-File number	03.04.2014	Winnie		
DIM	TOL	④ Update 17.58&17.28 into 17.40&17.10mm	07.03.2014	Winnie		
X.°	±3°	③ Update the wire specification	28.06.2013	Winnie		
X.X°	±1.0°	Id.				
Angle	TOL	Modification	Date	Name		

Customer-No.

ASSMANN WSW-No.
A-DXF XX LP III/Z

Drawing-No.

ASS 4891 CO rev08

Replace

Sheet
2/2

1

2

3

4

5

6

7

H

G

F

E

D

C

B

A

H

G

F

E

D

C

B

A