



Chipsmall Limited consists of a professional team with an average of over 10 year of expertise in the distribution of electronic components. Based in Hongkong, we have already established firm and mutual-benefit business relationships with customers from,Europe,America and south Asia,supplying obsolete and hard-to-find components to meet their specific needs.

With the principle of "Quality Parts,Customers Priority,Honest Operation,and Considerate Service",our business mainly focus on the distribution of electronic components. Line cards we deal with include Microchip,ALPS,ROHM,Xilinx,Pulse,ON,Everlight and Freescale. Main products comprise IC,Modules,Potentiometer,IC Socket,Relay,Connector.Our parts cover such applications as commercial,industrial, and automotives areas.

We are looking forward to setting up business relationship with you and hope to provide you with the best service and solution. Let us make a better world for our industry!



Contact us

Tel: +86-755-8981 8866 Fax: +86-755-8427 6832

Email & Skype: info@chipsmall.com Web: www.chipsmall.com

Address: A1208, Overseas Decoration Building, #122 Zhenhua RD., Futian, Shenzhen, China



THIS COPY IS PROVIDED ON A RESTRICTED BASIS AND IS NOT TO BE USED IN ANY WAY DETRIMENTAL TO THE INTERESTS OF PANDUIT CORP.

DIMENSIONS - IN [mm]

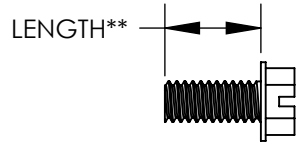
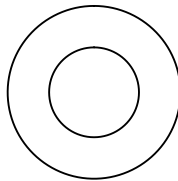
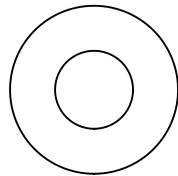
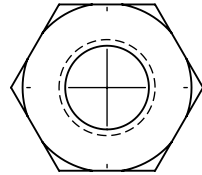
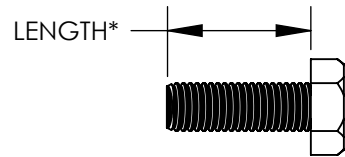

COMPONENT DESCRIPTION	PART NUMBER			
	HDW1/4-KT	HDW3/8-KT	HDW1/4-A-KT	HDW3/8-A-KT
	QUANTITY			
STAINLESS STEEL 1/4-20 HEX BOLT, 1.00 [25.4] LONG* INSTALLATION TOOL: 7/16" WRENCH	2	N/A	2	N/A
STAINLESS STEEL 3/8-16 HEX BOLT, 1.00 [25.4] LONG* INSTALLATION TOOL: 9/16" WRENCH	N/A	2	N/A	2
STAINLESS STEEL 1/4-20 HEX NUT INSTALLATION TOOL: 9/16"	2	N/A	2	N/A
STAINLESS STEEL 3/8-16 HEX NUT INSTALLATION TOOL: 9/16"	N/A	2	N/A	2
STAINLESS STEEL 1/4 FLAT WASHER	4	N/A	4	N/A
STAINLESS STEEL 3/8 FLAT WASHER	N/A	4	N/A	4
STAINLESS STEEL 1/4 BELLEVILLE COMPRESSION WASHER	2	N/A	2	N/A
STAINLESS STEEL 3/8 BELLEVILLE COMPRESSION WASHER	N/A	2	N/A	2
#12-24 THREAD FORMING SCREW, .45 [11.4] LONG** INSTALLATION TOOL: SLOTTED SCREWDRIVER / 5/16" WRENCH	2	2	N/A	N/A
#10-32 THREAD FORMING SCREW, .45 [11.4] LONG** INSTALLATION TOOL: SLOTTED SCREWDRIVER / 5/16" WRENCH	N/A	N/A	2	2
M5 THREAD FORMING SCREW, .45 [11.4] LONG** INSTALLATION TOOL: SLOTTED SCREWDRIVER / 8mm WRENCH	N/A	N/A	2	2
M6 THREAD FORMING SCREW, .45 [11.4] LONG** INSTALLATION TOOL: SLOTTED SCREWDRIVER / 8mm WRENCH	2	2	N/A	N/A

REV	DATE	BY	CHK	DESCRIPTION	ECN	SUP
02	2/12	JHNU	JHNU	ADDED LENGTH TO HEX BOLT & SCREW IN TABLE	N41736BB-C41736	RGB
01	3/10	JHNU	JHNU	ADDED INSTALLATION TOOL TO COMPONENT DESCRIPTION		
00	5/08	JHNU	JHNU	DRAWING RELEASED		

PANDUIT CORP. TINLEY PARK, ILLINOIS

STAINLESS STEEL HARDWARE KITS
(HDW1/4-KT, HDW3/8-KT, HDW1/4-A-KT, HDW3/8-A-KT)
CUSTOMER DRAWING

SCALE N/A DRAWING NO / CAD FILE C41736_02