



Chipsmall Limited consists of a professional team with an average of over 10 year of expertise in the distribution of electronic components. Based in Hongkong, we have already established firm and mutual-benefit business relationships with customers from,Europe,America and south Asia,supplying obsolete and hard-to-find components to meet their specific needs.

With the principle of “Quality Parts,Customers Priority,Honest Operation,and Considerate Service”,our business mainly focus on the distribution of electronic components. Line cards we deal with include Microchip,ALPS,ROHM,Xilinx,Pulse,ON,Everlight and Freescale. Main products comprise IC,Modules,Potentiometer,IC Socket,Relay,Connector.Our parts cover such applications as commercial,industrial, and automotives areas.

We are looking forward to setting up business relationship with you and hope to provide you with the best service and solution. Let us make a better world for our industry!



Contact us

Tel: +86-755-8981 8866 Fax: +86-755-8427 6832

Email & Skype: info@chipsmall.com Web: www.chipsmall.com

Address: A1208, Overseas Decoration Building, #122 Zhenhua RD., Futian, Shenzhen, China



Door mount

HET200VB series

Dimension drawing

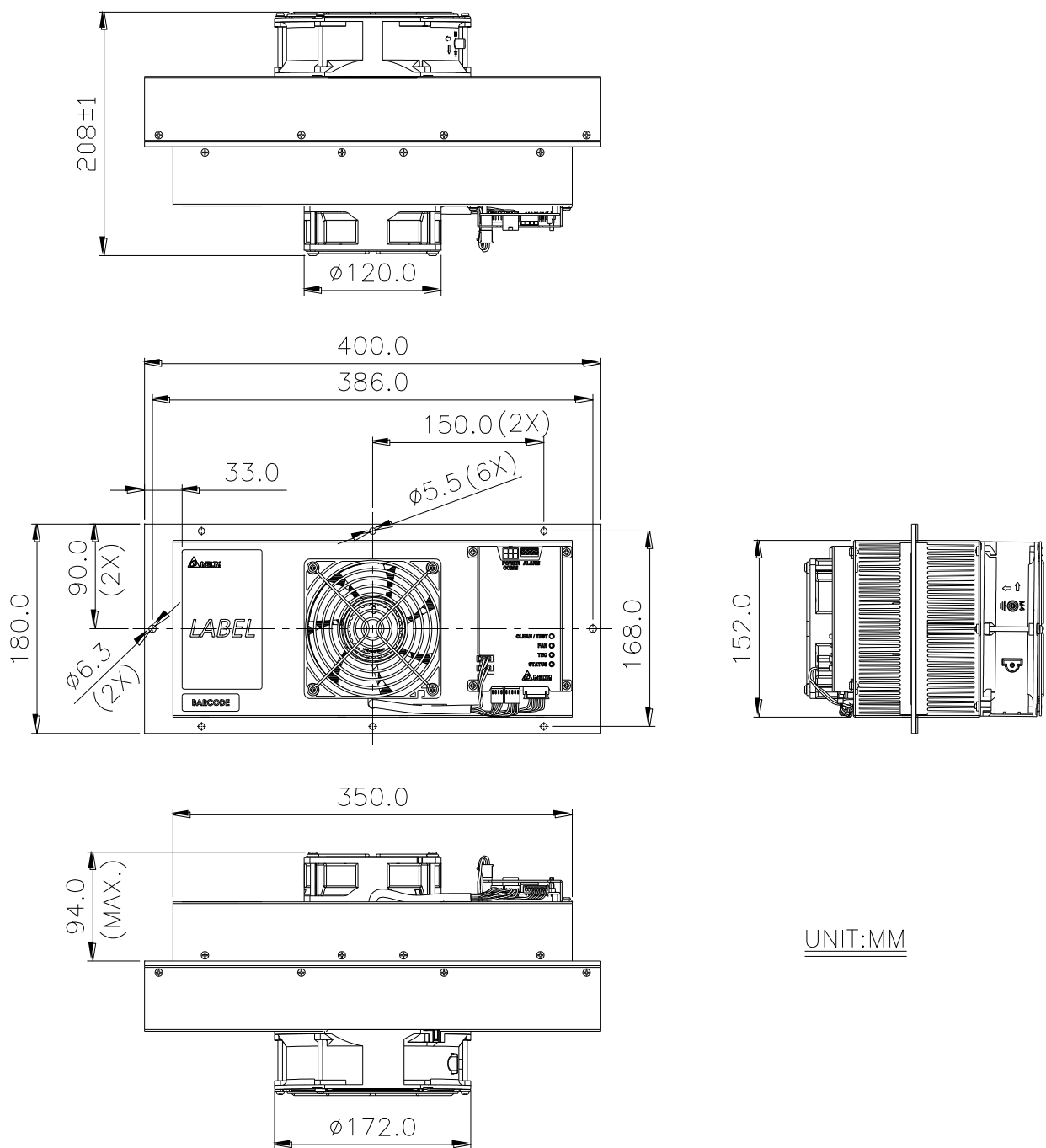

UNIT:MM

Features

- ◆ IP55 waterproof at external side
- ◆ FAN / TEC / Control fail alarm
- ◆ Clear LED status indicator
- ◆ Standalone temperature control
- ◆ High efficiency and reliable fan modules

Design

- ◆ High efficiency of cooling & Heating
- ◆ Thermal electric cooling module
- ◆ Rated voltage at 24V
- ◆ Built-in controller

| Main feature | Unit | Model Number |
|--|------|-----------------------|
| | | HET200VB |
| Outline dimension | mm | 400 H x 180 W x 209 D |
| Weight | kg | 9.0 ± 0.5 |
| Cooling capacity (ΔT =0℃) | W | 200 (TYP.) |
| Heating capacity @ -40° C | W | 225 (TYP.) |
| Rated voltage | VDC | 24 (TYP.) |
| Operating voltage range | VDC | 21~27 |
| Actuality Current | A | 12.2 (TYP.) |
| Power Consumption | W | 293 |
| Operating temperature | ℃ | -40 ~ +65 |
| Internal airflow rate | CFM | 100 (TYP.) |
| External airflow rate | | 120 (TYP.) |
| Acoustic noise at 1M : (Sound pressure) | dB-A | 61.0 (TYP.) |
| | | 64.0 (Max.) |

* Specifications are subject to change without notice.