



Chipsmall Limited consists of a professional team with an average of over 10 year of expertise in the distribution of electronic components. Based in Hongkong, we have already established firm and mutual-benefit business relationships with customers from,Europe,America and south Asia,supplying obsolete and hard-to-find components to meet their specific needs.

With the principle of “Quality Parts,Customers Priority,Honest Operation,and Considerate Service”,our business mainly focus on the distribution of electronic components. Line cards we deal with include Microchip,ALPS,ROHM,Xilinx,Pulse,ON,Everlight and Freescale. Main products comprise IC,Modules,Potentiometer,IC Socket,Relay,Connector.Our parts cover such applications as commercial,industrial, and automotives areas.

We are looking forward to setting up business relationship with you and hope to provide you with the best service and solution. Let us make a better world for our industry!



Contact us

Tel: +86-755-8981 8866 Fax: +86-755-8427 6832

Email & Skype: info@chipsmall.com Web: www.chipsmall.com

Address: A1208, Overseas Decoration Building, #122 Zhenhua RD., Futian, Shenzhen, China



Electrical / Environmental

HM100

High Current Low Profile Surface Mount Inductors

- Operating Temperature Range -40°C to +130°C
- Insulation System Class F, 155°C
- Ambient Temperature, Maximum 85°C
- Operating Frequency Up to 1MHz



Specifications

Part Number	Inductance ⁽¹⁾ μH ± 20%	— Rated Current ⁽²⁾ — (A)		Heating Current ⁽³⁾ (A)	DC Resistance ⁽⁴⁾	
		25°C	130°C		mΩ Typ.	mΩ Max.
HM100-251R0LF	1.0	70	55	62	0.6	0.9
HM100-251R5LF	1.5	45	40	62	0.6	0.9
HM100-252R0LF	2.0	35	30	62	0.6	0.9

- Notes:
- (1) Inductance is measured at 100kHz, 0.1 Vac without DC current.
 - (2) The rated current is the approximate current at which inductance will be decreased by 20% from its initial (zero DC) value.
 - (3) Heating Current is the DC current which causes the inductor temperature to increase by approximately 40°C.
 - (4) DC resistance is measured at 25°C.

Outline Dimensions (mm)

Top View

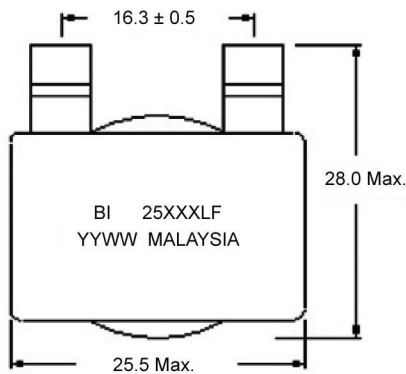

Side View



Recommended Solder Pad Layout

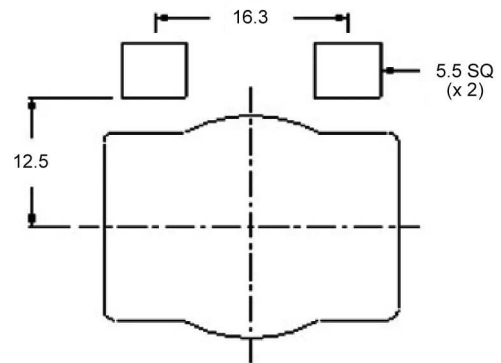

Ordering Information



Inductance Code:
 First 2 digits are significant. Last digit denotes the number of trailing zeros.
 For values below 10μH, 'R' denotes the decimal point.

Electrical Characteristics @ 25°C

