



Chipsmall Limited consists of a professional team with an average of over 10 year of expertise in the distribution of electronic components. Based in Hongkong, we have already established firm and mutual-benefit business relationships with customers from,Europe,America and south Asia,supplying obsolete and hard-to-find components to meet their specific needs.

With the principle of "Quality Parts,Customers Priority,Honest Operation,and Considerate Service",our business mainly focus on the distribution of electronic components. Line cards we deal with include Microchip,ALPS,ROHM,Xilinx,Pulse,ON,Everlight and Freescale. Main products comprise IC,Modules,Potentiometer,IC Socket,Relay,Connector.Our parts cover such applications as commercial,industrial, and automotives areas.

We are looking forward to setting up business relationship with you and hope to provide you with the best service and solution. Let us make a better world for our industry!



## Contact us

Tel: +86-755-8981 8866 Fax: +86-755-8427 6832

Email & Skype: info@chipsmall.com Web: www.chipsmall.com

Address: A1208, Overseas Decoration Building, #122 Zhenhua RD., Futian, Shenzhen, China



## Electrical / Environmental

- Operating Temperature Range -40°C to +130°C
- Operating Frequency Up to 3MHz

# HM36

High Current Low Profile Low Loss Ferrite  
Surface Mount Inductors

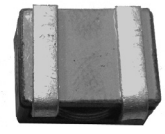

## Schematic

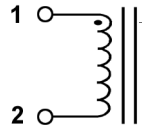

## Specifications @ 25°C / Packaging

Part Number	Inductance 100 kHz, 0.1 V		$I_{sat}^{(1)}$ (A <sub>dc</sub> )	DC Resistance		Height 'C' mm Max.	13" Reel Qty Units
	@ 0 A μH ± 10%	@ $I_{sat}$ μH Typ.		mΩ Typ.	mΩ Max.		
HM36-1211R95LF	0.95	0.80	12.0	1.06	1.40	5.65	600
HM36-12111R0LF	1.00	0.92	25.0	1.40	1.70	6.50	600
HM36-12111R4LF	1.40	1.30	20.0	1.40	1.70	6.50	600
HM36-12111R5LF	1.50	1.40	18.0	1.80	2.20	5.60	600
HM36-12113R6LF	3.60	3.42	12.0	3.00	3.50	7.50	500
HM36-1311R95LF	0.95	0.80	25.0	1.20	1.40	5.65	600
HM36-13111R4LF	1.40	1.25	22.0	1.60	1.80	5.95	600
HM36-13112R4LF	2.40	2.10	16.5	2.40	3.20	5.95	600
HM36-13116R0LF	6.00	5.20	10.0	4.60	4.92	8.00	400

Note: (1) The saturation current ( $I_{sat}$ ) is the approximate current at which inductance will be decreased by 20% from its initial (zero DC) value.

## Outline Dimensions (mm)

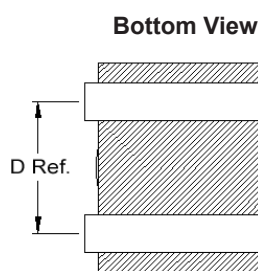
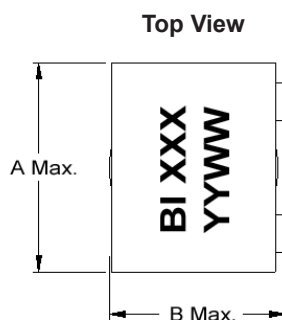

### Recommended Solder Pad Layout

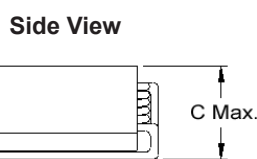
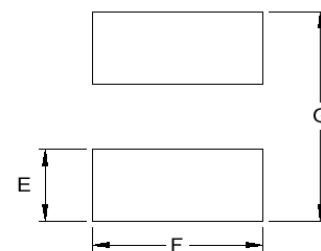

Case Size	A	B	D	E	F	G
1211	12.5	10.5	7.3	2.9	10.5	10.2
1311	13.1	11.2	8.1	4.0	10.4	12.8

Refer to Specifications table for 'C' dimension of each model.

## Electrical Characteristics @ 25°C

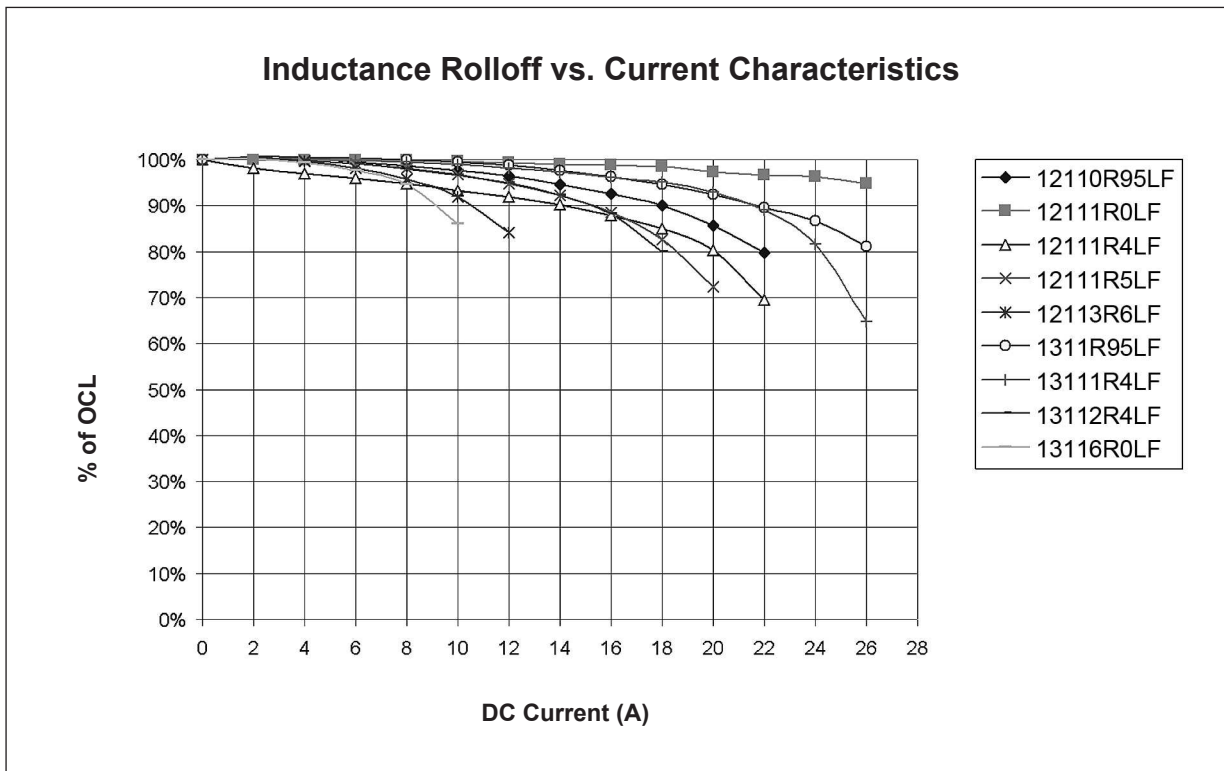
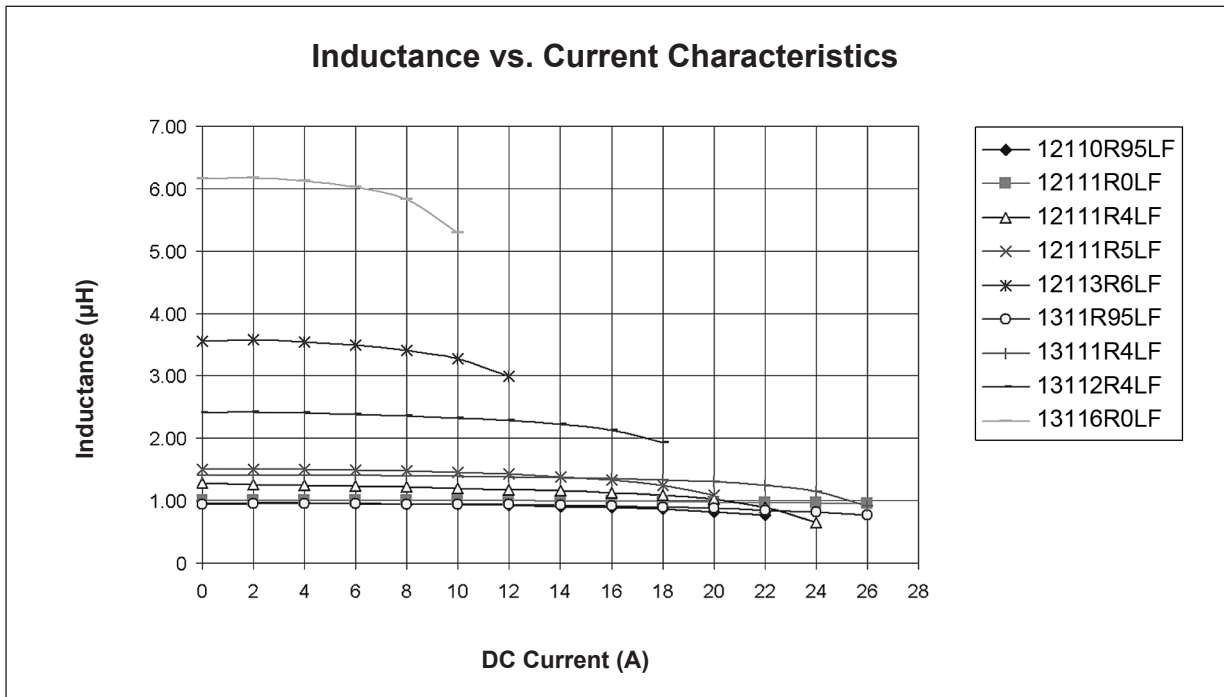

## Ordering Information

