



Chipsmall Limited consists of a professional team with an average of over 10 year of expertise in the distribution of electronic components. Based in Hongkong, we have already established firm and mutual-benefit business relationships with customers from,Europe,America and south Asia,supplying obsolete and hard-to-find components to meet their specific needs.

With the principle of “Quality Parts,Customers Priority,Honest Operation,and Considerate Service”,our business mainly focus on the distribution of electronic components. Line cards we deal with include Microchip,ALPS,ROHM,Xilinx,Pulse,ON,Everlight and Freescale. Main products comprise IC,Modules,Potentiometer,IC Socket,Relay,Connector.Our parts cover such applications as commercial,industrial, and automotives areas.

We are looking forward to setting up business relationship with you and hope to provide you with the best service and solution. Let us make a better world for our industry!



Contact us

Tel: +86-755-8981 8866 Fax: +86-755-8427 6832

Email & Skype: info@chipsmall.com Web: www.chipsmall.com

Address: A1208, Overseas Decoration Building, #122 Zhenhua RD., Futian, Shenzhen, China



In case that the application demands a high level of reliability, such as automotive,
please contact a company representative for further information.

DESCRIPTION OF REVISIONS		BY	CHKD	DATE	COUNT	DESCRIPTION OF REVISIONS	BY	CHKD	DATE
1	RE-S-00371	T.O		01/11/20					

TABLE 1

**	ATT.	PART NO.	HRS NO.
00	0dB	HSC-AT11K-A00	CL820-6001-6
01	1dB	HSC-AT11K-A01	CL820-6002-9
02	2dB	HSC-AT11K-A02	CL820-6003-1
03	3dB	HSC-AT11K-A03	CL820-6004-4
04	4dB	HSC-AT11K-A04	CL820-6005-7
05	5dB	HSC-AT11K-A05	CL820-6006-0
06	6dB	HSC-AT11K-A06	CL820-6007-2
10	10dB	HSC-AT11K-A10	CL820-6008-5
15	15dB	HSC-AT11K-A15	CL820-6009-8
20	20dB	HSC-AT11K-A20	CL820-6010-7
25	25dB	HSC-AT11K-A25	CL820-6011-0
30	30dB	HSC-AT11K-A30	CL820-6012-2

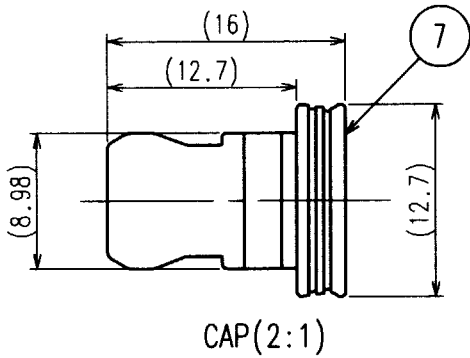
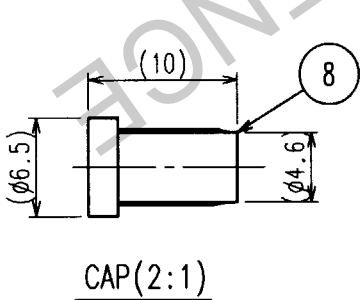
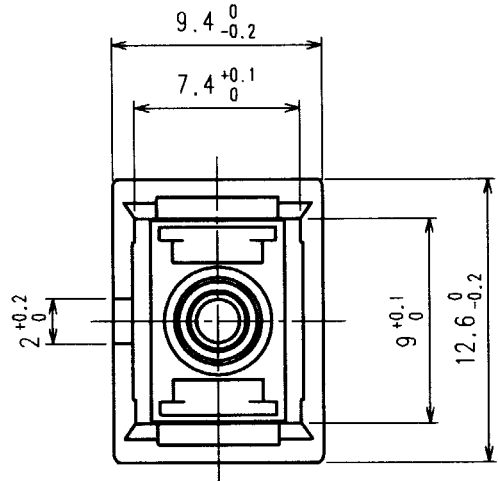
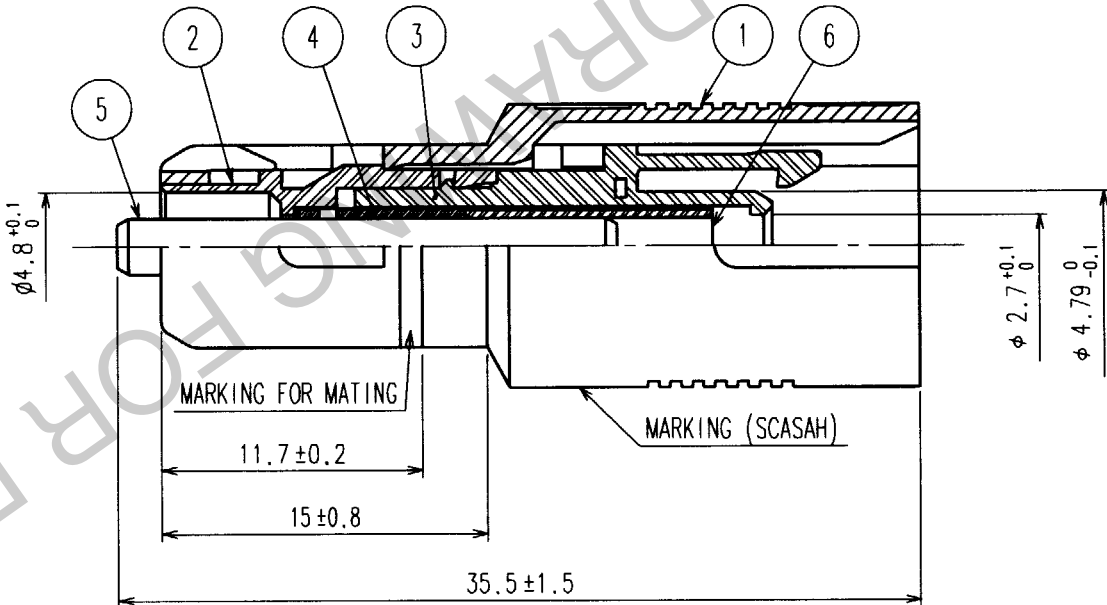
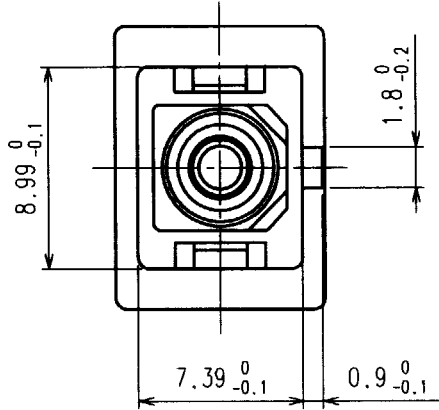
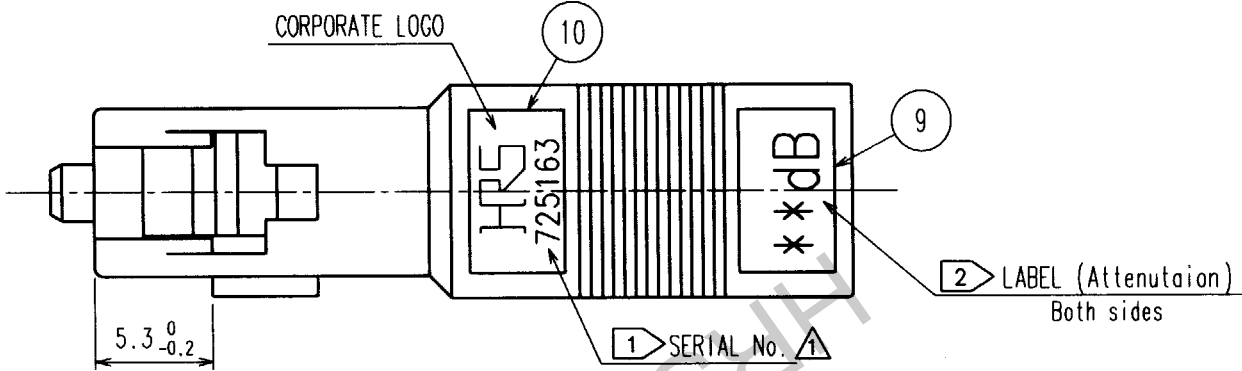

NOTE 1 AN EXAMPLE OF SERIAL NO.
2 THE SIGN ** CORRESPONDS TO THE ATTENUATION.
3 PART NO. CORRESPONDING TO THE ATTENUATION ARE WRITTEN IN TABLE1.

5	Zirconia		10	Polyester	
4	Stainless Steel		9	Polyester	
3	Synthetic Resin		8	Polyester Elastomer	Black
2	Synthetic Resin		7	Synthetic Resin	Black
1	Zink Diecast	Nickel Plated	6	Zirconia	
NO.	MATERIAL	FINISH, REMARKS	NO.	MATERIAL	FINISH, REMARKS

CODE NO. (OLD)	DRAWN	DESIGNED	CHECKED	APPROVED	RELEASED
	T.YOSHIDA	T.YOSHIDA	Y.MIYAKE	Y.MIYAKE	
	01.10.9	01.10.9	01.10.9	01.10.9	

SCALE 3 : 1	DRAWING NO. EDC3-140867	PART NO. HSC-AT11K-A**
UNITS mm	HIROSE ELECTRIC CO., LTD	CODE NO. CL820