



Chipsmall Limited consists of a professional team with an average of over 10 year of expertise in the distribution of electronic components. Based in Hongkong, we have already established firm and mutual-benefit business relationships with customers from,Europe,America and south Asia,supplying obsolete and hard-to-find components to meet their specific needs.

With the principle of “Quality Parts,Customers Priority,Honest Operation,and Considerate Service”,our business mainly focus on the distribution of electronic components. Line cards we deal with include Microchip,ALPS,ROHM,Xilinx,Pulse,ON,Everlight and Freescale. Main products comprise IC,Modules,Potentiometer,IC Socket,Relay,Connector.Our parts cover such applications as commercial,industrial, and automotives areas.

We are looking forward to setting up business relationship with you and hope to provide you with the best service and solution. Let us make a better world for our industry!



Contact us

Tel: +86-755-8981 8866 Fax: +86-755-8427 6832

Email & Skype: info@chipsmall.com Web: www.chipsmall.com

Address: A1208, Overseas Decoration Building, #122 Zhenhua RD., Futian, Shenzhen, China



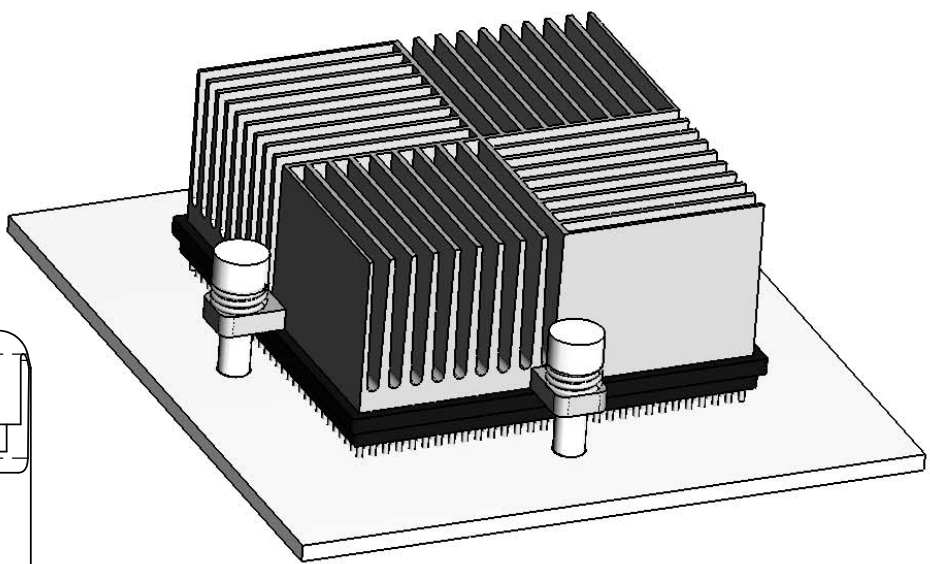

TYPICAL APPLICATION

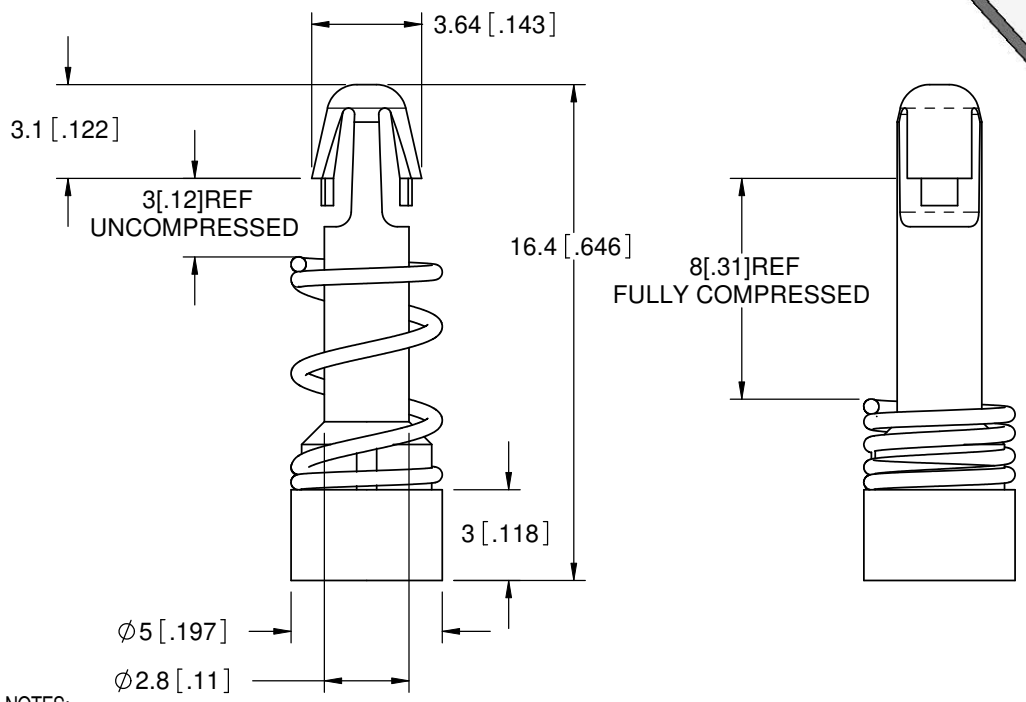

- NOTES:
 1. MATERIAL: NYLON 6/6 UL 94 V-2 RMS-047, COLOR: NATURAL
 2. SPRING MATERIAL: STEEL, RMS-326, CHROME PLATED (RMS-355).
 3. DESIGNED TO SNAP LOCK INTO A $\varnothing 3.00 \pm 0.08$ [$\varnothing 0.118 \pm 0.03$] HOLE
 4. INSERTS THROUGH A 3.18-4.00 [$\varnothing 0.125$ - .157] HOLE IN HEATSINK
 5. SPRING RATE: 12 LB/IN +/- 2
 6. PART IS DESIGNED IN MILLIMETERS.
 INCH CONVERSIONS ARE PROVIDED FOR REF ONLY

F	SEE CO 200526 FOR CHANGES	SK	04.26.10
E	SEE CO 200099 FOR CHANGES	SK	01/07/08
D	SEE ECN #1205 FOR CHANGES	SJ	08/03/06
C	SEE ECN #937 FOR CHANGES	SK	02/08/05
B	SEE ECN #922 FOR CHANGES	SK	01/25/05
A	RELEASED FOR PRODUCTION	SM	10/19/04
REV.	DESCRIPTION	ENGR.	DATE

TITLE: HEAT SINK SPRING MOUNT RIVET				DWG IN mm[IN]			
CREATED USING SOLIDWORKS		FILE #: HSR-1	DWN: D.J.Z.	APP: D.J.Z.		FINAL	
TOLERANCES UNLESS NOTED =±.25 ANG.=±1°		SHEET: 1 OF 1	SHEET SIZE: A	DT: 08/27/2004	CHKD: S.J.	PART #	PRINT TYPE
RE: RICHCO INC.		RICHCO, INC.		ENG@RICHCO-INC.COM		HSR-1	CA
		(773) 539-4060					