



Chipsmall Limited consists of a professional team with an average of over 10 year of expertise in the distribution of electronic components. Based in Hongkong, we have already established firm and mutual-benefit business relationships with customers from,Europe,America and south Asia,supplying obsolete and hard-to-find components to meet their specific needs.

With the principle of “Quality Parts,Customers Priority,Honest Operation,and Considerate Service”,our business mainly focus on the distribution of electronic components. Line cards we deal with include Microchip,ALPS,ROHM,Xilinx,Pulse,ON,Everlight and Freescale. Main products comprise IC,Modules,Potentiometer,IC Socket,Relay,Connector.Our parts cover such applications as commercial,industrial, and automotives areas.

We are looking forward to setting up business relationship with you and hope to provide you with the best service and solution. Let us make a better world for our industry!



Contact us

Tel: +86-755-8981 8866 Fax: +86-755-8427 6832

Email & Skype: info@chipsmall.com Web: www.chipsmall.com

Address: A1208, Overseas Decoration Building, #122 Zhenhua RD., Futian, Shenzhen, China



HSS



RoHS Compliant

Miniature Slide Switches



Part Numbering

HSS 1 12 A 12

Series code: HSS
 Number of poles: 1 (1 pole), 2 (2 poles)
 Current: 12
 Switching function: A (1 pole), K (2 poles), ON - OFF; D (2 poles), N (2 poles), ON - ON
 Terminal style: 12 (Solder terminal), #187 (Tab terminal)

Terminal Styles

Single pole		Double poles	
Tab term.#187	Solder term.	Tab term.#187	Solder term.

Panel Cut Out Dimension

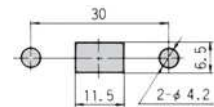
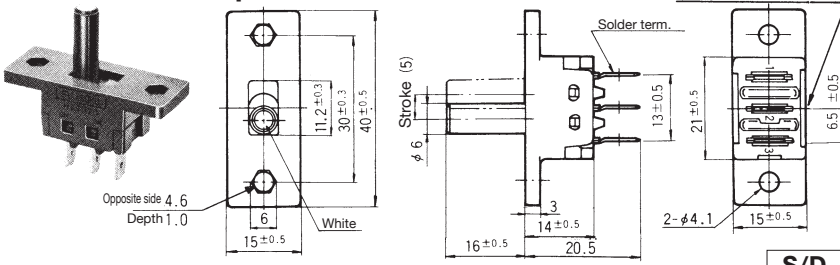

Table of Part Numbers → Page 524.

HSS112

1 pole



Dimension L

Part No.	Terminal style	TAB#250	Solder
HSS112A	■	24	20.5
HSS112D	■	24	20.5

Specifications

	Rating	Initial contact resistance	Dielectric strength	Insulation resistance	Electrical life
HSS112A HSS112D	AC125V 12A Max. AC250V 6A Max. AC-DC 6V 1mA Min.	100mΩ Max. (DC2~4V 1A)	AC1500V 1 minute	100MΩ Min. (DC500V)	15,000 cycles

Part No.	Switching function	
	Viewed from part No. marking side	
HSS112A		
Connecting terminals	2-1	-
HSS112D		
Connecting terminals	2-1	2-3

HSS208

2 pole

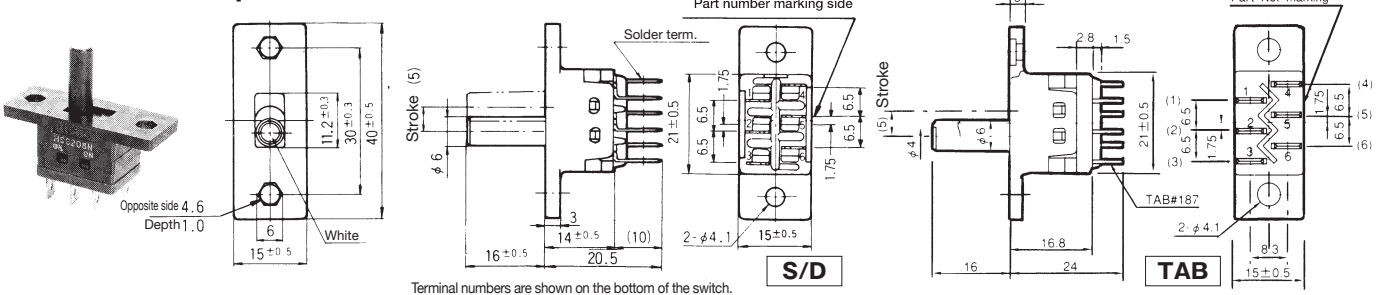

Specifications

	Rating	Initial contact resistance	Dielectric strength	Insulation resistance	Electrical life
HSS208K HSS208N	AC125V 8A Max. AC250V 5A Max. AC-DC 6V 1mA Min.	100mΩ Max. (DC2~4V 1A)	AC1500V 1 minute	100MΩ Min. (DC500V)	15,000 cycles

Part No.	Switching function	
	Viewed from part No. marking side	
HSS208K		
Connecting terminals	2-1 5-4	-
HSS208N		
Connecting terminals	2-1 5-4	2-3 5-6

■ To check the full part number of the products marked with the ■, please refer to "Table of Part Numbers" on P. 530.