



Chipsmall Limited consists of a professional team with an average of over 10 year of expertise in the distribution of electronic components. Based in Hongkong, we have already established firm and mutual-benefit business relationships with customers from,Europe,America and south Asia,supplying obsolete and hard-to-find components to meet their specific needs.

With the principle of “Quality Parts,Customers Priority,Honest Operation,and Considerate Service”,our business mainly focus on the distribution of electronic components. Line cards we deal with include Microchip,ALPS,ROHM,Xilinx,Pulse,ON,Everlight and Freescale. Main products comprise IC,Modules,Potentiometer,IC Socket,Relay,Connector.Our parts cover such applications as commercial,industrial, and automotives areas.

We are looking forward to setting up business relationship with you and hope to provide you with the best service and solution. Let us make a better world for our industry!



Contact us

Tel: +86-755-8981 8866 Fax: +86-755-8427 6832

Email & Skype: info@chipsmall.com Web: www.chipsmall.com

Address: A1208, Overseas Decoration Building, #122 Zhenhua RD., Futian, Shenzhen, China



PRODUCT NUMBER	PITCH
HTxx50x000J0G	7.62mm

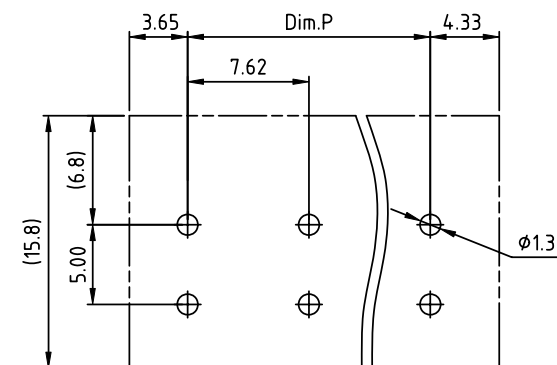
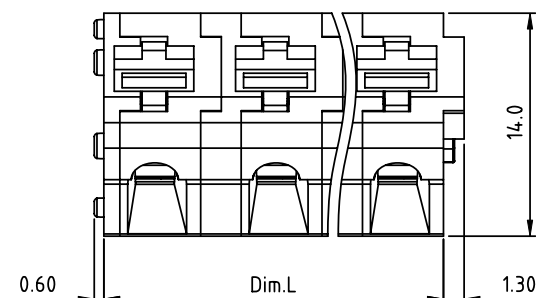

RECOMMENDED P.C.B LAYOUT
TOP VIEW

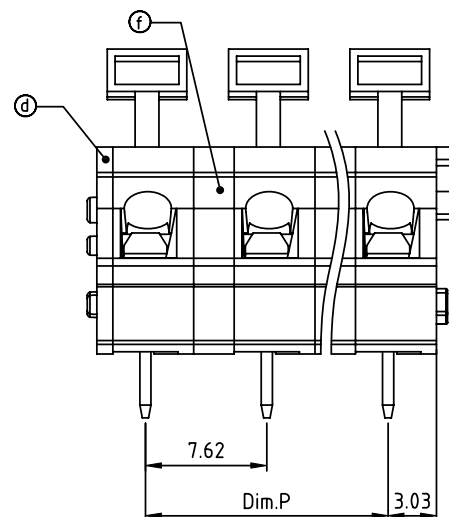
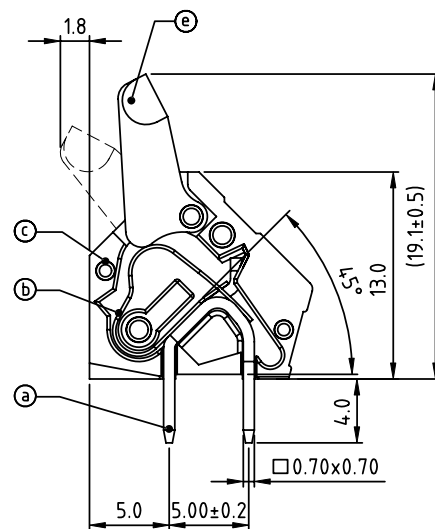

Material:

- Item①Solder pin: Brass, Tin plated
- Item②Wire guard: Stainless steel
- Item③Terminal housing: Thermoplastic (UL94V-0)
- Item④Terminal cover: Thermoplastic (UL94V-0)
- Item⑤Terminal lever: Thermoplastic (UL94V-HB)
- Item⑥Pad board: Thermoplastic (UL94V-0)

Electrical

- Voltage rating: 300V
- Current rating: 15A
- Wire range:
- Solid wire(AWG): 12-28
- Stranded wire(AWG): 12-28
- Wire strip length: 6-7mm
- Withstanding Voltage: 1.6KV
- Operating temperature: -40°C to +115°C
- Soldering temperature: 260°C±5°C/5 Sec
- Safety Approval: cULus

Dim.P=(N-1)×7.62
Dim.L=(N-1)×7.62+6.08
N=Number of poles

POLES	Dim.L	Dim.P
2p-6p	±0.25	±0.25
7p-12p	±0.30	±0.30
12p-16p	±0.40	±0.35

PART NO.: HT xx 50 x 000J0 G

No. of poles	Body Color	RoHS compliant
0	Black (RAL9005)	(lead<4%)
End Stackable	2 Red (RAL3001/D)	In copper Alloy
02 2 poles	3 Orange(RAL2011/P)	
03 3 poles	4 Yellow(RAL1018/A)	
...	5 Green(RAL6018/T)	
16 16 poles	6 Blue (RAL5015/A)	
	8 Grey(RAL7004/P)	
	9 White(RAL1102)	
	C Multiple colors	

mat'l. code				surface	tolerance	projection	product family	
ltr ecn no dr date				ASME Y14.5	ASME Y14.5	ASME Y14.5	TERMINAL BLOCK	
				tolerances unless otherwise specified		MM	title	
				angles	X.±0.5		TERMINAL BLOCK	
				flatness	X.X±0.3		SPRING CLAMP, 4SD WIRE INLET	
				X*±1°	X.XX±0.1	scale	dwg no	
				dr	EVIN ZHONG	052814	sheet 1 of 1	
				enr	EVIN ZHONG	052814	size	
				chr	HANKE FENG	052814	A4	
				appd	SHI JUN	052814	type	
							CUSTOMER Drawing	
sheet index	revision	sheet	A					