



Chipsmall Limited consists of a professional team with an average of over 10 year of expertise in the distribution of electronic components. Based in Hongkong, we have already established firm and mutual-benefit business relationships with customers from,Europe,America and south Asia,supplying obsolete and hard-to-find components to meet their specific needs.

With the principle of “Quality Parts,Customers Priority,Honest Operation,and Considerate Service”,our business mainly focus on the distribution of electronic components. Line cards we deal with include Microchip,ALPS,ROHM,Xilinx,Pulse,ON,Everlight and Freescale. Main products comprise IC,Modules,Potentiometer,IC Socket,Relay,Connector.Our parts cover such applications as commercial,industrial, and automotives areas.

We are looking forward to setting up business relationship with you and hope to provide you with the best service and solution. Let us make a better world for our industry!



Contact us

Tel: +86-755-8981 8866 Fax: +86-755-8427 6832

Email & Skype: info@chipsmall.com Web: www.chipsmall.com

Address: A1208, Overseas Decoration Building, #122 Zhenhua RD., Futian, Shenzhen, China



HTZ150C Series

$$I_{F(AV)} = 3.0 \text{ A}$$

$$V_{RRM} = 9600 \text{ V}$$

High Voltage Diode Rectifier Module

LARONTROL
Electronic Devices

Type Number	Repetitive Peak	Minimum Avalanche Voltage $V_{(BR)R}$
HTZ150C9K	9600	10200
HTZ150C8K	8400	9000
HTZ150C7K	7200	7800
HTZ150C6K	6000	6600

CIRCUIT DIAGRAM

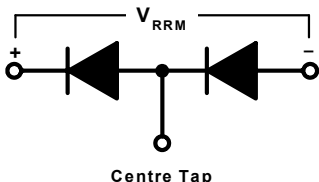

CURRENT RATINGS - AIR COOLED

$I_{F(AV)}$	Mean forward current
I_F	Continuous (direct) forward current
$R_{th(j-a)}$	Thermal resistance junction to ambient

Half wave resistive load $T_{amb} = 35^\circ\text{C}$
 $T_{amb} = 35^\circ\text{C}$

3.0	A
3.6	A
6.5	$^\circ\text{C/W}$

CURRENT RATINGS - OIL COOLED

$I_{F(AV)}$	Mean forward current
I_T	Continuous (direct) forward current
$R_{th(j-o)}$	Thermal resistance junction to oil

Half wave resistive load $T_{oil} = 60^\circ\text{C}$
 $T_{oil} = 60^\circ\text{C}$

6.5	A
7.0	A
2.0	$^\circ\text{C/W}$

SURGE RATINGS

I^2t	I^2t for fusing
I_{FSM}	Surge (non-repetitive) forward current

10 ms half sine $T_{vj} = 150^\circ\text{C}$
 $T_{vj} = 150^\circ\text{C}$

50	A^2sec
100	A

TEMPERATURE AND FREQUENCY RATINGS

T_{vj}	Virtual junction temperature
T_{stg}	Storage temperature range
f	Frequency range

Forward (conducting)
Reverse (blocking)

180	$^\circ\text{C}$
180	$^\circ\text{C}$
-40 to 100	$^\circ\text{C}$
20 to 400	Hz

CHARACTERISTICS $T_{case} = 25^\circ\text{C}$ unless otherwise stated

V_{FM}	Forward voltage
I_{RM}	Peak reverse current

At 2 Amps peak
At V_{RRM} , $T_{case} = 150^\circ\text{C}$

max 6.0	V
max 0.5	mA

Dimensioned Outlines

Dimensions shown are maximum in mm

Weight typ.: 0,24 Kg

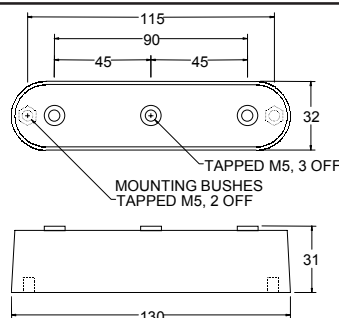

IXYS reserves the right to change limits, test conditions and dimensions.

Issue 1 June 1998

Distributed by

USA
3540 Bassett Street
Santa Clara, CA 95054
Phone: (408) 982-0700
FAX: (408) 496-0670

EUROPE
IXYS Semiconductor GmbH
Lampertheim Germany
Phone: +49.6206.503.0
Fax: +49.6206.503.627

IXYS
www.IXYS.net

HTZ150C Series

$$I_{F(AV)} = 3.0 \text{ A}$$

$$V_{RRM} = 9600 \text{ V}$$

High Voltage Diode Rectifier Module

LARONTROL

Electronic Devices

