



Chipsmall Limited consists of a professional team with an average of over 10 year of expertise in the distribution of electronic components. Based in Hongkong, we have already established firm and mutual-benefit business relationships with customers from,Europe,America and south Asia,supplying obsolete and hard-to-find components to meet their specific needs.

With the principle of “Quality Parts,Customers Priority,Honest Operation,and Considerate Service”,our business mainly focus on the distribution of electronic components. Line cards we deal with include Microchip,ALPS,ROHM,Xilinx,Pulse,ON,Everlight and Freescale. Main products comprise IC,Modules,Potentiometer,IC Socket,Relay,Connector.Our parts cover such applications as commercial,industrial, and automotives areas.

We are looking forward to setting up business relationship with you and hope to provide you with the best service and solution. Let us make a better world for our industry!



Contact us

Tel: +86-755-8981 8866 Fax: +86-755-8427 6832

Email & Skype: info@chipsmall.com Web: www.chipsmall.com

Address: A1208, Overseas Decoration Building, #122 Zhenhua RD., Futian, Shenzhen, China



THIS DRAWING IS UNPUBLISHED. RELEASED FOR PUBLICATION 20
 © COPYRIGHT 20 BY - ALL RIGHTS RESERVED.

REVISIONS					
P	LTR	DESCRIPTION	DATE	DWN	APVD
B		REVISED PRE DCR #AE-27	22APR1994	-	GMR
C		REVISED PER DCR #T996007	11MAY1999	-	GMR
D		REVISED PER ECO-15-010986	13JUL2015	AG	HS

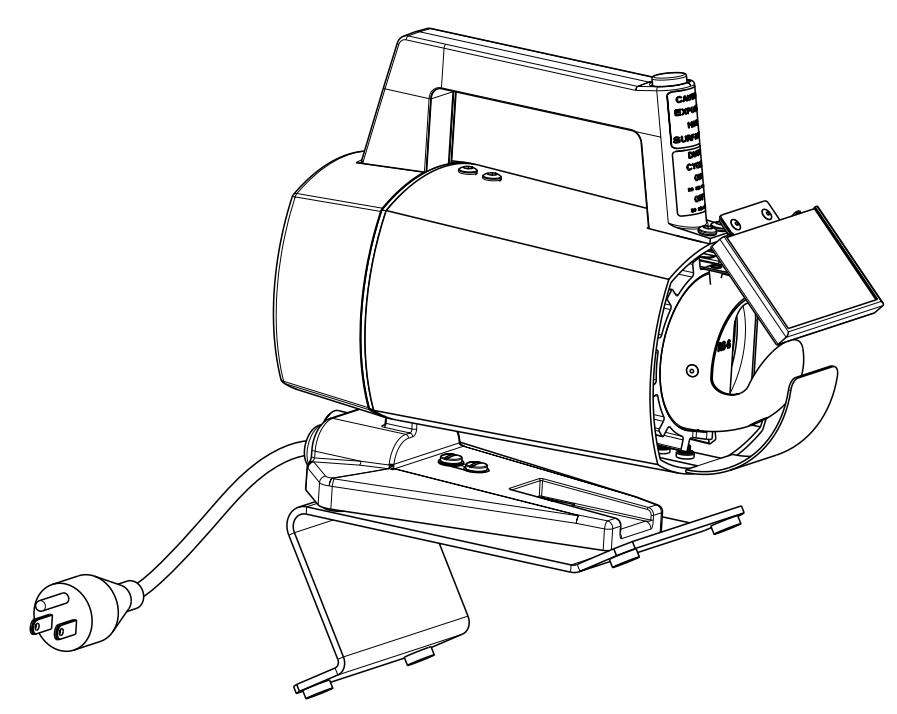
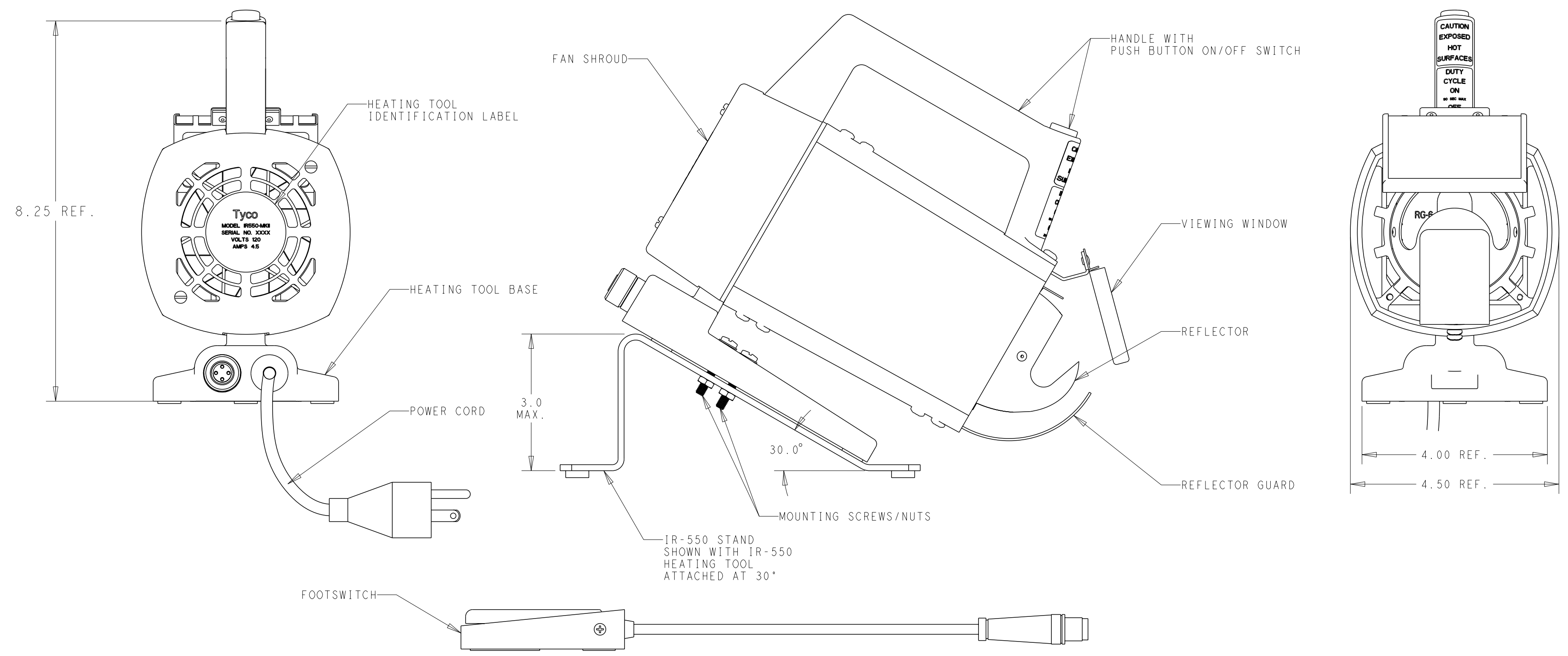

- NOTES:
1. THIS IR-550 MKII HEATING TOOL MAY BE PURCHASED FROM RAYCHEM CORPORATION AS PCN: 994350-000.
 2. REFER TO IR-550 MARK II OPERATING AND MAINTANANCE MANUAL FOR COMPLETE OPERATING INSTRUCTIONS.
 3. SPECIFICATIONS:
 INPUT POWER - 105 TO 120 VAC.
 WEIGHT - 5.5 LBS APPROX.
 DUTY CYCLE - 80%, 90 SECOND HEATING TIMES.

THIS DRAWING IS A CONTROLLED DOCUMENT.		DWN A. GAD 13JUL2015	TE Connectivity	
DIMENSIONS: INCHES		CHK N. NAGAR 28JUL2015		
TOLERANCES UNLESS OTHERWISE SPECIFIED:		APVD H. SMITH 28JUL2015	NAME IR-550 MARK II HEATING TOOL ASSY 120 VAC SERVICE	
0 PLC ± 1 PLC ± 2 PLC ± 3 PLC ± 4 PLC ± ANGLES ± FINISH -		PRODUCT SPEC -	SIZE A2	RESTRICTED TO -
MATERIAL -		APPLICATION SPEC -	CAGE CODE -	DRAWING NO. G-IR-550-50
		WEIGHT -	SCALE NTS	SHEET 1 OF 1 REV D
		CUSTOMER DRAWING		

If this document is printed it becomes uncontrolled. Check for the latest revision