



Chipsmall Limited consists of a professional team with an average of over 10 year of expertise in the distribution of electronic components. Based in Hongkong, we have already established firm and mutual-benefit business relationships with customers from,Europe,America and south Asia,supplying obsolete and hard-to-find components to meet their specific needs.

With the principle of "Quality Parts,Customers Priority,Honest Operation,and Considerate Service",our business mainly focus on the distribution of electronic components. Line cards we deal with include Microchip,ALPS,ROHM,Xilinx,Pulse,ON,Everlight and Freescale. Main products comprise IC,Modules,Potentiometer,IC Socket,Relay,Connector.Our parts cover such applications as commercial,industrial, and automotives areas.

We are looking forward to setting up business relationship with you and hope to provide you with the best service and solution. Let us make a better world for our industry!



Contact us

Tel: +86-755-8981 8866 Fax: +86-755-8427 6832

Email & Skype: info@chipsmall.com Web: www.chipsmall.com

Address: A1208, Overseas Decoration Building, #122 Zhenhua RD., Futian, Shenzhen, China





Technical Data Sheet

1.6mm Side Looking Infrared Emitting Diode

IR958-8P

■ Features

- Low forward voltage
- Peak wavelength $\lambda_p=950\text{nm}$
- High reliability
- Pb free
- The product itself will remain within RoHS compliant version.



■ Descriptions

The IR958-8P is a GaAs infrared emitting diode. The miniature side-facing device is a chip that emits radiation from the side of the pink clear package.

■ Applications

- VCR
- Floppy disk drive
- Automatic stroboscope
- Cassette type recorder
- Optoelectronic switch
- Photo interrupter

■ Device Selection Guide

Part No.	Chip	Lens Color
	Material	
IR	GaAs	Pink

Package Dimensions

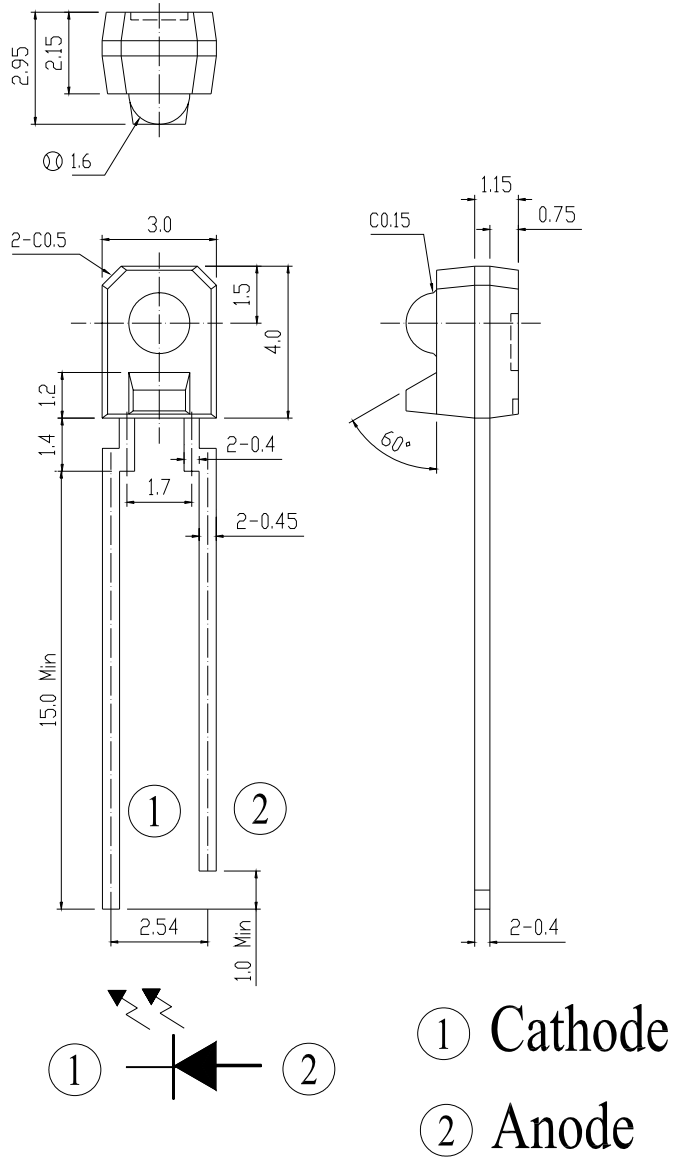

Notes: 1.All dimensions are in millimeters
2.Tolerances unless dimensions $\pm 0.2\text{mm}$

Absolute Maximum Ratings (Ta=25°C)

Item	Symbol	Rating	Unit
Power Dissipation	P _D	75	mW
Reverse Voltage	V _R	6	V
Forward Current	I _F	50	mA
Peak Forward Current (*1)	I _{FP}	1	A
Operating Temperature	T _{opr}	-25~+85	°C
Storage Temperature	T _{stg}	-40~+85	°C
Soldering Temperature (1/16 inch from body for 5 seconds)	T _{sol}	260	°C

Notes: (*1) $t_w=100\mu$ secs. $T=10$ m secs.

Electro-Optical Characteristics (Ta=25°C)

Parameter	Symbol	Min	Typ	Max	Unit	Condition
Collector Current	I _{c(on)}	300	-	2000	μ A	I _F =4mA, V _{CE} =3.5V
Peak Wavelength	λ_p	-	950	-	nm	I _F =20mA
Spectral Bandwidth	$\Delta \lambda$	-	80	-	nm	I _F =20mA
View Angle	2 θ 1/2	-	±11	-	Deg	I _F =20mA
Forward Voltage	V _F	-	1.2	1.5	V	I _F =20mA
Reverse Current	I _R	-	-	10	μ A	V _R =6V

Device No:DIR-958-142

Typical Electro-Optical Characteristics Curves

Fig.1 Forward Current vs. Ambient Temperature

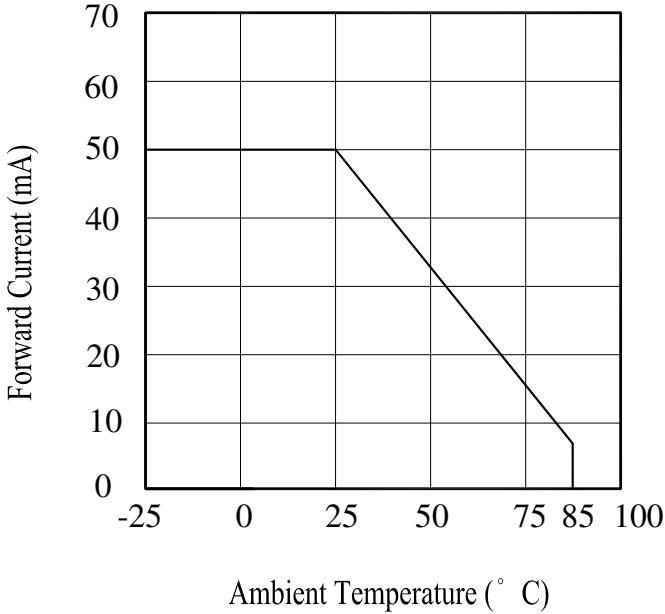

Fig.2 Spectral Distribution

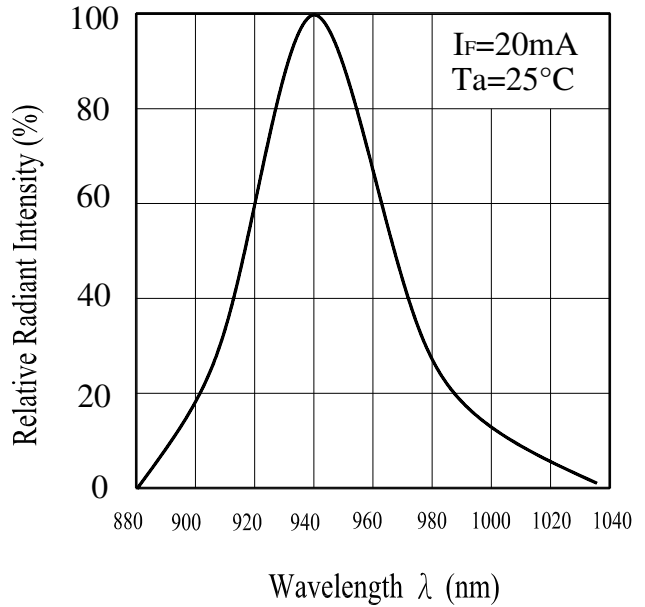

Fig.3 Peak Emission Wavelength vs. Ambient Temperature

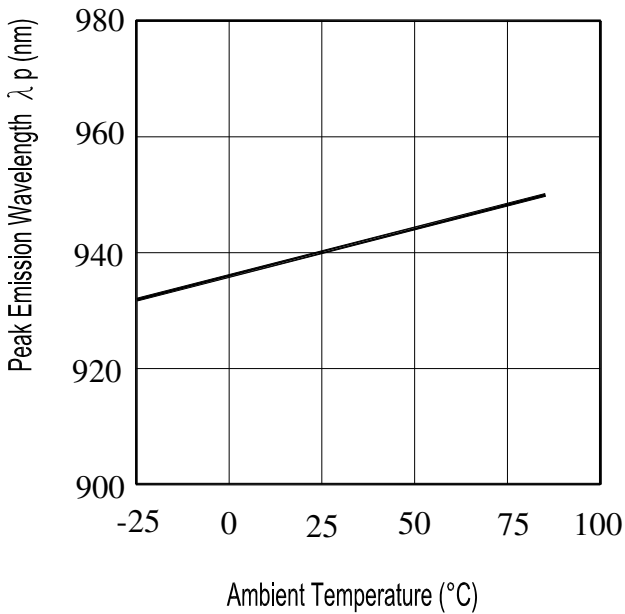
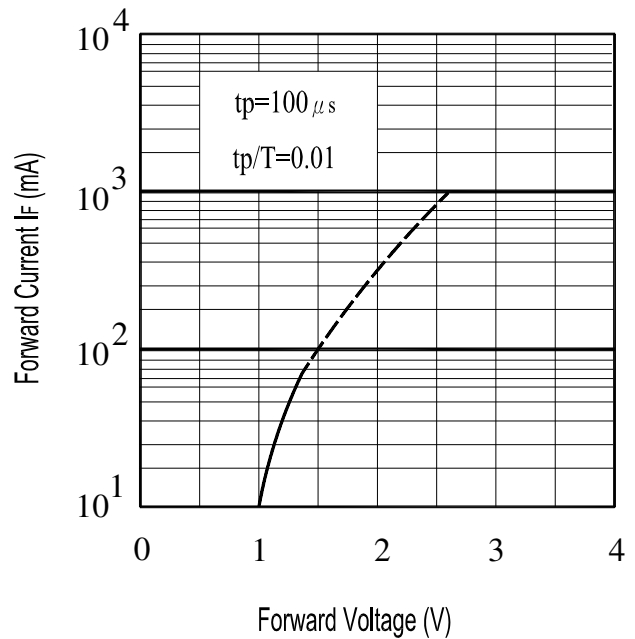

Fig.4 Forward Current vs. Forward Voltage



Typical Electro-Optical Characteristics Curves

Fig.5 Relative Intensity vs. Forward Current

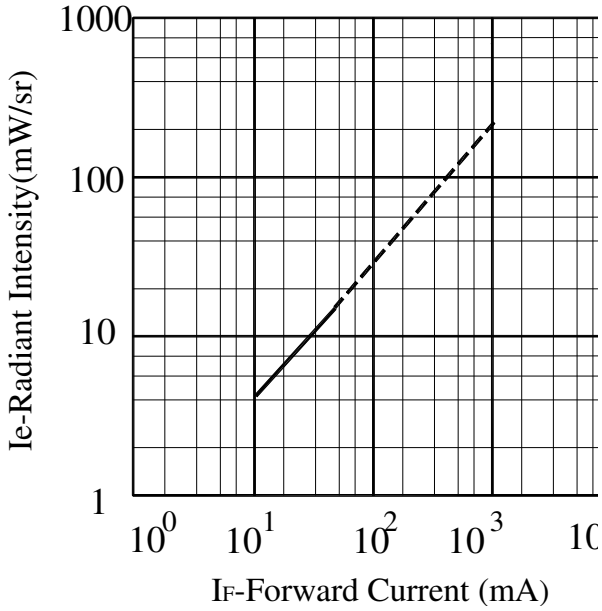
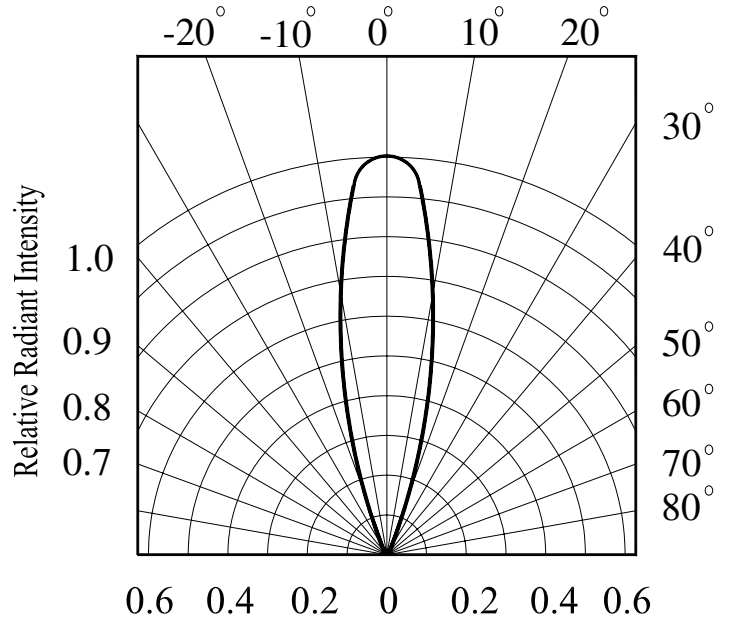
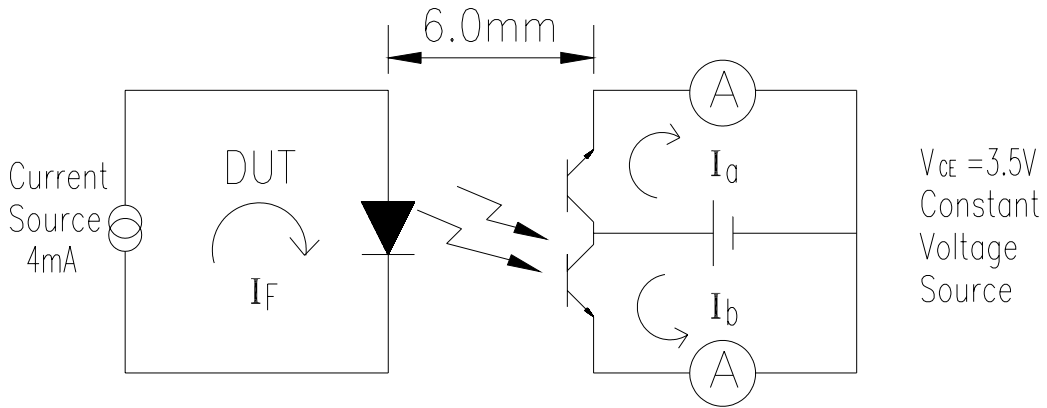

Fig.6 Relative Radiant Intensity vs Angular Displacement



Test Method

The intensity testing method of Infrared emitting diode:



To Distinguish Intensity:

Ranks

Color Code	Parameter	Symbol	Min	Max	Unit	Test Condition
No paint	7-2	I _{c(on)}	300	450	μ A	I _F =4mA, V _{CE} =3.5V
No paint	7-1	I _{c(on)}	330	565	μ A	I _F =4mA, V _{CE} =3.5V
No paint	6-2	I _{c(on)}	450	770	μ A	I _F =4mA, V _{CE} =3.5V
No paint	6-1	I _{c(on)}	630	1300	μ A	I _F =4mA, V _{CE} =3.5V
No paint	5-2	I _{c(on)}	1000	2000	μ A	I _F =4mA, V _{CE} =3.5V

Reliability Test Item And Condition

The reliability of products shall be satisfied with items listed below.

Confidence level : 90%

LTPD : 10%

NO.	Item	Test Conditions	Test Hours/ Cycles	Sample Sizes	Failure Judgment Criteria	Ac/Re
1	Solder Heat	TEMP. : 260°C±5°C	10 secs	22pcs	$I_R \geq U \times 2$ $I_{C(ON)} \leq L \times 0.8$ $V_F \geq U \times 1.2$ U : Upper Specification Limit L : Lower Specification Limit	0/1
2	Temperature Cycle	H : +85°C 30mins ↕ 5mins L : -55°C 30mins	50 Cycles	22pcs		0/1
3	Thermal Shock	H : +100°C 5mins ↕ 10secs L : -10°C 5mins	50 Cycles	22pcs		0/1
4	High Temperature Storage	TEMP. : +100°C	1000 hrs	22pcs		0/1
5	Low Temperature Storage	TEMP. : -55°C	1000 hrs	22pcs		0/1
6	DC Operating Life	$I_F=20mA$	1000 hrs	22pcs		0/1
7	High Temperature/ High Humidity	85°C / 85% R.H	1000 hrs	22pcs		0/1

EVERLIGHT ELECTRONICS CO., LTD.
 Office: No 25, Lane 76, Sec 3, Chung Yang Rd,
 Tucheng, Taipei 236, Taiwan, R.O.C

Tel: 886-2-2267-2000, 2267-9936
 Fax: 886-2267-6244, 2267-6189, 2267-6306
<http://www.everlight.com>

Device No:DIR-958-142