



Chipsmall Limited consists of a professional team with an average of over 10 year of expertise in the distribution of electronic components. Based in Hongkong, we have already established firm and mutual-benefit business relationships with customers from,Europe,America and south Asia,supplying obsolete and hard-to-find components to meet their specific needs.

With the principle of “Quality Parts,Customers Priority,Honest Operation,and Considerate Service”,our business mainly focus on the distribution of electronic components. Line cards we deal with include Microchip,ALPS,ROHM,Xilinx,Pulse,ON,Everlight and Freescale. Main products comprise IC,Modules,Potentiometer,IC Socket,Relay,Connector.Our parts cover such applications as commercial,industrial, and automotives areas.

We are looking forward to setting up business relationship with you and hope to provide you with the best service and solution. Let us make a better world for our industry!



## Contact us

Tel: +86-755-8981 8866 Fax: +86-755-8427 6832

Email & Skype: info@chipsmall.com Web: www.chipsmall.com

Address: A1208, Overseas Decoration Building, #122 Zhenhua RD., Futian, Shenzhen, China



## Datasheet

# Jupiter 3-30

Extra Low Power 20-channel  
GPS receiver module

[ image ]

December 22, 2009

## CONTENTS

<b>1.0 Introduction</b> .....	1	5.1.10 Reset input .....	8
<b>2.0 Technical description</b> .....	1	5.2 Data input output specifications .....	9
2.1 Product applications .....	1	5.2.1 Voltage levels .....	9
2.1.1 Compatibility .....	1	5.2.2 I/O surface mount pads.....	10
2.2 Receiver architecture .....	2	<b>6.0 Software interface</b> .....	11
2.3 Major components of the Jupiter 3-30 .....	2	6.1 NMEA output messages.....	11
2.4 Physical characteristics .....	3	6.2 SiRF Binary .....	11
2.5 Mechanical specification .....	3	6.3 Software functions and capabilities .....	11
2.6 External antenna surface mount pads .....	3	<b>7.0 Jupiter 20/30 comparison</b> .....	12
2.7 I/O and power connections .....	3	7.1 Active antenna specification.....	12
2.8 Environmental.....	3	7.2 Electrical interface .....	12
2.9 Compliances.....	3	7.3 Functionality .....	12
2.10 Marking/Serialization.....	4	<b>8.0 Jupiter 3-30 mechanical drawing</b> .....	13
<b>3.0 Performance characteristics</b> .....	4	<b>9.0 Jupiter 3-30 Development kit</b> .....	13
3.1 TTFF (Time To First Fix).....	4	<b>10.0 Product handling</b> .....	13
3.1.1 Hot start .....	4	10.1 Packaging and delivery.....	14
3.1.2 Warm start .....	4	10.2 Moisture sensitivity.....	14
3.1.3 Cold start .....	4	10.3 ESD sensitivity .....	14
3.2 Acquisition times.....	4	10.4 Safety .....	14
3.3 Timing 1PPS output .....	4	10.5 Disposal .....	14
3.4 Power management.....	5	<b>11.0 Ordering information</b> .....	14
3.4.1 Adaptive TricklePower .....	5	<b>12.0 Glossary and acronyms</b> .....	14
3.4.2 Push-To-Fix mode .....	5		
3.5 Differential aiding.....	5		
3.5.1 Differential GPS (DGPS).....	5		
3.5.2 Satellite Based Augmentation Systems (SBAS) .....	5		
3.6 Core processor performance.....	5		
3.7 Sensitivity.....	6		
3.8 Dynamic constraints .....	6		
3.9 Position and velocity accuracy.....	6		
<b>4.0 Multi-mode aiding</b> .....	6		
<b>5.0 Electrical requirements</b> .....	7		
5.1 Power supply .....	7		
5.1.1 Primary power .....	7		
5.1.2 Battery backup (SRAM/RTC backup).....	7		
5.1.3 VCC_RF power supply .....	7		
5.1.4 External antenna voltage .....	7		
5.1.5 RF (Radio Frequency) input .....	7		
5.1.6 Antenna gain .....	8		
5.1.7 Burnout protection .....	8		
5.1.8 Jamming performance.....	8		
5.1.9 Flash upgradability .....	8		
		<b>Figures</b>	
		Figure 2-1: Jupiter 3-30 architecture .....	2
		Figure 8-1: Jupiter 3-30 mechanical layout .....	13
		<b>Tables</b>	
		Table 3-1: Acquisition times at -125 dBm .....	4
		Table 3-2: Sensitivity .....	6
		Table 3-3: Position and velocity accuracy.....	6
		Table 5-1: Operating power for the Jupiter 3-30 .....	7
		Table 5-2: Typical jamming performance .....	8
		Table 5-3: Interface voltage levels .....	9
		Table 5-4: Jupiter 3-30 receiver pad functions .....	10
		Table 6-1: Default NMEA messages.....	11
		Table 6-2: Jupiter 3-30 software capability .....	11
		Table 7-1: Active antenna differences .....	12
		Table 7-2: Electrical interface differences .....	12
		Table 7-3: Functionality differences .....	12
		Table 11-1: Jupiter 3-30 ordering information .....	14

## 1.0 Introduction

---

Navman's Jupiter 3-30 extra low power receiver module offers the ultimate in high sensitivity GPS performance and low power consumption, capable of both autonomous and aided modes of operation.

The Jupiter 3-30 acquires GPS position faster under low signal conditions than all previous Jupiter receiver modules and can continue tracking in areas of dense foliage, built-up inner city environments and even indoors.

The module provides a 20-channel receiver that continuously tracks all satellites in view and provides accurate positioning data.

## 2.0 Technical description

---

Navman has enhanced the architecture of the SiRF GSC3f LPx chipset by adding carefully selected key components including TCXO, LNA and Flash. This ensures frequency stability, improved sensitivity at low level signals of better than  $-159$  dBm, lower power consumption and a faster TTFF (Time To First Fix). The GSC3e LPx chip integrates both baseband and RF sections, thereby reducing power consumption.

By providing separate on-board regulators, the Jupiter 3-30 allows operation over a wide input voltage range, down to 3.0VDC. This gives OEMs the ability to design with a single voltage supply that consumes less power.

The 20-channel architecture with more than 200 000 effective correlators provides rapid TTFF under all start-up conditions. Acquisition is guaranteed under all conditions due to higher sensitivity and the ability to use multi-mode aiding.

Protocols supported are selected NMEA (National Marine Electronics Association) data messages and SiRF Binary.

### 2.1 Product applications

The Jupiter 3-30 is designed specifically for applications where rapid TTFF and operation under low signal levels are primary requirements. The module offers high performance and maximum flexibility in a wide range of OEM configurations.

The high sensitivity of the module makes it ideal for:

- **navigation systems** – where athermic glass, or an unsuitably positioned antenna inside the vehicle will reduce visibility and signal strength
- **vehicle and people tracking devices** – where satellites are obstructed by partially covered car parks and walkways; Jupiter 3-30 will continue tracking indoors
- **marine buoys** – where multipath and unstable sea conditions make satellite visibility irregular
- **asset tracking** – where construction machinery is located in covered yards and areas of dense foliage

#### 2.1.1 Compatibility

The Jupiter 3-30 is the successor to the established Jupiter 30 xLP, sharing the same form factor (25.4x25.4 mm) and electrical compatibility. This provides a low risk migration path for existing users requiring greater sensitivity, lower power consumption and a faster fix.

Refer to section 7.0 for further information about compatibility between the modules.

Note that the NMEA protocol used on the Jupiter 3-30 is not backwards compatible to the Jupiter 30 xLP. The NMEA protocol has been upgraded from version 2.2 to version 3.0.

## 2.2 Receiver architecture

The functional architecture of the Jupiter 3-30 receiver is shown in Figure 2-1.

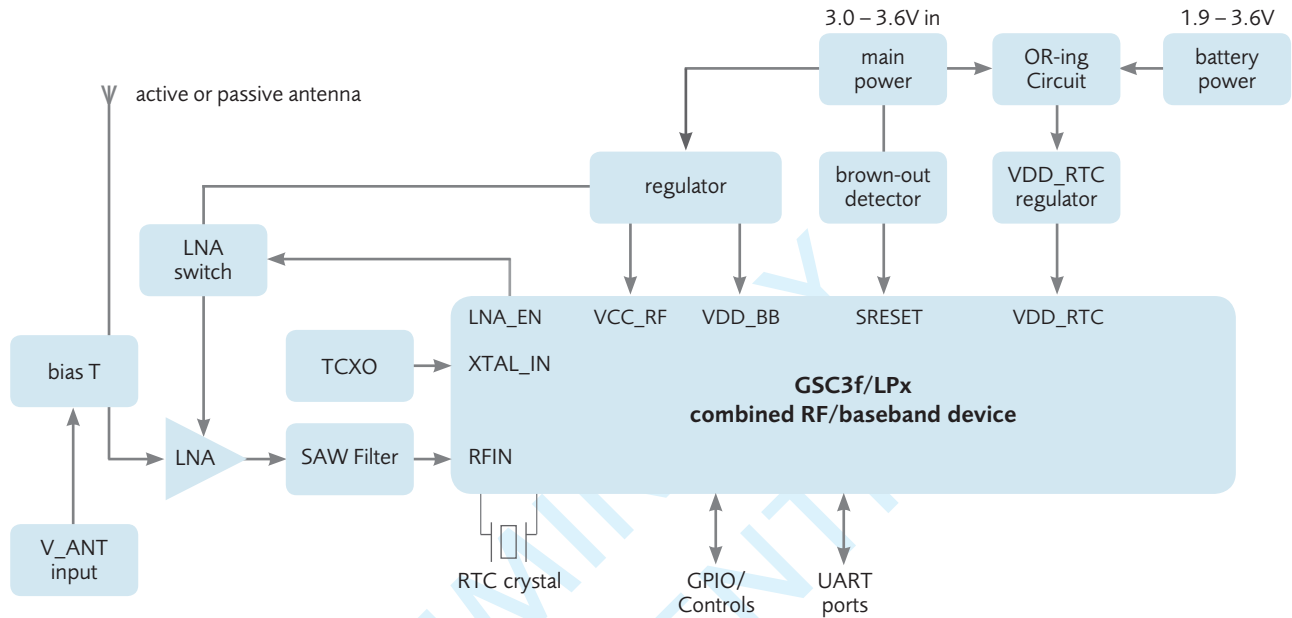

Figure 2-1: Jupiter 3-30 architecture

## 2.3 Major components of the Jupiter 3-30

**LNA (Low Noise Amplifier):** this amplifies the GPS signal and provides enough gain for the receiver to use a passive antenna. A very low noise design is used to provide maximum sensitivity.

**LNA switch:** this switch controls the LNA during low power modes.

**Bias T:** this provides the voltage to an external active antenna.

**Bandpass SAW filter (1.575 GHz):** this filters the GPS signal removing unwanted signals caused by external influences that would corrupt the operation of the receiver. The filtered signal is fed to the RF input of GSC3 chipset for further processing. The filter has a bandwidth of 2MHz.

**TCXO (Temperature Compensated Crystal Oscillator):** this highly stable 16.369 MHz oscillator controls the down conversion process for the RFIC block.

**Regulator:** this dual low-noise regulator provides two outputs of 2.85V power to the RF section and the digital IO section of the GSC3 chip.

**Main power:** primary supply voltage range is 3.0–3.6V.

**Brown out detector:** the precision voltage detector chip senses the input voltage and resets the module in case of any drop in the voltage. This detector chip also serves the function of power-on-reset.

**OR-ing circuit:** this circuit distributes the RTC/SRAM voltage from either the main voltage supply or the back-up voltage input in order for the RTC/SRAM elements to work in low power and continuous modes. However a back-up voltage must be connected if the device is to be shut down and expected to perform Hot and Warm starts.

**VDD\_RTC regulator:** supplies a regulated voltage for the RTC/SRAM cell within the GSC3 chip.

**Battery power:** the back-up battery supply feeds the VDD\_RTC regulator through the OR-ing circuit, and provides the power to the battery-backed SRAM and the RTC section of the GSC3.

**GSC3e LPx chip:** this single chip GPS device includes an integrated Baseband and RF section.

**Flash:** the 4 Megabit Flash memory stores software and also some long term data.

**RTC (Real Time Clock) crystal:** the 32 kHz crystal operates in conjunction with the RTC inside the baseband block, and provides an accurate clock function when main power has been removed, if the battery backup is connected.

## 2.4 Physical characteristics

The Jupiter 3-30 receiver is identical in form and fit to the Jupiter 20. It is a surface mount device packaged on a miniature printed circuit board, with a metallic RF enclosure on one side.

## 2.5 Mechanical specification

The physical dimensions of the Jupiter 3-30 are as follows:

**length:** 25.4 mm  $\pm$  0.1 mm

**width:** 25.4 mm  $\pm$  0.1 mm

**thickness:** 3.0 mm max

**weight:** 4.0 g max

Refer to Figure 8-1 for the Jupiter 3-30 mechanical drawing.

## 2.6 External antenna surface mount pads

The RF surface mount pad for the external antenna has a characteristic impedance of 50 ohms.

## 2.7 I/O and power connections

The I/O (Input Output) and power connections use surface mount pads with edge plating around the edge of the module.

## 2.8 Environmental

The environmental operating conditions of the Jupiter 3-30 are as follows:

**temperature:**  $-40^{\circ}\text{C}$  to  $+85^{\circ}\text{C}$

**humidity:** up to 95% non-condensing or a wet bulb temperature of  $+35^{\circ}\text{C}$

**altitude:**  $-304$  m to 18000 m

**vibration:** random vibration IEC 68-2-64

**max. vehicle dynamics:** 500 m/s

**shock (non-operating):** 18 G peak, 5 ms

## 2.9 Compliances

The Jupiter 3-30 complies with the following:

- Directive 2002/95/EC on the restriction of the use of certain hazardous substances in electrical and electronic equipment (RoHS)
- CISPR22 and FCC: Part 15, Class B for radiated emissions
- Automotive standard TS 16949
- Manufactured in an ISO 9000:2000 accredited facility

## 2.10 Marking/Serialization

The Jupiter 3-30 supports a code 128 barcode indicating the unit serial number. The Navman 13-character serial number convention is:

- characters 1 and 2: year of manufacture (e.g. 06=2006, 07=2007)
- characters 3 and 4: week of manufacture (e.g. 01=1st week of year, 02=2nd week of year)
- character 5: manufacturer code
- characters 6 and 7: product and type
- character 8: product revision
- characters 9-13: sequential serial number

## 3.0 Performance characteristics

### 3.1 TTFF (Time To First Fix)

TTFF is the actual time required by a GPS receiver to achieve a position solution. This specification will vary with the operating state of the receiver, the length of time since the last position fix, the location of the last fix, and the specific receiver design.

Aiding is a method of effectively reducing the TTFF by making every start Hot or Warm.

#### 3.1.1 Hot start

A hot start results from a software reset after a period of continuous navigation, or a return from a short idle period (i.e. a few minutes) that was preceded by a period of continuous navigation. In this state, all of the critical data (position, velocity, time, and satellite ephemeris) is valid to the specified accuracy and available in SRAM. Battery backup of the SRAM and RTC during loss of power is required to achieve a hot start.

#### 3.1.2 Warm start

A warm start typically results from user-supplied position and time initialisation data or continuous RTC operation with an accurate last known position available in memory. In this state, position and time data are present and valid but ephemeris data validity has expired.

#### 3.1.3 Cold start

A cold start acquisition results when either position or time data is unknown. Almanac information is used to identify previously healthy satellites.

### 3.2 Acquisition times

Table 3-1 shows the corresponding TTFF times for each of the acquisition modes.

Mode	@ -125 dBm	
	Typ	90%
hot start TTFF	500 ms	<1 s
warm start TTFF	31 s	36 s
cold start TTFF	33 s	38 s
re-acquisition (<10 s obstruction)	1 s	

**Table 3-1: Acquisition times at -125 dBm**

### 3.3 Timing 1PPS output

The 1 PPS output of the Jupiter 3-30 receiver is accurate to <1 s, typical  $\pm 300$  ns ref UTC. Refer to Table 6-2 for the default status on the Jupiter 3-30.

## 3.4 Power management

The Jupiter 3-30 offers two power saving modes: Adaptive TricklePower and Push-To-Fix, which can be set using NMEA or SiRF Binary messages.

### 3.4.1 Adaptive TricklePower

The Jupiter 3-30 can use the Adaptive TricklePower (ATP) feature, which reduces power consumption by intelligently switching between full power in tough GPS environments and low power in strong GPS signal areas.

When signal levels drop, the receiver returns to full power so that message output rates remain constant. This results in variable power savings but much more reliable performance for a fixed output rate. Applications using ATP should give performance very similar to full power, but with significant power savings in strong signal conditions.

ATP is best suited for applications that require solutions at a fixed rate as well as low power consumption and still maintain the ability to track weak signals.

With ATP at a 1 second update, a power saving of 50% can easily be achieved with minimal degradation in navigation performance.

### 3.4.2 Push-To-Fix mode

Push-To-Fix mode always forces the GPS software to revert to a continuous sleep mode after a navigation position fix. It will stay in sleep mode until woken by activation of the WAKEUP input (pad 26) to compute a fresh position.

If the ephemeris data become invalid, the RTC has the ability to self activate and refresh the data, thus keeping the restart TTFB very short.

This mode yields the lowest power consumption of the module, and is ideal where a battery powered application requires very few position fixes.

For further information refer to the Navman Low Power Operating Modes application note (LA000513), Navman NMEA reference manual (MN000315) and the SiRF Binary Protocol reference manual.

## 3.5 Differential aiding

### 3.5.1 Differential GPS (DGPS)

DGPS is not available on the Jupiter 3-30.

### 3.5.2 Satellite Based Augmentation Systems (SBAS)

The Jupiter 3-30 is capable of receiving SBAS differential corrections including WAAS and EGNOS. SBAS improves horizontal position accuracy by correcting GPS signal errors caused by ionospheric disturbances, timing and satellite orbit errors.

## 3.6 Core processor performance

The standard Jupiter 3-30 with GSW3 software runs at a CPU clock speed of 49 MHz. An SDK (Software Development Kit) is available from SiRF to customise the Jupiter 3-30 firmware.



## 3.7 Sensitivity

Sensitivity of the Jupiter 3-30 is measured assuming a system noise value of 3 dB. The sensitivity values are as follows:

Parameter	Signal Strength	C/N <sup>0</sup>
acquisition – cold start	-145 dBm	25 dBHz
acquisition – hot start	-155 dBm	15 dBHz
navigation	-158 dBm	12 dBHz
tracking	-159 dBm	10 dBHz

**Table 3-2: Sensitivity**

## 3.8 Dynamic constraints

The Jupiter 3-30 receiver is programmed to deliberately lose track if any of the following limits is exceeded:

- velocity: 500m/s max
- acceleration: 4 G (39.2m/s<sup>2</sup>) max
- vehicle jerk: 5 m/s<sup>3</sup> max
- altitude: 18000m max (referenced to MSL)

## 3.9 Position and velocity accuracy

The position and velocity accuracy of the Jupiter 30 are shown in Table 3-3, assuming full accuracy C/A code. These values are the same in normal operation and when Adaptive TricklePower is active.

Parameter	Value
horizontal CEP*	2.5 m
horizontal (2 dRMS)	5.5 m
vertical VEP*	2.0 m
velocity (speed)**	< 0.01m/s
velocity (heading)**	< 0.01
* position error 50% and under normal open sky conditions	
** In 3D Kalman filtered mode in steady state open sky conditions	

**Table 3-3: Position and velocity accuracy**

## 4.0 Multi-mode aiding

Multi-mode aiding technology makes navigation information available to GPS devices when enough Satellite Vehicles (SVs) are not visible due to obstruction. In autonomous operation mode, the GPS receiver requires a signal level of 28 dBHz or higher in four or more SVs to download ephemerides. This requires an uninterrupted full 30 seconds of data reception from each SV. If the data isn't received in full, the ephemeris data collection has to start again at the next cycle.

The type of multi-mode aiding currently supported by the Jupiter 3-30 is Ephemeris Push. This feature supports live ephemeris data to be downloaded from application servers that allows hot start performance at all times including in weak conditions and moving start ups. The ephemeris would typically be valid for 4 hours until the live ephemeris is downloaded or new ephemeris data is provided.

To use with this Ephemeris Push, the live ephemeris data is collected at application servers and then transmitted to the GPS receiver through a network connection. An application note about Ephemeris Push is in preparation and will be available at a later date.

## 5.0 Electrical requirements

### 5.1 Power supply

#### 5.1.1 Primary power

The Jupiter 3-30 receiver is designed to operate from a single supply voltage, meeting the requirements shown in Table 5-1.

Parameter	Value	
input voltage	3.0 to 3.6VDC	
average sustained power (after 1st solution)	@ 3 V: <82 mW	@ 3.3 V: <95 mW
power (typ) using ATP*	56 mW at 3.3 V	
battery backup voltage**	1.9 to 3.6VDC	
battery backup current	5 to 6µA (typ)	
ripple	not to exceed 50 mV peak to peak	
*Using Adaptive TricklePower with a 1 s update		
**Battery backup voltage must not fall below 1.4V		

**Table 5-1: Operating power for the Jupiter 3-30**

#### 5.1.2 Battery backup (SRAM/RTC backup)

During 'powered down' conditions, the SRAM and RTC (Real Time Clock) may be kept operating by supplying power from the VBATT as shown in Table 5-1.

#### 5.1.3 VCC\_RF power supply

The VCC\_RF (pad 20) provides a regulated 2.85 V power source. The specifications for this supply are as follows:

voltage: 2.85 V ± 2%

current max: 50 mA

#### 5.1.4 External antenna voltage

DC power is supplied to the external antenna through the antenna power input pad (VANT). The receiver does not use this supply. The DC supply to the RF connection does not use current limiting in the event of a short circuit. Reference designs for antenna current limiting are available in the Jupiter 3-30 Integrator's manual (LA000577).

The external antenna characteristics are as follows:

voltage (typ): 3 V

voltage max: 12 V

current max: 50 mA

**WARNING:** The GPS receiver will experience permanent damage if the antenna or its cable develops a short circuit and the external antenna current is not limited.

#### 5.1.5 RF (Radio Frequency) input

RF input is 1575.42 MHz (L1 Band) at a level between -135 dBm and -159 dBm into a 50 ohm impedance. This input may have a DC voltage impressed upon it to supply power to an active antenna. The maximum input return loss is -9 dB.

## 5.1.6 Antenna gain

The receiver will operate with a passive antenna with unity gain. However, GPS performance will be optimum when an active antenna is used. The gain of this antenna at the input of the module should ideally be 16 dB.

For recommendations on antenna use and testing see the Jupiter 3-30 Integrator's manual (LA000577).

## 5.1.7 Burnout protection

The receiver accepts without risk of damage a signal of +10 dBm from 0 to 2 GHz carrier frequency, except in band 1560 to 1590 MHz where the maximum level is -10 dBm.

## 5.1.8 Jamming performance

The typical jamming performance of the receiver based upon a 3 dB degradation in C/N0 performance is shown in Table 5-2. This is with reference to the external antenna.

Frequency MHz	Jamming signal power dBm
1550	-22
1555	-25
1560	-38
1565	-45
1570	-65
1574	-85
1575.42	-90
1576	-85
1580	-77
1585	-70
1590	-55
1595	-37
1600	-23

**Table 5-2: Typical jamming performance**

## 5.1.9 Flash upgradability

The firmware programmed in the Flash memory may be upgraded via the serial port. The user can control this by driving the Serial BOOT (pad 3) high at startup, then downloading the code from a PC with suitable software (e.g. SiRFFlash). In normal operation this pad should be left floating for minimal current drain. It is recommended that in the user's application, the BOOT pad is connected to a test pad for use in future software upgrades.

## 5.1.10 Reset input

This active low input (pad 22) allows the user to restart the software from an external signal. In normal operation this pad should be left floating or activated by an open drain driver. Active pull-up is not recommended.

## 5.2 Data input output specifications

All communications between the Jupiter 3-30 receiver and external devices are through the I/O surface mount pads. These provide the contacts for power, ground, serial I/O and control. Power requirements are discussed in Section 5.1.

### 5.2.1 Voltage levels

The I/O connector voltage levels measured at PWR\_IN=3V are shown in Table 5-3.

Signal	Parameter	Value
TXD & RXD GPIOs	V <sub>IH</sub> (min)	1.995V
	V <sub>IH</sub> (max)	3.15V
	V <sub>IL</sub> (min)	0.3V
	V <sub>IL</sub> (max)	0.855V
	V <sub>OH</sub> (min) at I <sub>OH</sub> 2mA	2.137V
	V <sub>OH</sub> (max)	2.85V
	V <sub>OL</sub> (min)	0V
	V <sub>OL</sub> (max) at I <sub>OL</sub> -2mA	0.7125V
Reset input*	max capacitance C <sub>max</sub>	100pF
	input current max	-600μA
	pulse time min	250ms
*Reset input should not be driven high by external circuits. It is recommended that this input is driven low by an open drain interface.		

**Table 5-3: Interface voltage levels**

## 5.2.2 I/O surface mount pads

Details of the surface mount pad functions are shown in Table 5-4.

Pad No.	Name	Type	Description
1	PWRIN	P	main power input (3.3 V)
2	GND	P	ground
3	BOOT	I	serial boot (active high)
4	RXA	I	CMOS level asynchronous input for UART A
5	TXA	O	CMOS level asynchronous output for UART A
6	TXB	O	CMOS level asynchronous output for UART B
7	RXB	I	CMOS level asynchronous input for UART B
8	NANT_SC	I	antenna short circuit sensor input (active low)
9	RF_ON	O	output to indicate whether the RF section is enabled (active high)
10	GND	P	ground
11	GND	P	ground
12	GND	P	ground
13	GND	P	ground
14	GND	P	ground
15	GND	P	ground
16	GND	P	ground
17	RF_IN	I	RF input
18	GND	P	ground
19	ACTIVE_PWR	P	active antenna power input
20	VCC_RF	O	RF Power (+2.85 V) supply output
21	V_BATT	P	backup battery input
22	NRESET	I	external reset (active low, see section 5.1.10)
23	GPS_FIX	O	GPS fix indication (active low)
24	GPIO15	IO	Reserved, do not connect
25	GPIO4	IO	configuration to flash
26	WAKEUP	I	push-to-fix wakeup (active on +ve going edge)
27	ANT_OC	I	antenna open circuit sensor input (active high)
28	ANT_CTRL	O	active antenna control output
29	1PPS	O	1 pulse per second output
30	GND	P	ground

**Table 5-4: Jupiter 3-30 receiver pad functions**

## 6.0 Software interface

The host serial I/O port of the receiver's serial data interface supports full duplex communication between the receiver and the user.

The default serial modes are as follows:

**Port A:** NMEA, 9600 bps, 8 data bits, no parity, 1 stop bit

**Port B:** SiRF Binary, 38 400 bps, 8 data bits, no parity, 1 stop bit

### 6.1 NMEA output messages

NMEA is a standard protocol used by GPS receivers to transmit data. The output NMEA (0183 v2.2) messages for the Jupiter 3-30 are listed in Table 6-1. A complete description of each NMEA message is contained in the Navman NMEA reference manual (MN000315).

Message ID and description	Refresh rate
GGA – global positioning system fix data	1 s
GSA – DOP and active satellites	1 s
GSV – satellites in view	1 s
RMC – recommended minimum specific GPS data	1 s
VTG – track made good and ground speed	1 s
GLL – latitude, longitude, UTC of position fix and status	1 s
ZDA – PPS timing message	1 s

**Table 6-1: Default NMEA messages**

### 6.2 SiRF Binary

SiRF Binary is the proprietary interface protocol of SiRF. It allows the Jupiter 3-30 a greater level of configurability and a more standardised message set than NMEA. A complete description of each binary message is contained in the SiRF Binary Protocol reference manual.

### 6.3 Software functions and capabilities

Table 6-2 shows the software features available to the Jupiter 3-30.

Feature	Description	Availability
SBAS capability	Improves position accuracy by using freely available satellite-based correction services called SBAS (Satellite Based Augmentation System)	A
Adaptive TricklePower	Improves battery life by using enhanced power management and intelligently switching between low and full power depending on the current GPS signal level	A
Push-to-Fix	Provides an on-demand position fix mode designed to further improve battery life	A
Ephemeris Push	Allows hot start performance at all times including in weak conditions and moving start ups	yes
Almanac to Flash	Improves cold start times by storing the most recent almanac to flash memory	yes
Low signal acquisition	Acquires satellites and continues tracking in extremely low signal environments	yes
Low signal navigation	Continues navigating in extremely low signal environments	yes
Write to Flash	Saves and restores user configurations and preferences to Flash memory (software version 2.0 and higher)	yes
yes = always enabled      A = available, but not enabled by default		

**Table 6-2: Jupiter 3-30 software capability**

## 7.0 Jupiter 20 / 3-30 comparison

This section highlights the differences between the Jupiter 20 and Jupiter 3-30 to assist with replacing modules in existing applications.

### 7.1 Active antenna specification

Feature	Jupiter 20	Jupiter 3-30
antenna gain	active antenna gain should be in the range of 20 to 30 dB	best results achieved with an active antenna gain of 16 dB at the module input

**Table 7-1: Active antenna differences**

### 7.2 Electrical interface

The following table highlights the differences between the electrical connector pins.

Pin no.	Jupiter 20		Jupiter 3-30	
	Name	Description	Name	Description
24	GPIO6	user GPIO	GPIO13	no function
25	GPIO5		GPIO4	
26	GPIO7		Wake_Up	Push-to-Fix wake up (active high)

**Table 7-2: Electrical interface differences**

### 7.3 Functionality

Feature	Description	J20	J3-30
RTCM DGPS	Accepts DGPS corrections in the RTCM SC-104 format	yes	no
SBAS DGPS	Accepts DGPS corrections in the SBAS format	yes	yes
PPS time message	PPS binary output message, MID52 (0x34)	yes	no
SBAS message	SBAS operating parameters message MID50 (0x32)	yes	no
user GPIO	proprietary NMEA messaging to control User GPIO	yes	no

**Table 7-3: Functionality differences**

## 8.0 Jupiter 3-30 mechanical drawing

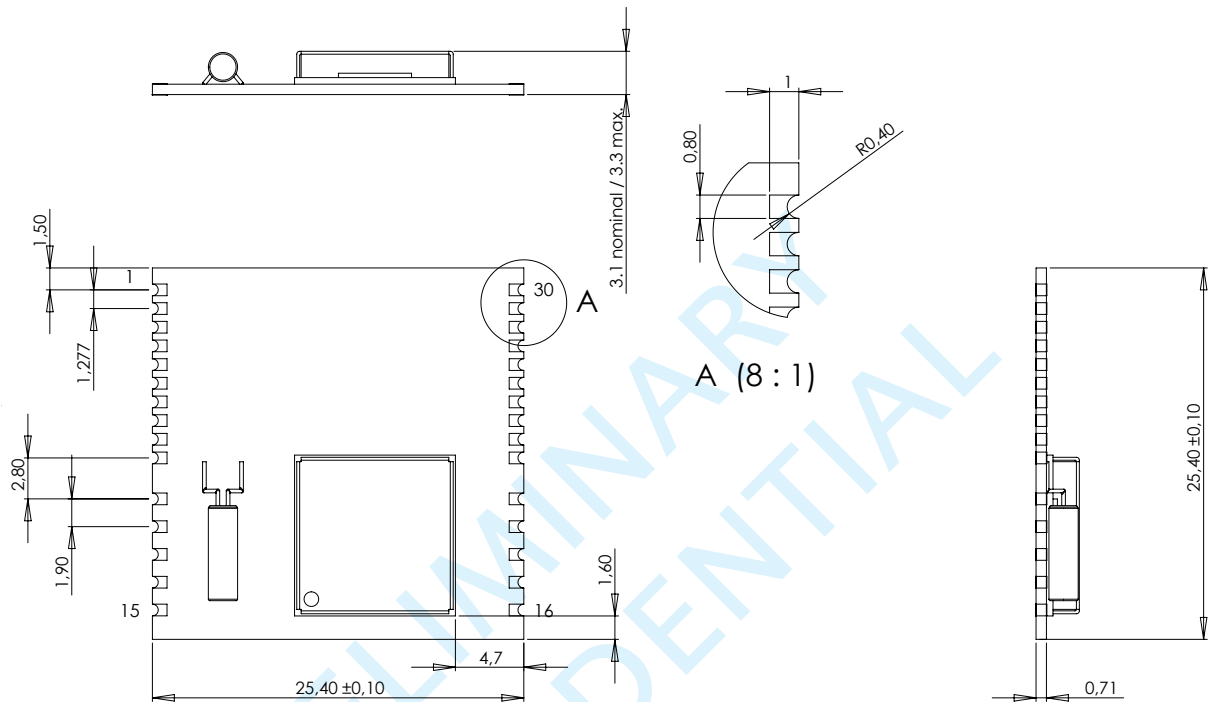

Figure 8-1: Jupiter 3-30 mechanical layout

## 9.0 Jupiter 3-30 Development kit

The Jupiter 3-30 Development kit is available to assist in the development and integration of the Jupiter 3-30 module in custom applications. The Development kit contains all of the necessary hardware and software to carry out a thorough evaluation and development of applications using the Jupiter 3-30 module.

## 10.0 Product handling

### 10.1 Packaging and delivery

Jupiter 3-30 modules are shipped in Tape and Reel form. The reeled modules are shipped with 250 units per 300x44 mm (D x W) reel with a pitch of 32 mm. Each reel is 'dry' packaged and vacuum sealed in an MBB (Moisture Barrier Bag) with two silica gel packs and placed in a carton.

The MOQ (Minimum Order Quantity) for shipping is 250 units.

All packaging is ESD protective lined. Please follow the MSD and ESD handling instructions on the labels of the MBB and exterior carton (refer to sections 10.2 and 10.3).



## 10.2 Moisture sensitivity

The Jupiter 3-30 GPS receiver is an MSD (Moisture Sensitive Device) level 3. Precautionary measures are required in handling, storing and using such devices to avoid damage from moisture absorption. If localised heating is required to rework or repair the device, precautionary methods are required to avoid exposure to solder reflow temperatures that can result in performance degradation.

Further information can be obtained from the IPC/JEDEC standard J-STD-033: Handling, Packing, Shipping and Use of Moisture/Reflow Sensitive Surface Mount Devices.

## 10.3 ESD sensitivity

The Jupiter 3-30 GPS receiver contains class 1 devices and is ESDS (ElectroStatic Discharge Sensitive). Navman recommends the two basic principles of protecting ESDS devices from damage:

- Only handle sensitive components in an ESD Protected Area (EPA) under protected and controlled conditions
- Protect sensitive devices outside the EPA using ESD protective packaging

All personnel handling ESDS devices have the responsibility to be aware of the ESD threat to reliability of electronic products.

Further information can be obtained from the IEC Technical Report IEC61340-5-1 & 2: Protection of electronic devices from electrostatic phenomena.

## 10.4 Safety

Improper handling and use of the Jupiter GPS receiver can cause permanent damage to the receiver and may even result in personal injury.

## 10.5 Disposal

This product should not be treated as household waste. For more detailed information about recycling of this product, please contact your local waste management authority or the reseller from whom you purchased the product.

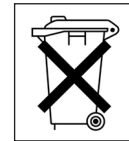

## 11.0 Ordering information

The part numbers of the Jupiter 3-30 variants are shown in Table 11-1.

Part Number	Description
J3-30	Jupiter 3-30 (standard)
J3-30CB	Jupiter 3-30 adapter board
J3-30DK	Jupiter 3-30 Development Kit

**Table 11-1: Jupiter 3-30 ordering information**

## 12.0 Glossary and acronyms

**2dRMS:** twice-distance Root Mean SquareA horizontal measure of accuracy representing the radius of a circle within which the true value lies at least 95% of the time.

**Almanac:** A set of orbital parameters that allows calculation of approximate GPS satellite positions and velocities. The almanac is used by a GPS receiver to determine satellite visibility and as an aid during acquisition of GPS satellite signals. The almanac is a subset of satellite ephemeris data and is updated weekly by GPS Control.

**C/A code:** Course Acquisition codeA spread spectrum direct sequence code that is used primarily by commercial GPS

receivers to determine the range to the transmitting GPS satellite.

**C/N0:** Carrier to Noise ratio

**DGPS:** Differential GPSA technique to improve GPS accuracy that uses pseudo-range errors recorded at a known location to improve the measurements made by other GPS receivers within the same general geographic area.

**GDOP:** Geometric Dilution of PrecisionA factor used to describe the effect of the satellite geometry on the position and time accuracy of the GPS receiver solution. The lower the value of the GDOP parameter, the less the error in the position solution. Related indicators include PDOP, HDOP, TDOP and VDOP.

**EGNOS:** European Geostationary Navigation Overlay ServiceThe system of geostationary satellites and ground stations developed in Europe to improve the position and time calculation performed by the GPS receiver.

**Ephemeris:** A set of satellite orbital parameters that is used by a GPS receiver to calculate precise GPS satellite positions and velocities. The ephemeris is used to determine the navigation solution and is updated frequently to maintain the accuracy of GPS receivers.

**GPS:** Global Positioning SystemA space-based radio positioning system that provides accurate position, velocity, and time data.

**OEM:** Original Equipment Manufacturer

**Re-acquisition:** The time taken for a position to be obtained after all satellites have been made invisible to the receiver.

**SBAS:** Satellite Based Augmentation SystemAny system that uses a network of geostationary satellites and ground stations to improve the performance of a Global Navigation Satellite System (GNSS). Current examples are EGNOS and WAAS.

**SRAM:** Static Random Access Memory

**SAW filter:** Surface Acoustic Wave filter

**WAAS:** Wide Area Augmentation SystemThe system of satellites and ground stations developed by the FAA (Federal Aviation Administration) that provides GPS signal corrections. WAAS satellite coverage is currently only available in North America.

© 2006 Navman Wireless OEM Solutions. All Rights Reserved.

SiRF and SiRF logo are registered trademarks of SiRF Technology, Inc. SiRFstar, SiRFLoc, Push-to-Fix, and TricklePower are trademarks of SiRF Technology, Inc. All other trademarks mentioned in this document are property of their respective owners.

Information in this document is provided in connection with Navman Wireless OEM Solutions ('Navman') products. These materials are provided by Navman as a service to its customers and may be used for informational purposes only. Navman assumes no responsibility for errors or omissions in these materials. Navman may make changes to specifications and product descriptions at any time, without notice. Navman makes no commitment to update the information and shall have no responsibility whatsoever for conflicts or incompatibilities arising from future changes to its specifications and product descriptions. No license, express or implied, by estoppel or otherwise, to any intellectual property rights is granted by this document. Except as provided in Navman's Terms and Conditions of Sale for such products, Navman assumes no liability whatsoever.

THESE MATERIALS ARE PROVIDED 'AS IS' WITHOUT WARRANTY OF ANY KIND, EITHER EXPRESSED OR IMPLIED, RELATING TO SALE AND/OR USE OF NAVMAN PRODUCTS INCLUDING LIABILITY OR WARRANTIES RELATING TO FITNESS FOR A PARTICULAR PURPOSE, CONSEQUENTIAL OR INCIDENTAL DAMAGES, MERCHANTABILITY, OR INFRINGEMENT OF ANY PATENT, COPYRIGHT OR OTHER INTELLECTUAL PROPERTY RIGHT. NAVMAN FURTHER DOES NOT WARRANT THE ACCURACY OR COMPLETENESS OF THE INFORMATION, TEXT, GRAPHICS OR OTHER ITEMS CONTAINED WITHIN THESE MATERIALS. NAVMAN SHALL NOT BE LIABLE FOR ANY SPECIAL, INDIRECT, INCIDENTAL, OR CONSEQUENTIAL DAMAGES, INCLUDING WITHOUT LIMITATION, LOST REVENUES OR LOST PROFITS, WHICH MAY RESULT FROM THE USE OF THESE MATERIALS.

Navman products are not intended for use in medical, lifesaving or life sustaining applications. Navman customers using or selling Navman products for use in such applications do so at their own risk and agree to fully indemnify Navman for any damages resulting from such improper use or sale. Product names or services listed in this publication are for identification purposes only, and may be trademarks of third parties. Third-party brands and names are the property of their respective owners. Additional information, posted at [www.navman.com](http://www.navman.com), is incorporated by reference.