



Chipsmall Limited consists of a professional team with an average of over 10 year of expertise in the distribution of electronic components. Based in Hongkong, we have already established firm and mutual-benefit business relationships with customers from,Europe,America and south Asia,supplying obsolete and hard-to-find components to meet their specific needs.

With the principle of “Quality Parts,Customers Priority,Honest Operation,and Considerate Service”,our business mainly focus on the distribution of electronic components. Line cards we deal with include Microchip,ALPS,ROHM,Xilinx,Pulse,ON,Everlight and Freescale. Main products comprise IC,Modules,Potentiometer,IC Socket,Relay,Connector.Our parts cover such applications as commercial,industrial, and automotives areas.

We are looking forward to setting up business relationship with you and hope to provide you with the best service and solution. Let us make a better world for our industry!



Contact us

Tel: +86-755-8981 8866 Fax: +86-755-8427 6832

Email & Skype: info@chipsmall.com Web: www.chipsmall.com

Address: A1208, Overseas Decoration Building, #122 Zhenhua RD., Futian, Shenzhen, China



Single Output Industrial Power Supplies

Features

- ◆ Power factor Corrected
- ◆ Wide range output adjustment
- ◆ Single wire current share
- ◆ Input transient protection
- ◆ UL508 Industrial Controls Approval
- ◆ Factory Mutual Approval (Class 1, Div 2)
- ◆ 5 Year Warranty
- ◆ EN61000-4 Input Transient

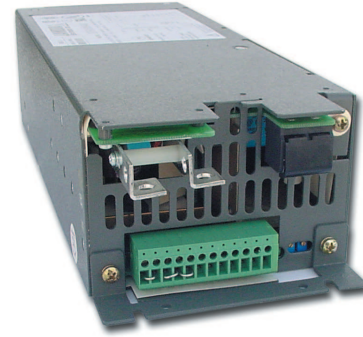

Specifications		JFS0500	JFS0750	JFS1000	JFS1500	JFS2000
AC Input Voltage	-	85-265VAC (170-265VAC JFS2000), 47-63Hz				
DC Input Voltage Range	-	120-330VDC (240-330VDC for JFS2000)				
Input Current (typ@110VAC)	A rms	6	9	12	20	12 ⁽¹⁾
Inrush Current (110 / 220VAC)	A	35 / 70				- / 70
Efficiency (typ@110VAC)	%	75				82 ⁽²⁾
Power Factor	-	Meets EN61000-3-2 (0.99 typical)				
Overcurrent Protection	-	<110% (auto recovery)				
Overvoltage Protection	V	24V models set at 30V, 48V models set at 60V (auto recovery)				
Hold Up Time (Typ)	ms	16				
Transient Reponse	-	For 25% load change, recovers to regulation within 5ms				
Remote Sense	-	Compenstates for 0.25V drop per leg				
Remote Adjust	-	With either external Resistor or Voltage				
Remote On / Off	-	Low = OFF, Open = ON				
Signals & Indicators	-	Open Collector AC Fail and DC Good, Green LED				
Parallel Connection	-	Single wire current share				
Operating Temperature	°C	-20 to +70°C, derate linearly to 50% load from 50°C (30 min warm up at -20°C)				
Storage Temperature	°C	-40 to +85				
Humidity (non condensing)	%RH	10 - 90				
Cooling	-	Internal fan				
Withstand Voltage	-	Input - Ground 2kVAC, Input - Output 3kVAC, Output - Ground 500VDC				
Vibration	-	Per IEC68-2-6				
Shock	-	Per IEC68-2-27				
Safety Agency Approvals	-	UL508, UL60950, CSA22.2 No.60950, EN60950, FM3611 & CE Mark				
Conducted & Radiated EMI	-	EN55022 Class A, FCC Docket 20780 Part 15, subpartJ, Class A				
Weight (Net / Shipping)	lbs	6 / 7	7 / 8		9 / 10	
Size (WxHxD)	mm	See output line drawings				
Warranty	-	5 years				

Notes: (Consult Installation Manual for detailed specifications, test methods and application notes)

(1) At 220VAC

(2) At 170VAC

OBSOLETE

Output Ratings

Model	Nom. Volt.	Adjust. Range	Min Load	Max Current	Load Reg (mV)	Line Reg (mV)	Ripple & Noise (mV p-p)
JFS0500-24	24V	20 - 29	0	20.8	< 240	< 240	250
JFS0750-24	24V	20 - 29	0	31.2	< 240	< 240	250
JFS1000-24	24V	20 - 29	0	41.6	< 240	< 240	250
JFS1500-24	24V	20 - 29	0	62.5	< 240	< 240	250
JFS2000-24	24V	20 - 29	0	83.3	< 240	< 240	250
JFS0500-48	48V	36 - 56	0	10.4	< 480	< 480	500
JFS0750-48	48V	36 - 56	0	15.6	< 480	< 480	500
JFS1000-48	48V	36 - 56	0	20.8	< 480	< 480	500
JFS1500-48	48V	36 - 56	0	31.2	< 480	< 480	500
JFS2000-48	48V	36 - 56	0	41.6	< 480	< 480	500

JFS0750/1000 Outline Drawing

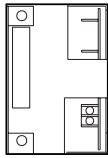

FRONT VIEW

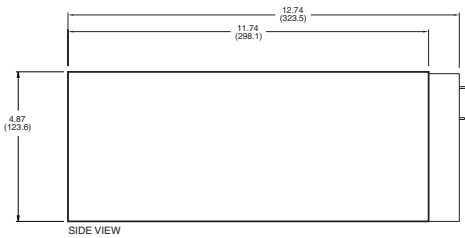

SIDE VIEW

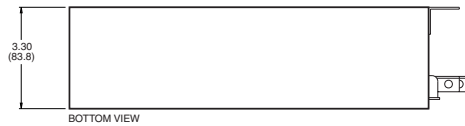

BOTTOM VIEW

NOTE:
1. DIMENSIONS ARE IN INCHES EXCEPT DIMENSIONS () ARE IN MM.
2. WEIGHT: NET 7.0 LBS, SHIPPING 8.0 LBS.

Other Industrial Products

HWS	15W to 1500W Single Output
LZS, LZSa	250W to 1500W Single Output
DLP, DPP, DSP	10 to 480W DIN Rail Single Output

For Additional Information, please visit
us.tdk-lambda.com/lp/products/jfs-series.htm



JFS0500 Outline Drawing

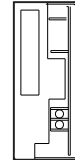

FRONT VIEW

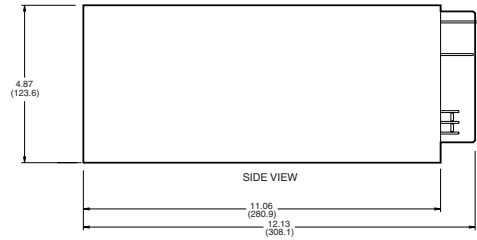

SIDE VIEW

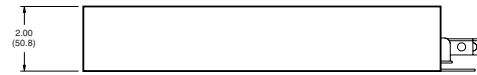

NOTE:
1. DIMENSIONS ARE IN INCHES EXCEPT DIMENSIONS () ARE IN MM.
2. WEIGHT: NET 6.0 LBS, SHIPPING 7.0 LBS.

PRELIMINARY

JFS1500/2000 Outline Drawing

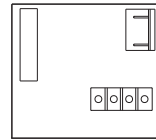

FRONT VIEW

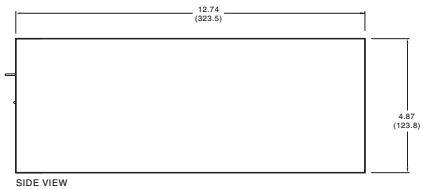

SIDE VIEW

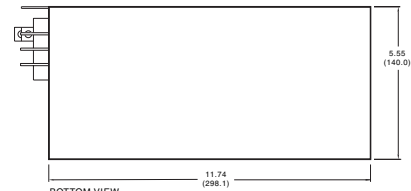

BOTTOM VIEW

NOTE:
1. DIMENSIONS ARE IN INCHES EXCEPT DIMENSIONS () ARE IN MM.
2. WEIGHT: NET 9.0 LBS, SHIPPING 10.0 LBS.

OBSOLETE