



Chipsmall Limited consists of a professional team with an average of over 10 year of expertise in the distribution of electronic components. Based in Hongkong, we have already established firm and mutual-benefit business relationships with customers from,Europe,America and south Asia,supplying obsolete and hard-to-find components to meet their specific needs.

With the principle of "Quality Parts,Customers Priority,Honest Operation,and Considerate Service",our business mainly focus on the distribution of electronic components. Line cards we deal with include Microchip,ALPS,ROHM,Xilinx,Pulse,ON,Everlight and Freescale. Main products comprise IC,Modules,Potentiometer,IC Socket,Relay,Connector.Our parts cover such applications as commercial,industrial, and automotives areas.

We are looking forward to setting up business relationship with you and hope to provide you with the best service and solution. Let us make a better world for our industry!



Contact us

Tel: +86-755-8981 8866 Fax: +86-755-8427 6832

Email & Skype: info@chipsmall.com Web: www.chipsmall.com

Address: A1208, Overseas Decoration Building, #122 Zhenhua RD., Futian, Shenzhen, China



REV	DOCUMENT	CHANGED BY	CHECK
6	202793	GRT 10APR01	SAV
7	204628	GRT 3 JAN 02	SAV

2X ϕ .094

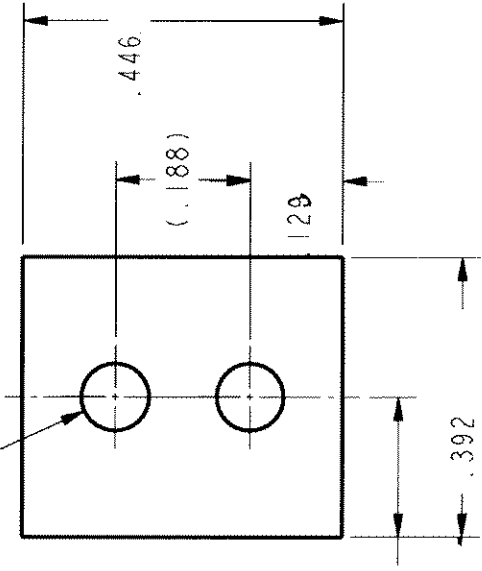

.196

.446

(.188)

12φ

.392

.010

NOTES

- MOUNTING HOLES MUST ACCEPT PINS OR SCREWS OF ϕ .087 MAX ON $.188 \pm .002$ CENTERS

- MATERIAL: NEOPRENE COATED FIBERGLASS CLOTH

UNLESS OTHERWISE SPECIFIED TOLERANCES ARE:	<input checked="" type="checkbox"/> US (INCH)	<input type="checkbox"/> METRIC
NO PLACE	$\pm .040$	± 1
ONE PLACE	$\pm .030$	$\pm 0,4$
TWO PLACE	$\pm .015$	$\pm 0,15$
THREE PLACE	$\pm .005$	\pm
ANGLES	\pm	\pm
RAW MATERIAL - COMMERCIAL STANDARD		

THIRD ANGLE PROJECTION



DRAWN	GRT	10APR01
CHECK	SAV	10APR01
THIS DRAWING COVERS A PROPRIETARY ITEM AND IS THE PROPERTY OF HONEYWELL SENSING AND CONTROL. THIS DRAWING IS NOT TO BE COPIED OR USED WITHOUT THE PERMISSION OF HONEYWELL.		
DIMENSIONS ARE TO BE MET BEFORE PROTECTIVE COATINGS ARE APPLIED		
PTC3D	ASME Y14.5M-1994	

Honeywell	
Sensing and Control	
TITLE	
INSULATOR, ELECTRICAL	
SIZE DWG TYPE	DRAWING NAME
A	JX-10131
SCALE 4 :	SHEET 1 OF 1

REV	7
SIZE DWG TYPE	DRAWING NAME
A	JX-10131
SCALE 4 :	SHEET 1 OF 1