



Chipsmall Limited consists of a professional team with an average of over 10 year of expertise in the distribution of electronic components. Based in Hongkong, we have already established firm and mutual-benefit business relationships with customers from,Europe,America and south Asia,supplying obsolete and hard-to-find components to meet their specific needs.

With the principle of “Quality Parts,Customers Priority,Honest Operation,and Considerate Service”,our business mainly focus on the distribution of electronic components. Line cards we deal with include Microchip,ALPS,ROHM,Xilinx,Pulse,ON,Everlight and Freescale. Main products comprise IC,Modules,Potentiometer,IC Socket,Relay,Connector.Our parts cover such applications as commercial,industrial, and automotives areas.

We are looking forward to setting up business relationship with you and hope to provide you with the best service and solution. Let us make a better world for our industry!



Contact us

Tel: +86-755-8981 8866 Fax: +86-755-8427 6832

Email & Skype: info@chipsmall.com Web: www.chipsmall.com

Address: A1208, Overseas Decoration Building, #122 Zhenhua RD., Futian, Shenzhen, China



PRODUCT NUMBER	PITCH
KFxxA0x000J0G	7.50 mm

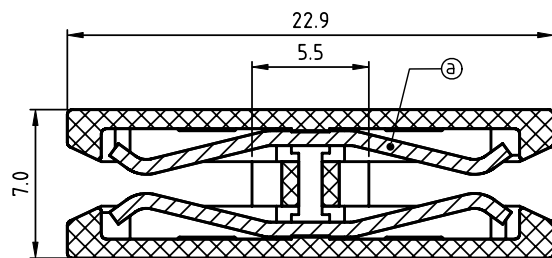
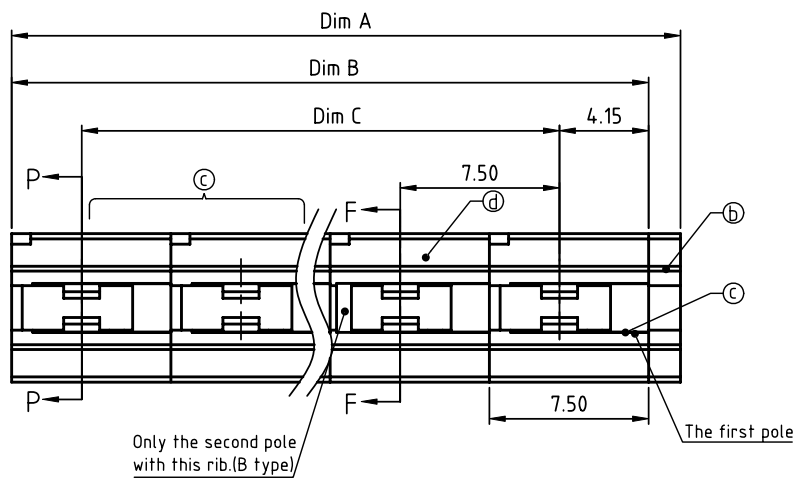

SECTION P-P

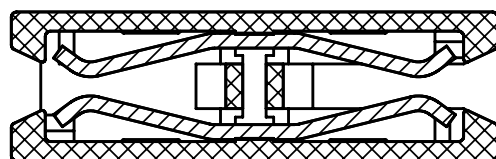

SECTION F-F

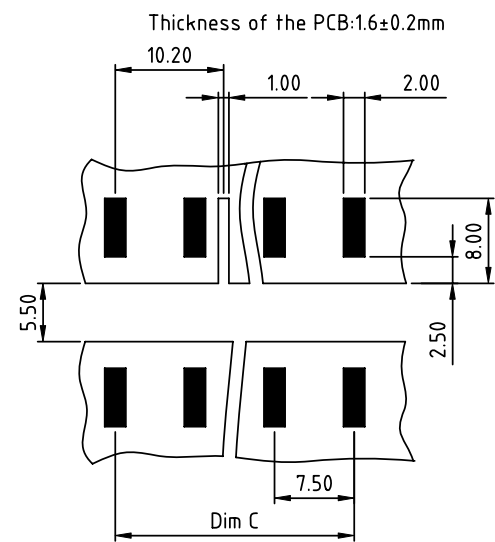

RECOMMENDED P.C.B LAYOUT
TOP VIEW

- Material:
- Item ③ Female contact: PhBz(CuSn), Tin plated
 - Item ⑥ Terminal Cover: Thermoplastic (UL94V-0)
 - Item ⑦ Terminal housing: Thermoplastic (UL94V-0)
 - Item ⑧ Terminal housing (B type): Thermoplastic (UL94V-0)
- Electrical cULus
- Voltage rating: 300VAC
 - Current rating: 10A
 - Withstanding Voltage: 1.6KV
 - Operating temperature: -40°C to +115°C

Dimension

Dim A	N×7.5+1.50
Dim B	N×7.5
Dim C	(N-1)×7.5

N=Number of poles

Poles	Tolerance
2p-6p	±0.20
7p-11p	±0.30
12p-16p	±0.40

PART NO.: KF xx A0 x 0 00J0 G

End stackable	0	Color	Black (RAL9005)	RoHS compliant	(lead<4%)
No. of poles	2		Red (RAL3001/D)	In copper Alloy	
02	2 poles	3	Orange(RAL2011/P)		
03	3 poles	4	Yellow(RAL1018/A)		
...	...	5	Green(RAL6018/T)		
16	16 poles	6	Blue (RAL5015/A)		
		8	Grey(RAL7035/D)		
		9	White(RAL1102)		
		C	Green(RAL6018/U)		

mat'l. code		surface	tolerance	projection	product family
		ASME Y14.5	ASME Y14.5		TERMINAL BLOCK
ltr ecn no dr date		tolerances unless otherwise specified		MM	title
				scale	TERMINAL BLOCK
		angles	X.±0.5		PCB CONNECTOR,BOARD TO BOARD
		X'±1"	X.X±0.3		
			X.XX±0.1		
		dr	EVIN ZHONG 050614		dwg no
		enr	EVIN ZHONG 050614		sheet 1 of 1
		chr	HANKE FENG 050614		size
		appd	SHI JUN 050614		A4
sheet index	revision sheet	A	1		type
					CUSTOMER Drawing