



Chipsmall Limited consists of a professional team with an average of over 10 year of expertise in the distribution of electronic components. Based in Hongkong, we have already established firm and mutual-benefit business relationships with customers from,Europe,America and south Asia,supplying obsolete and hard-to-find components to meet their specific needs.

With the principle of “Quality Parts,Customers Priority,Honest Operation,and Considerate Service”,our business mainly focus on the distribution of electronic components. Line cards we deal with include Microchip,ALPS,ROHM,Xilinx,Pulse,ON,Everlight and Freescale. Main products comprise IC,Modules,Potentiometer,IC Socket,Relay,Connector.Our parts cover such applications as commercial,industrial, and automotives areas.

We are looking forward to setting up business relationship with you and hope to provide you with the best service and solution. Let us make a better world for our industry!



Contact us

Tel: +86-755-8981 8866 Fax: +86-755-8427 6832

Email & Skype: info@chipsmall.com Web: www.chipsmall.com

Address: A1208, Overseas Decoration Building, #122 Zhenhua RD., Futian, Shenzhen, China



PART No	"A" WIRE BUNDLE DIA.	"B" APPROXIMATE HEIGHT
KL-125	.125-.150 (3.2-3.8)	.48 (12.2)
KL-200	.16-.24 (4.1-6.1)	.82 (20.7)
KL-250	.20-.30 (5.1-7.6)	.91 (23.0)
KL-350	.30-.40 (7.6-10.2)	1.03 (26.2)
KL-450	.40-.50 (10.2-12.7)	1.20 (30.5)
KL-600	.55-.65 (14.0-16.5)	1.25 (31.8)
KL-750	.70-.80 (17.8-20.3)	1.52 (38.6)
KL-950	.90-1.00 (22.9-25.4)	1.75 (44.5)

THRU HOLE MAY NOT
APPEAR ON ALL PARTS

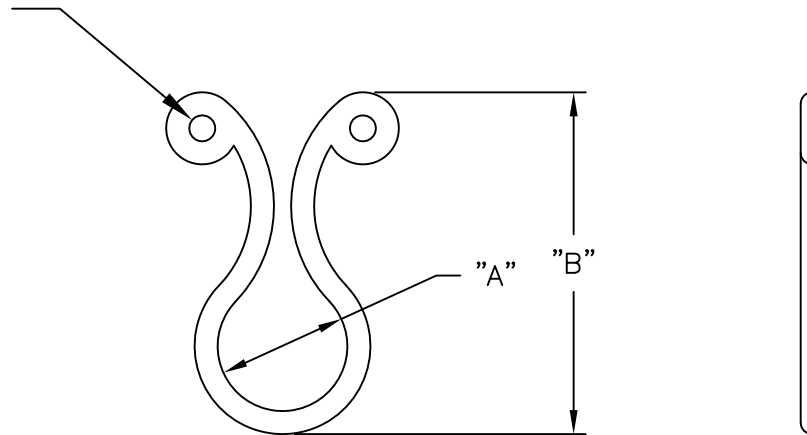

NOTE

1. MATERIAL: NYLON 6/6 (RMS-01).
FLAME RETARDANT, NYLON (RMS-19),
AVAILABLE BY SPECIAL ORDER ONLY.
SPECIFIED MATERIALS COMPLY WITH STANDARD SS-00259-1.
2. COLOR: NATURAL.
OTHER COLORS AVAILABLE BY SPECIAL ORDER ONLY.

H	SEE CO 200214 FOR CHANGES	SK 08.19.08	TITLE: KURLY LOK-SERIES		DWG IN IN (MM)	
G	SEE ECN #649 FOR CHANGES	SM 06.17.03				
F	SEE ECN #596 FOR CHANGES	SM 03.12.03				
E	CHANGED FILE NUMBER	SM 05.31.01	FILE # KL	DWN: J.P.	APP:	FINAL
D	ADDED OTHER COLOR BY SPECIAL ORDER	JL 3.7.00	MAT'L: SEE NOTES	DT: 02-11-91	DT:	PART # SEE TABLE
C	ADDED RMS-19	JL 3.3.00	RE: RICHCO, INC.	RICHCO INC. PO BOX 804238, CHICAGO, 60680 (773) 539-4060		
B	ADDED KL-200	JL 9.17.97	TOLERANCES UNLESS NOTED .XX=±.010 .XXX=±.005 FRAC=±1/64 ANG=±1°			
A	ADDED KL-125 TO PART #S	JB 11.17.95				
REV	DESCRIPTION	ENGR DATE				