



Chipsmall Limited consists of a professional team with an average of over 10 year of expertise in the distribution of electronic components. Based in Hongkong, we have already established firm and mutual-benefit business relationships with customers from,Europe,America and south Asia,supplying obsolete and hard-to-find components to meet their specific needs.

With the principle of "Quality Parts,Customers Priority,Honest Operation,and Considerate Service",our business mainly focus on the distribution of electronic components. Line cards we deal with include Microchip,ALPS,ROHM,Xilinx,Pulse,ON,Everlight and Freescale. Main products comprise IC,Modules,Potentiometer,IC Socket,Relay,Connector.Our parts cover such applications as commercial,industrial, and automotives areas.

We are looking forward to setting up business relationship with you and hope to provide you with the best service and solution. Let us make a better world for our industry!



Contact us

Tel: +86-755-8981 8866 Fax: +86-755-8427 6832

Email & Skype: info@chipsmall.com Web: www.chipsmall.com

Address: A1208, Overseas Decoration Building, #122 Zhenhua RD., Futian, Shenzhen, China



LEGEND = KEY PRODUCT CHARACTERISTICS

REVISION HISTORY

REV	DESCRIPTION	DATE	BY	ECN
0	FIRST ISSUE	10/12/2010	M.H	8984

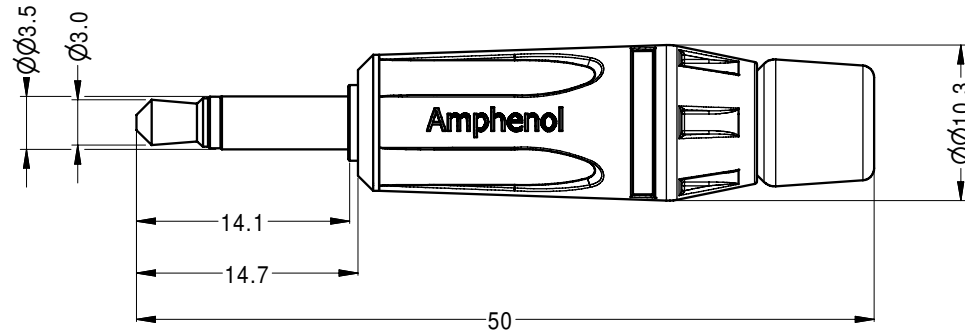
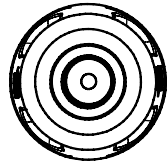

ITEM	PART NUMBER	DESCRIPTION	QTY
3	51270016-521	INSULATE PVC TUBE CLEAR	1
2	51560088-321/121	MONO INSERT ASSEMBLY NICKEL/GOLD	1
1	50440041-300/400	DIECAST SHELL NICKEL/BLACK FINISH	1

Parts List

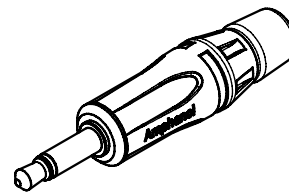

ISO VIEW (1 : 1)

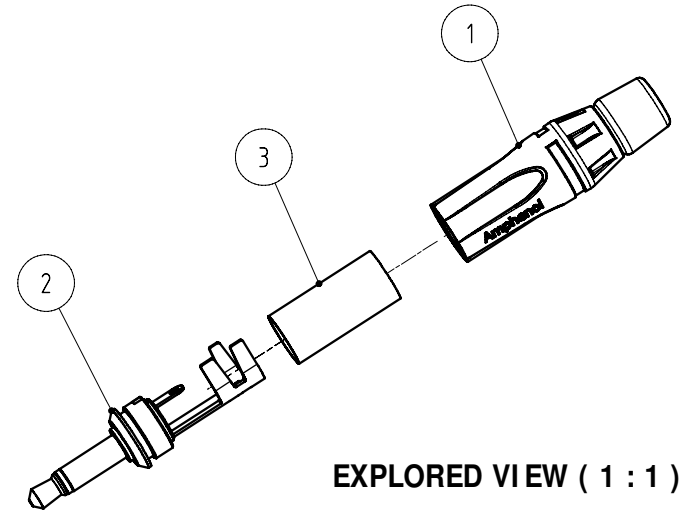

EXPLORED VIEW (1 : 1)

PART NUMBER		
PART NUMBER	SHELL FINISH	CONTACT FINISH
KM2P	NICKEL	NICKEL RING, SLEEVE & TIP
KM2P-AU	NICKEL	GOLD RING, SLEEVE & TIP
KM2PB	BLACK	NICKEL RING, SLEEVE & TIP
KM2PB-AU	BLACK	GOLD RING, SLEEVE & TIP

UNLESS OTHERWISE SPECIFIED TOLERANCE TO BE		THIS DOCUMENT IS THE PROPERTY OF AMPHENOL AUSTRALIA PTY. LTD. NO PART THEREOF MAY BE REPRODUCED AND USED WITHOUT THE PRIOR WRITTEN CONSENT OF THE OWNER				Amphenol Amphenol Australia Pty.Ltd, 2 Fiveways Blvd, Keysborough, VIC 3173	
LINEAR		ANGULAR		DRN: T.Z	DATE: 10-12-10	TITLE: 3.5mm MONO PHONE PLUG CUSTOMER DRAWING	
X ± 0.5	X' ± 1			CKD: M.H	DATE: 10-12-10	PART No: SEE TABLE	
X.X ± 0.25	X.X' ± 30'			APP'D: P.M	DATE: 10-12-10	DRAWING NO. 55010723-000-1	
X.XX ± 0.1	X.XX' ± 15'			SCALE: 2:1		CAD FILE: 55010723000120	SHEET 1/2
BREAK ALL SHARP EDGES AND REMOVE ALL BURRS				MATERIAL: SEE PARTS LIST & TABLE			
DO NOT SCALE				FINISH: SEE TABLE			
DIMENSIONS IN MILLIMETRES				THIRD ANGLE PROJECTION			