



Chipsmall Limited consists of a professional team with an average of over 10 year of expertise in the distribution of electronic components. Based in Hongkong, we have already established firm and mutual-benefit business relationships with customers from,Europe,America and south Asia,supplying obsolete and hard-to-find components to meet their specific needs.

With the principle of “Quality Parts,Customers Priority,Honest Operation,and Considerate Service”,our business mainly focus on the distribution of electronic components. Line cards we deal with include Microchip,ALPS,ROHM,Xilinx,Pulse,ON,Everlight and Freescale. Main products comprise IC,Modules,Potentiometer,IC Socket,Relay,Connector.Our parts cover such applications as commercial,industrial, and automotives areas.

We are looking forward to setting up business relationship with you and hope to provide you with the best service and solution. Let us make a better world for our industry!



## Contact us

Tel: +86-755-8981 8866 Fax: +86-755-8427 6832

Email & Skype: info@chipsmall.com Web: www.chipsmall.com

Address: A1208, Overseas Decoration Building, #122 Zhenhua RD., Futian, Shenzhen, China



# KMX Series Microminiature Tact Switch for SMT

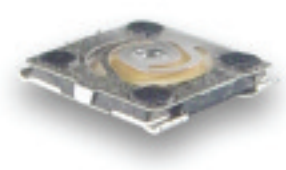

## Features

- Ultra low profile 0.58mm
- Compact switch body; 4.5x4.5mm
- 1.6 and 2.2N sharp tactile feel
- 250k cycles
- $\varnothing$  1.4mm actuator grounded
- Lead free compliant

## Typical Applications

- Allows higher board density with compact SMT switch for ultra low profile environment: cell phones keypads, key fob, white goods, medical and military

## Specification

FUNCTION: Snap action push-on type SPST/shielded  
 CONTACT TYPE: Normally open  
 TERMINALS: Gullwing type for SMT

## Mechanical

MAXIMUM ACTUATING FORCE/LIFE: 20 N for 1,000 cycles

Type	Operating force Newtons (grams)	Operating life (operations)	Travel
KMX211G/213G	1.6 (160) $\pm$ 30%	250,000	0,20 $\pm$ 0,10
KMX221G/223G	2.2 (220) $\pm$ 30%	250,000	0,20 $\pm$ 0,10

## Packaging

Switches are delivered in tape and reels of 10,000 pieces. The reel diameter is 380 (14.961). The tape dimensions conform to the EIA-RS-481 and EC-286-6 norms.

**NOTE:** For the latest information regarding RoHS compliance, please go to: [www.ittcannon.com/rohs](http://www.ittcannon.com/rohs).

## Electrical

	Silver	Gold
MAXIMUM POWER:	0.5 VA	0.5 VA
MAXIMUM VOLTAGE:	32 VDC	32 VDC
MAXIMUM CURRENT DC:	50 mA	20 mA
MINIMUM CURRENT DC:	1 mA	1 mA
CONTACT RESISTANCE:	$\leq$ 100 m $\Omega$	
INSULATION RESISTANCE:	$\geq$ 50 M $\Omega$	
BOUNCE TIME:	$\leq$ 6 ms	

## Environmental

	Silver	Gold
OPERATING TEMPERATURE:	-40°C to 85°C	-40°C to 125°C
STORAGE TEMPERATURE:	-55°C to 85°C	-55°C to 125°C
RELATIVE HUMIDITY	90 to 96%	

## Process

Compatible with infrared reflow, lead free soldering and pick and place SMT machines.

## How To Order

Our easy build-a-switch concept allows you to mix and match options to create the switch you need. To order, select desired option from each category and place it in the appropriate box.

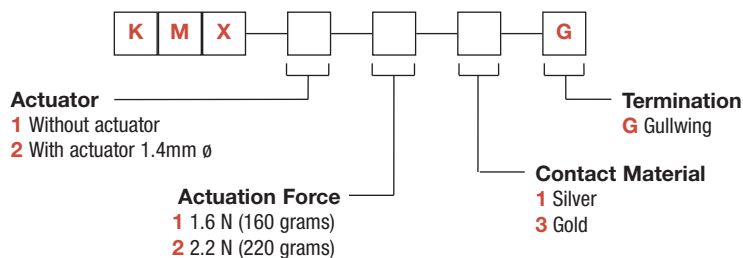

# KMX Series Microminiature Tact Switch for SMT

## ACTUATOR

### KMX 1

### PAD LAYOUT

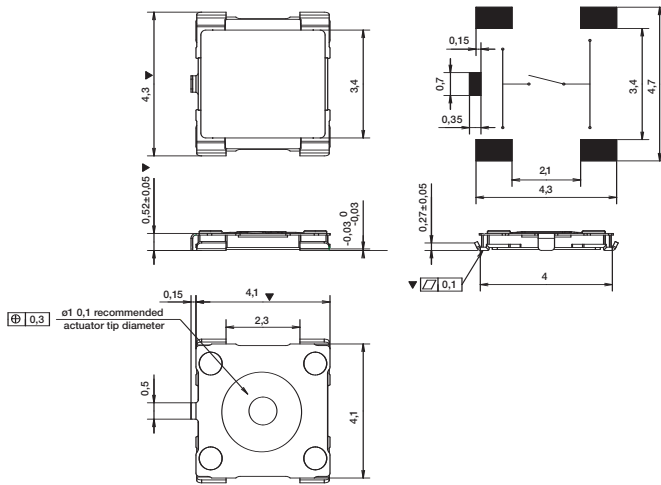

### KMX 2

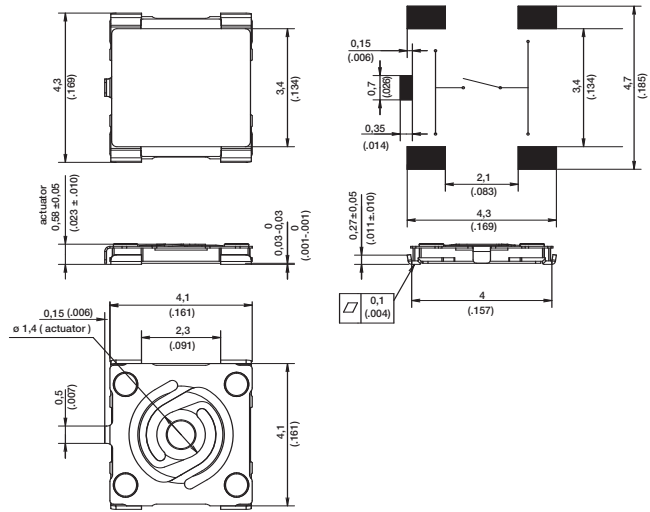

## TAPE & REEL

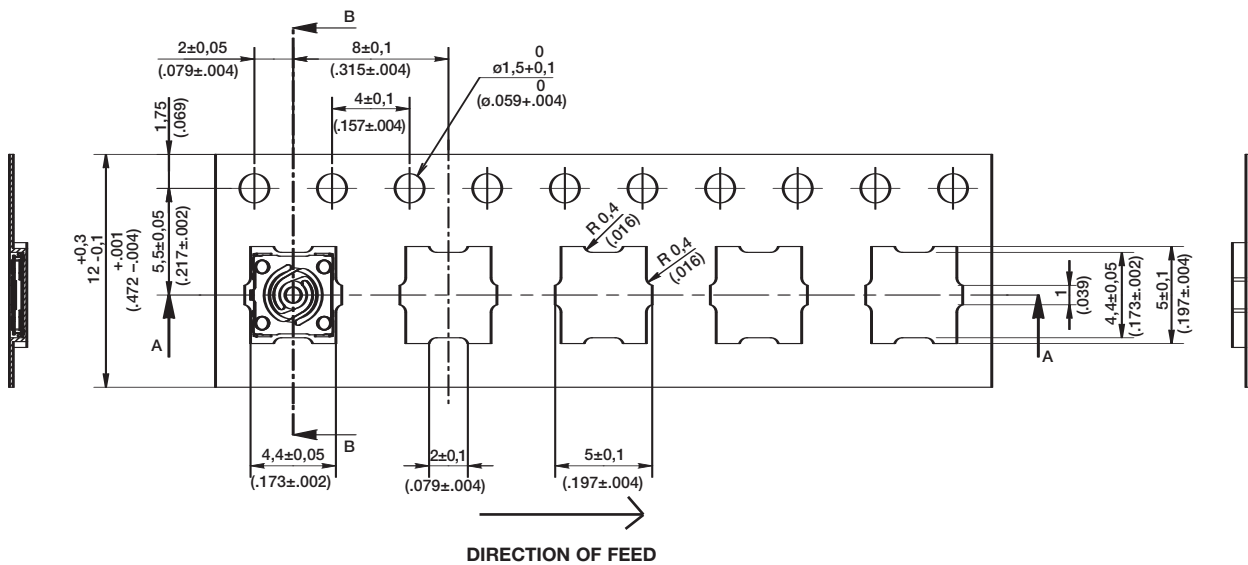

Dimensions shown in: mm (inch)  
Specifications and dimensions subject to change