



Chipsmall Limited consists of a professional team with an average of over 10 year of expertise in the distribution of electronic components. Based in Hongkong, we have already established firm and mutual-benefit business relationships with customers from,Europe,America and south Asia,supplying obsolete and hard-to-find components to meet their specific needs.

With the principle of "Quality Parts,Customers Priority,Honest Operation,and Considerate Service",our business mainly focus on the distribution of electronic components. Line cards we deal with include Microchip,ALPS,ROHM,Xilinx,Pulse,ON,Everlight and Freescale. Main products comprise IC,Modules,Potentiometer,IC Socket,Relay,Connector.Our parts cover such applications as commercial,industrial, and automotives areas.

We are looking forward to setting up business relationship with you and hope to provide you with the best service and solution. Let us make a better world for our industry!



Contact us

Tel: +86-755-8981 8866 Fax: +86-755-8427 6832

Email & Skype: info@chipsmall.com Web: www.chipsmall.com

Address: A1208, Overseas Decoration Building, #122 Zhenhua RD., Futian, Shenzhen, China





Copyright FCI.



FCIconnect.com



1 | 2

3 |

4

PRODUCT NUMBER	PITCH
KOxx21x100J0G	9.52 mm

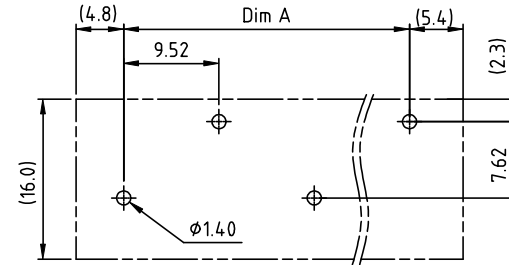
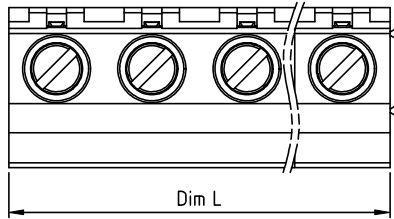

RECOMMENDED P.C.B LAYOUT
TOP VIEW

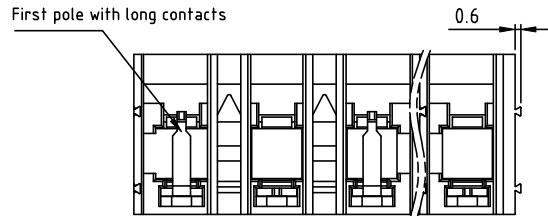
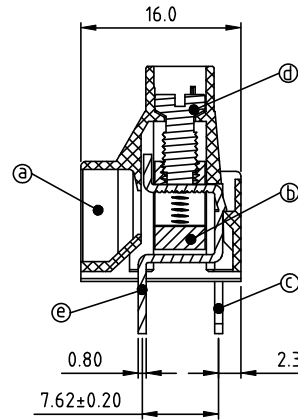
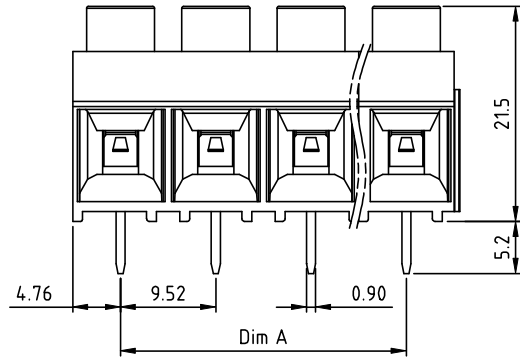

PART NO.: KO xx 2 1 x 1 00J0 G

DIMENSION

Dim L	Nx9.52
Dim A	(N-1)x9.52

N=Number of poles

Poles	Tolerance
2p/4p/6p	±0.15
8p/10p/12p	±0.25
14p/16p	±0.35

End Stackable	0	Body Color	Black (RAL9005)	RoHS compliant	(lead<4%)
No. of poles	2		Red (RAL3001/D)	In copper Alloy	
02 2 poles	3		Orange(RAL2011/P)		
04 4 poles	4		Yellow(RAL1018/A)		
...	...		5 Green(RAL6018/T)		
16 16 poles	6		6 Blue (RAL5015/A)		
	8		8 Grey(RAL7035/D)		
	9		9 White(RAL1102)		
	C		Green(RAL6018/U)		

Material:

- Item a Terminal housing : Thermoplastic (UL94V-0)
- Item b Clamp : Brass, Ni plated
- Item c Short pin : Copper , Tin plated (Side Contacts)
- Item d Terminal screw: Steel Zinc plating "-" slot type
- Item e Long pin : Copper , Tin plated (Center Contacts)

Electrical:

- Voltage rating: 600 V
- Current rating: 30 A
- Wire range:
- Solid wire(AWG): 10-24
- Stranded wire(AWG): 10-24
- Torque: 5.5 Lb-In
- Screw: M3.5
- Wire strip length: 7-8 mm
- Withstanding Voltage: 2.2KV
- Operating temperature: -40°C to +115°C
- Soldering temperature: 260°C±5°C/5 Sec
- Safety Approval:

mat'l. code				surface	tolerance	projection	product family	
				ASME Y14.5	ASME Y14.5		TERMINAL BLOCK	
itr	ecn no	dr	date	tolerances unless otherwise specified			title	
				angles	X.±0.5	MM	TERMINAL BLOCK	
				X'±1"	X.XX±0.3		RISING CLAMP,180D WIRE INLET,INTERLACE TAIL,EVEN POLES	
					X.XX±0.1	scale	scale	
		dr	EVIN ZHONG	041414			dwg no	
		enr	EVIN ZHONG	041414	sheet 1 of 2		size	
		chr	HANKE FENG	041414	KOxx21x100J0G		A4	
		appd	SHI JUN	041414	type		CUSTOMER Drawing	
sheet index	revision sheet	A	1					



PRODUCT NUMBER	PITCH
KOxx21x100J0G	9.52 mm

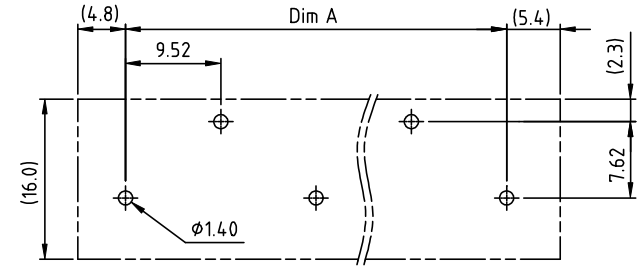
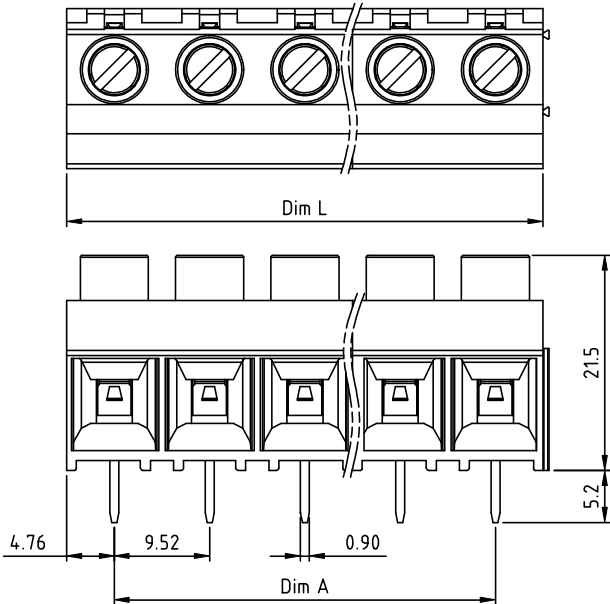

RECOMMENDED P.C.B LAYOUT
TOP VIEW

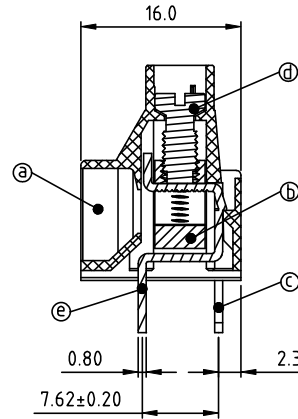

Material:

- Item a Terminal housing : Thermoplastic (UL94V-0)
- Item b Clamp : Brass, Ni plated
- Item c Short pin : Copper , Tin plated (Side Contacts)
- Item d Terminal screw: Steel Zinc plating "-" slot type
- Item e Long pin : Copper , Tin plated (Center Contacts)

Electrical:

- Voltage rating: 600 V
- Current rating: 30 A
- Wire range:
- Solid wire(AWG): 10-24
- Stranded wire(AWG): 10-24
- Torque: 5.5 Lb-In
- Screw: M3.5
- Wire strip length: 7-8 mm
- Withstanding Voltage: 2.2KV
- Operating temperature: -40°C to +115°C
- Soldering temperature: 260°C±5°C/5 Sec
- Safety Approval:

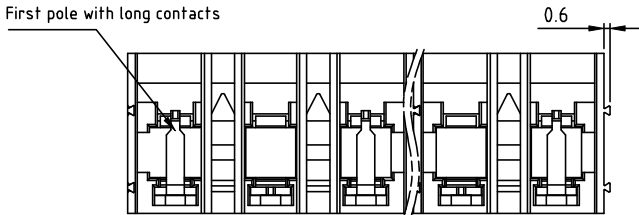

PART NO.: KO xx 2 1 x 1 00J0 G

DIMENSION

Dim L	Nx9.52
Dim A	(N-1)x9.52

N=Number of poles

Poles	Tolerance
3p/5p	±0.15
7p/9p/11p	±0.25
13p/15p	±0.35

End Stackable	0	Body Color	Black (RAL9005)	RoHS compliant	(lead<4%)
No. of poles	2		Red (RAL3001/D)	In copper Alloy	
03	3 poles	3	Orange(RAL2011/P)		
05	5 poles	4	Yellow(RAL1018/A)		
...	...	5	Green(RAL6018/T)		
15	15 poles	6	Blue (RAL5015/A)		
		8	Grey(RAL7035/D)		
		9	White(RAL1102)		
		C	Green(RAL6018/U)		

mat'l. code				surface	tolerance	projection	product family		
				ASME Y14.5	ASME Y14.5		TERMINAL BLOCK		
itr				tolerances unless otherwise specified		title			
ecn no						TERMINAL BLOCK			
dr				angles		RISING CLAMP,180D WIRE INLET,INTERLACE TAIL,ODD POLES			
date				X±0.5		scale			
				X.X±0.3		dwg no			
				X'±1"		K0xx21x100J0G			
				X.XX±0.1		sheet 2 of 2 size			
				dr		A4			
				enr		type			
				chr		CUSTOMER Drawing			
				appd					
				SHI JUN					
				041414					
				041414					
				041414					
				041414					
sheet				revision		A			
index				sheet		2			